



an ISO 9001:2000 Registered Company

1968 CORVETTE

w & wo AC

1969-76 CORVETTE

wo AC CONTROL PANEL CONVERSION KIT

473170

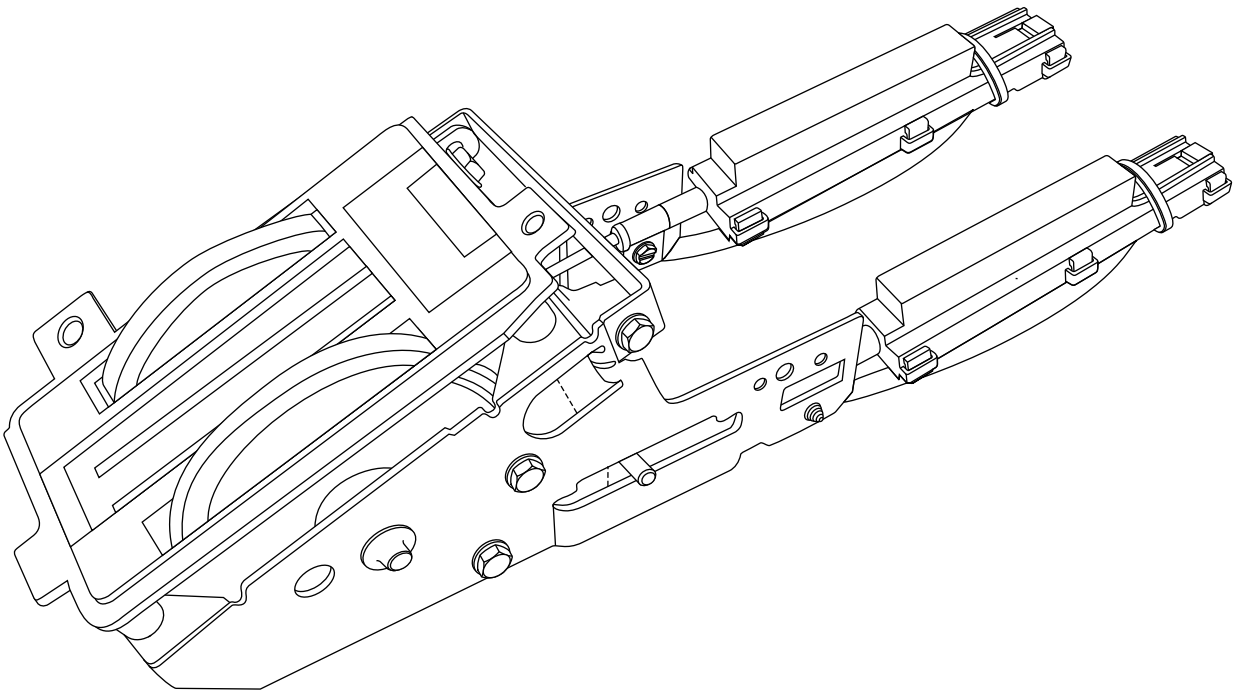

18865 GOLL ST. - SAN ANTONIO, TX. - 78266 ph.210-654-7171 - fax 210-654-3113



Table of Contents

PAGES

1. COVER
2. TABLE OF CONTENTS
3. PACKING LIST/PARTS DISCLAIMER
4. DISASSEMBLY/ PLACARD INSTALLATION
FIGURE 1
5. CABLE CONVERTER ASSEMBLY MODIFICATIONS & CABLE CONVERTER
ASSEMBLY MOUNTING CLAMP INSTALLATION
FIGURES 2 & 3
6. DEF/ DASH/ FLR CABLE CONVERTER ASSEMBLY INSTALLATION
FIGURE 4
7. CONTROL HARNESS
FIGURES 5 & 5a
8. COLD/ HOT CABLE CONVERTER ASSEMBLY INSTALLATION
& CONTROL HARNESS
FIGURES 6 & 7
9. CONTROL HARNESS CONT. & BLOWER SWITCH PC BOARD INSTALLATION
FIGURES 8 & 9
10. FINAL STEPS
FIGURE 10
11. CONTROL PANEL CALIBRATION PROCEDURE
12. WIRING DIAGRAM
13. OPERATION OF CONTROLS
14. CONTROL PANEL CONVERSION KIT PACKING LIST



**1968 CORVETTE w & wo AC
1969-76 CORVETTE wo AC CONTROL PANEL
CONVERSION PACKING LIST**

CONVERSION KIT
473170

No.	QTY.	PART No.	DESCRIPTION
1.	1	484173-PCR	68-76 CORVETTE PLACARD
2.	2	112002-SUA	CABLE CONVERTER ASM
3.	1	232006-VUR	GEN IV UNIVERSAL CONTROL HARNESS (TYPE B)
4.	2	65975-VUE	1/8" PUSH-ON RING
5.	2	49705-VUI	1/8" NYLON SPACER
6.	2	491010-VUR	CABLE CONVERTER CLAMP
7.	5	21301-VUP	4" TIE WRAP
8.	1	231520	GROUND WIRE
9.	1	246110-PUA	68-76 CORVETTE 3-SPD BLWR SWITCH PC BOARD ASM
10.	2	18247-VUB	#10 x 1/2 SHEET METAL SCREW

**** BEFORE BEGINNING INSTALLATION OPEN ALL PACKAGES AND CHECK CONTENTS OF SHIPMENT. PLEASE REPORT ANY SHORTAGES DIRECTLY TO VINTAGE AIR WITHIN 15 DAYS. AFTER 15 DAYS, VINTAGE AIR WILL NOT BE RESPONSIBLE FOR MISSING OR DAMAGED ITEMS.**

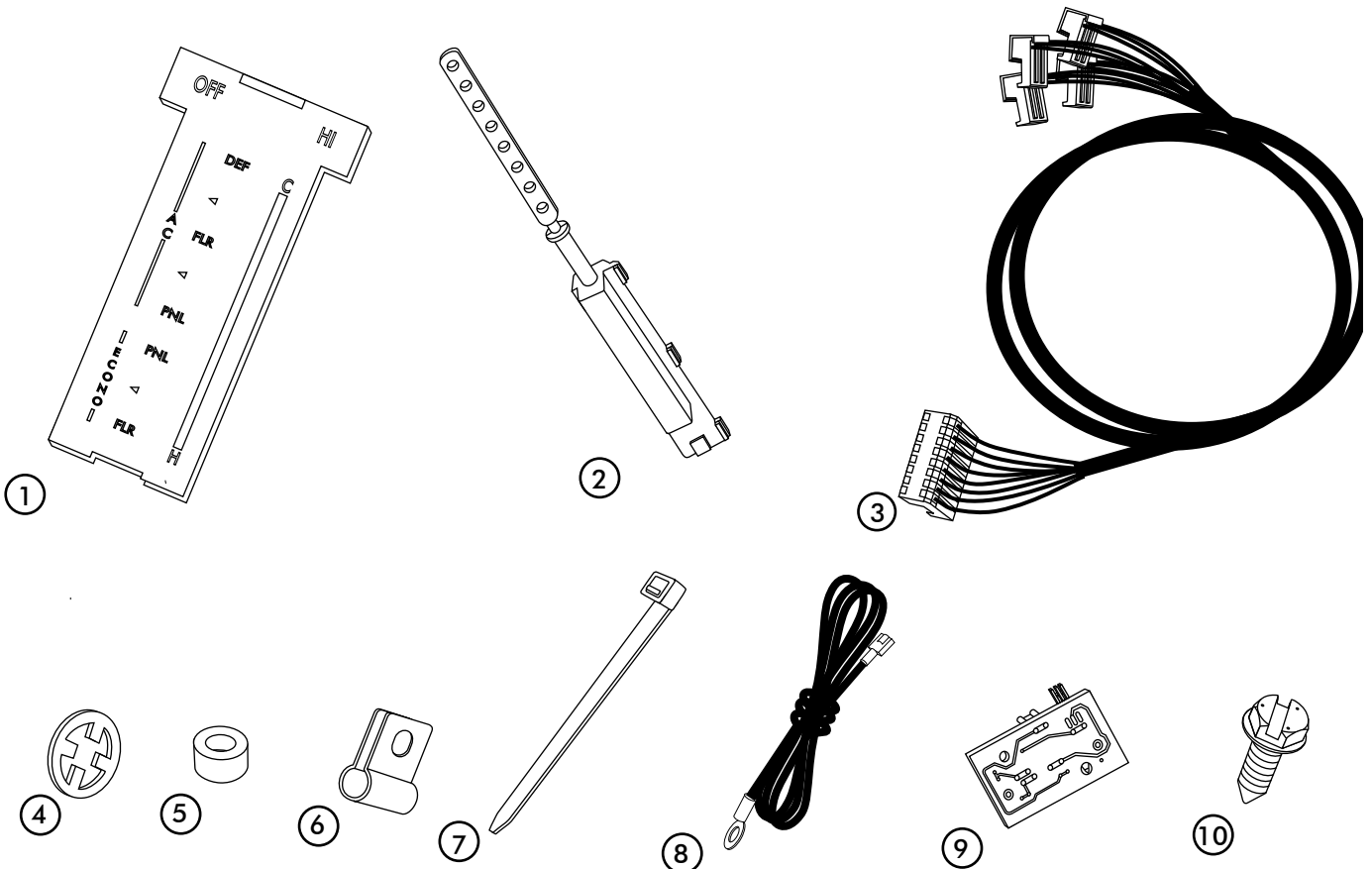



1968-76 CORVETTE CONTROL PANEL CONVERSION

REMOVE CONTROL PANEL BEZEL BY REMOVING THE (4) OEM MOUNTING SCREWS ON THE BACKSIDE OF THE CONTROL PANEL . (RETAIN)
REMOVE THE OEM VACUUM CONTROL ASSEMBLY AND A/C SWITCH ASSEMBLY. (DISCARD)
REMOVE THE CONTROL PANEL BRACE. (DISCARD)
REMOVE OEM PLACARD AND INSTALL NEW PLACARD AS SHOWN IN FIGURE 1, BELOW.
RE-INSTALL THE BEZEL USING THE (4) OEM SCREWS.

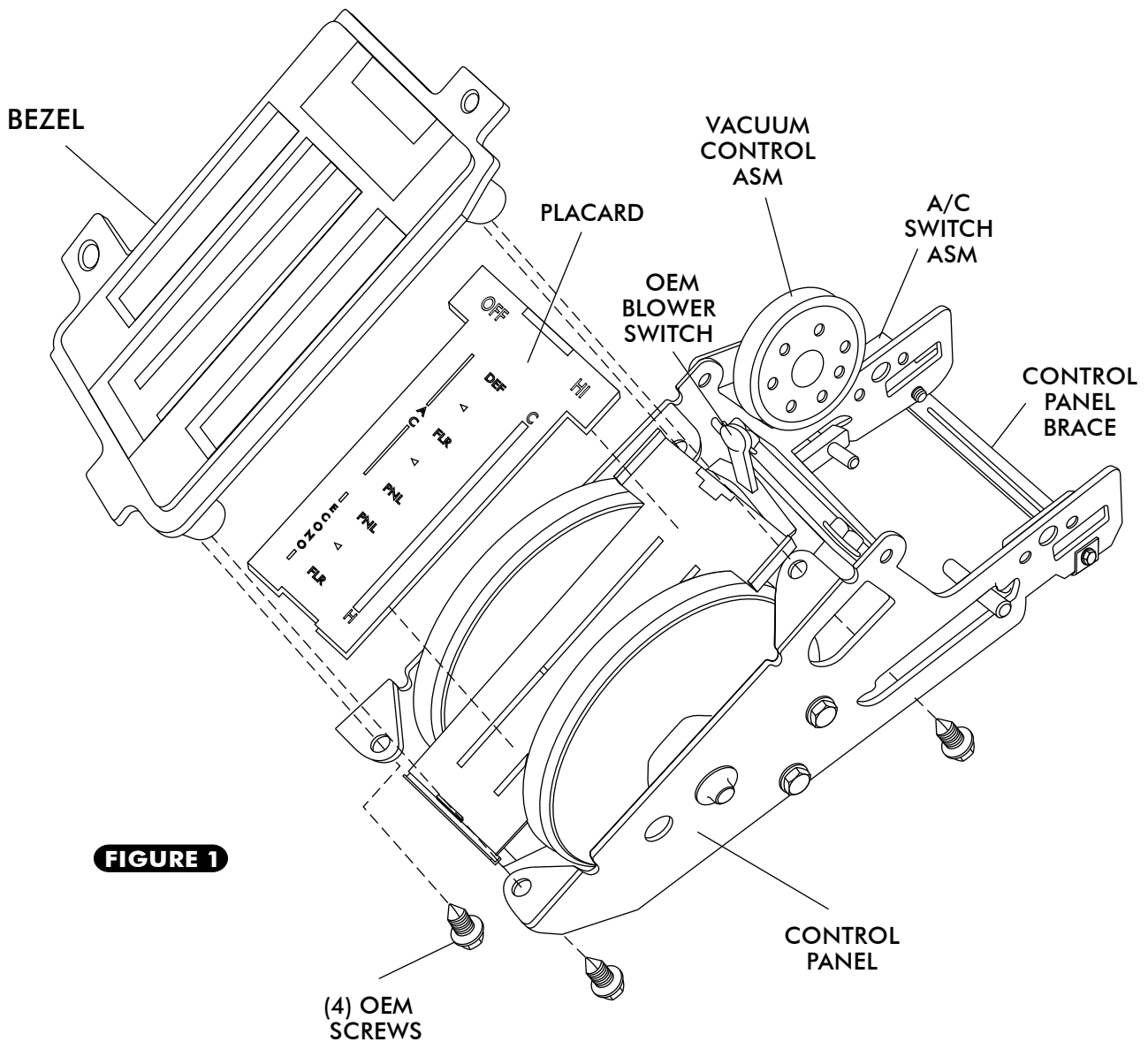
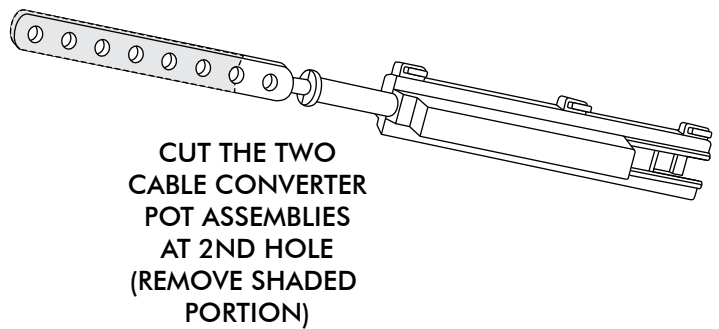
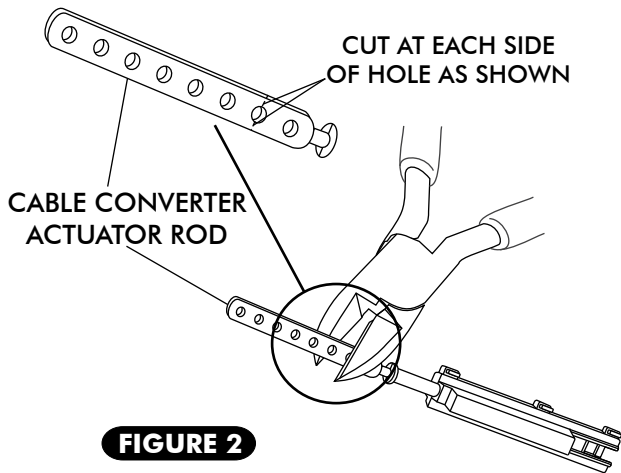

FIGURE 1



CABLE CONVERTER ASSEMBLY MODIFICATIONS

- LOCATE THE (2) CABLE CONVERTER ASSEMBLIES, AND A PAIR OF WIRE CUTTERS, CUT CABLE CONVERTER ACTUATOR RODS AS SHOWN BELOW IN FIGURE 2.



CABLE CONVERTER ASSEMBLY MOUNTING CLAMP INSTALLATION

- INSTALL CABLE CONVERTER ASM MOUNTING CLAMPS. SEE FIGURE 3 BELOW.

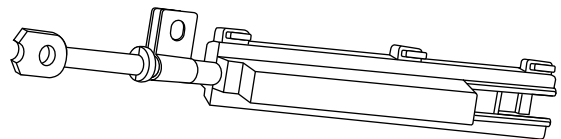
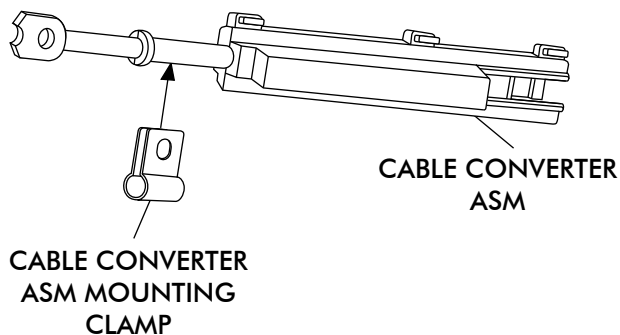



CABLE CONVERTER ASSEMBLY INSTALLATION

DEF/ DASH/ FLR CABLE CONVERTER ASSEMBLY

- INSTALL CABLE CONVERTER ASM ON THE DEF/ DASH/ FLR LEVER. SEE FIGURE 4 BELOW.
- INSTALL CABLE CONVERTER LEVER PUSH ROD ONTO OEM CABLE MOUNTING STUD ON LEVER. SEE FIGURE 4 BELOW.
- SECURE THE CABLE CONVERTER ASM TO THE CONTROL PANEL USING 1/8" SPACER AND A #10 x 1/2" SHEET METAL SCREW AS SHOWN IN FIGURE 4.
- SINCE THE CABLE CONVERTER ASSEMBLY CAN SLIDE BACK AND FORTH IN CLAMP BEFORE SCREW IS TIGHTENED, POSITION CABLE CONVERTER ASSEMBLY SUCH THAT THE FLAT PART OF THE ROD IS AS CLOSE TO FLUSH AS POSSIBLE WITH THE END OF HOUSING AT THE LEVERS INNER MOST POSITION. SEE FIGURE 4 BELOW.
- SECURE CABLE CONVERTER PUSH ROD ONTO OEM CABLE MOUNTING STUD USING 1/8" PUSH-ON RING AS SHOWN IN FIGURE 4 BELOW.

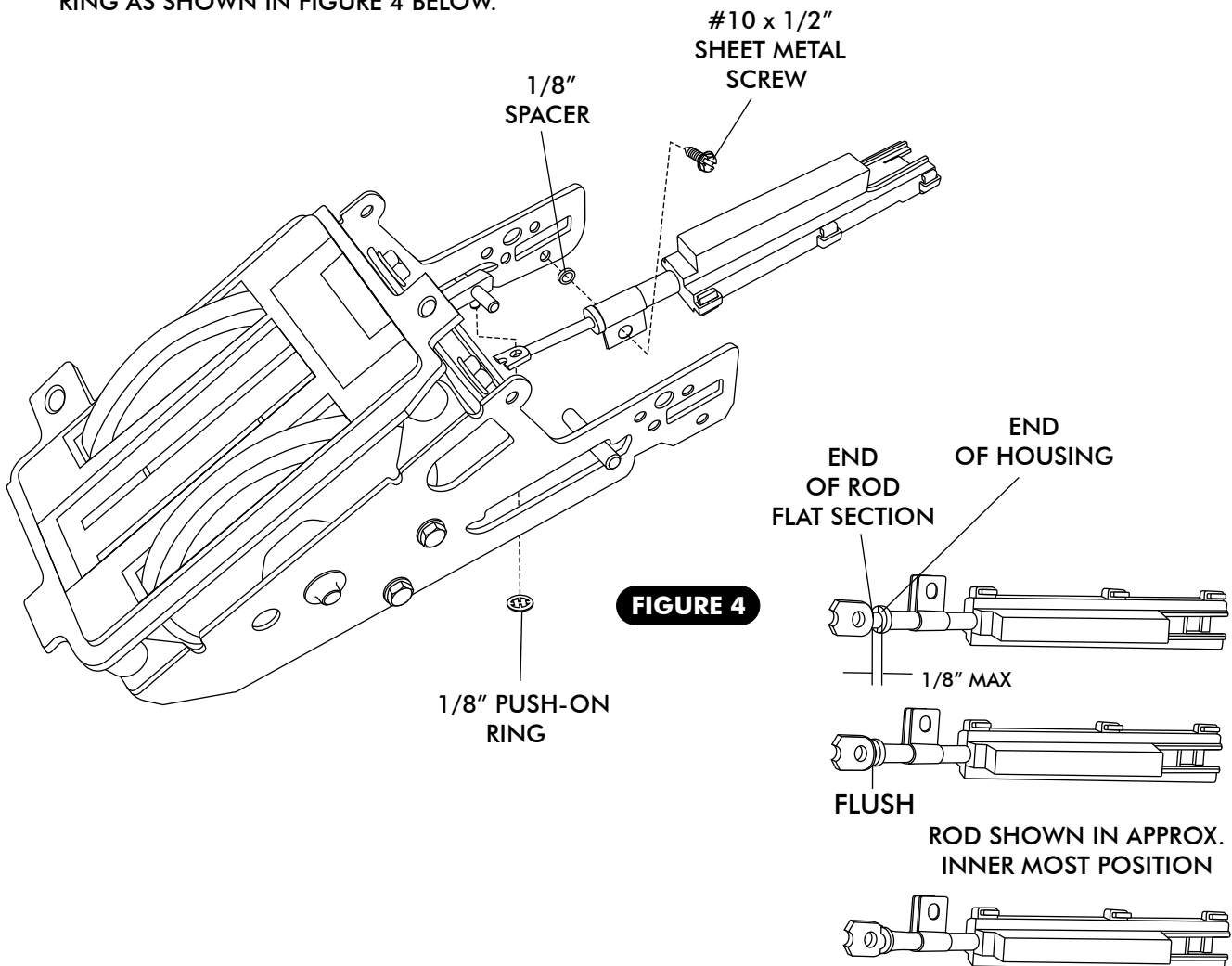

NOTE: DO NOT ALLOW ROD TO SEPARATE HOUSING WHEN ROD IS IN INNER MOST POSITION.



CONTROL HARNESS

- LOCATE THE CONTROL PANEL WIRING HARNESS AND PLUG THE CORRESPONDING WIRES INTO THE CORRECT CABLE CONVERTER ASSEMBLY AS SHOWN IN FIGURE 5 BELOW.

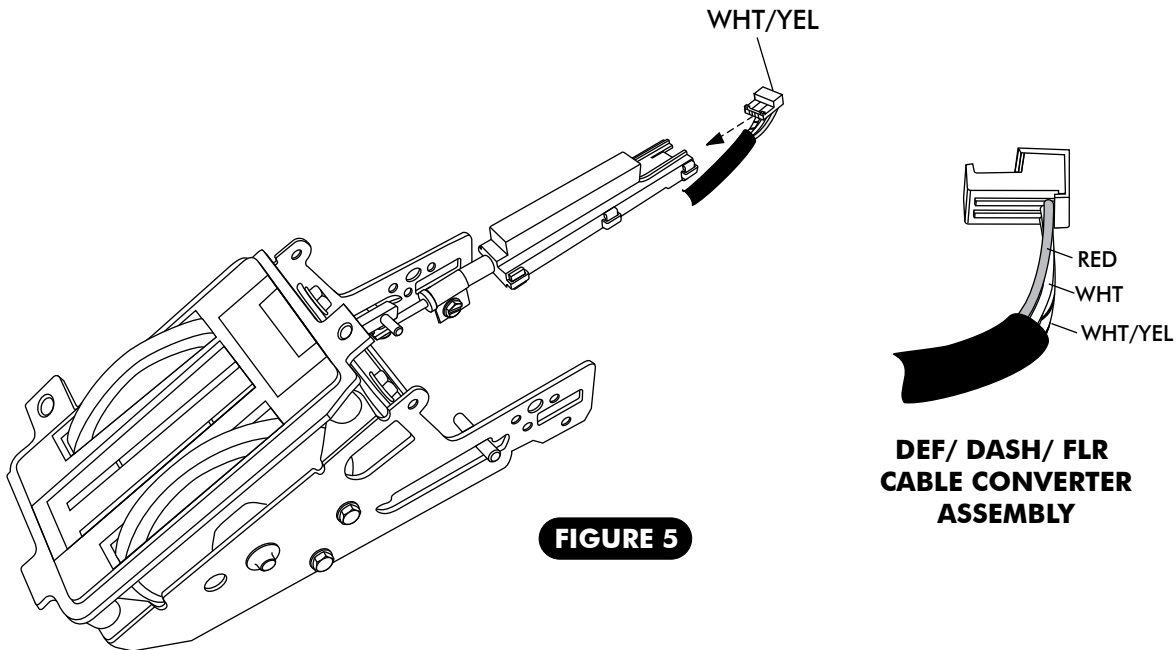

- ONCE WIRES ARE CORRECTLY PLUGGED INTO CABLE CONVERTER ASSEMBLY, SECURE WIRES TO THE CABLE CONVERTER ASSEMBLY USING TIE WRAPS (SUPPLIED). SEE FIGURE 5a BELOW. THE TIE WRAP MUST BE LOCATED BETWEEN THE END OF THE WIRE JACKET AND THE STEP IN THE CABLE CONVERTER HOUSING FORCING A BEND IN EACH WIRE AS THEY PASS OVER THE STEP IN CABLE CONVERTER HOUSING. HEAD OF TIE WRAP MUST FALL ON EDGE OF HOUSING AS SHOWN TO REMAIN TIGHT. ENSURE THAT THE TIE WRAPS ARE SNUG ENOUGH THAT WIRES CANNOT MOVE. SEE FIGURE 5a.

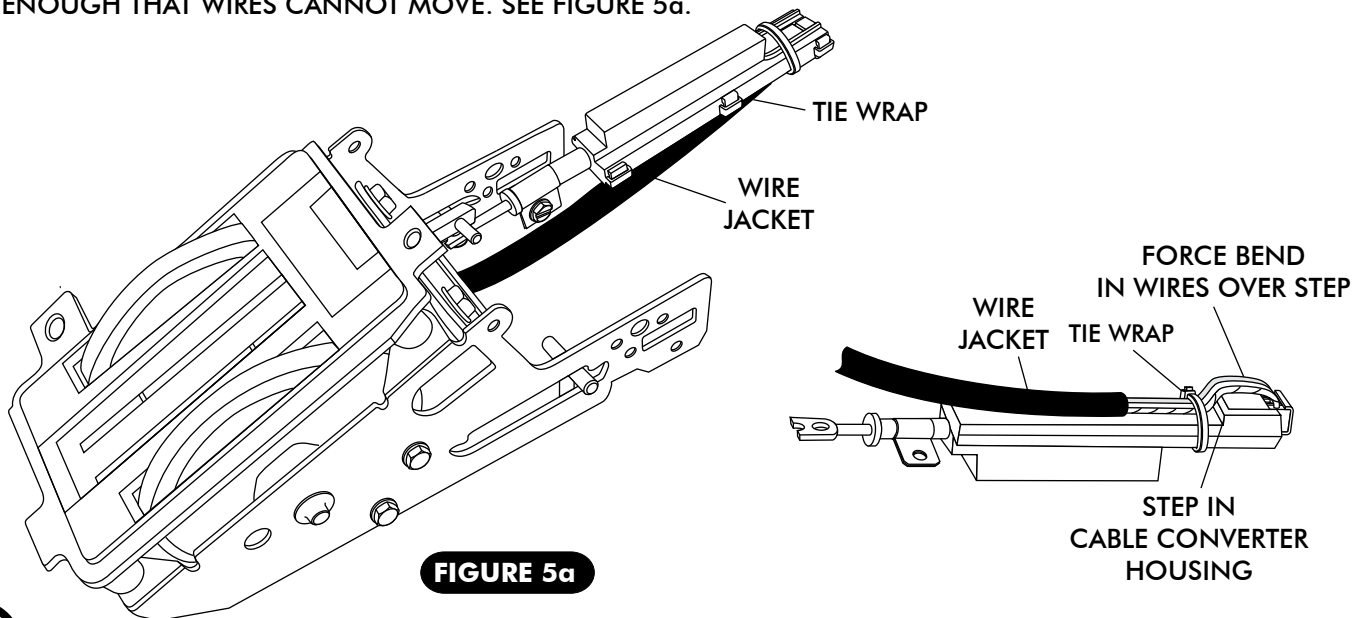



CABLE CONVERTER ASSEMBLY INSTALLATION

COLD/ HOT CABLE CONVERTER ASSEMBLY

- INSTALL CABLE CONVERTER ASM ON THE COLD/HOT LEVER. SEE FIGURE 6 BELOW.
- INSTALL CABLE CONVERTER LEVER PUSH ROD ONTO OEM CABLE MOUNTING STUD ON LEVER. SEE FIGURE 6 BELOW.
- SECURE THE CABLE CONVERTER ASM TO THE CONTROL PANEL USING 1/8" SPACER AND A #10 x 1/2" SHEET METAL SCREW AS SHOWN IN FIGURE 6.
- SINCE THE CABLE CONVERTER ASSEMBLY CAN SLIDE BACK AND FORTH IN CLAMP BEFORE SCREW IS TIGHTENED, POSITION CABLE CONVERTER ASSEMBLY SUCH THAT THE FLAT PART OF THE ROD IS AS CLOSE TO FLUSH AS POSSIBLE WITH THE END OF HOUSING AT THE LEVER'S INNER MOST POSITION. SEE FIGURE 6 BELOW.
- SECURE CABLE CONVERTER PUSH ROD ONTO OEM CABLE MOUNTING STUD USING 1/8" PUSH-ON RING AS SHOWN IN FIGURE 6 BELOW.

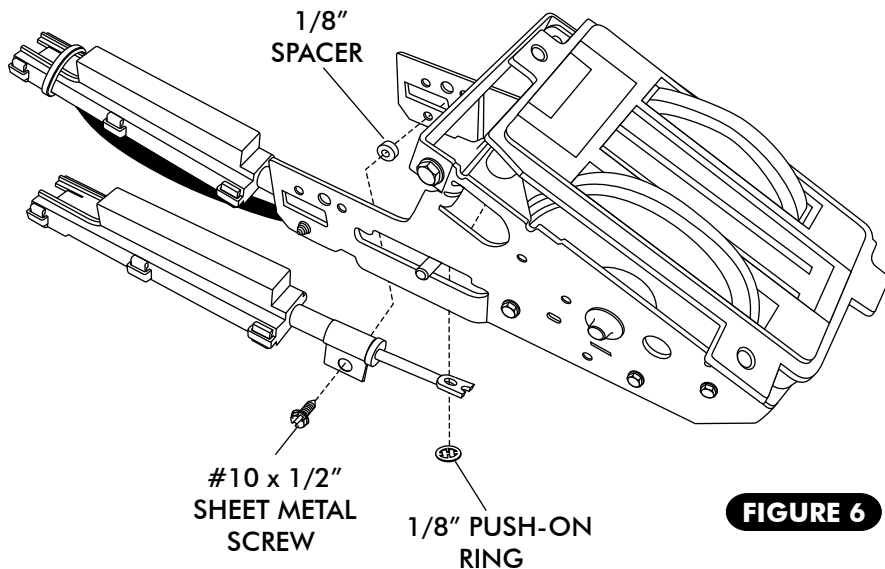

FIGURE 6

CONTROL HARNESS

- LOCATE THE CONTROL PANEL WIRING HARNESS AND PLUG THE CORRESPONDING WIRES INTO THE CORRECT CABLE CONVERTER ASSEMBLY AS SHOWN IN FIGURE 7 BELOW.

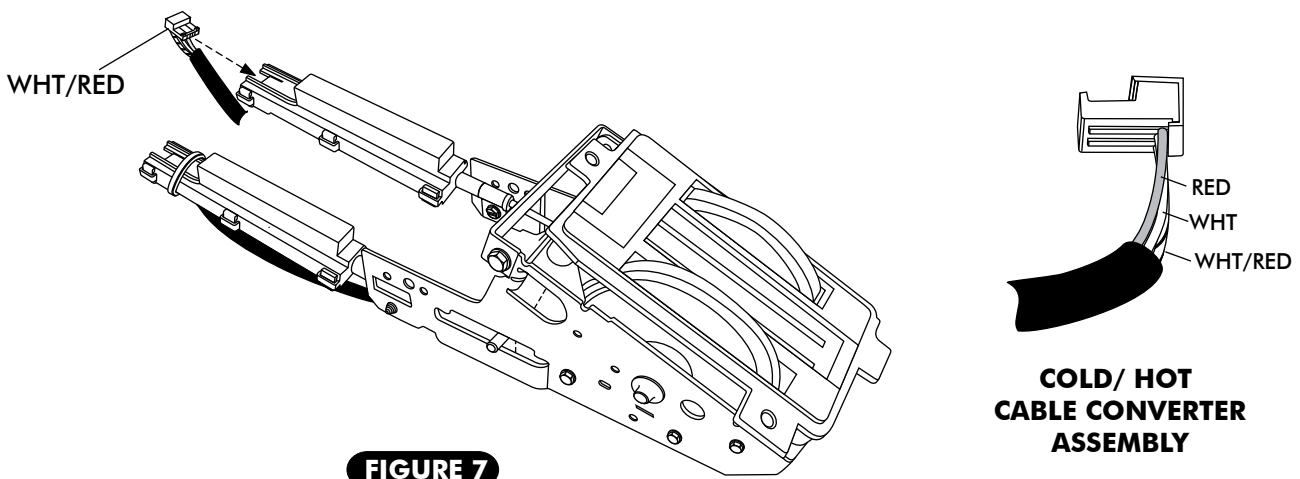

FIGURE 7



CONTROL HARNESS CONT.

- ONCE WIRES ARE CORRECTLY PLUGGED INTO CABLE CONVERTER ASSEMBLY, SECURE WIRE TO THE CABLE CONVERTER ASSEMBLY USING TIE WRAPS (SUPPLIED). SEE FIGURE 8 BELOW. THE TIE WRAP MUST BE LOCATED BETWEEN THE END OF THE WIRE JACKET AND THE STEP IN THE CABLE CONVERTER HOUSING FORCING A BEND IN EACH WIRE AS THEY PASS OVER THE STEP IN CABLE CONVERTER HOUSING. HEAD OF TIE WRAP MUST FALL ON EDGE OF HOUSING AS SHOWN TO REMAIN TIGHT. ENSURE THAT THE TIE WRAPS ARE SNUG ENOUGH THAT THE WIRES CANNOT MOVE. SEE FIGURE 8.

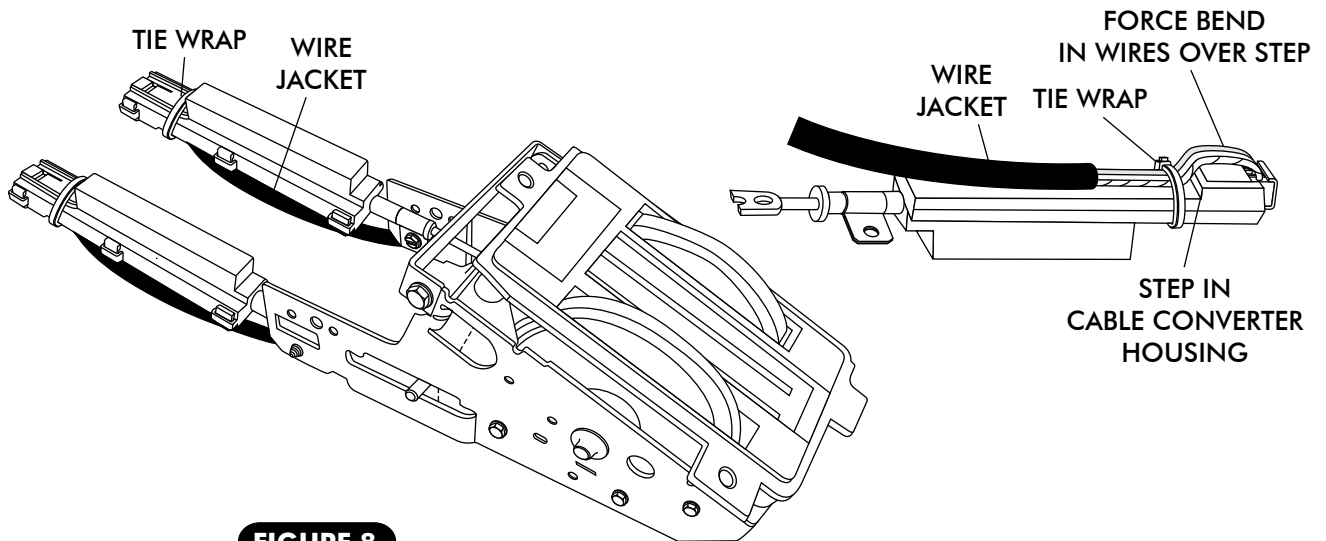

FIGURE 8

BLOWER SPEED SWITCH PC BOARD INSTALLATION

- INSTALL THE BLOWER SPEED SWITCH PC BOARD ON THE BACK OF THE OEM SWITCH AS SHOWN. SEE FIGURE 9 BELOW.

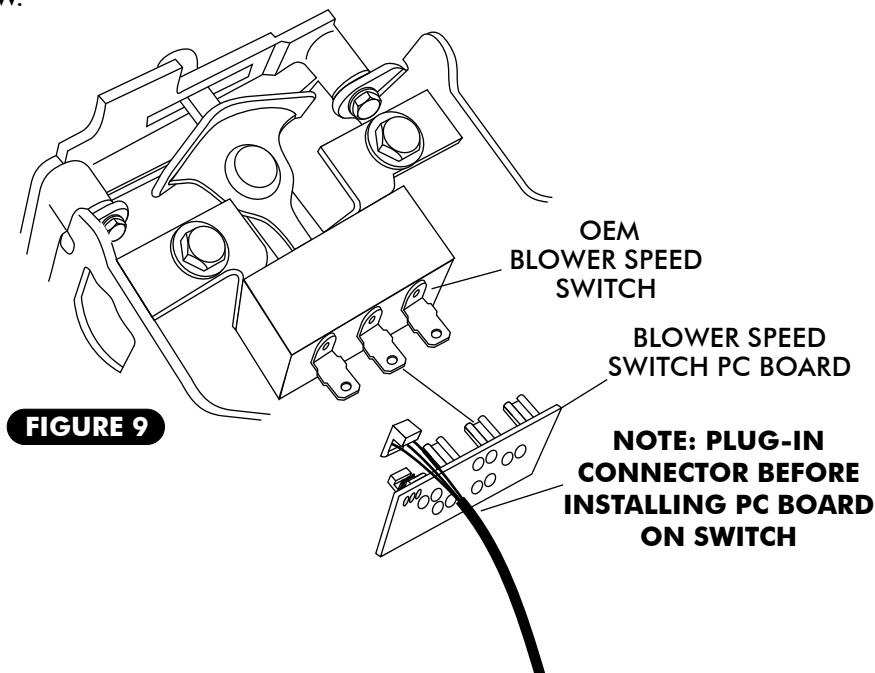

FIGURE 9



FINAL STEPS

- ❑ USING THE SUPPLIED TIE WRAPS, TIE THE WIRES TO THE CONTROL PANEL AS SHOWN IN FIGURE 10 BELOW. CONFIRM THAT WIRES ARE SECURE AND DO NOT INTERFERE WITH LEVER OPERATION OR CABLE CONVERTER ASSEMBLY.
- ❑ REINSTALL CONTROL PANEL IN CENTER CONSOLE.
- ❑ PLUG THE WIRING HARNESS INTO THE ECU MODULE ON SUB CASE. SEE FIGURE 10 BELOW.
- ❑ WIRE ACCORDING TO WIRING DIAGRAM ON PAGE 12.
- ❑ CALIBRATION PROCEDURE AND OPERATION INSTRUCTIONS:

CALIBRATING THE CONTROL PANEL WILL SET THE RANGE OF TRAVEL FOR THE CABLE CONVERTERS CONNECTED TO THE OEM CONTROL PANEL LEVERS. PERFORMING THIS PROCEDURE WILL SET THE LIMITS OF THE CABLE CONVERTERS AT THEIR HIGHEST AND LOWEST POINTS.

LOCATE THE GRAY WIRE WITH AN UNUSED CONNECTOR IN THE WIRING HARNESS NEAR THE TWO CABLE HARNESS RELAYS. THIS WIRE IS LABELED *PRGM* ON THE WIRING DIAGRAM ON PAGE 12.

IT WILL BE NECESSARY TO GROUND THE GRAY WIRE FOR APPROXIMATELY FIVE SECONDS WHILE MOVING THE CONTROLS SO IT IS SOMETIMES HELPFUL TO ATTACH ONE END OF THE WHITE JUMPER WIRE TO THE VEHICLE'S GROUND (FOR EXAMPLE THE CHASSIS) AND HAVE THE OTHER END READY TO CONNECT TO THE GRAY *PRGM* WIRE WHEN THE PROCEDURE REQUIRES IT.

TO CALIBRATE THE CONTROL PANEL FOLLOW THE CALIBRATION PROCEDURES ON PAGE 11.

NOTE: TIE THE UNUSED WIRE TO THE CONTROL THAT THE WIRE DOES NOT INTERFERE WITH LEVER OR SLIDE POT ASSEMBLIES.

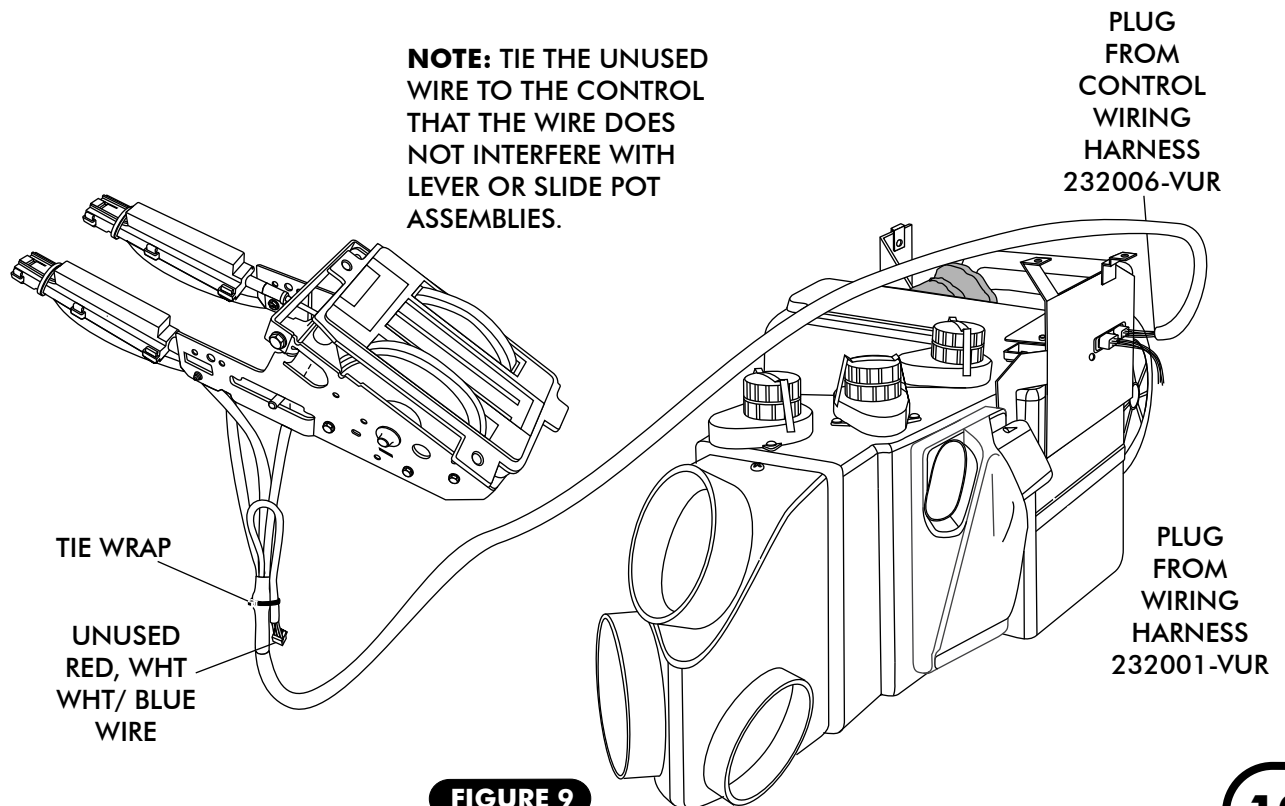

FIGURE 9



CONTROL PANEL CALIBRATION PROCEDURE

1. TURN THE IGNITION SWITCH ON (DO NOT START THE ENGINE)
2. CONNECT THE WHITE JUMPER WIRE TO VEHICLE'S GROUND (FOR EXAMPLE THE VEHICLE CHASSIS). ENSURE THAT THE GRAY WIRE IS NOT GROUNDED. DO NOT CONNECT JUMPER WIRE TO THE GRAY PRGM WIRE. SEE FIGURE A, BELOW.

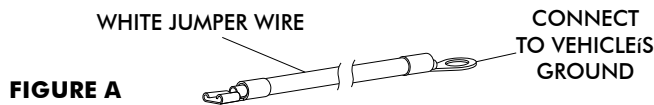

FIGURE A

3. MOVE ALL OF THE CONTROL LEVERS TO THEIR POSITIONS, AS SHOWN IN FIGURE B, BELOW.

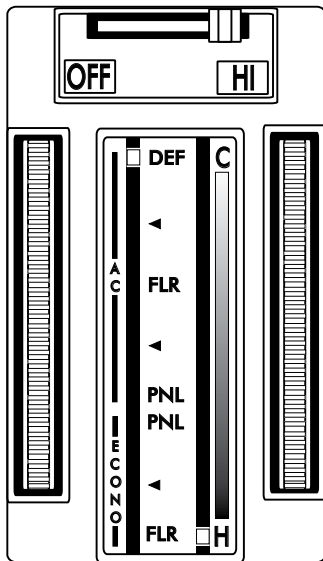

FIGURE B

4. GROUND THE GRAY WIRE BY CONNECTING THE GRAY PRGM WIRE & WHITE JUMPER WIRE FOR APPROXIMATELY 5 SECONDS (THE BLOWER WILL CHANGE SPEEDS WHEN STEP FOUR IS COMPLETE). SEE FIGURE C, BELOW.

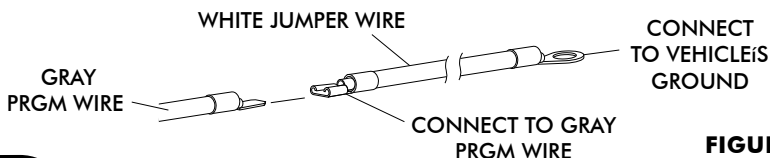

FIGURE C

5. LEAVING THE GRAY WIRE GROUNDED, MOVE ALL OF THE CONTROL LEVERS TO THEIR POSITIONS AS SHOWN IN FIGURE D BELOW.

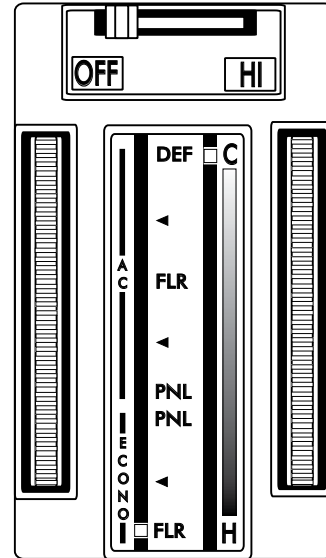

FIGURE D

6. DISCONNECT THE GRAY WIRE FROM THE WHITE GROUND JUMPER WIRE (THE BLOWER WILL CHANGE SPEEDS WHEN STEP SIX IS COMPLETE). SEE FIGURE E, BELOW.

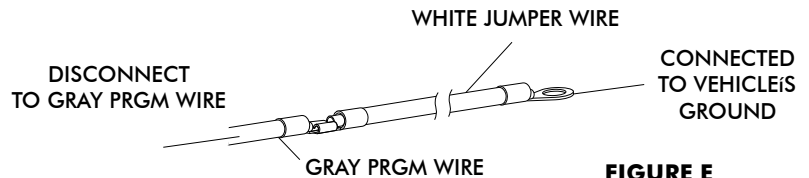

FIGURE E

7. START THE ENGINE AND TEST ALL OF THE CONTROLS TO ENSURE THAT THE INTENDED RESULTS WERE ACCOMPLISHED.
8. DISCONNECT THE WHITE JUMPER WIRE FROM VEHICLE'S GROUND.

NOTE: THIS PROCEDURE MAY BE REPEATED IF NECESSARY.

*** WHEN FINISHED, TAPE OVER PROGRAM WIRE CONNECTOR WITH ELECTRICAL TAPE TO PREVENT ACCIDENTAL CONTACT WITH CHASSIS GROUND.**



WIRING DIAGRAM

232006-VUR

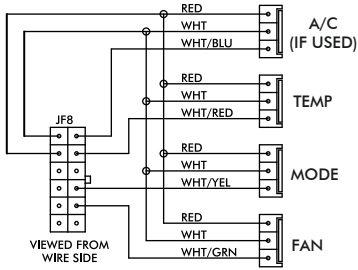

232007-VUR

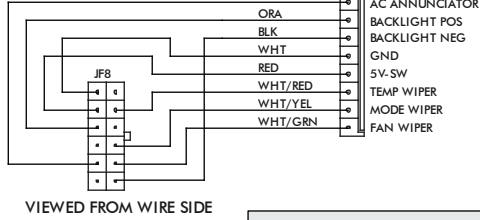

232002-VUA

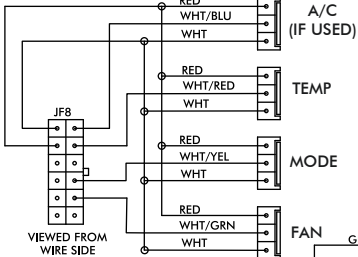

GEN IV ECU

GEN IV WIRING DIAGRAM
REV C, 11/24/2009

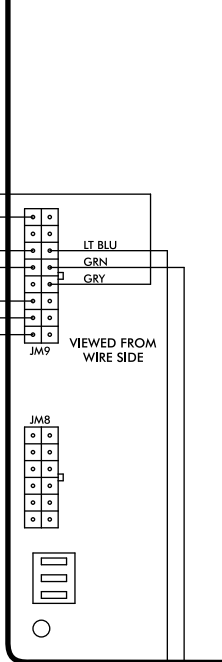

PRE-WIRED

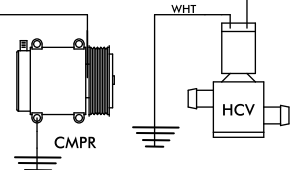
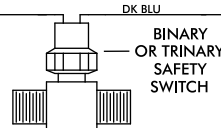
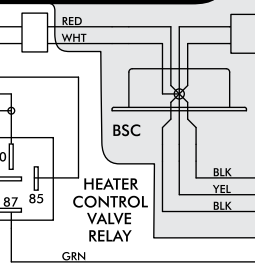
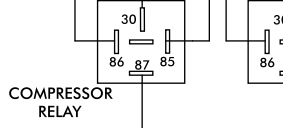
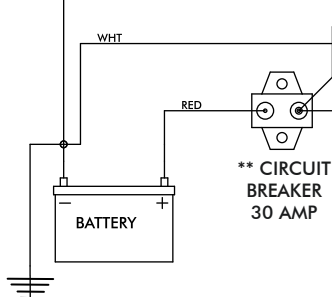
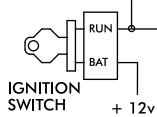
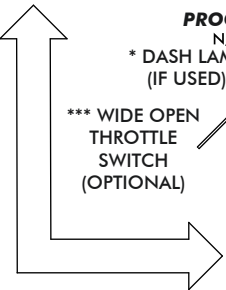
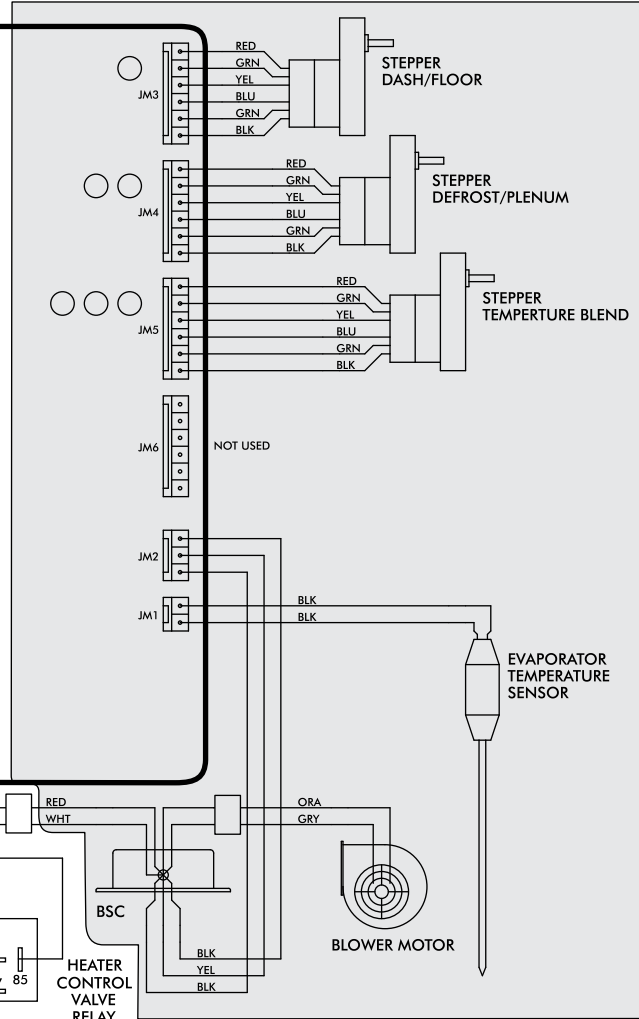

NOTE: = CHASSIS GROUND

- * DASH LAMP IS ONLY USED WITH TYPE C HARNESS
- ** WARNING: ALWAYS MOUNT CIRCUIT BREAKER UNDER THE HOOD IN THE ENGINE COMPARTMENT AND AS CLOSE TO THE BATTERY AS POSSIBLE.
- *** WIDE OPEN THROTTLE SWITCH CONTACTS CLOSE ONLY AT FULL THROTTLE, WHICH DISABLES AC COMPRESSOR.



OPERATION OF CONTROLS

NOTE: WHEN EVER BATTERY POWER IS RECONNECTED TO THE ECU, THE COMPUTER GOES THROUGH AN INITIALIZ ATION SEQUENCE. THIS INITIALIZATION MAY TAKE UP TO 30 SECONDS. DURING INITIALIZATION THE DOORS INSIDE THE UNIT WILL BE OPERATING. A LOW BATTERY MAY ALSO TRIGGER A RE-INITIALIZATION. WHEN THE ENGINE IS BEING CRANKED A WEAK BATTERY MAY DROP BELOW 7 VOLTS, TRIGGERING RE-INITIALIZATION.

SYSTEM OFF

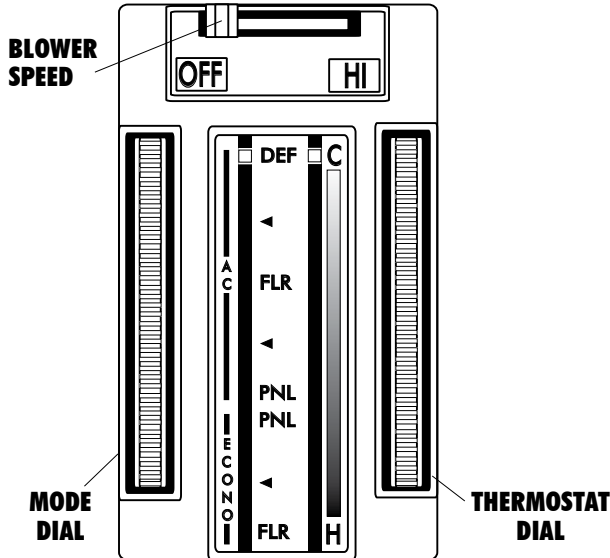

BLOWER SPEED
THIS LEVER CONTROLS THE BLOWER SPEED, FROM OFF TO HI

A/C THERMOSTAT DIAL
ROLL THE THERMOSTAT DIAL ALL THE WAY UP FOR MAXIMUM COOLING, ROLL THE DIAL DOWN TO DECREASE THE AMOUNT OF COOLING

MODE DIAL
ROLL THE DIAL DOWN TO THE "PNL" LEGEND IN AC RANGE OF THE MODE DIAL

A/C MODE

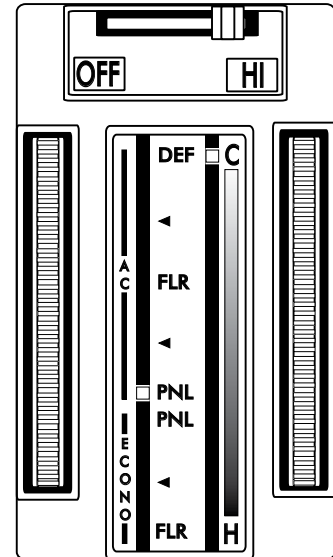

HEAT MODE

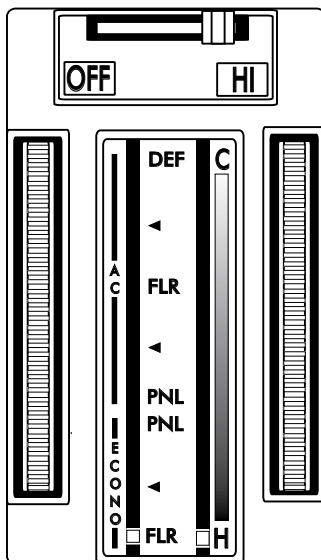

BLOWER SPEED
THIS LEVER CONTROLS THE BLOWER SPEED, FROM OFF TO HI

A/C THERMOSTAT DIAL
ROLL THE THERMOSTAT DIAL ALL THE WAY DOWN FOR MAXIMUM HEATING, ROLL THE DIAL UP TO DECREASE THE AMOUNT OF HEATING

MODE DIAL
ROLL THE DIAL DOWN TO THE "FLR" LEGEND IN THE ECONO RANGE OF THE MODE DIAL

BLOWER SPEED
THIS LEVER CONTROLS THE BLOWER SPEED, FROM OFF TO HI

A/C THERMOSTAT DIAL
ROLL THE THERMOSTAT DIAL ALL THE WAY DOWN FOR MAXIMUM HEATING, ROLL THE DIAL UP TO DECREASE THE AMOUNT OF HEATING

MODE DIAL
ROLL THE DIAL DOWN TO THE "DEF" LEGEND IN THE AC RANGE OF THE MODE DIAL

DEFROST MODE

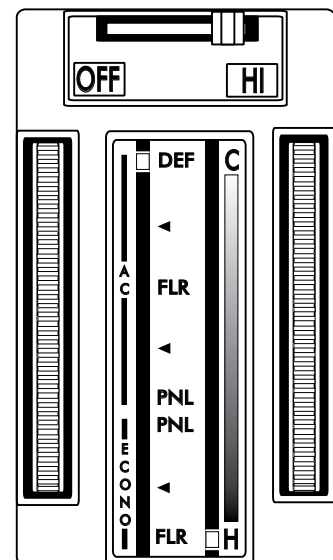

MODE DIAL, AC & ECONO RANGES

BOTH RANGES OF THE MODE DIAL OPERATE IDENTICALLY, WITH THE SINGULAR EXPECTATION THAT THE EXTRA COOLING AVAILABLE FROM THE AC COMPRESSOR IS NOT AVAILABLE WHILE THE MODE DIAL IS IN THE ECONO RANGE. WHEN THE MODE DIAL MOVES FROM ONE MODE RANGE TO THE OTHER, THE BLOWER SPEED CHANGES FOR AN INSTANT AND RETURNS TO NORMAL. THIS BEHAVIOR IS USED TO INDICATE THAT THE OPERATOR HAS MOVED INTO THE ALTERNATE MODE RANGE.



**1968 CORVETTE w & wo AC
1969-76 CORVETTE wo AC CONTROL PANEL
CONVERSION PACKING LIST**

CONVERSION KIT
473170

No.	QTY.	PART No.	DESCRIPTION
1.	1	484173-PCR	68-76 CORVETTE PLACARD
2.	2	112002-SUA	CABLE CONVERTER ASM
3.	1	232006-VUR	GEN IV UNIVERSAL CONTROL HARNESS (TYPE B)
4.	2	65975-VUE	1/8" PUSH-ON RING
5.	2	49705-VUI	1/8" NYLON SPACER
6.	2	491010-VUR	CABLE CONVERTER CLAMP
7.	5	21301-VUP	4" TIE WRAP
8.	1	231520	GROUND WIRE
9.	1	246110-PUA	68-76 CORVETTE 3-SPD BLWR SWITCH PC BOARD ASM
10.	2	18247-VUB	#10 x 1/2 SHEET METAL SCREW

CHECKED BY: _____
 PACKED BY: _____
 DATE: _____

