

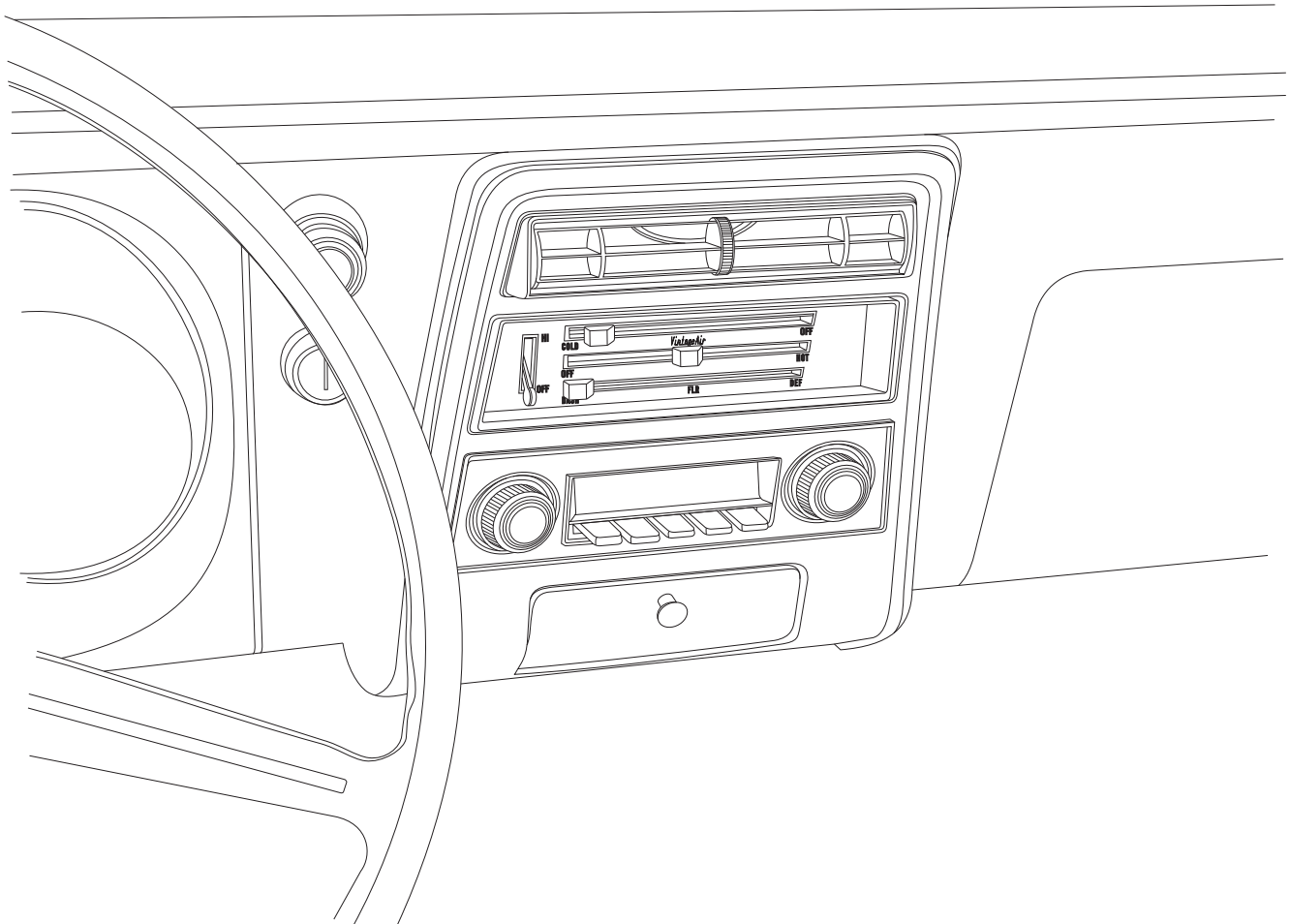

1967-68 CAMARO

w/ AC CONTROL PANEL
CONVERSION KIT

474167



18865 GOLL ST. - SAN ANTONIO, TX. - 78266 ph.210-654-7171 - fax 210-654-3113



Table of Contents

PAGES

1. COVER
2. TABLE OF CONTENTS
3. PACKING LIST/ PARTS DISCLAIMER
4. REMOVING OEM CONTROL PANEL & PLACARD INSTALLATION
FIGURES 1 & 2
5. SLIDE POT ASM MODIFICATIONS & SLIDE POT ASM MOUNTING
CLAMP INSTALLATION
FIGURES 3 & 4
6. DASH/FLR/DEF SLIDE POT ASM INSTALLATION
FIGURE 5
7. SLIDE POT ASM INSTALLATION CONT.
FIGURE 5a & FIGURE 5b
8. SLIDE POT ASM INSTALLATION CONT.
FIGURE 6 & FIGURE 6A
9. SLIDE POT ASM INSTALLATION CONT.
COLD/OFF SLIDE POT ASM INSTALLATION & OFF/ HI BLOWER
SWITCH INSTALLATION
FIGURE 6b & FIGURE 7
10. CONTROL HARNESS
FIGURE 7a & FIGURE 7b
11. FINAL STEPS
FIGURE 8
12. CONTROL PANEL CALIBRATION PROCEDURE
13. WIRING DIAGRAM
14. OPERATION OF CONTROLS
15. CONTROL PANEL KIT PACKING LIST



1967-68 CAMARO w/ AC CNTRL PNL

CONTROL KIT PACKING LIST

CONTROL KIT 474167

No.	QTY.	PART No.	DESCRIPTION
1.	1	484167	1967-68 CAMARO w/ AC CNTRL PNL MODE LABEL
2.	3	112002-SUA	SLIDE POT ASM
3.	1	232006-VUR	GEN IV UNIVERSAL CONTROL HARNESS (TYPE B)
4.	3	65976-VUE	3/16" PUSH-ON RING
5.	3	491010-VUR	SLIDE POT CLAMP
6.	5	21301-VUP	4" TIE WRAP
7.	1	23140-VUW	GROUND WIRE
8.	1	246108-PUA	BLOWER SWITCH PC BOARD

**** BEFORE BEGINNING INSTALLATION OPEN ALL PACKAGES AND CHECK CONTENTS OF SHIPMENT. PLEASE REPORT ANY SHORTAGES DIRECTLY TO VINTAGE AIR WITHIN 15 DAYS. AFTER 15 DAYS, VINTAGE AIR WILL NOT BE RESPONSIBLE FOR MISSING OR DAMAGED ITEMS.**

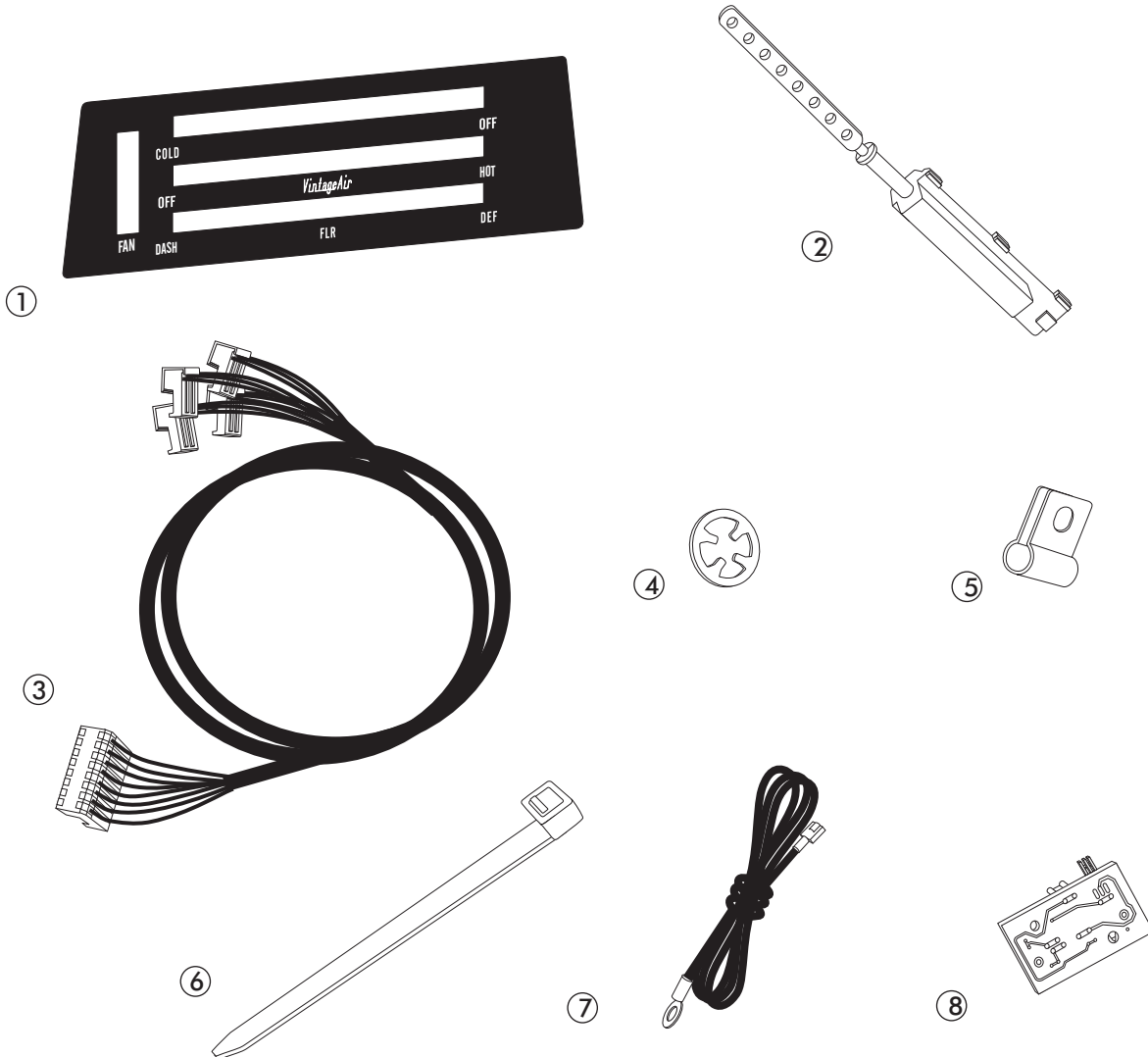



1967-68 CAMARO w/ AC CNTRL PNL

REMOVING OEM CONTROL PANEL

- REMOVE THE (4) OEM MOUNTING SCREWS FROM DASH BEZEL UNDER THE DASH. SEE FIGURE 1 BELOW.
- REMOVE CONTROL PANEL.
- DISCONNECT CABLES AND WIRES FROM BACK OF CONTROL PANEL.

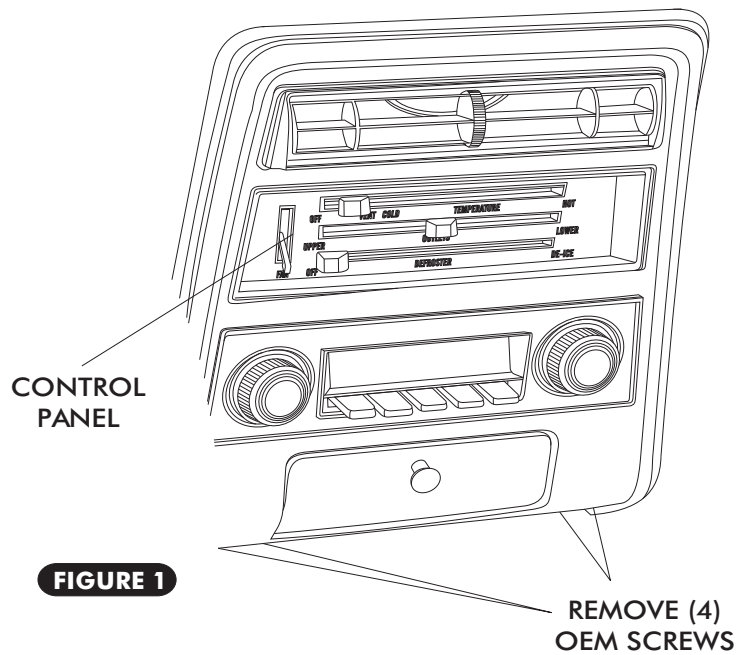

FIGURE 1

PLACARD INSTALLATION

- REMOVE LEVER KNOBS.
- REMOVE THE (4) CONTROL PANEL FACE PLATE MOUNTING RIVETS. USE A 9/64 DRILL BIT TO DRILL OUT RIVETS.
- REMOVE OEM PLACARD FROM CONTROL PANEL.
- INSTALL MODE LABEL ON FRONT SIDE OF OEM PLACARD.
- INSTALL PLACARD AND CONTROL PANEL FACE PLATE. SECURE CONTROL PANEL FACE PLATE TO CONTROL PANEL USING (4) #6 x 3/8 PH PAN HEAD SCREWS.
- RE-INSTALL KNOBS.

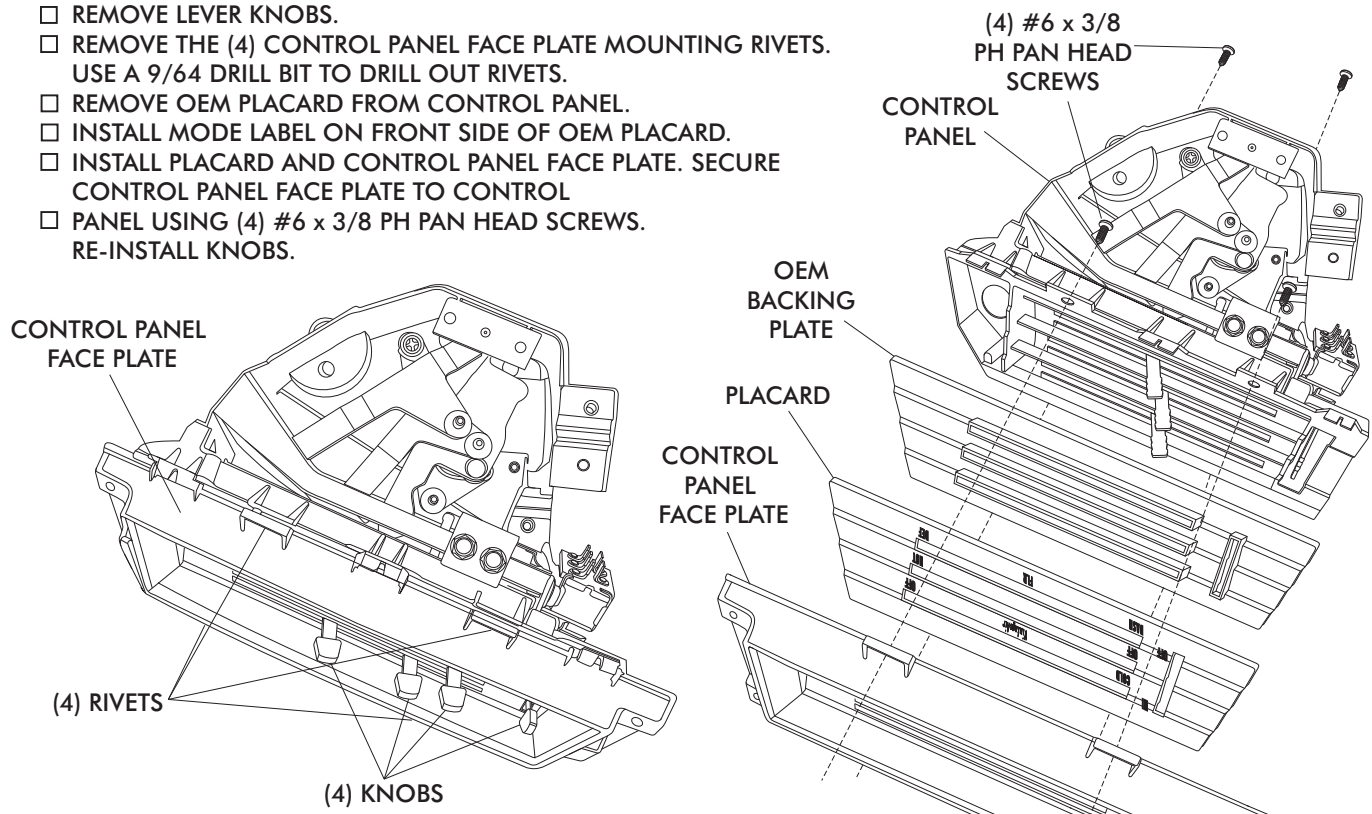
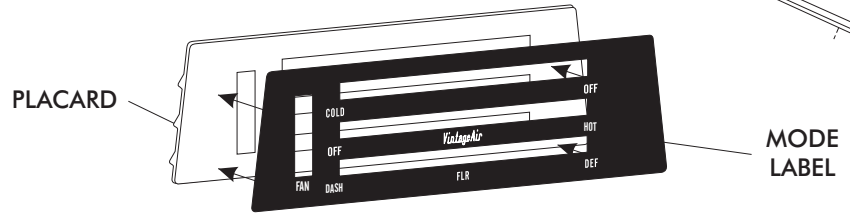

FIGURE 2





SLIDE POT ASSEMBLY MODIFICATIONS

- LOCATE THE THREE SLIDE POT ASSEMBLIES, AND USING A PAIR OF WIRE CUTTERS, CUT SLIDE POT ACTUATOR RODS AS SHOWN BELOW IN FIGURE 3.

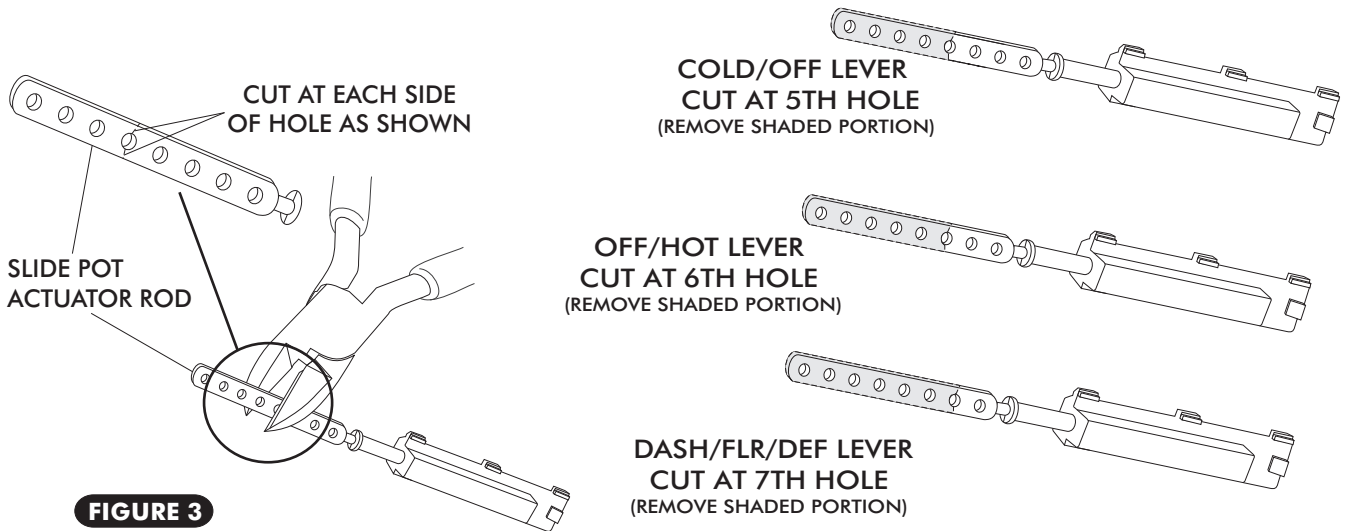

FIGURE 3

SLIDE POT ASSEMBLY MOUNTING CLAMP INSTALLATION

- INSTALL SLIDE POT ASM MOUNTING CLAMPS, SEE FIGURE 4 BELOW.

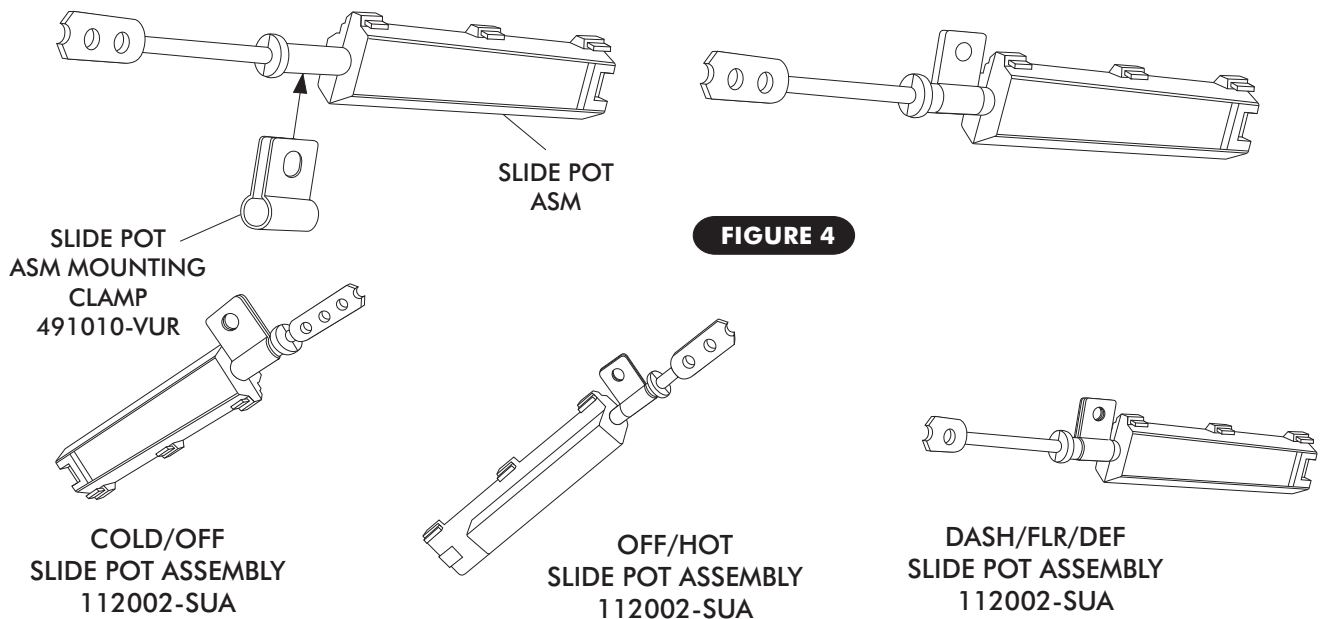

FIGURE 4

ORIENT SLIDE POT ASSEMBLIES AS SHOWN AND INSTALL MOUNTING CLAMPS AS SHOWN. (NOTE: ORIENT CLAMPS IN RELATION TO THE (3) HOUSING SNAPS ON SLIDE POT ASSEMBLY)



SLIDE POT ASSEMBLY INSTALLATION

DASH/FLR/DEF SLIDE POT ASSEMBLY

TURN CONTROL PANEL OVER, BOTTOM SIDE FACING UP

- INSTALL SLIDE POT ASM ON THE DASH/FLR/DEF LEVER. SEE FIGURE 5 BELOW.
- INSTALL SLIDE POT LEVER PUSH ROD ONTO OEM CABLE MOUNTING STUD ON LEVER. SEE FIGURE 5 BELOW.
- SECURE THE SLIDE POT ASM TO THE CONTROL PANEL USING THE OEM SCREW IN THE OEM CABLE CLAMP MOUNTING LOCATION. SEE FIGURE 5 BELOW.
- SINCE THE SLIDE POT ASSEMBLY CAN SLIDE BACK AND FORTH IN CLAMP BEFORE SCREW IS TIGHTENED, POSITION SLIDE POT ASSEMBLY SUCH THAT THE FLAT PART OF THE ROD IS AS CLOSE TO FLUSH AS POSSIBLE WITH THE END OF HOUSING AT THE LEVER'S INNER MOST POSITION. SEE FIGURE 5 BELOW.
- SECURE SLIDE POT LEVER PUSH ROD ONTO OEM CABLE MOUNTING STUD USING 3/16" PUSH-ON RING AS SHOWN IN FIGURE 5 BELOW.

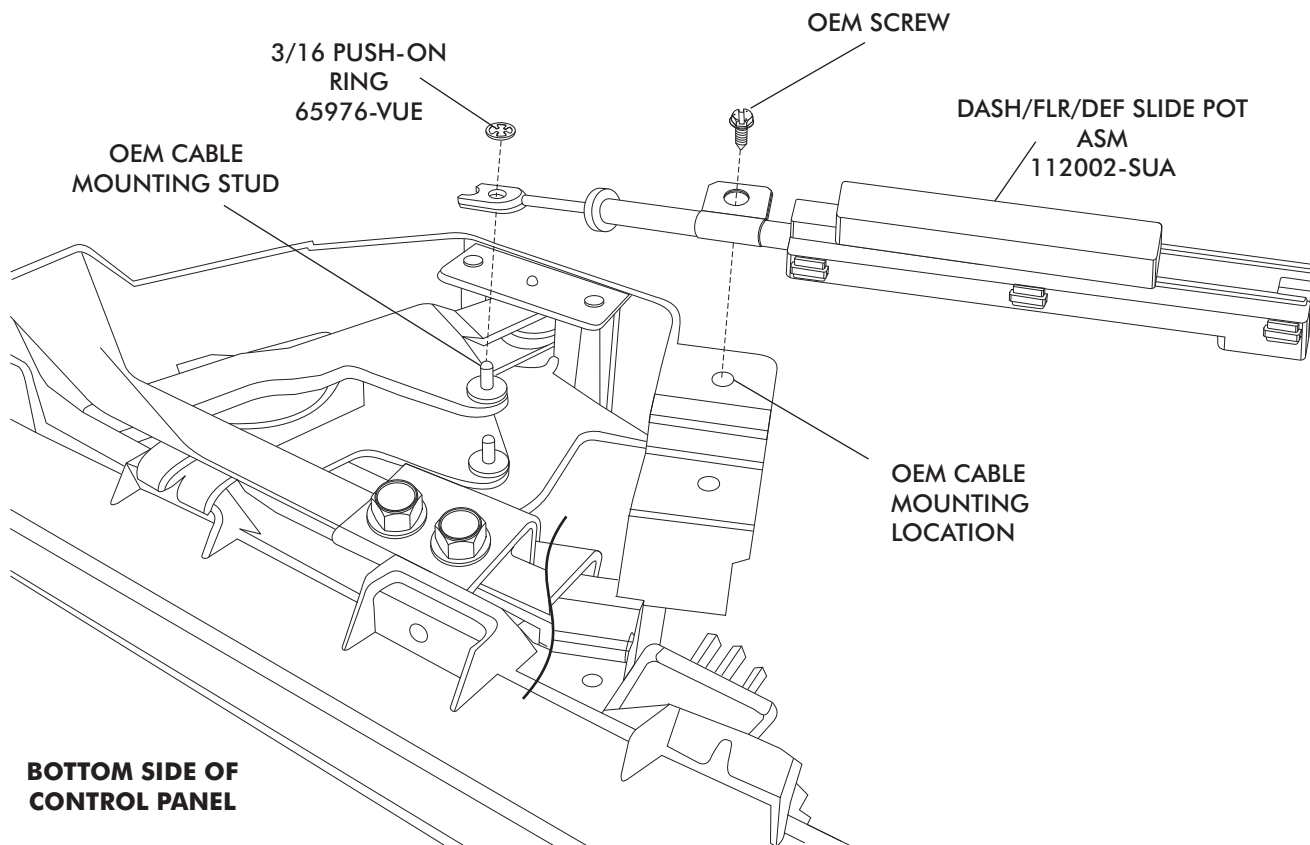

BOTTOM SIDE OF CONTROL PANEL

FIGURE 5

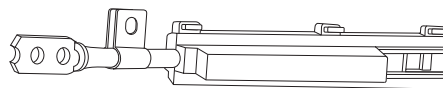
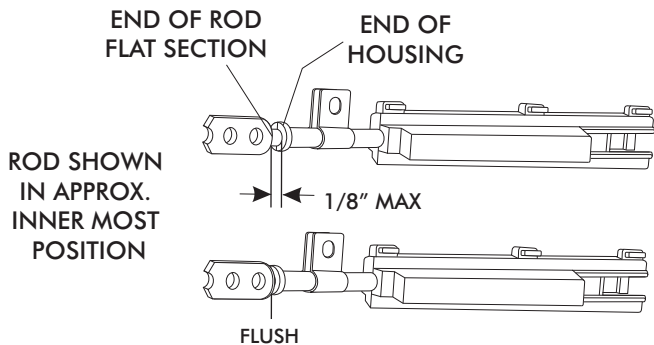

NOTE: DO NOT ALLOW ROD TO SEPARATE HOUSING WHEN ROD IS IN INNER MOST POSITION.



SLIDE POT ASSEMBLY INSTALLATION CONT.

- LOCATE THE CONTROL PANEL WIRE HARNESS AND PLUG THE CORRESPONDING WIRES INTO THE CORRECT SLIDE POT ASSEMBLY AS SHOWN IN FIGURE 5a BELOW.

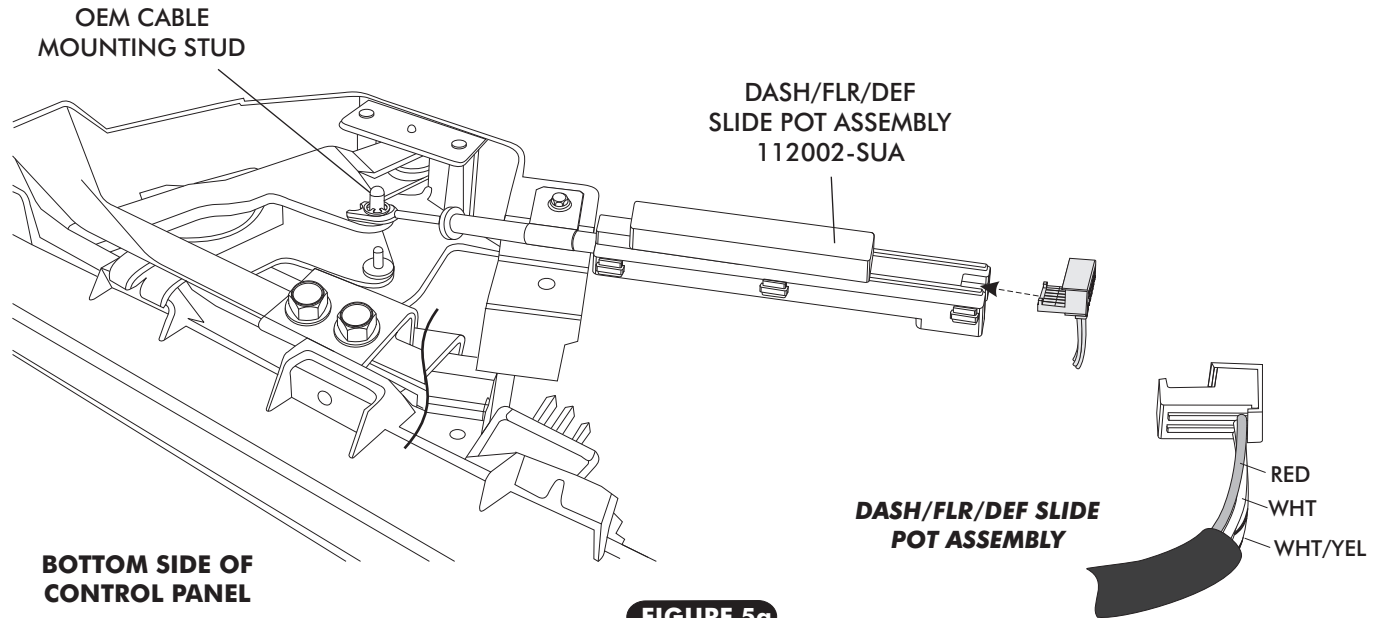

FIGURE 5a

- ONCE WIRES ARE CORRECTLY PLUGGED INTO SLIDE POT ASSEMBLY, SECURE WIRES TO THE SLIDE POT ASSEMBLY USING TIE WRAPS (SUPPLIED). SEE FIGURE 5b BELOW. THE TIE WRAP MUST BE LOCATED BETWEEN THE END OF THE WIRE JACKET AND THE STEP IN THE SLIDE POT HOUSING FORCING A BEND IN EACH WIRE AS THEY PASS OVER THE STEP IN SLIDE POT HOUSING. HEAD OF TIE WRAP MUST FALL ON EDGE OF HOUSING AS SHOWN TO REMAIN TIGHT. ENSURE THAT THE TIE WRAPS ARE SNUG ENOUGH THAT THE WIRES CANNOT MOVE. SEE FIGURE 5b.

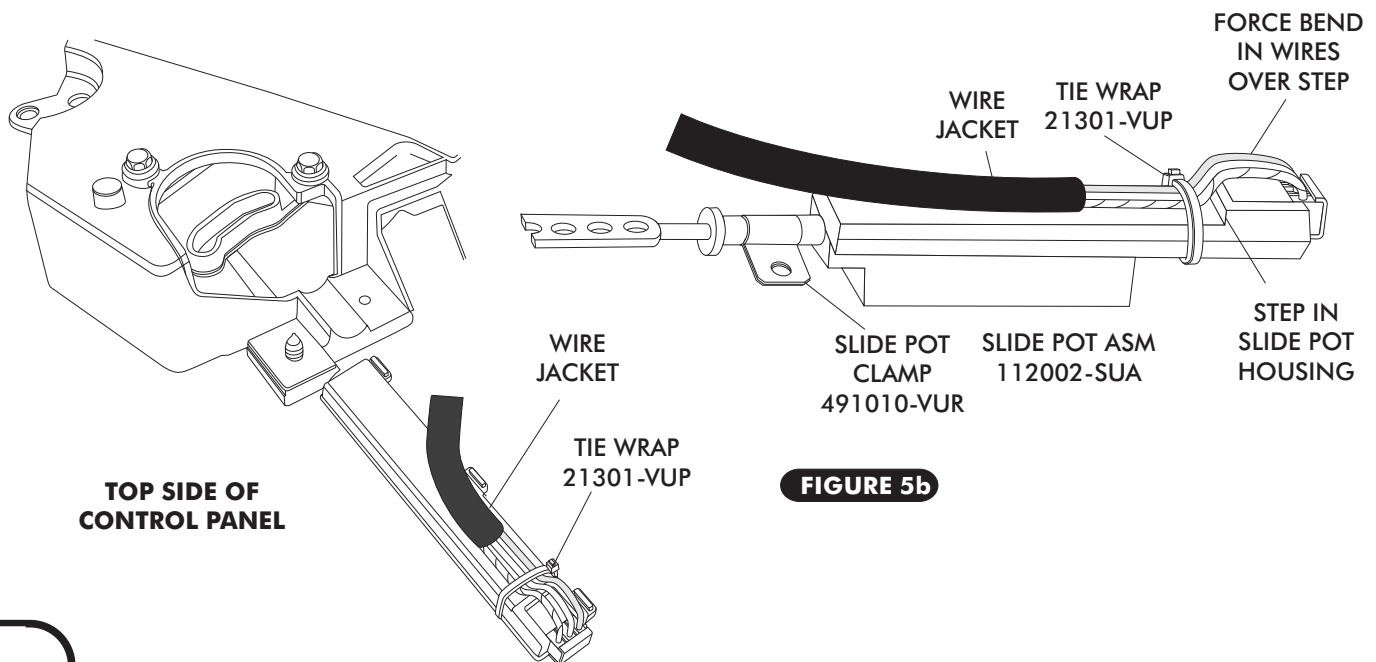

FIGURE 5b



SLIDE POT ASSEMBLY INSTALLATION CONT.

OFF/HOT SLIDE POT ASSEMBLY

- INSTALL SLIDE POT ASM ON THE OFF/HOT LEVER. SEE FIGURE 6 BELOW.
- INSTALL SLIDE POT LEVER PUSH ROD ONTO OEM CABLE MOUNTING STUD ON LEVER. SEE FIGURE 6 BELOW.
- SECURE THE SLIDE POT ASM TO THE CONTROL PANEL USING THE OEM SCREW IN THE OEM CABLE CLAMP MOUNTING LOCATION. SEE FIGURE 6 BELOW.
- SINCE THE SLIDE POT ASSEMBLY CAN SLIDE BACK AND FORTH IN CLAMP BEFORE SCREW IS TIGHTENED, POSITION SLIDE POT ASSEMBLY SUCH THAT THE FLAT PART OF THE ROD IS AS CLOSE TO FLUSH AS POSSIBLE WITH THE END OF HOUSING AT THE LEVER'S INNER MOST POSITION. SEE FIGURE 5 PAGE 6.
- SECURE SLIDE POT LEVER PUSH ROD ONTO OEM CABLE MOUNTING STUD USING 3/16" PUSH-ON RING AS SHOWN IN FIGURE 6 BELOW.

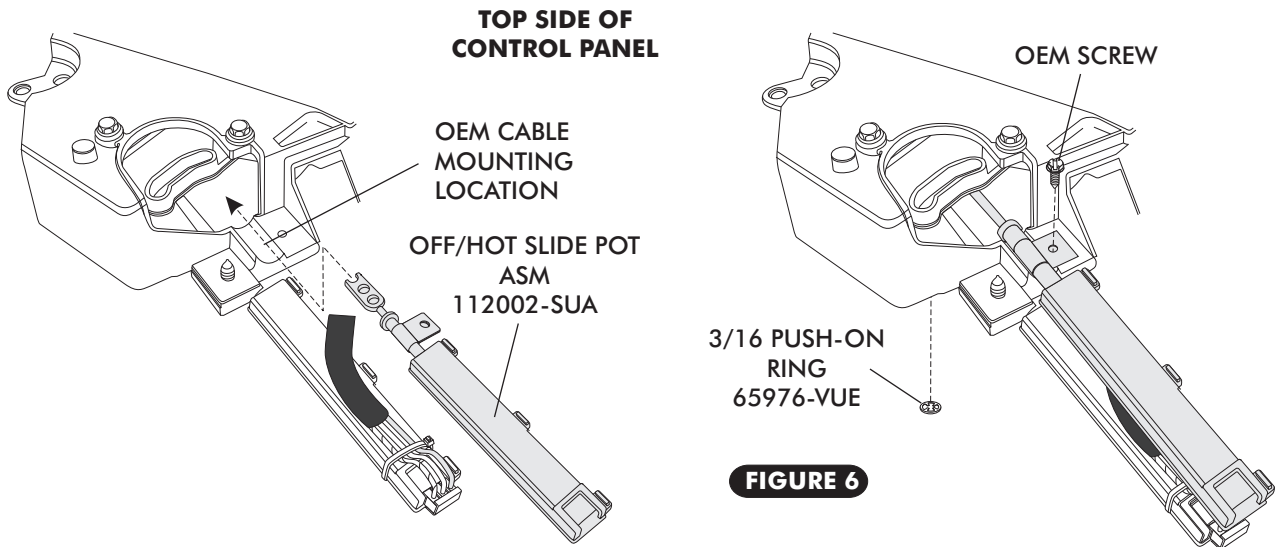

FIGURE 6

- LOCATE THE CONTROL PANEL WIRE HARNESS AND PLUG THE CORRESPONDING WIRES INTO THE CORRECT SLIDE POT ASSEMBLY AS SHOWN IN FIGURE 6a BELOW.

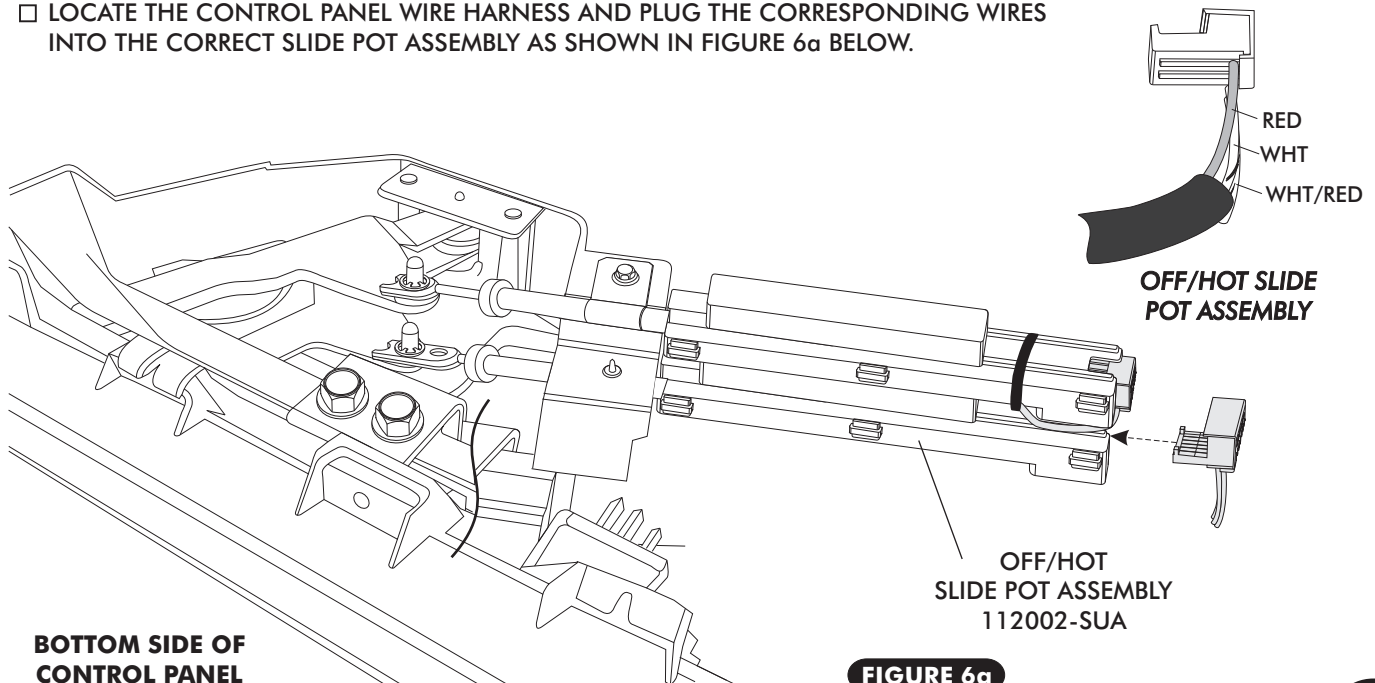

FIGURE 6a



SLIDE POT ASSEMBLY INSTALLATION CONT.

- ONCE WIRES ARE CORRECTLY PLUGGED INTO SLIDE POT ASSEMBLY, SECURE WIRES TO THE SLIDE POT ASSEMBLY USING TIE WRAPS (SUPPLIED). SEE FIGURE 6b BELOW. THE TIE WRAP MUST BE LOCATED BETWEEN THE END OF THE WIRE JACKET AND THE STEP IN THE SLIDE POT HOUSING FORCING A BEND IN EACH WIRE AS THEY PASS OVER THE STEP IN SLIDE POT HOUSING. HEAD OF TIE WRAP MUST FALL ON EDGE OF HOUSING AS SHOWN TO REMAIN TIGHT. ENSURE THAT THE TIE WRAPS ARE SNUG ENOUGH THAT THE WIRES CANNOT MOVE. SEE FIGURE 6b.

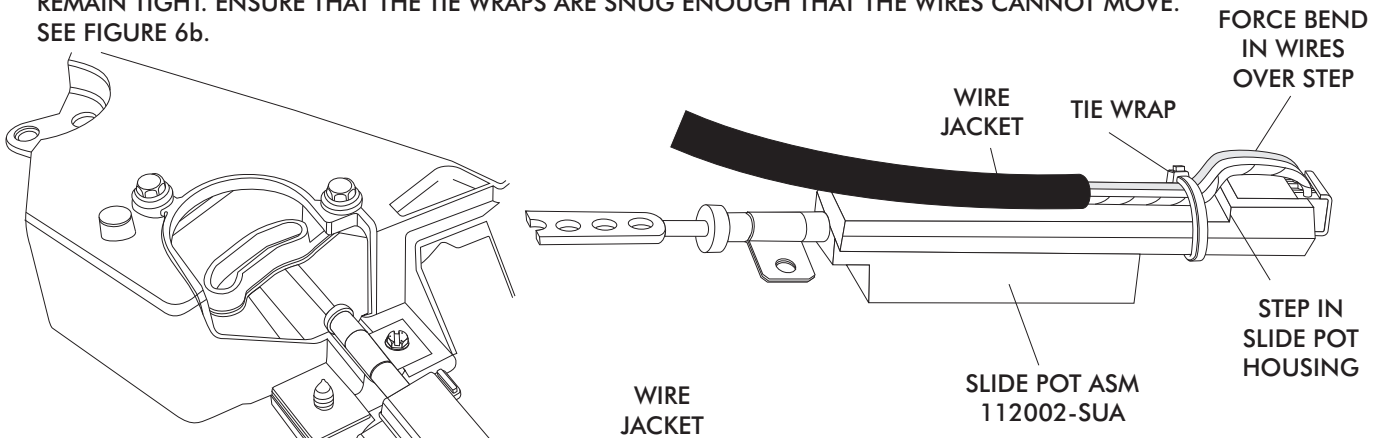
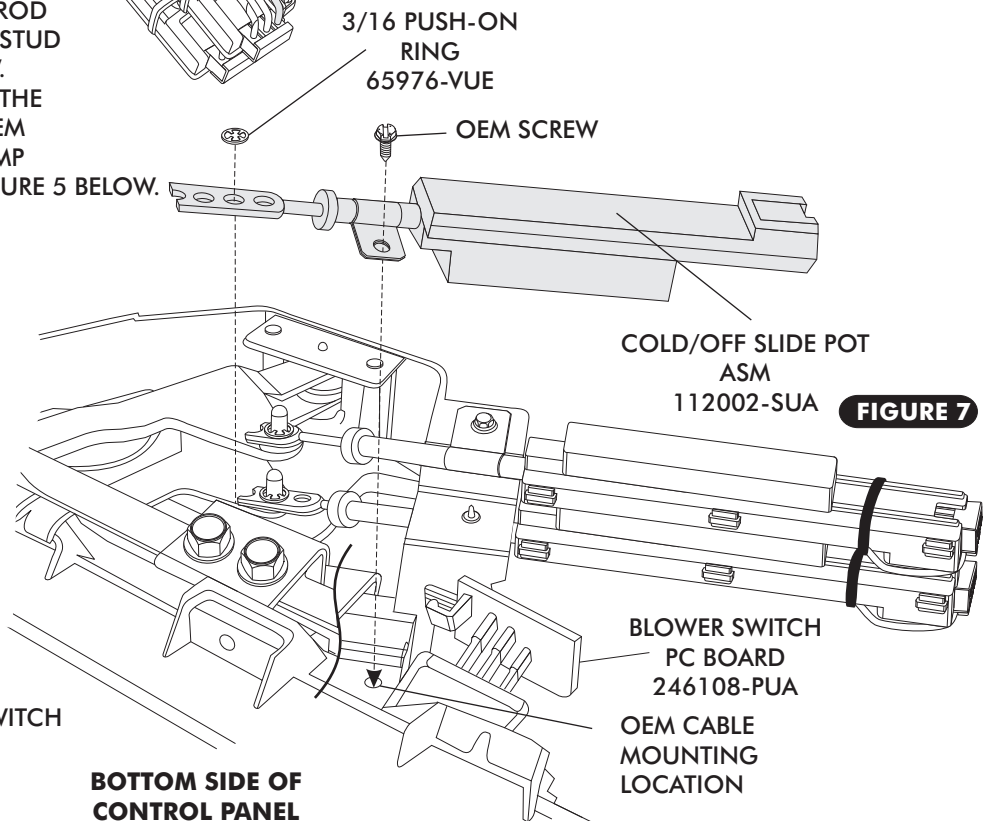

FIGURE 6b

COLD/OFF SLIDE POT ASSEMBLY & OFF/ HI BLOWER SWITCH INSTALLATION

- INSTALL SLIDE POT ASM ON THE COLD/OFF LEVER. SEE FIGURE 7 BELOW.
- INSTALL SLIDE POT LEVER PUSH ROD ONTO OEM CABLE MOUNTING STUD ON LEVER. SEE FIGURE 7 BELOW.
- SECURE THE SLIDE POT ASM TO THE CONTROL PANEL USING THE OEM SCREW IN THE OEM CABLE MOUNTING LOCATION. SEE FIGURE 5 BELOW.
- SINCE THE SLIDE POT ASSEMBLY CAN SLIDE BACK AND FORTH IN CLAMP BEFORE SCREW IS TIGHTENED, POSITION SLIDE POT ASSEMBLY SUCH THAT THE FLAT PART OF THE ROD IS AS CLOSE TO FLUSH AS POSSIBLE WITH THE END OF HOUSING AT THE LEVER'S INNER MOST POSITION. SEE FIGURE 5, PAGE 6
- SECURE SLIDE POT LEVER PUSH ROD ONTO OEM CABLE MOUNTING STUD USING 3/16" PUSH-ON RING AS SHOWN IN FIGURE 7 BELOW.
- INSTALL THE BLOWER SWITCH PC BOARD ON OEM BLOWER SWITCH AS SHOWN IN FIGURE 7 BELOW



BOTTOM SIDE OF CONTROL PANEL

CONTROL HARNESS

- LOCATE THE CONTROL PANEL WIRE HARNESS AND PLUG THE CORRESPONDING WIRES INTO THE CORRECT SLIDE POT ASSEMBLY AND PLUG THE CORRESPONDING WIRES INTO THE PC BOARD ON BLOWER SWITCH. SEE FIGURE 7a BELOW.

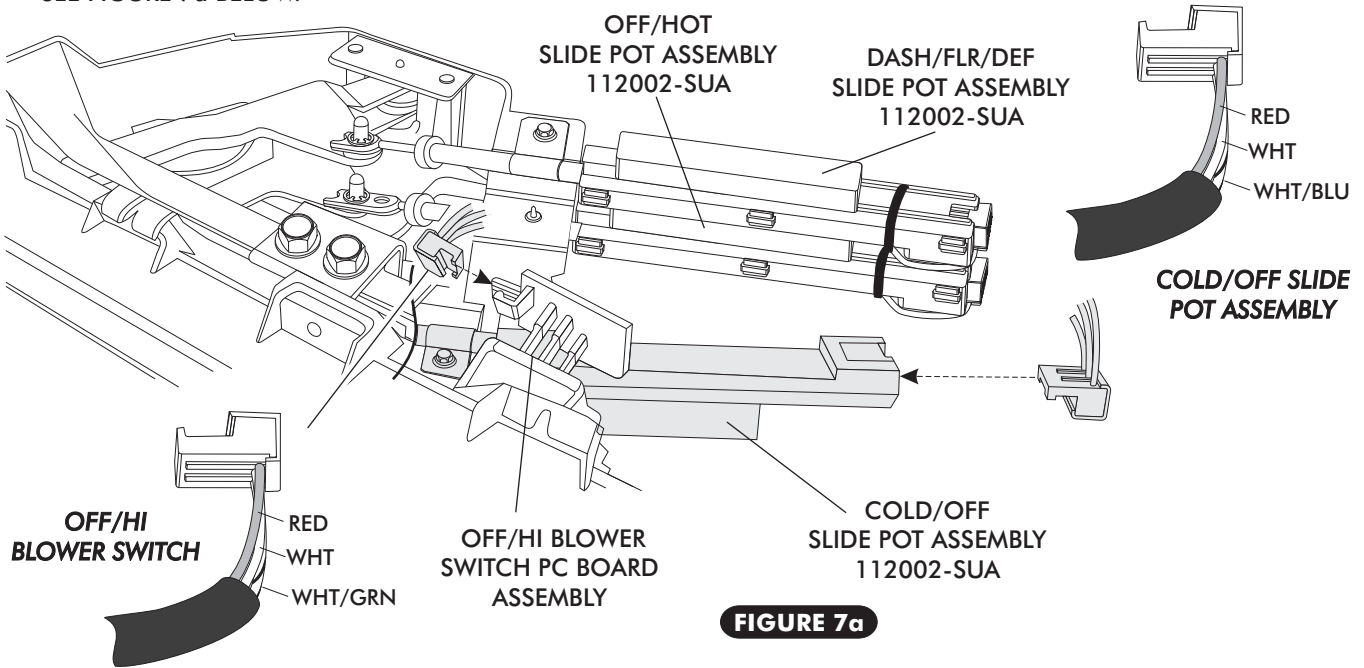

- ONCE WIRES ARE CORRECTLY PLUGGED INTO SLIDE POT ASSEMBLY, SECURE WIRES TO THE SLIDE POT ASSEMBLY USING TIE WRAPS (SUPPLIED). SEE FIGURE 7b BELOW. THE TIE WRAP MUST BE LOCATED BETWEEN THE END OF THE WIRE JACKET AND THE STEP IN THE SLIDE POT HOUSING FORCING A BEND IN EACH WIRE AS THEY PASS OVER THE STEP IN SLIDE POT HOUSING. HEAD OF TIE WRAP MUST FALL ON EDGE OF HOUSING AS SHOWN TO REMAIN TIGHT. ENSURE THAT THE TIE WRAPS ARE SNUG ENOUGH THAT THE WIRES CANNOT MOVE. FORCE BEND IN WIRES OVER STEP. SEE FIGURE 7b.

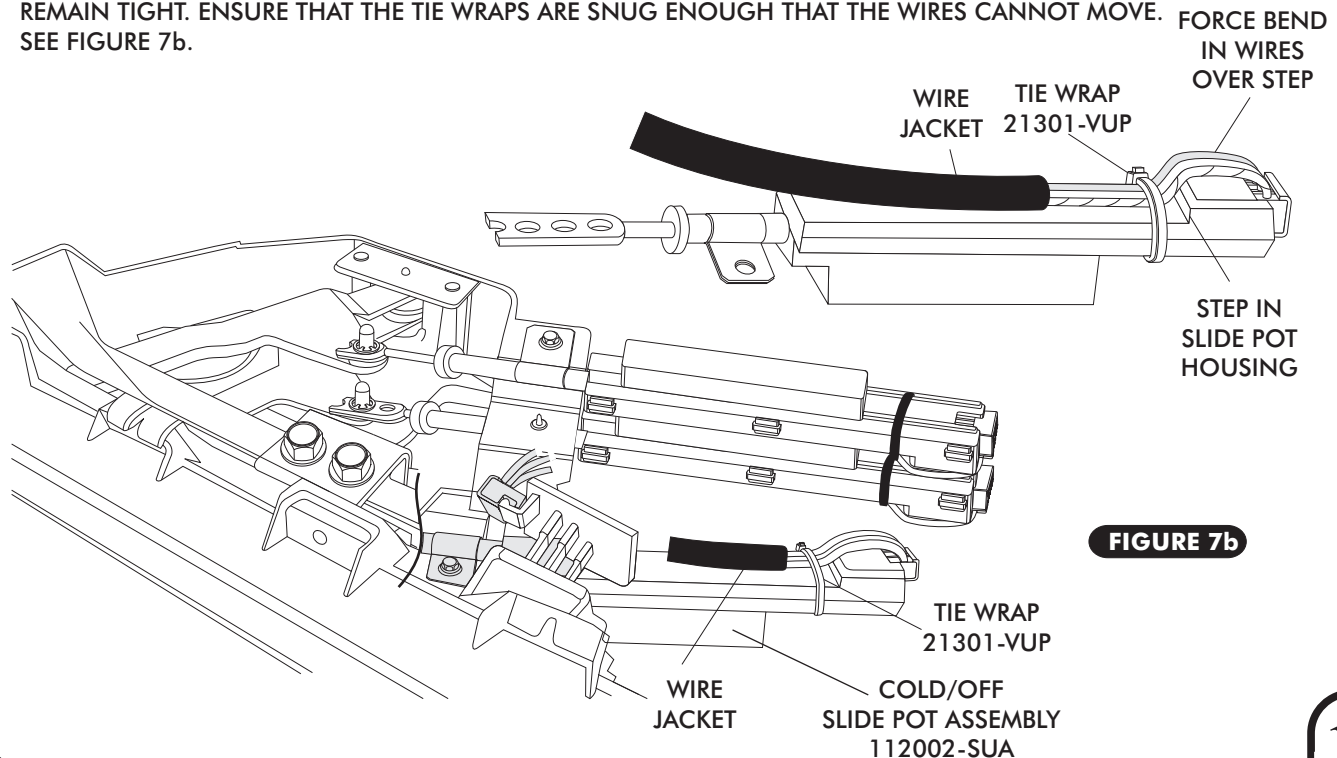



FINAL STEPS

- USING THE SUPPLIED TIE-WRAPS, TIE THE WIRES TO THE CONTROL PANEL AS SHOWN IN FIGURE 8 BELOW. . CONFIRM THAT WIRES ARE SECURE AND DO NOT INTERFERE WITH LEVER OPERATION OR SLIDE POT ASSEMBLY.
- INSTALL CONTROL PANEL IN DASH. TO EASE INSTALLATION, ROTATE CONTROL PANEL SLIGHTLY AND PASS THE SLIDE POT ASSEMBLIES THROUGH DASH OPENING FIRST. AS THE SLIDE POT ASSEMBLIES PASS THROUGH THE DASH OPENING ROTATE THE CONTROL PANEL BACK THE OPPOSITE DIRECTION TO FIT CONTROL PANEL IN DASH. **NOTE: MAKE SURE SLIDE POT ASSEMBLIES CLEAR DUCT HOSE BEHIND THE LEFT SIDE OF DASH OPENING. DO NOT FORCE THE CONTROL PANEL IN DASH, FORCING THE CONTROL PANEL IN DASH WILL DAMAGE SLIDE POT ASSEMBLIES AND/OR DUCT HOSE.**
- PLUG THE WIRING HARNESS INTO THE ECU MODULE ON SUB CASE. SEE FIGURE 8 BELOW.
- WIRE ACCORDING TO WIRING DIAGRAM ON PAGE 13.
- CALIBRATION PROCEDURE AND OPERATION INSTRUCTIONS:

CALIBRATING THE CONTROL PANEL WILL SET THE RANGE OF TRAVEL FOR THE SLIDE POTS CONNECTED TO THE OEM CONTROL PANEL LEVERS. PERFORMING THIS PROCEDURE WILL SET THE LIMITS OF THE SLIDE POTS AT THEIR HIGHEST AND LOWEST POINTS

LOCATE THE GRAY WIRE WITH AN UNUSED CONNECTOR IN THE WIRING HARNESS NEAR THE TWO CABLE HARNESS RELAYS. THIS WIRE IS LABELED PRGM ON THE WIRING DIAGRAM ON PAGE 13.

IT WILL BE NECESSARY TO GROUND THE GRAY WIRE FOR APPROXIMATELY FIVE SECONDS WHILE MOVING THE CONTROLS SO IT IS SOMETIMES HELPFUL TO ATTACH ONE END OF THE WHITE JUMPER WIRE TO THE VEHICLE'S GROUND (FOR EXAMPLE THE CHASSIS) AND HAVE THE OTHER END READY TO CONNECT TO THE GRAY PRGM WIRE WHEN THE PROCEDURE REQUIRES IT.

TO CALIBRATE THE CONTROL PANEL FOLLOW THE CALIBRATION PROCEDURES ON PAGE 12.

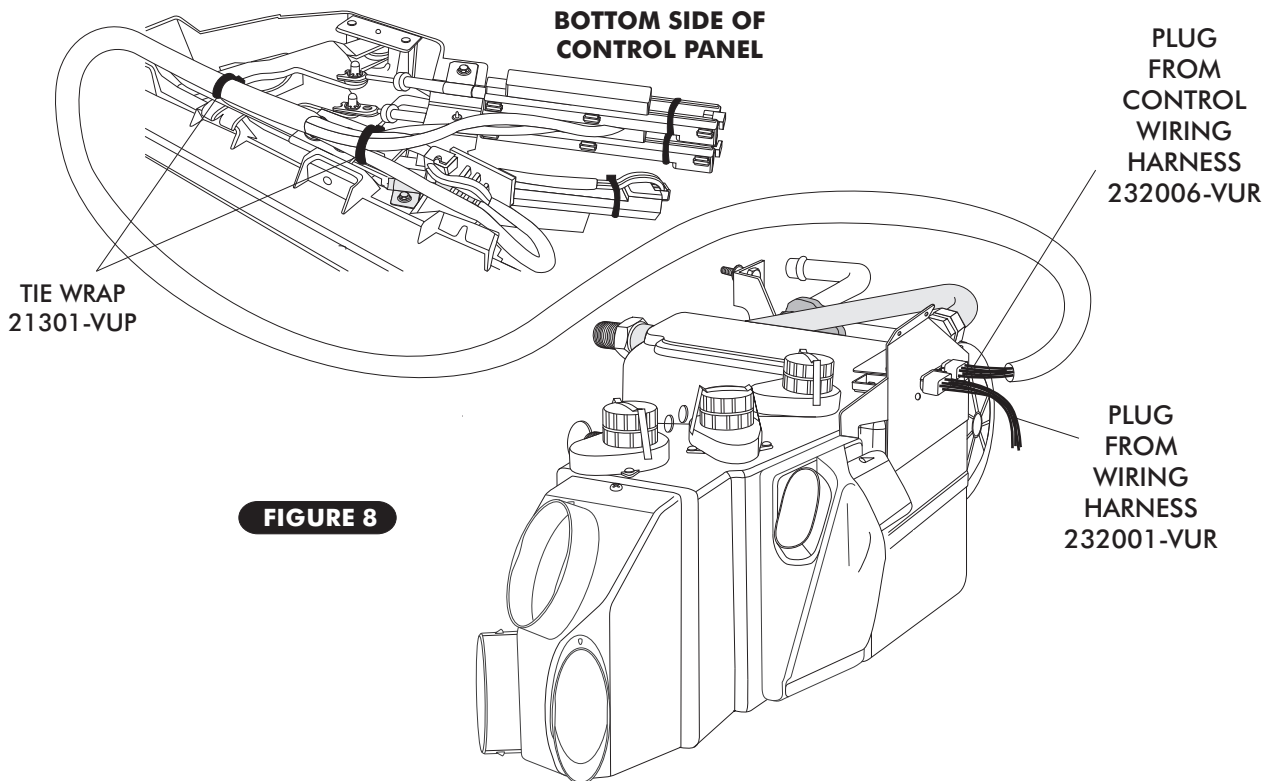



CONTROL PANEL CALIBRATION PROCEDURE

1. TURN THE IGNITION SWITCH ON (DO NOT START THE ENGINE)
2. CONNECT THE WHITE JUMPER WIRE TO VEHICLE'S GROUND (FOR EXAMPLE THE VEHICLE CHASSIS). ENSURE THAT THE GRAY WIRE IS NOT GROUNDED. DO NOT CONNECT JUMPER WIRE TO THE GRAY PRGM WIRE. SEE FIGURE A, BELOW.

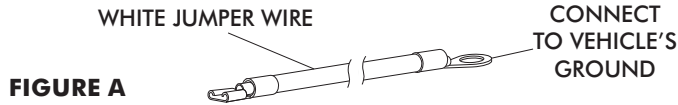

FIGURE A

3. MOVE ALL OF THE CONTROL LEVERS TO THEIR MAXIMUM POSITIONS, AS SHOWN IN FIGURE B, BELOW.

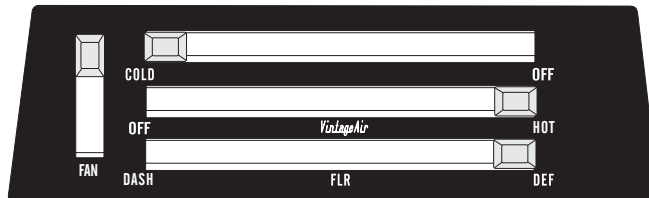

FIGURE B

4. GROUND THE GRAY WIRE BY CONNECTING THE GRAY PRGM WIRE & WHITE JUMPER WIRE FOR APPROXIMATELY 5 SECONDS (THE BLOWER WILL CHANGE SPEEDS WHEN STEP FOUR IS COMPLETE). SEE FIGURE C, BELOW.

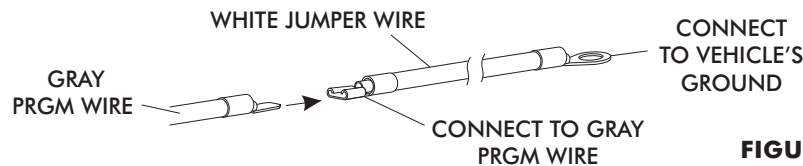

FIGURE C

5. LEAVING THE GRAY WIRE GROUNDED, MOVE ALL OF THE CONTROL LEVERS TO THEIR MINIMUM POSITIONS AS SHOWN IN FIGURE D BELOW.

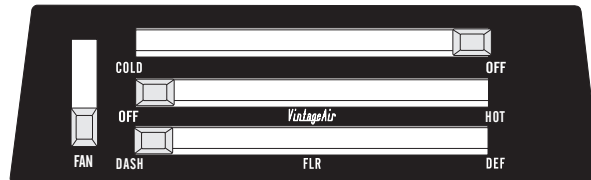

FIGURE D

6. DISCONNECT THE GRAY WIRE FROM THE WHITE GROUND JUMPER WIRE (THE BLOWER WILL CHANGE SPEEDS WHEN STEP SIX IS COMPLETE). SEE FIGURE E, BELOW.

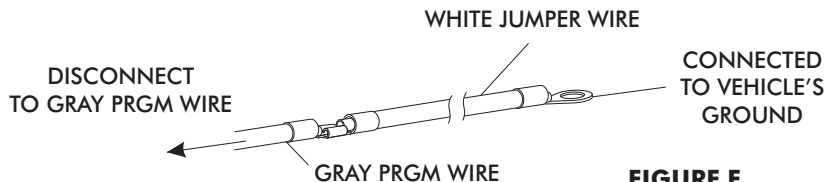

FIGURE E

7. START THE ENGINE AND TEST ALL OF THE CONTROLS TO ENSURE THAT THE INTENDED RESULTS WERE ACCOMPLISHED.
8. DISCONNECT THE WHITE JUMPER WIRE FROM VEHICLE'S GROUND.

NOTE: THIS PROCEDURE MAY BE REPEATED IF NECESSARY.

*** WHEN FINISHED, TAPE OVER PROGRAM WIRE CONNECTOR WITH ELECTRICAL TAPE TO PREVENT ACCIDENTAL CONTACT WITH CHASSIS GROUND.**



1967-68 CAMARO w/ AC CNTRL PNL

WIRING DIAGRAM

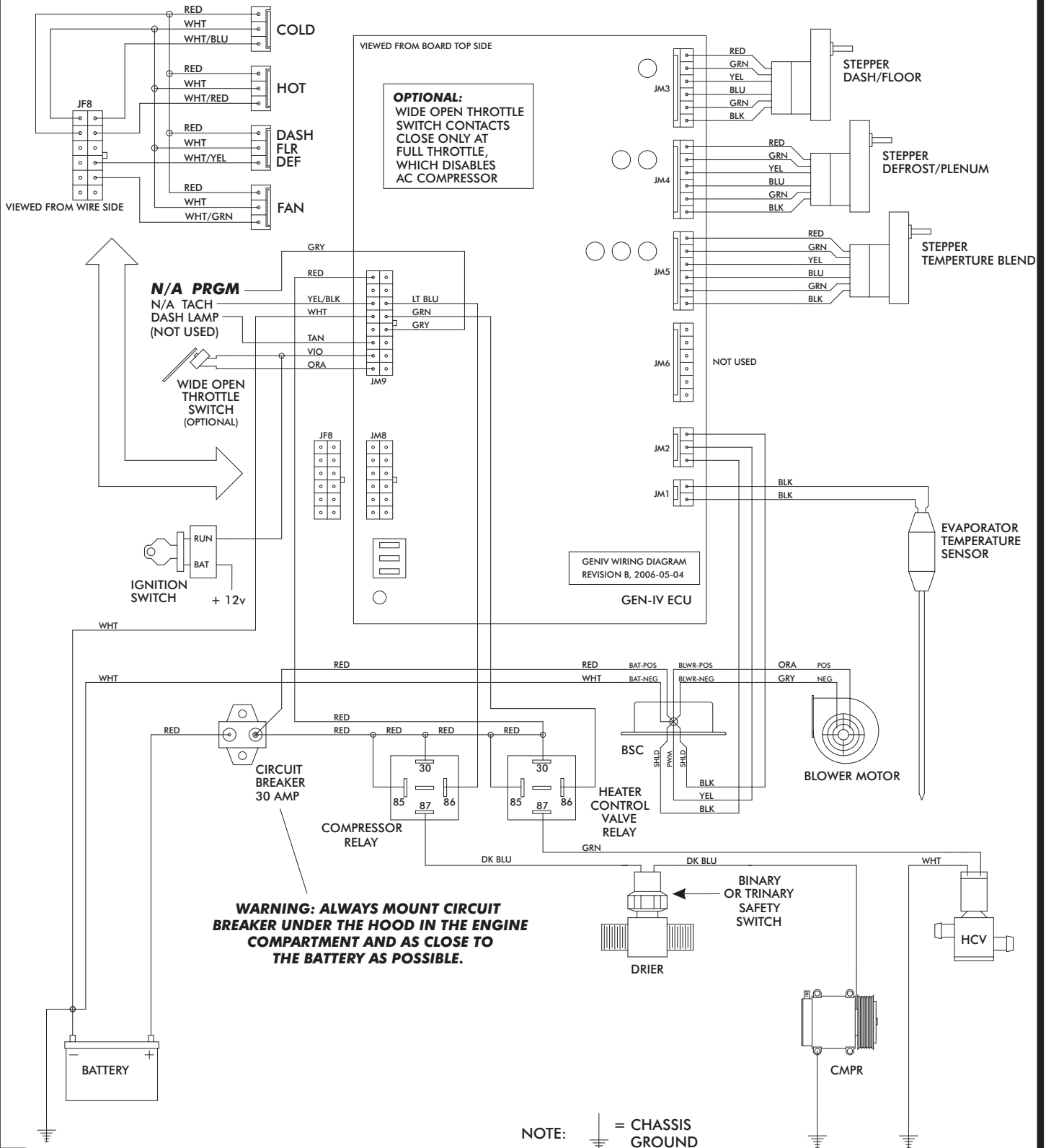



OPERATION OF CONTROLS

NOTE: WHEN BATTERY POWER IS FIRST CONNECTED TO THE ECU, THE COMPUTER GOES THROUGH AN INITIALIZATION SEQUENCE. THIS INITIALIZATION MAY TAKE UP TO 30 SECONDS. DURING INITIALIZATION THE BLOWER WILL NOT OPERATE, BUT THE DOORS INSIDE THE UNIT WILL BE OPERATING. A LOW BATTERY OR DISCONNECTING THE BATTERY MAY ALSO TRIGGER A RE-INITIALIZATION. DURING START UP, A LOW BATTERY MAY DROP BELOW 7 VOLTS, TRIGGERING RE-INITIALIZATION.

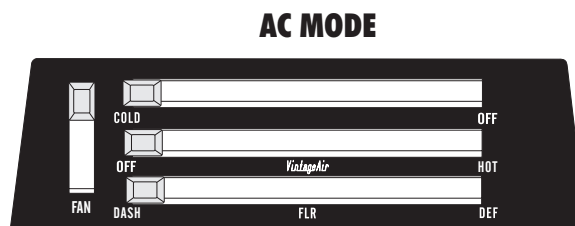
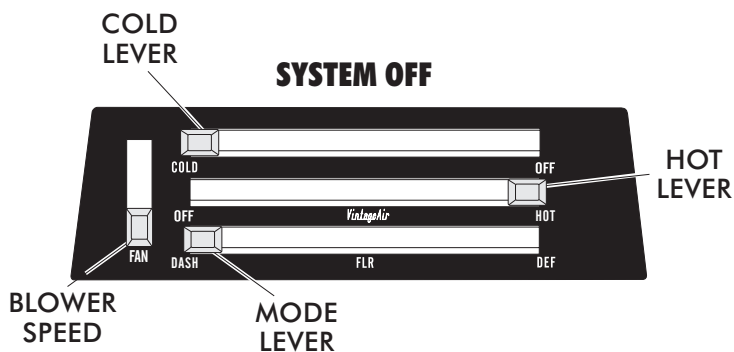

BLOWER SPEED

THIS LEVER CONTROLS THE BLOWER SPEED, FROM OFF TO HI

COLD LEVER

IN A/C MODE SLIDE THE COLD LEVER ALL THE WAY LEFT TO THE COLD POSITION, FOR MAXIMUM COOLING (SLIDE LEVER LEFT OR RIGHT TO ADJUST DESIRED TEMPERATURE)

HOT LEVER

IN HEAT MODE SLIDE THE HOT LEVER ALL THE WAY RIGHT TO THE HOT POSITION, FOR MAXIMUM HEATING (SLIDE LEVER LEFT OR RIGHT TO ADJUST DESIRED TEMPERATURE)

MODE LEVER

SLIDE THE LEVER TO THE "DASH" POSITION

BLOWER SPEED

SLIDE THE LEVER UP TO DESIRED BLOWER SPEED, FROM OFF TO HI

COLD LEVER

IN A/C MODE SLIDE THE COLD LEVER ALL THE WAY LEFT TO THE COLD POSITION, TO ENGAGE COMPRESSOR. FOR MAXIMUM COOLING (SLIDE LEVER LEFT OR RIGHT TO ADJUST DESIRED TEMPERATURE)

HOT LEVER

IN AC MODE SLIDE THE HOT LEVER ALL THE LEFT TO THE OFF POSITION

MODE LEVER

SLIDE THE LEVER TO THE "DASH" POSITION

HEAT MODE

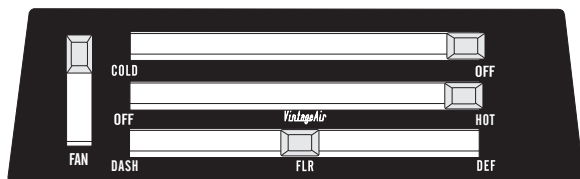

BLOWER SPEED

SLIDE THE LEVER UP TO DESIRED BLOWER SPEED, FROM OFF TO HI

COLD LEVER

IN HEAT MODE SLIDE THE COLD LEVER ALL THE WAY RIGHT TO THE OFF POSITION

HOT LEVER

IN HEAT MODE SLIDE THE HOT LEVER ALL THE WAY RIGHT TO THE HOT POSITION, FOR MAXIMUM HEATING (SLIDE LEVER LEFT OR RIGHT TO ADJUST DESIRED TEMPERATURE)

MODE LEVER

SLIDE THE LEVER TO THE "FLR" POSITION

DEFROST/ DE-FOG MODE



BLOWER SPEED

SLIDE THE LEVER UP TO DESIRED BLOWER SPEED, FROM OFF TO HI

COLD LEVER

IN DEFROST MODE SLIDE THE COLD LEVER ALL THE WAY LEFT TO THE COLD POSITION, TO ENGAGE COMPRESSOR. FOR MAXIMUM COOLING (SLIDE LEVER LEFT OR RIGHT TO ADJUST DESIRED TEMPERATURE)

HOT LEVER

IN DEFROST MODE SLIDE THE HOT LEVER ALL THE RIGHT TO THE HOT POSITION, FOR MAXIMUM HEATING (SLIDE LEVER LEFT OR RIGHT TO ADJUST DESIRED TEMPERATURE)

MODE LEVER

SLIDE THE LEVER TO THE "DEF" POSITION



1967-68 CAMARO w/ AC CNTRL PNL

CONTROL KIT 474167

CONTROL KIT PACKING LIST

No.	QTY.	PART No.	DESCRIPTION	
1.	1	484167	1967-68 CAMARO w/ AC CNTRL PNL MODE LABEL	_____
2.	3	112002-SUA	SLIDE POT ASM	_____
3.	1	232006-VUR	GEN IV UNIVERSAL CONTROL HARNESS (TYPE B)	_____
4.	3	65976-VUE	3/16" PUSH-ON RING	_____
5.	3	491010-VUR	SLIDE POT CLAMP	_____
6.	5	21301-VUP	4" TIE WRAP	_____
7.	1	23140-VUW	GROUND WIRE	_____
8.	1	246108-PUA	BLOWER SWITCH PC BOARD	_____

CHECKED BY: _____
 PACKED BY: _____
 DATE: _____

