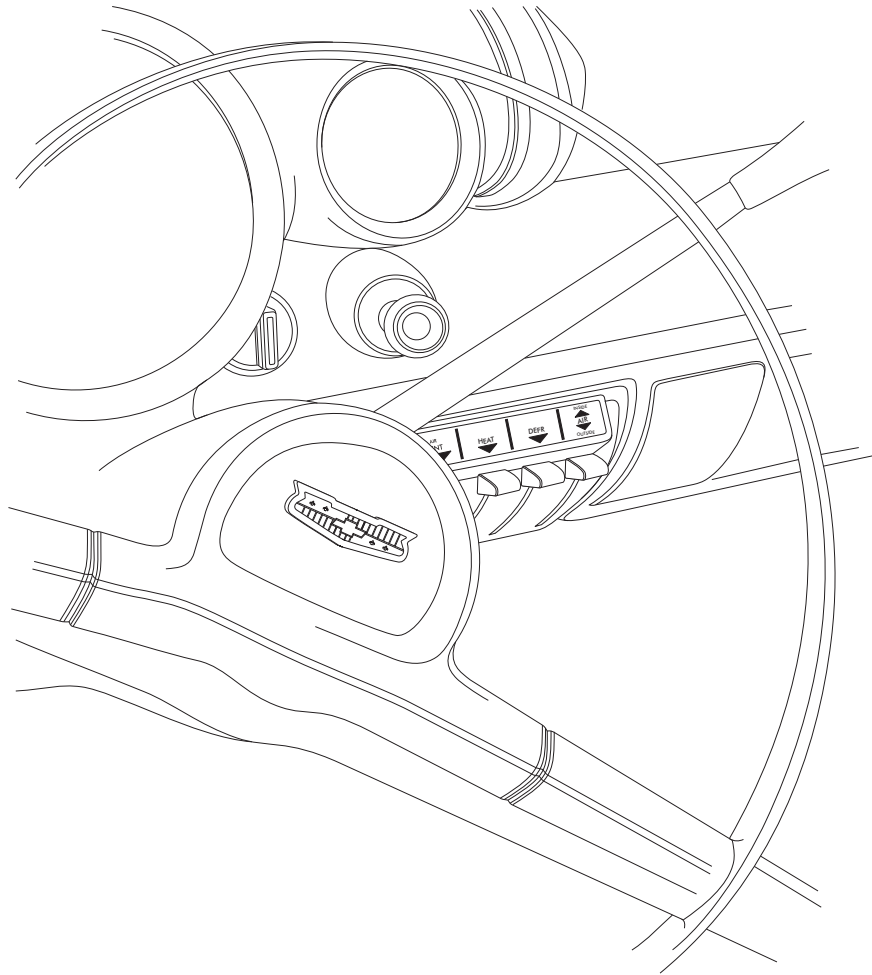




# 1957 CHEVY

w/o AC CONTROL PANEL  
CONVERSION KIT  
**472057**



18865 GOLL ST. - SAN ANTONIO, TX. - 78266 ph.210-654-7171 - fax 210-654-3113



## ***Table of Contents***

### PAGES

1. COVER
2. TABLE OF CONTENTS
3. PACKING LIST/ PARTS DISCLAIMER
4. REMOVING OEM CONTROL PANEL  
SLIDE POT MODIFICATIONS
5. SLIDE POT ASM MOUNTING CLAMP INSTALLATION  
PLACARD INSTALLATION
6. BLOWER SWITCH INSTALLATION & SLIDE POT ASM INSTALLATION  
(DASH/FLR/DEF SLIDE POT ASM)
7. CONTROL HARNESS
8. COLD/OFF SLIDE POT ASM INSTALLATION  
CONTROL HARNESS
9. CONTROL HARNESS CONT.  
OFF/HEAT SLIDE POT ASM INSTALLATION
10. CONTROL HARNESS
11. BLOWER SWITCH & CONTROL HARNESS
12. FRESH AIR CABLE INSTALLATION
13. FRESH AIR CABLE INSTALLATION CONT.  
CONTROL CABLES
14. FINAL STEPS
15. CONTROL PANEL CALIBRATION PROCEDURE
16. WIRING DIAGRAM
17. OPERATION OF CONTROLS
18. CONTROL PANEL KIT PACKING LIST



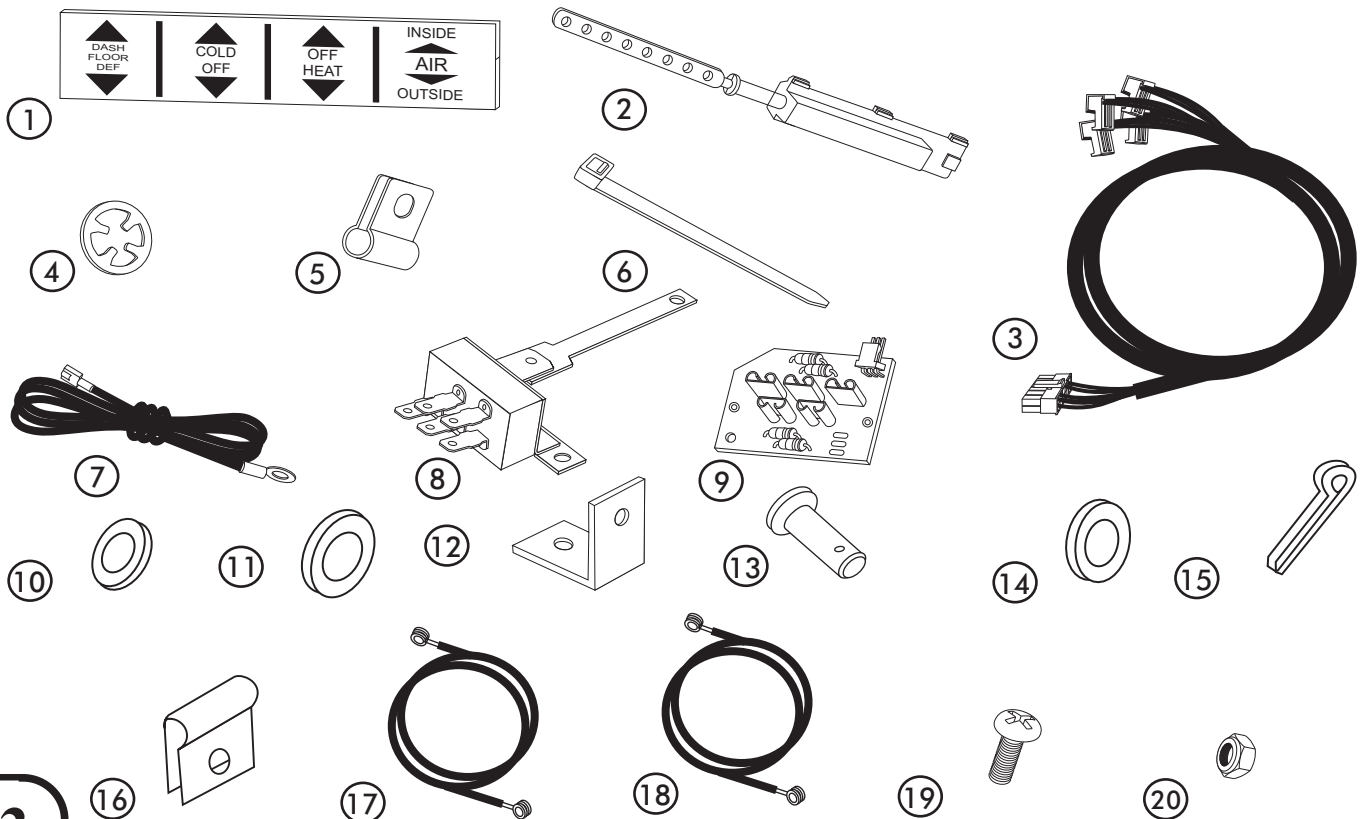
# 1957 CHEVY w/ 4 LEVER CONTROL PANEL CONVERSION KIT

## CONTROL PANEL CONVERSION KIT PACKING LIST

**CONTROL KIT  
472057**

No.	QTY.	PART No.	DESCRIPTION
1.	1	48400-PSR	1957 CHEVY GEN IV PLACARD
2.	3	112002-SUA	SLIDE POT ASM
3.	1	232006-VUR	GEN IV UNIVERSAL CONTROL HARNESS (TYPE B)
4.	3	65976-VUE	3/16" PUSH-ON RING
5.	3	491010-VUR	SLIDE POT CLAMP
6.	5	21301-VUP	4" TIE WRAP
7.	1	231520	GROUND WIRE
8.	1	11257-LCR	57 CHEV BLOWER SWITCH
9.	1	246110-PUA	BLOWER SWITCH PC BOARD
10.	2	49704-VUI	1/16 NYLON FLAT WASHER
11.	1	49705-VUI	1/8 NYLON FLAT WASHER
12.	1	64798-PCB	1957 CHEV FRESH AIR CABLE BRKT.
13.	1	18857-VSR	3/16 x 7/8 CLEVIS PIN
14.	1	18657-JSS	#8 FLAT WASHER
15.	1	18757-VSR	3/32 x 1/2 COTTER PIN
16.	4	18056-VUB	CABLE CLAMP
17.	1	49057-VCI	CABLE EYE TO EYE 57 3/4 x 50 1/4
18.	1	49076-VCI	CABLE EYE TO EYE 50 1/2 x 47 7/8
19.	2	18113-PSR	8-32 x 3/4 PAN HEAD SCREW
20.	2	18602-NSR	8-32 NYLOCK NUT

**\*\* BEFORE BEGINNING INSTALLATION OPEN ALL PACKAGES AND CHECK CONTENTS OF SHIPMENT. PLEASE REPORT ANY SHORTAGES DIRECTLY TO VINTAGE AIR WITHIN 15 DAYS. AFTER 15 DAYS, VINTAGE AIR WILL NOT BE RESPONSIBLE FOR MISSING OR DAMAGED ITEMS.**





## CONTROL PANEL CONVERSION INSTRUCTIONS FOR 1957 CHEVY

### REMOVING OEM CONTROL PANEL

- REMOVE THE (4) OEM MOUNTING SCREWS FROM CONTROL PANEL. SEE FIGURE 1.
- DISCONNECT CABLES AND WIRES FROM BACK OF CONTROL PANEL AND REMOVE THE CONTROL PANEL FROM DASH.

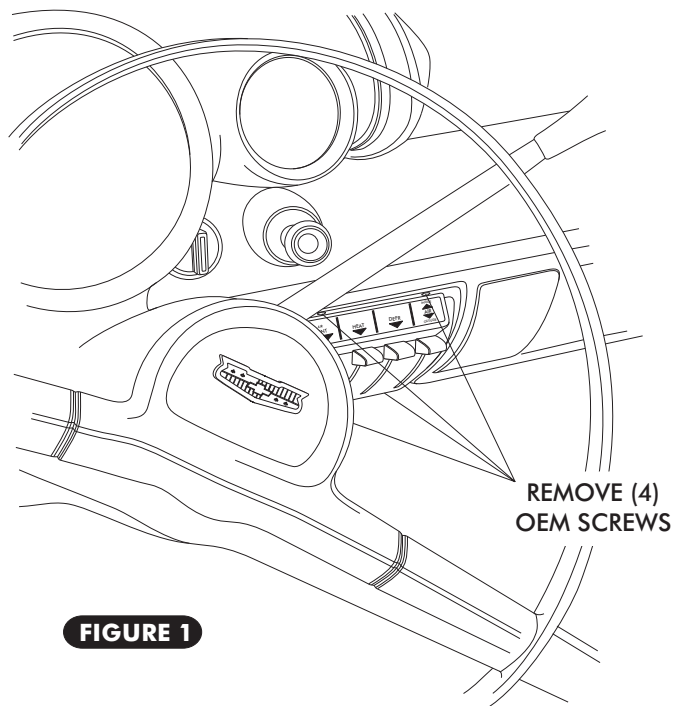


FIGURE 1

### SLIDE POT ASSEMBLY MODIFICATIONS

- LOCATE THE THREE SLIDE POT ASSEMBLIES, AND USING A PAIR OF WIRE CUTTERS, CUT SLIDE POT ACTUATOR RODS AS SHOWN BELOW IN FIGURE 2.

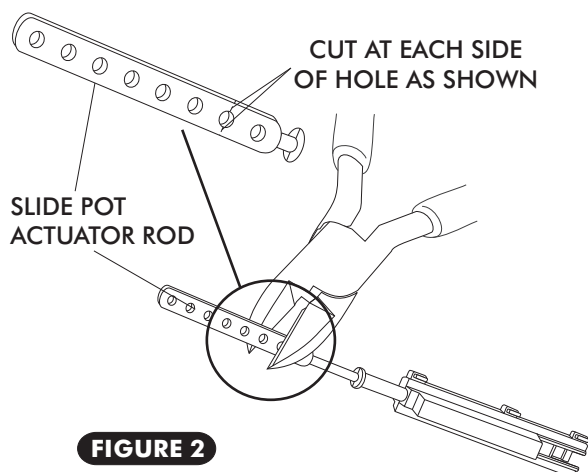
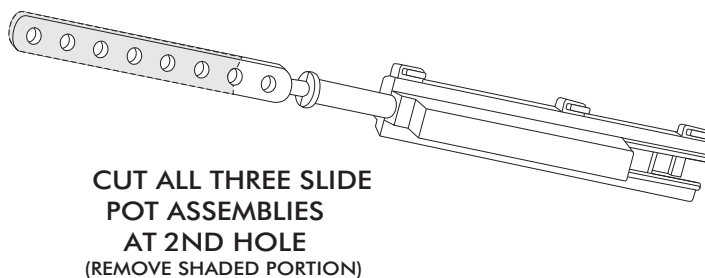


FIGURE 2

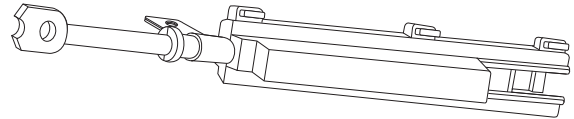
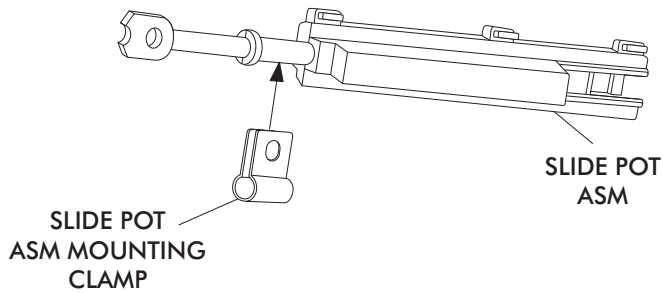


CUT ALL THREE SLIDE  
POT ASSEMBLIES  
AT 2ND HOLE  
(REMOVE SHADED PORTION)



### SLIDE POT ASSEMBLY MOUNTING CLAMP INSTALLATION

- INSTALL SLIDE POT ASM MOUNTING CLAMPS. SEE FIGURE 3 BELOW.

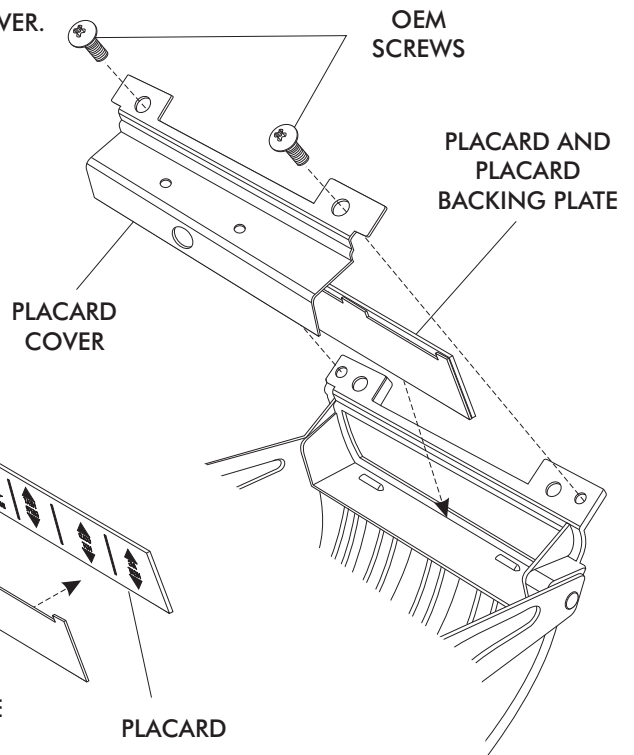
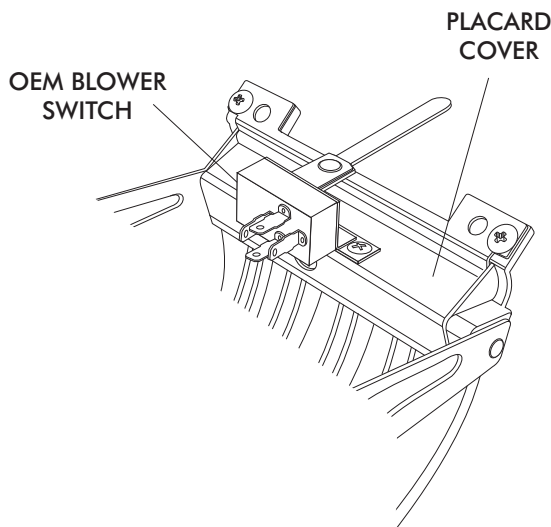


**FIGURE 3**

**ORIENT SLIDE POT ASSEMBLIES AS SHOWN AND INSTALL MOUNTING CLAMPS AS SHOWN. (NOTE: ORIENT CLAMPS IN RELATION TO THE (3) HOUSING SNAPS ON SLIDE POT ASSEMBLY)**

### PLACARD INSTALLATION

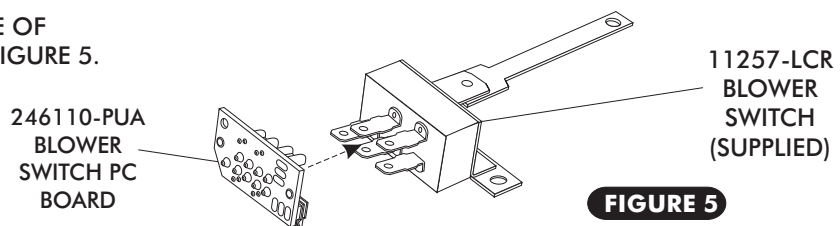
- REMOVE OEM BLOWER SWITCH (DISCARD), AND PLACARD COVER. SEE FIGURE 4 BELOW.
- REMOVE PLACARD BACKING PLATE AND PLACARD. (DISCARD PLACARD)
- PLACE PLACARD AND PLACARD BACKING PLATE TOGETHER AND PLACE IN CONTROL PANEL AS SHOWN IN FIGURE 4 BELOW.
- INSTALL PLACARD COVER AND SECURE USING OEM SCREWS.



**FIGURE 4**

### PC BOARD INSTALLATION

- INSTALL PC BOARD ON BACKSIDE OF SUPPLIED BLOWER SWITCH. SEE FIGURE 5.

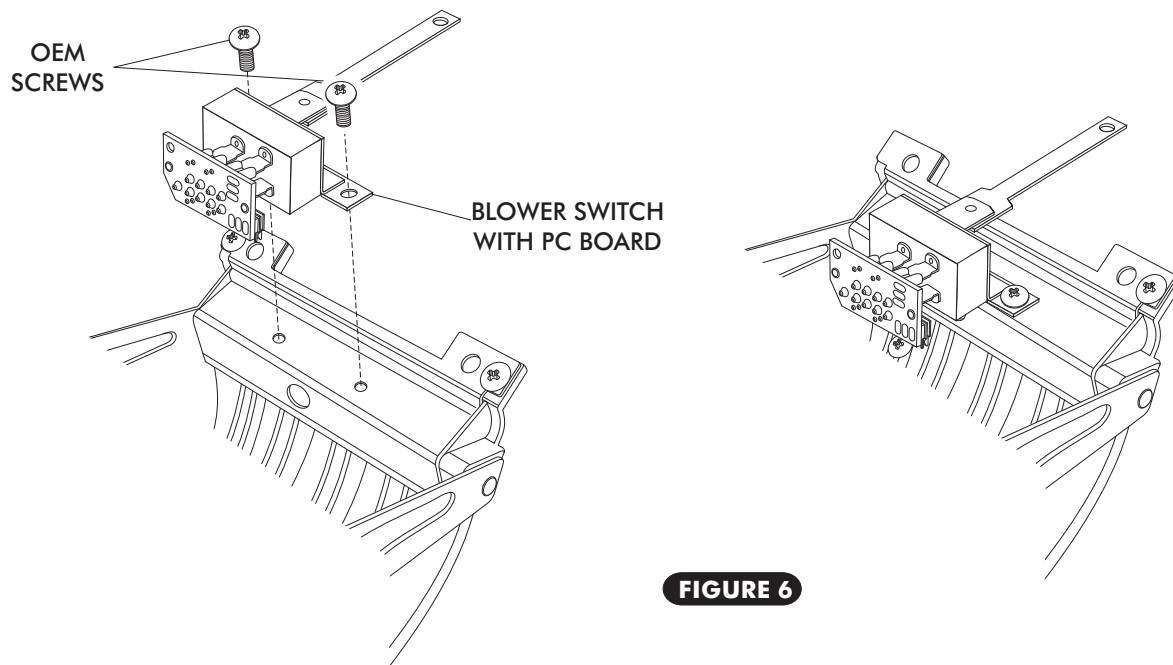


**FIGURE 5**



## BLOWER SWITCH INSTALLATION

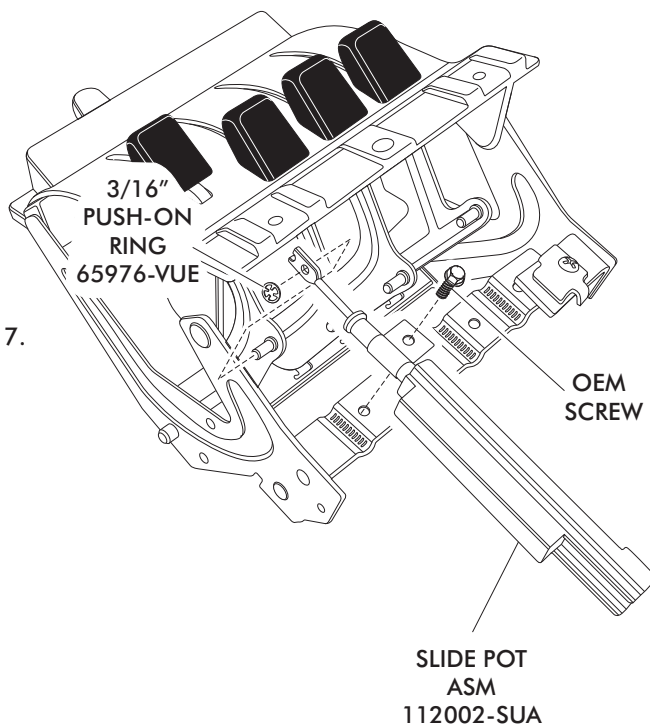
- ONCE PC BOARD IS INSTALLED ON BLOWER SWITCH, INSTALL BLOWER SWITCH, SECURE USING OEM SCREWS AS SHOWN IN FIGURE 6, BELOW.



## SLIDE POT ASSEMBLY INSTALLATION

### DASH/FLR/DEF SLIDE POT ASSEMBLY

- INSTALL SLIDE POT ASM ON THE DASH/FLR/DEF LEVER. SEE FIGURE 7 BELOW.
- INSTALL SLIDE POT LEVER PUSH ROD ONTO OEM CABLE MOUNTING STUD ON LEVER. SEE FIGURE 7 BELOW.
- SECURE THE SLIDE POT ASM TO THE CONTROL PANEL USING THE OEM SCREW IN THE OEM CABLE CLAMP MOUNTING LOCATION. SEE FIGURE 7.
- SINCE THE SLIDE POT ASSEMBLY CAN SLIDE BACK AND FORTH IN CLAMP BEFORE SCREW IS TIGHTENED, POSITION SLIDE POT AS SHOWN IN FIGURE 7b, PAGE 7.
- SECURE SLIDE POT LEVER PUSH ROD ONTO OEM CABLE MOUNTING STUD USING 3/16" PUSH-ON RING AS SHOWN IN FIGURE 7.



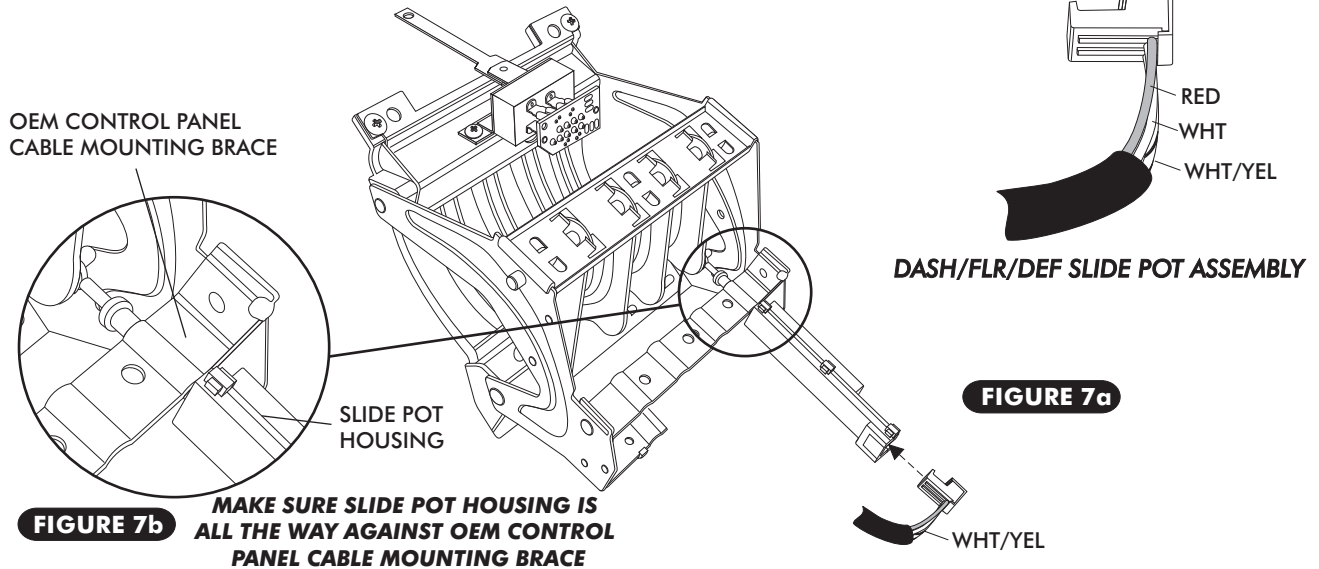
**FIGURE 7**



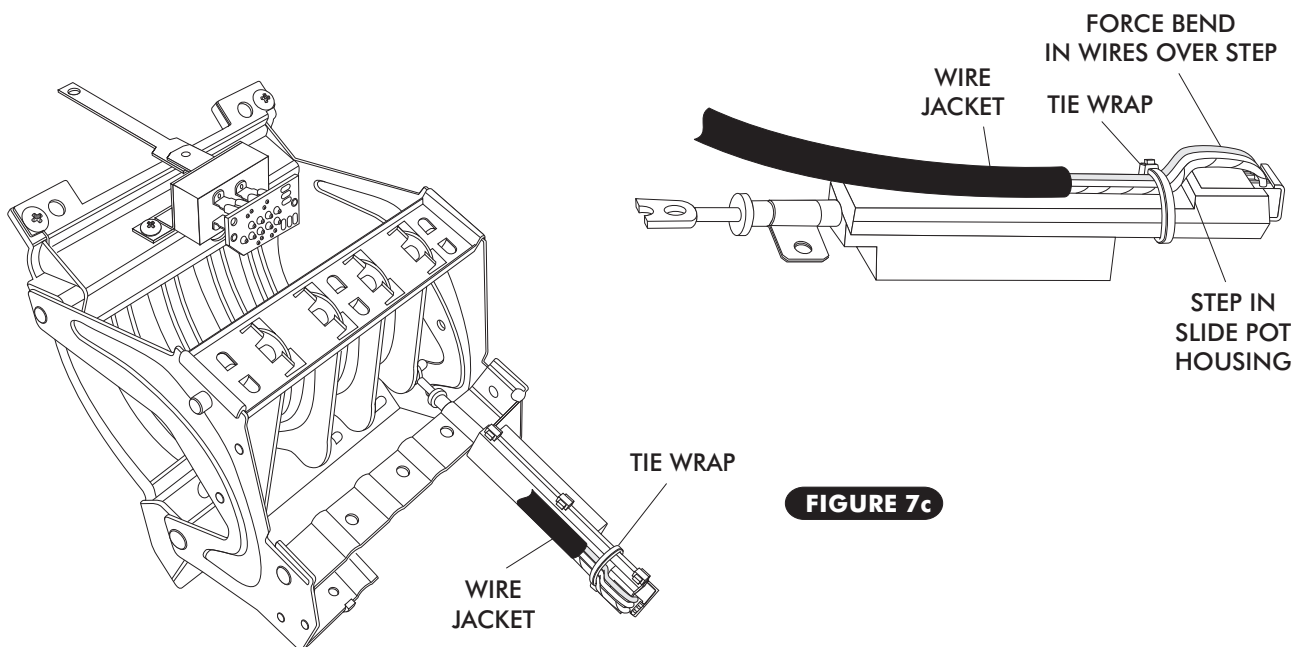
# 1957 CHEVY w/ 4 LEVER CONTROL PANEL CONVERSION KIT

## CONTROL HARNESS

- LOCATE THE CONTROL PANEL WIRE HARNESS AND PLUG THE CORRESPONDING WIRES INTO THE CORRECT SLIDE POT ASSEMBLY AS SHOWN IN FIGURE 7a BELOW.



- ONCE WIRES ARE CORRECTLY PLUGGED INTO SLIDE POT ASSEMBLY, SECURE WIRES TO THE SLIDE POT ASSEMBLY USING TIE WRAPS (SUPPLIED). SEE FIGURE 7c BELOW. THE TIE WRAP MUST BE LOCATED BETWEEN THE END OF THE WIRE JACKET AND THE STEP IN THE SLIDE POT HOUSING FORCING A BEND IN EACH WIRE AS THEY PASS OVER THE STEP IN SLIDE POT HOUSING. HEAD OF TIE WRAP MUST FALL ON EDGE OF HOUSING AS SHOWN TO REMAIN TIGHT. ENSURE THAT THE TIE WRAPS ARE SNUG ENOUGH THAT THE WIRES CANNOT MOVE. SEE FIGURE 7c.

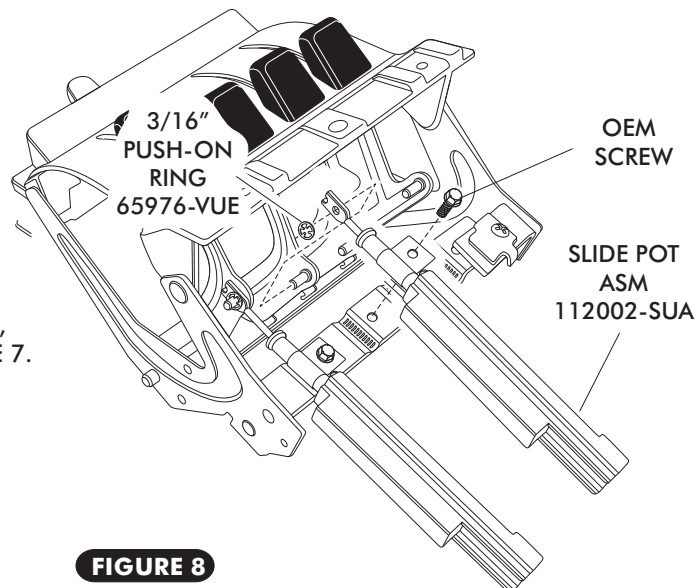




## SLIDE POT ASSEMBLY INSTALLATION

### COLD/OFF SLIDE POT ASSEMBLY

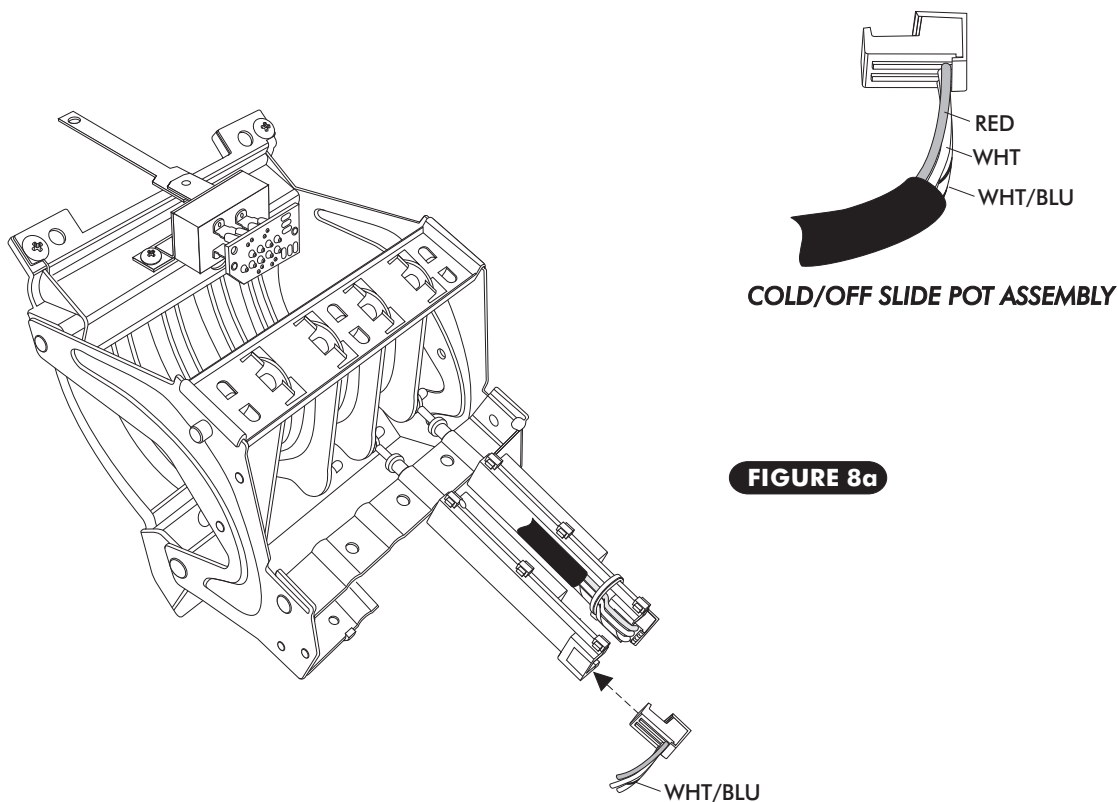
- ❑ INSTALL SLIDE POT ASM ON THE COLD/ OFF LEVER. SEE FIGURE 8 BELOW.
- ❑ INSTALL SLIDE POT LEVER PUSH ROD ONTO OEM CABLE MOUNTING STUD ON LEVER. SEE FIGURE 8 BELOW.
- ❑ SECURE THE SLIDE POT ASM TO THE CONTROL PANEL USING THE OEM SCREW IN THE OEM CABLE CLAMP MOUNTING LOCATION. SEE FIGURE 8.
- ❑ SINCE THE SLIDE POT ASSEMBLY CAN SLIDE BACK AND FORTH IN CLAMP BEFORE SCREW IS TIGHTENED, POSITION SLIDE POT AS SHOWN IN FIGURE 7b, PAGE 7.
- ❑ SECURE SLIDE POT LEVER PUSH ROD ONTO OEM CABLE MOUNTING STUD USING 3/16" PUSH-ON RING AS SHOWN IN FIGURE 8.



**FIGURE 8**

## CONTROL HARNESS

- ❑ LOCATE THE CONTROL PANEL WIRE HARNESS AND PLUG THE CORRESPONDING WIRES INTO THE CORRECT SLIDE POT ASSEMBLY AS SHOWN IN FIGURE 8a BELOW.

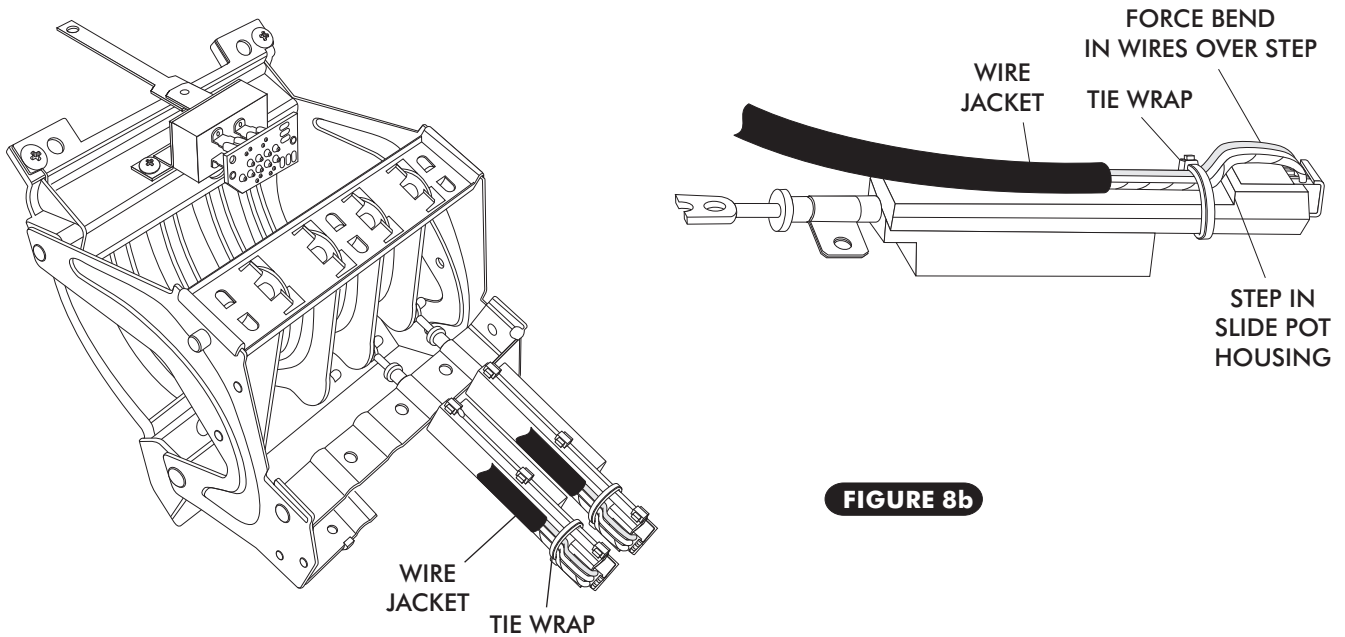


**FIGURE 8a**



## 1957 CHEVY w/ 4 LEVER CONTROL PANEL CONVERSION KIT

- ONCE WIRES ARE CORRECTLY PLUGGED INTO SLIDE POT ASSEMBLY, SECURE WIRES TO THE SLIDE POT ASSEMBLY USING TIE WRAPS (SUPPLIED). SEE FIGURE 8b BELOW. THE TIE WRAP MUST BE LOCATED BETWEEN THE END OF THE WIRE JACKET AND THE STEP IN THE SLIDE POT HOUSING FORCING A BEND IN EACH WIRE AS THEY PASS OVER THE STEP IN SLIDE POT HOUSING. HEAD OF TIE WRAP MUST FALL ON EDGE OF HOUSING AS SHOWN TO REMAIN TIGHT. ENSURE THAT THE TIE WRAPS ARE SNUG ENOUGH THAT THE WIRES CANNOT MOVE. SEE FIGURE 8b.

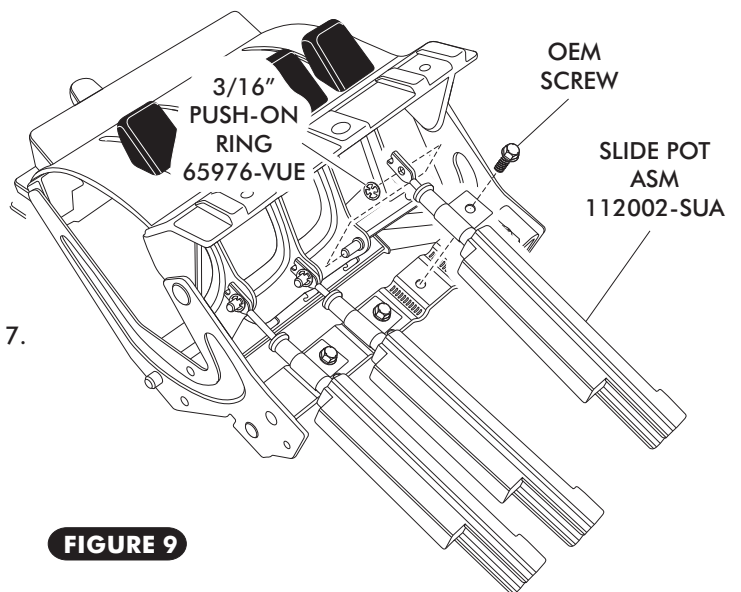


**FIGURE 8b**

### SLIDE POT ASSEMBLY INSTALLATION

#### OFF/HEAT SLIDE POT ASSEMBLY

- INSTALL SLIDE POT ASM ON THE OFF/ HEAT LEVER. SEE FIGURE 9 BELOW.
- INSTALL SLIDE POT LEVER PUSH ROD ONTO OEM CABLE MOUNTING STUD ON LEVER. SEE FIGURE 9 BELOW.
- SECURE THE SLIDE POT ASM TO THE CONTROL PANEL USING THE OEM SCREW IN THE OEM CABLE CLAMP MOUNTING LOCATION. SEE FIGURE 9.
- SINCE THE SLIDE POT ASSEMBLY CAN SLIDE BACK AND FORTH IN CLAMP BEFORE SCREW IS TIGHTENED, POSITION SLIDE POT AS SHOWN IN FIGURE 7b, PAGE 7.
- SECURE SLIDE POT LEVER PUSH ROD ONTO OEM CABLE MOUNTING STUD USING 3/16" PUSH-ON RING AS SHOWN IN FIGURE 9.



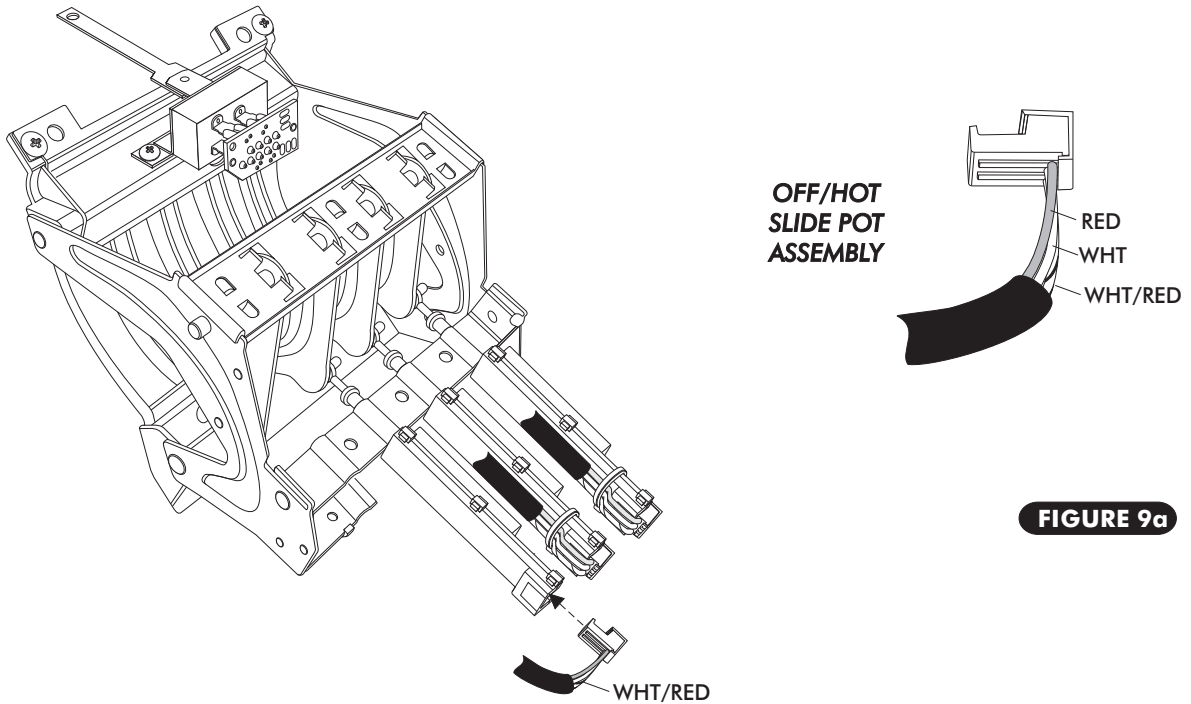
**FIGURE 9**



# 1957 CHEVY w/ 4 LEVER CONTROL PANEL CONVERSION KIT

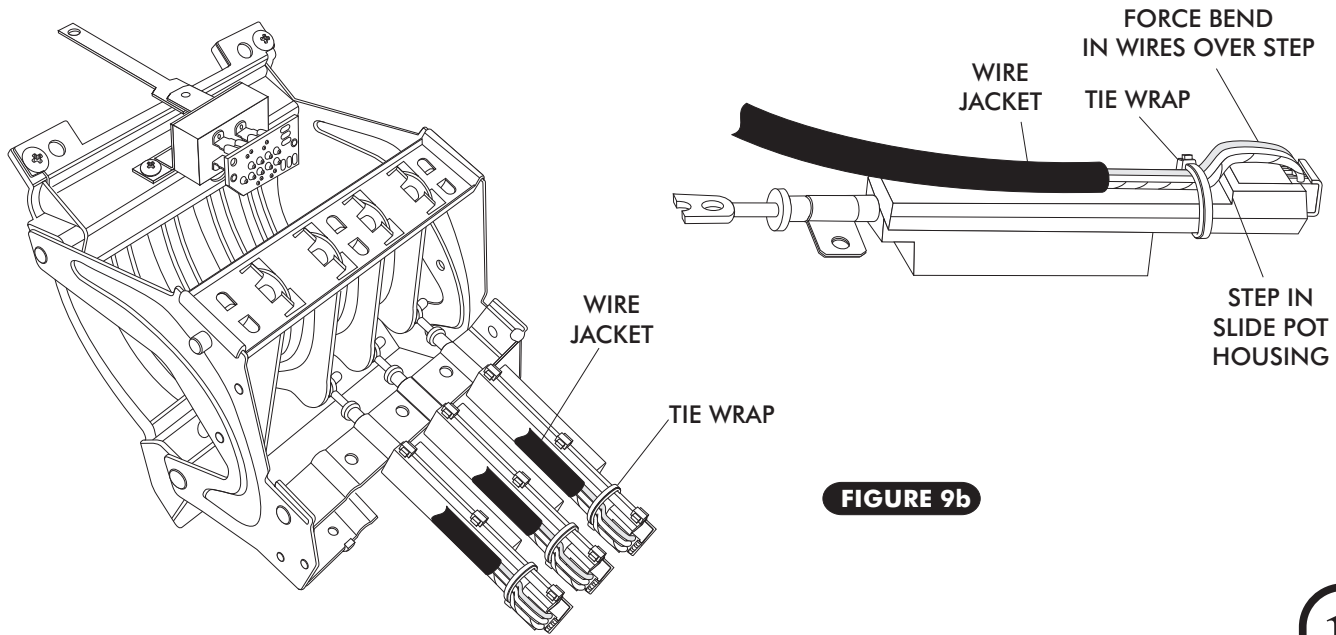
## CONTROL HARNESS

- LOCATE THE CONTROL PANEL WIRE HARNESS AND PLUG THE CORRESPONDING WIRES INTO THE CORRECT SLIDE POT ASSEMBLY AS SHOWN IN FIGURE 9a BELOW.



**FIGURE 9a**

- ONCE WIRES ARE CORRECTLY PLUGGED INTO SLIDE POT ASSEMBLY, SECURE WIRES TO THE SLIDE POT ASSEMBLY USING TIE WRAPS (SUPPLIED). SEE FIGURE 9b BELOW. THE TIE WRAP MUST BE LOCATED BETWEEN THE END OF THE WIRE JACKET AND THE STEP IN THE SLIDE POT HOUSING FORCING A BEND IN EACH WIRE AS THEY PASS OVER THE STEP IN SLIDE POT HOUSING. HEAD OF TIE WRAP MUST FALL ON EDGE OF HOUSING AS SHOWN TO REMAIN TIGHT. ENSURE THAT THE TIE WRAPS ARE SNUG ENOUGH THAT THE WIRES CANNOT MOVE. SEE FIGURE 9b.



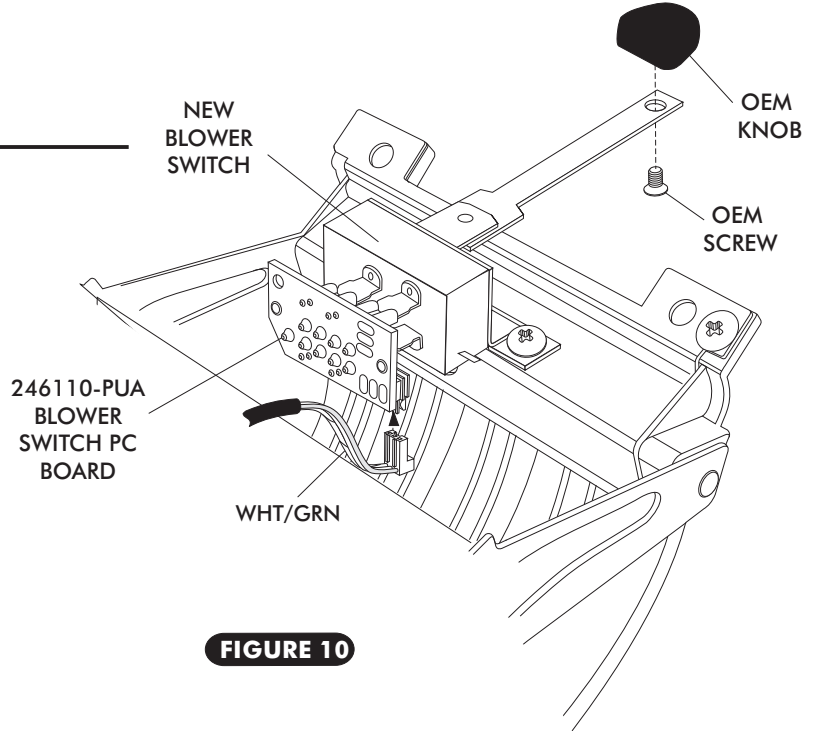
**FIGURE 9b**



# 1957 CHEVY w/ 4 LEVER CONTROL PANEL CONVERSION KIT

## BLOWER SWITCH

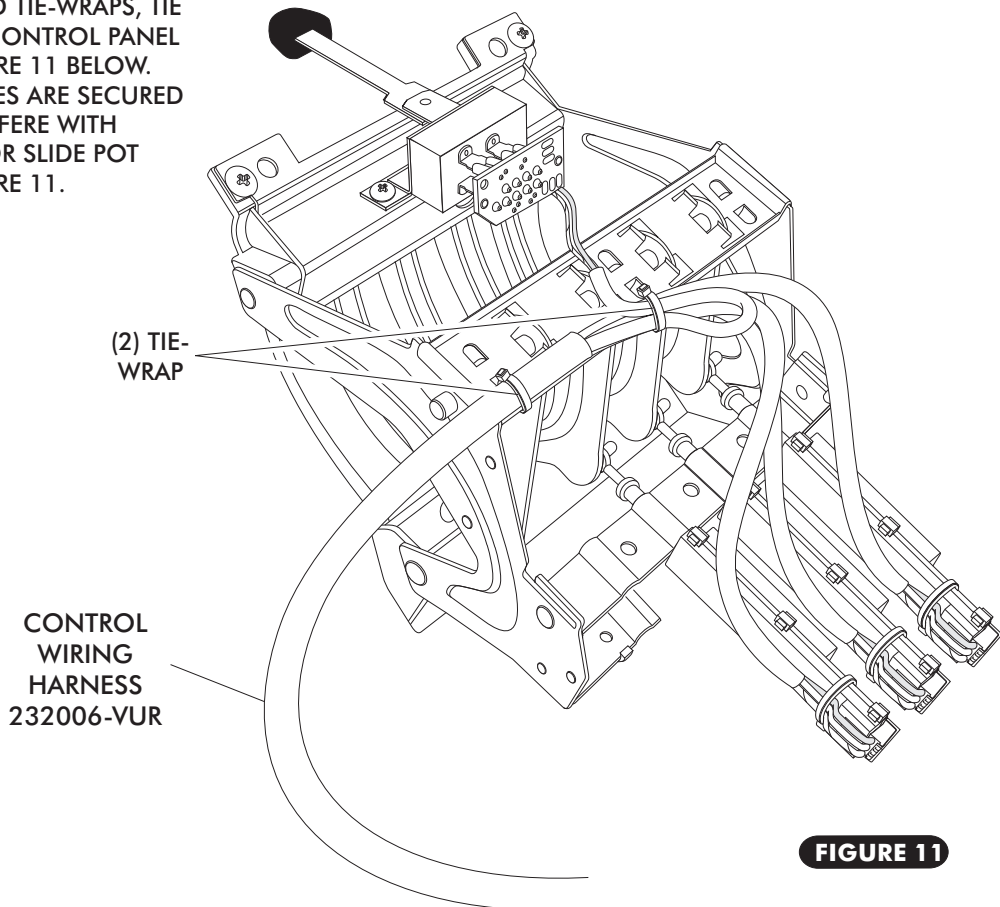
- ❑ PLUG IN THE REMAINING CONNECTOR WITH THE RED, WHT & WHT/GRN WIRES INTO THE BLOWER SWITCH PC BOARD AS SHOWN IN FIGURE 10 BELOW.
- ❑ INSTALL OEM KNOB, SECURE KNOB TO BLOWER SWITCH LEVER USING OEM SCREW. SEE FIGURE 10.



**FIGURE 10**

## CONTROL HARNESS CONT.

- ❑ USING THE SUPPLIED TIE-WRAPS, TIE THE WIRES TO THE CONTROL PANEL AS SHOWN IN FIGURE 11 BELOW. CONFIRM THAT WIRES ARE SECURED AND DO NOT INTERFERE WITH LEVER OPERATION OR SLIDE POT ASSEMBLY. SEE FIGURE 11.



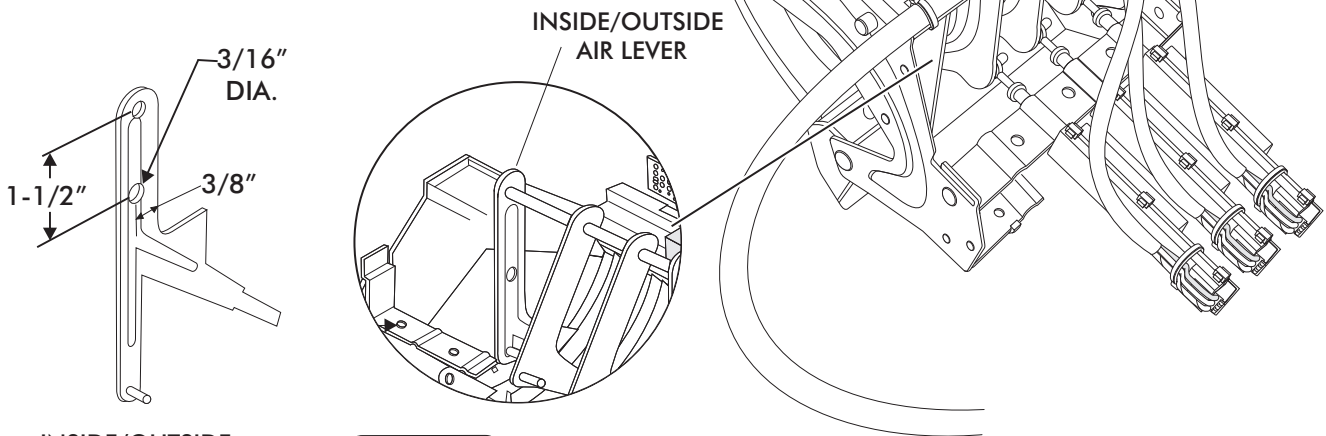
**FIGURE 11**



# 1957 CHEVY w/ 4 LEVER CONTROL PANEL CONVERSION KIT

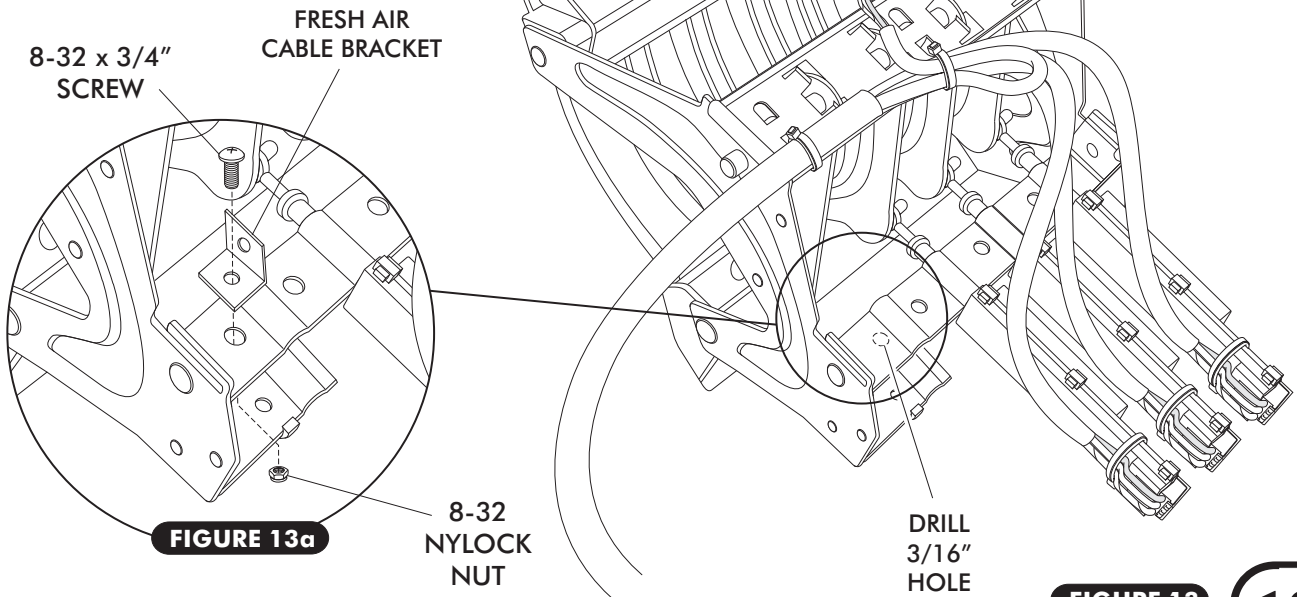
## FRESH AIR CABLE INSTALLATION

- REMOVE O.E.M. CABLE CLAMPS, AND DISCARD.
- REMOVE FRESH AIR LEVER FROM O.E.M. CONTROL PANEL, DRILL 3/16" DIA. HOLE AS SHOWN IN FIGURE 12, BELOW.
- REINSTALL LEVER IN CONTROL PANEL.



**FIGURE 12**

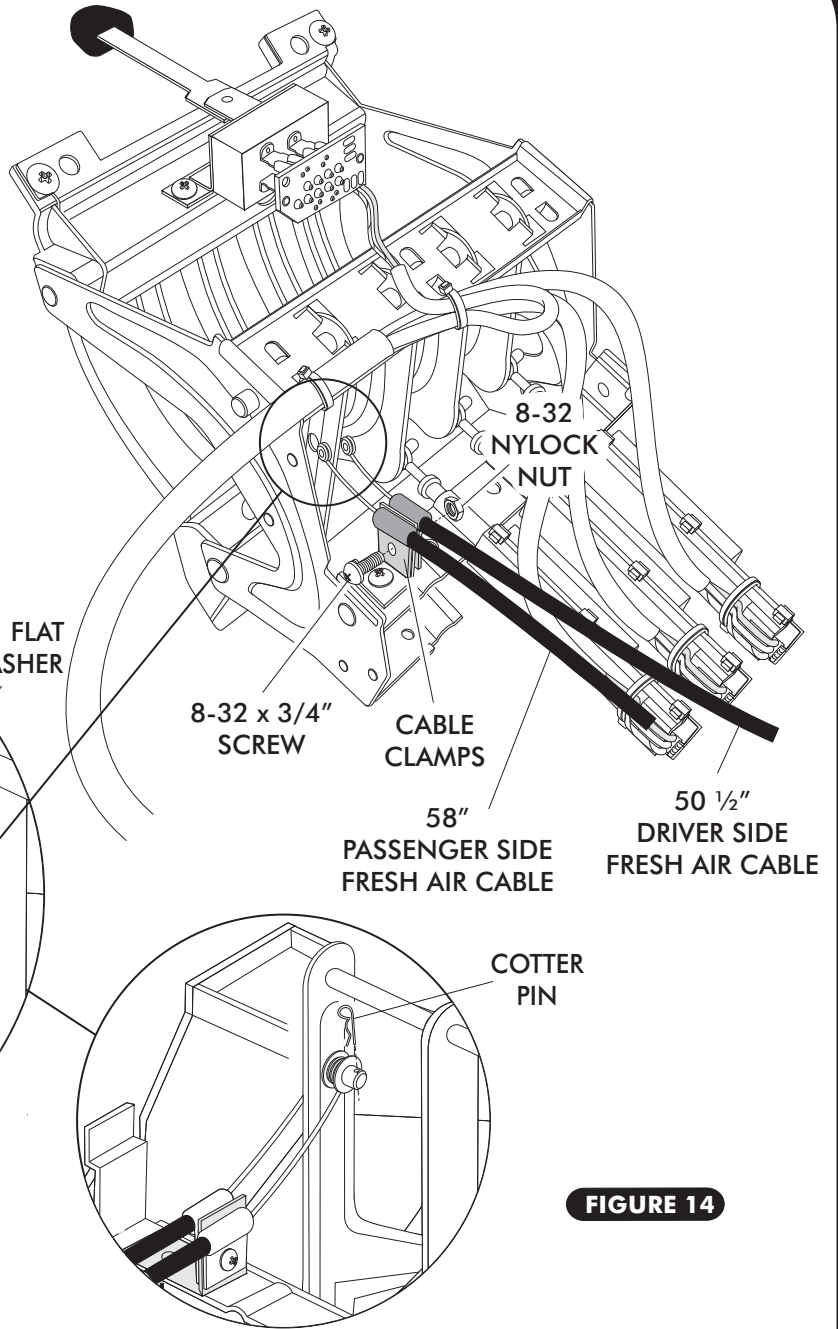
- DRILL 3/16" HOLE IN CONTROL PANEL AS SHOWN IN FIGURE 13 BELOW.
- INSTALL FRESH AIR CABLE BRACKET, SECURE BRACKET USING AN 8-32 x 3/4" SCREW WITH A 8-32 NYLOCK NUT. SEE FIGURE 13a, BELOW.



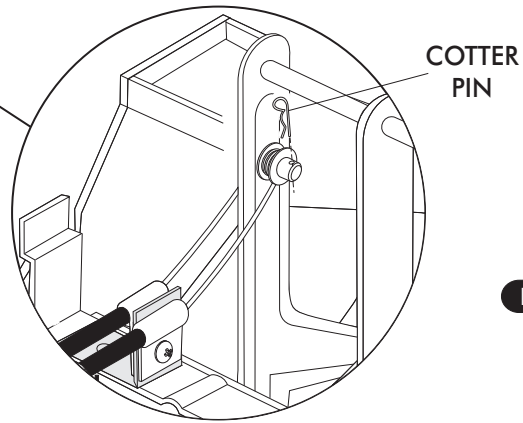
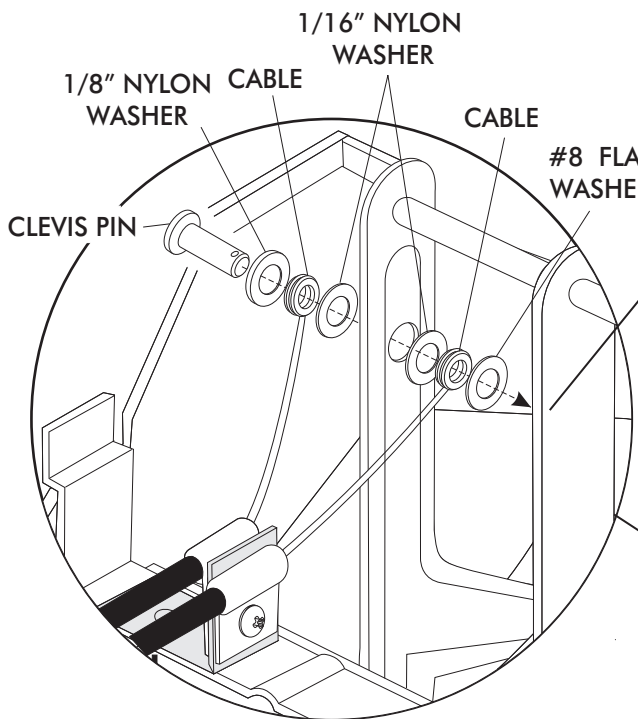
**FIGURE 13**



- ATTACH FRESH AIR CABLES WITH CABLE CLAMPS TO FRESH AIR CABLE MOUNTING BRACKET, SECURE WITH 8-32 x 3/4" SCREW AND 8/32 NYLOCK NUT.
- INSTALL FRESH AIR CABLES TO FRESH AIR LEVER, SECURE WITH CLEVIS PIN, NYLON WASHERS, 3/16" FLAT WASHER AND 3/32" COTTER PIN. SEE FIGURE PAGE 14, BELOW.

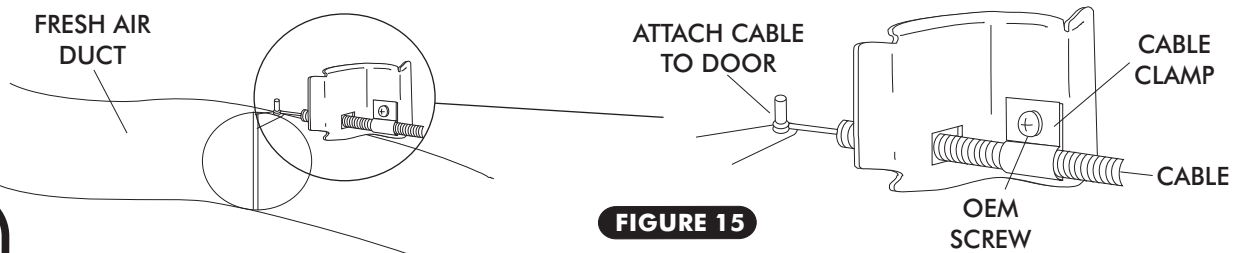


**FIGURE 14**



**CONTROL CABLES**

- ROUTE THE FRESH AIR CABLES THROUGH THE ORIGINAL CABLE HOLES IN THE FIREWALL. USING CABLE CLAMPS, CONNECT CABLE TO THE BUTTERFLY DOOR IN THE LEFT AND RIGHT FRONT FENDER. ADJUST CABLES, AND VERIFY THAT BOTH BUTTERFLY DOORS CLOSE COMPLETELY. SEE FIGURE 15, BELOW



**FIGURE 15**



## 1957 CHEVY w/ 4 LEVER CONTROL PANEL CONVERSION KIT

### FINAL STEPS

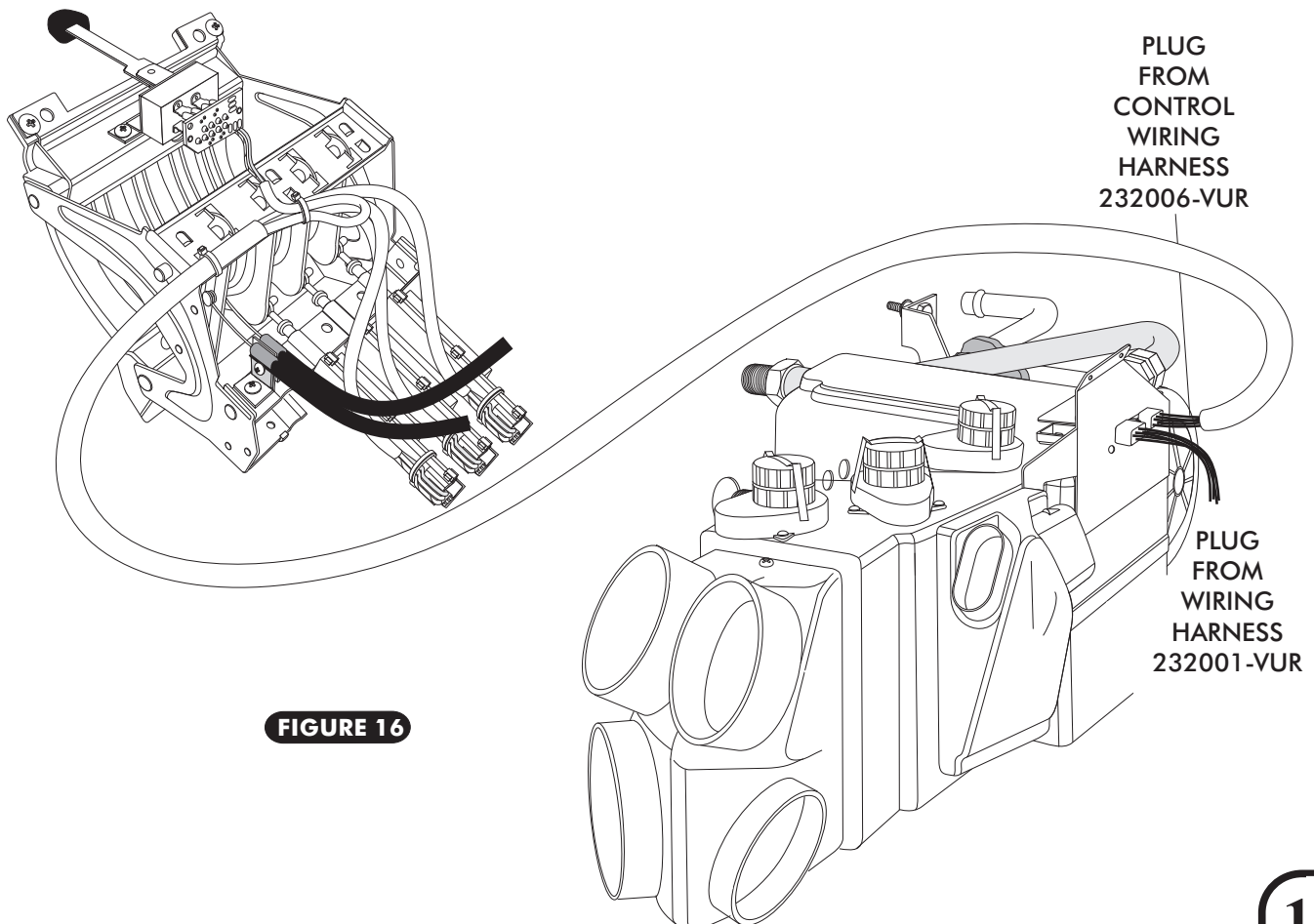
- RE-INSTALL CONTROL PANEL IN DASH.
- PLUG THE WIRING HARNESS INTO THE ECU MODULE ON SUB CASE. SEE FIGURE 16 BELOW.
- WIRE ACCORDING TO WIRING DIAGRAM ON PAGE 16.
- CONTROL PANEL CALIBRATION PROCEDURE AND OPERATION INSTRUCTIONS:

CALIBRATING THE CONTROL PANEL WILL SET THE RANGE OF TRAVEL FOR THE SLIDE POTS CONNECTED TO THE OEM CONTROL PANEL LEVERS. PERFORMING THIS PROCEDURE WILL SET THE LIMITS OF THE SLIDE POTS AT THEIR HIGHEST AND LOWEST POINTS

LOCATE THE GRAY WIRE WITH AN UNUSED CONNECTOR IN THE WIRING HARNESS NEAR THE TWO CABLE HARNESS RELAYS. THE WIRE IS LABELED PRGM ON THE WIRING DIAGRAM ON PAGE 16.

IT WILL BE NECESSARY TO GROUND THE GRAY WIRE FOR APPROXIMATELY FIVE SECONDS WHILE MOVING THE CONTROLS SO IT IS SOMETIMES HELPFUL TO ATTACH ONE END OF THE WHITE JUMPER WIRE TO THE VEHICLE'S GROUND (FOR EXAMPLE THE CHASSIS) AND HAVE THE OTHER END READY TO CONNECT TO THE GRAY PRGM WIRE WHEN THE PROCEDURE REQUIRES IT.

TO CALIBRATE THE CONTROL PANEL FOLLOW THE CALIBRATION PROCEDURES ON PAGE 15.



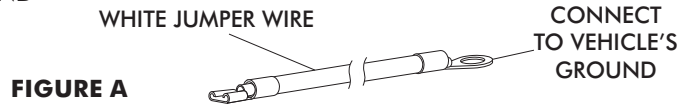
**FIGURE 16**



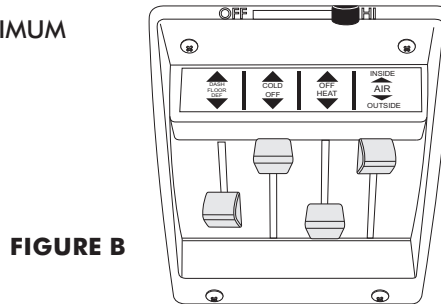
**CONTROL PANEL CALIBRATION PROCEDURE**

1. TURN THE IGNITION SWITCH ON (DO NOT START THE ENGINE)

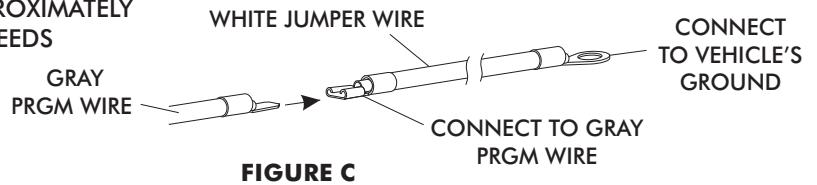
2. CONNECT THE WHITE JUMPER WIRE TO VEHICLE'S GROUND (FOR EXAMPLE THE VEHICLE CHASSIS). ENSURE THAT THE GRAY WIRE IS NOT GROUNDED. DO NOT CONNECT JUMPER WIRE TO THE GRAY PRGM WIRE. SEE FIGURE A.



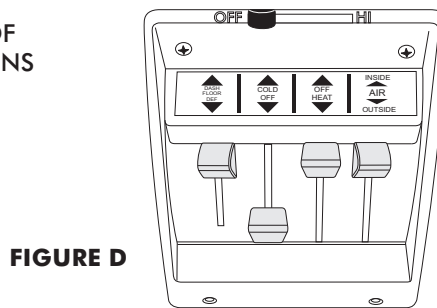
3. MOVE ALL OF THE CONTROL LEVERS TO THEIR MAXIMUM POSITIONS, AS SHOWN IN FIGURE B.



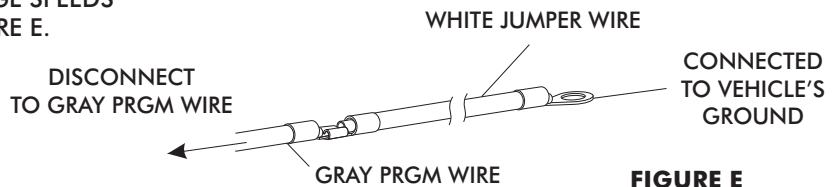
4. GROUND THE GRAY WIRE BY CONNECTING THE GRAY PRGM WIRE & WHITE JUMPER WIRE FOR APPROXIMATELY 5 SECONDS (THE BLOWER WILL CHANGE SPEEDS WHEN STEP FOUR IS COMPLETE). SEE FIGURE C.



5. LEAVING THE GRAY WIRE GROUNDED, MOVE ALL OF THE CONTROL LEVERS TO THEIR MINIMUM POSITIONS AS SHOWN IN FIGURE D.



6. DISCONNECT THE GRAY WIRE FROM THE WHITE GROUND JUMPER WIRE (THE BLOWER WILL CHANGE SPEEDS WHEN STEP SIX IS COMPLETE). SEE FIGURE E.



7. START THE ENGINE AND TEST ALL OF THE CONTROLS TO ENSURE THAT THE INTENDED RESULTS WERE ACCOMPLISHED.

8. DISCONNECT THE WHITE JUMPER WIRE FROM VEHICLE'S GROUND.

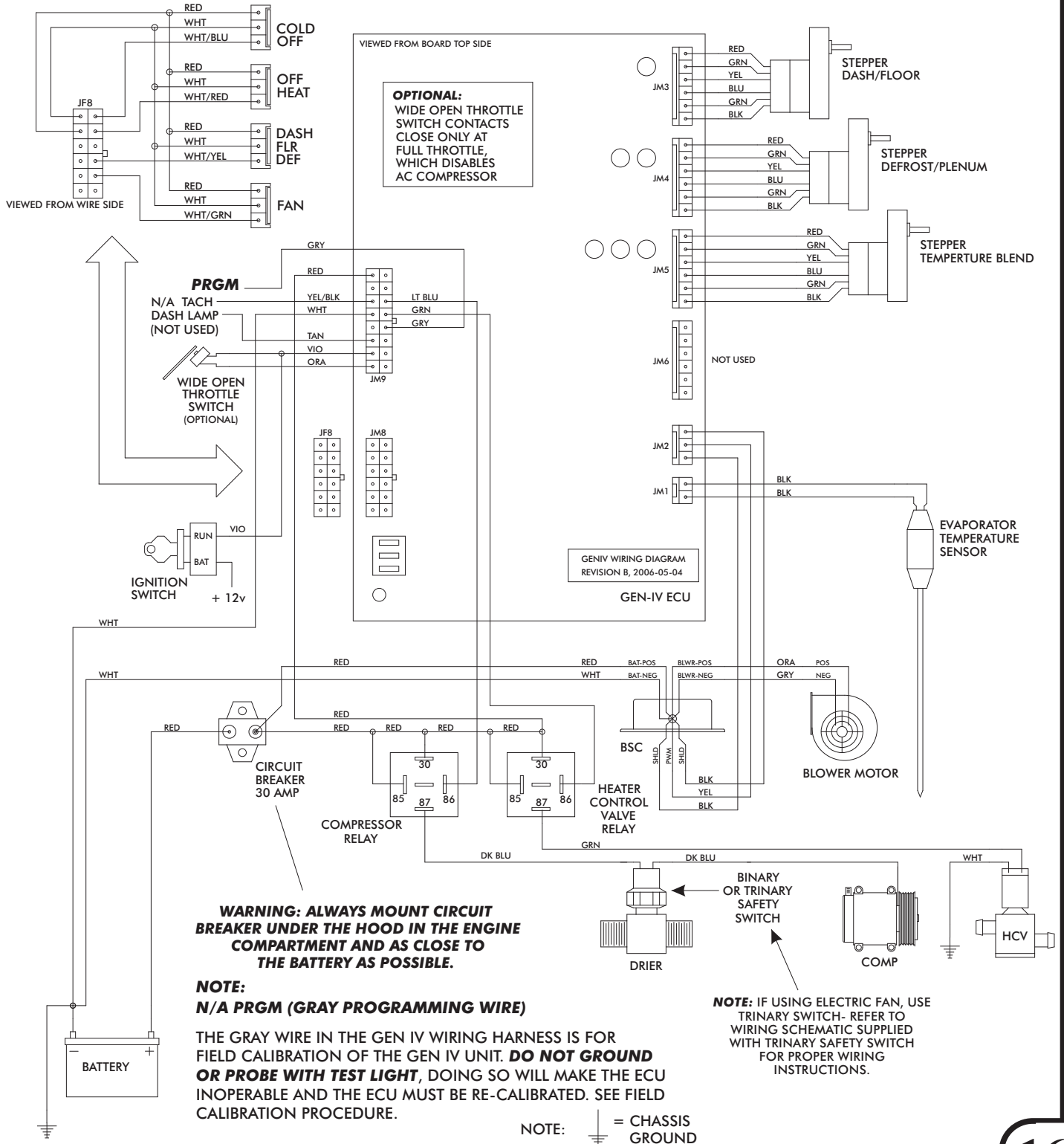
NOTE: THIS PROCEDURE MAY BE REPEATED IF NECESSARY.

**\* WHEN FINISHED, TAPE OVER PROGRAM WIRE CONNECTOR WITH ELECTRICAL TAPE TO PREVENT ACCIDENTAL CONTACT WITH CHASSIS GROUND.**



# 1957 CHEVY w/ 4 LEVER CONTROL PANEL CONVERSION KIT

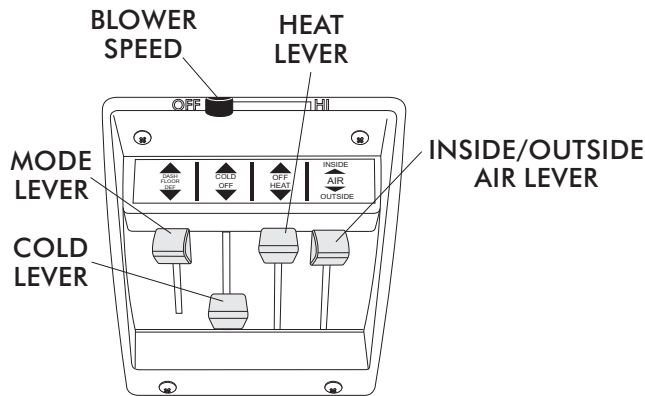
## WIRING DIAGRAM





## OPERATION OF CONTROLS

**NOTE: WHEN BATTERY POWER IS FIRST CONNECTED TO THE ECU, THE COMPUTER GOES THROUGH AN INITIALIZATION SEQUENCE. THIS INITIALIZATION MAY TAKE UP TO 30 SECONDS. DURING INITIALIZATION THE BLOWER WILL NOT OPERATE, BUT THE DOORS INSIDE THE UNIT WILL BE OPERATING. A LOW BATTERY OR DISCONNECTING THE BATTERY MAY ALSO TRIGGER A RE-INITIALIZATION. DURING START UP, A LOW BATTERY MAY DROP BELOW 7 VOLTS, TRIGGERING RE-INITIALIZATION.**



### SYSTEM OFF

#### **BLOWER SPEED**

THIS LEVER CONTROLS THE BLOWER SPEED, FROM OFF TO HI

#### **COLD LEVER**

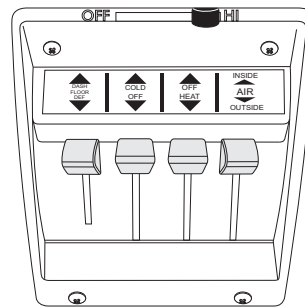
IN A/C MODE SLIDE THE COLD LEVER ALL THE WAY UP TO THE COLD POSITION, FOR MAXIMUM COOLING (SLIDE LEVER UP OR DOWN TO ADJUST DESIRED TEMPERATURE)

#### **HEAT LEVER**

IN HEAT MODE SLIDE THE HEAT LEVER ALL THE WAY DOWN TO THE HOT POSITION, FOR MAXIMUM HEATING (SLIDE LEVER UP OR DOWN TO ADJUST DESIRED TEMPERATURE)

#### **MODE LEVER**

SLIDE THE LEVER TO THE "DASH" POSITION



### A/C MODE

#### **BLOWER SPEED**

SLIDE LEVER TO THE RIGHT TO DESIRED BLOWER SPEED, FROM OFF TO HI

#### **COLD LEVER**

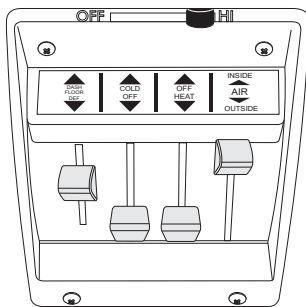
IN A/C MODE SLIDE THE COLD LEVER ALL THE WAY UP TO THE COLD POSITION, TO ENGAGE COMPRESSOR. FOR MAXIMUM COOLING (SLIDE LEVER UP OR DOWN TO ADJUST DESIRED TEMPERATURE)

#### **HEAT LEVER**

IN A/C MODE SLIDE THE HEAT LEVER ALL THE WAY UP TO THE OFF POSITION

#### **MODE LEVER**

SLIDE THE LEVER TO THE "DASH" POSITION



### HEAT MODE

#### **BLOWER SPEED**

SLIDE LEVER TO THE RIGHT TO DESIRED BLOWER SPEED, FROM OFF TO HI

#### **COLD LEVER**

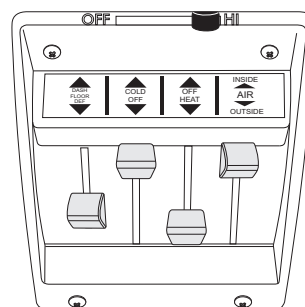
IN HEAT MODE SLIDE THE COLD LEVER ALL THE WAY DOWN TO THE OFF POSITION

#### **HEAT LEVER**

IN HEAT MODE SLIDE THE HEAT LEVER ALL THE WAY DOWN TO THE HOT POSITION, FOR MAXIMUM HEATING (SLIDE LEVER UP OR DOWN TO ADJUST DESIRED TEMPERATURE)

#### **MODE LEVER**

SLIDE THE LEVER TO THE "FLR" POSITION



### DEFROST/ DE-FOG MODE

#### **BLOWER SPEED**

SLIDE LEVER TO THE RIGHT TO DESIRED BLOWER SPEED, FROM OFF TO HI

#### **COLD LEVER**

IN DEFROST MODE SLIDE THE COLD LEVER ALL THE WAY UP TO THE COLD POSITION, TO ENGAGE COMPRESSOR. FOR MAXIMUM COOLING (SLIDE LEVER UP OR DOWN TO ADJUST DESIRED TEMPERATURE)

#### **HEAT LEVER**

IN DEFROST MODE SLIDE THE HEAT LEVER ALL THE WAY DOWN TO THE HOT POSITION, FOR MAXIMUM HEATING (SLIDE LEVER UP OR DOWN TO ADJUST DESIRED TEMPERATURE)

#### **MODE LEVER**

SLIDE THE LEVER TO THE "DEF" POSITION



# 1957 CHEVY w/ 4 LEVER CONTROL PANEL CONVERSION KIT

## CONTROL PANEL CONVERSION KIT PACKING LIST

**CONTROL KIT  
472057**

No.	QTY.	PART No.	DESCRIPTION
1.	1	48400-PSR	1957 CHEVY GEN IV PLACARD
2.	3	112002-SUA	SLIDE POT ASM
3.	1	232006-VUR	GEN IV UNIVERSAL CONTROL HARNESS (TYPE B)
4.	3	65976-VUE	3/16" PUSH-ON RING
5.	3	491010-VUR	SLIDE POT CLAMP
6.	5	21301-VUP	4" TIE WRAP
7.	1	231520	GROUND WIRE
8.	1	11257-LCR	57 CHEV BLOWER SWITCH
9.	1	246110-PUA	BLOWER SWITCH PC BOARD
10.	2	49704-VUI	1/16 NYLON FLAT WASHER
11.	1	49705-VUI	1/8 NYLON FLAT WASHER
12.	1	64798-PCB	1957 CHEV FRESH AIR CABLE BRKT.
13.	1	18857-VSR	3/16 x 7/8 CLEVIS PIN
14.	1	18657-JSS	#8 FLAT WASHER
15.	1	18757-VSR	3/32 x 1/2 COTTER PIN
16.	4	18056-VUB	CABLE CLAMP
17.	1	49057-VCI	CABLE EYE TO EYE 57 3/4 x 50 1/4
18.	1	49076-VCI	CABLE EYE TO EYE 50 1/2 x 47 7/8
19.	2	18113-PSR	8-32 x 3/4 PAN HEAD SCREW
20.	2	18602-NSR	8-32 NYLOCK NUT

CHECKED BY: \_\_\_\_\_  
 PACKED BY: \_\_\_\_\_  
 DATE: \_\_\_\_\_

