

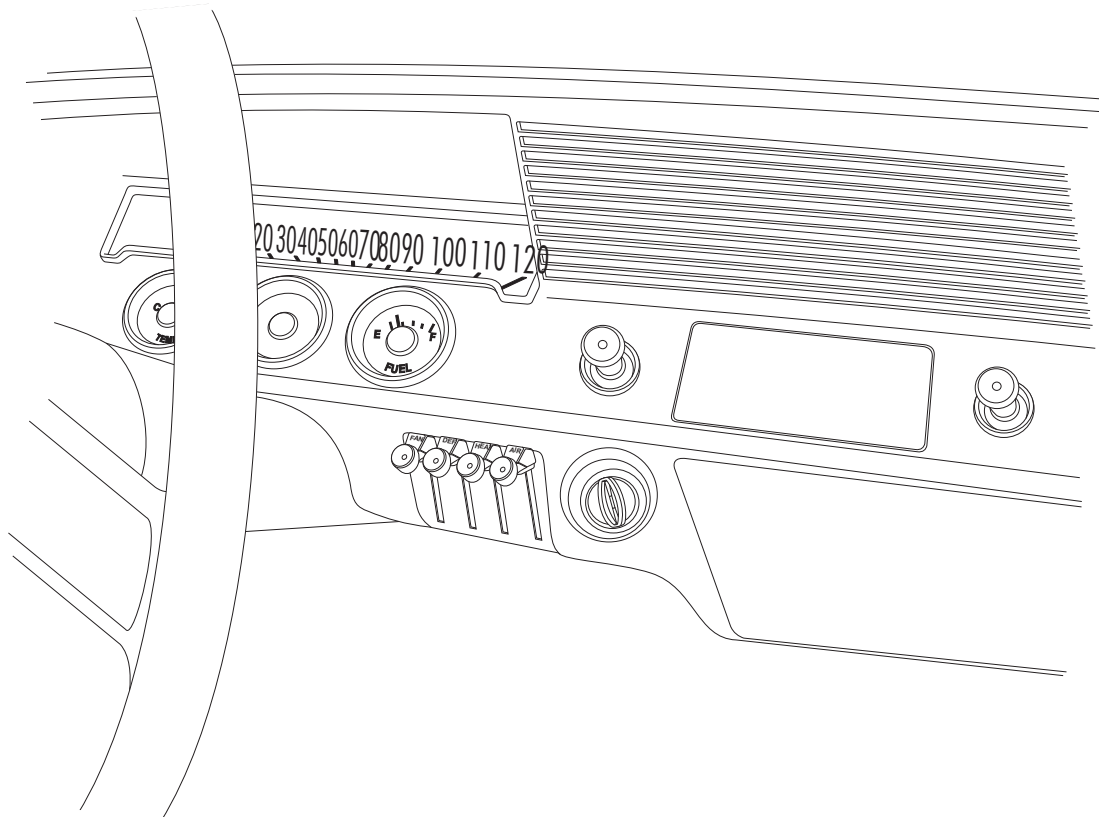

1961-62 IMPALA

CONTROL PANEL
CONVERSION KIT
471062



18865 GOLL ST. - SAN ANTONIO, TX. - 78266 ph.210-654-7171 - fax 210-654-3113



Table of Contents

PAGES

1. COVER
2. TABLE OF CONTENTS
3. PACKING LIST/ PARTS DISCLAIMER
4. REMOVING OEM CONTROL PANEL & SLIDE POT MODIFICATIONS
SLIDE POT ASM MOUNTING CLAMP INSTALLATION SLIDE POT ASM
FIGURES 1,2 & 3
5. DASH/FLR/DEF SLIDE POT ASM INSTALLATION
FIGURES 4
6. CONTROL HARNESS
FIGURES 5 & 5a
7. COLD/HOT SLIDE POT ASM INSTALLATION & CONTROL HARNESS
FIGURES 6 & 6a
8. CONTROL HARNESS CONT. & OFF/ HI SLIDE POT ASM INSTALLATION
FIGURES 6b & 7
9. CONTROL HARNESS
FIGURES 7a & 7b
10. CONTROL HARNESS CONT. & FINAL STEPS
FIGURE 8 & 9
11. FINAL STEPS CONT.
FIGURE 10
12. CONTROL PANEL CALIBRATION PROCEDURE
13. WIRING DIAGRAM
14. OPERATION OF CONTROLS
15. CONTROL PANEL KIT PACKING LIST



CONTROL KIT PACKING LIST

**CONTROL KIT
471062**

No.	QTY.	PART No.	DESCRIPTION	
1.	3	112002-SUA	SLIDE POT ASM	_____
2.	1	232006-VUR	GEN IV UNIVERSAL CONTROL HARNESS (TYPE B)	_____
3.	3	65976-VUE	3/16" PUSH-ON RING	_____
4.	3	491010-VUR	SLIDE POT CLAMP	_____
5.	5	21301-VUP	4" TIE WRAP	_____
6.	1	231520	GROUND WIRE	_____

**** BEFORE BEGINNING INSTALLATION OPEN ALL PACKAGES AND CHECK CONTENTS OF SHIPMENT. PLEASE REPORT ANY SHORTAGES DIRECTLY TO VINTAGE AIR WITHIN 15 DAYS. AFTER 15 DAYS, VINTAGE AIR WILL NOT BE RESPONSIBLE FOR MISSING OR DAMAGED ITEMS.**

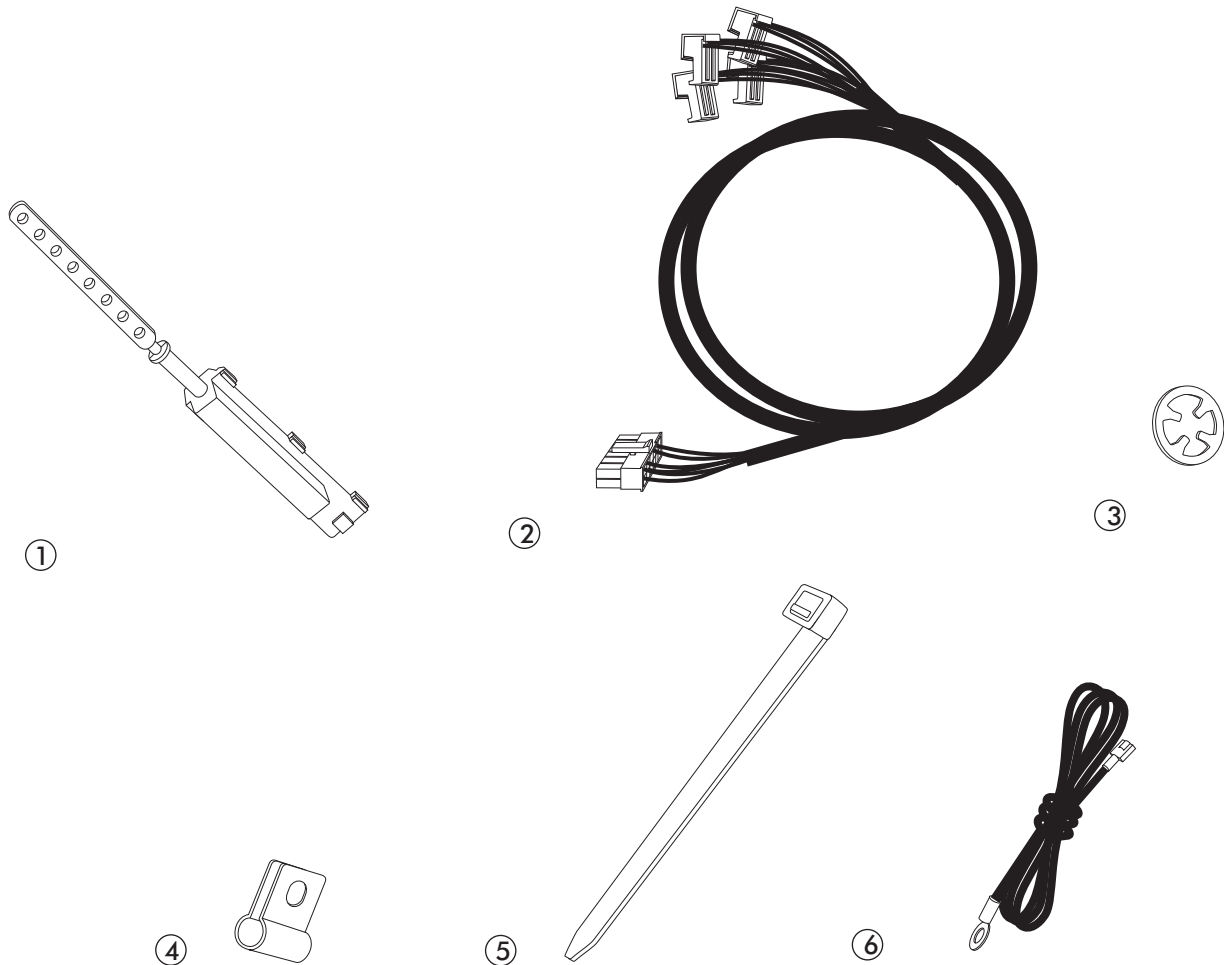



CONTROL PANEL CONVERSION INSTRUCTIONS FOR 1961-62 IMPALA w/ AC

REMOVING OEM CONTROL PANEL

- REMOVE THE (4) OEM LEVER KNOBS AND THE (4) OEM MOUNTING SCREWS FROM INSTRUMENT PANEL OF DASH. SEE FIGURE 1 BELOW.
- DISCONNECT CABLES AND WIRES FROM BACK OF CONTROL PANEL.
- REMOVE THE CONTROL PANEL FROM BEHIND THE DASH.

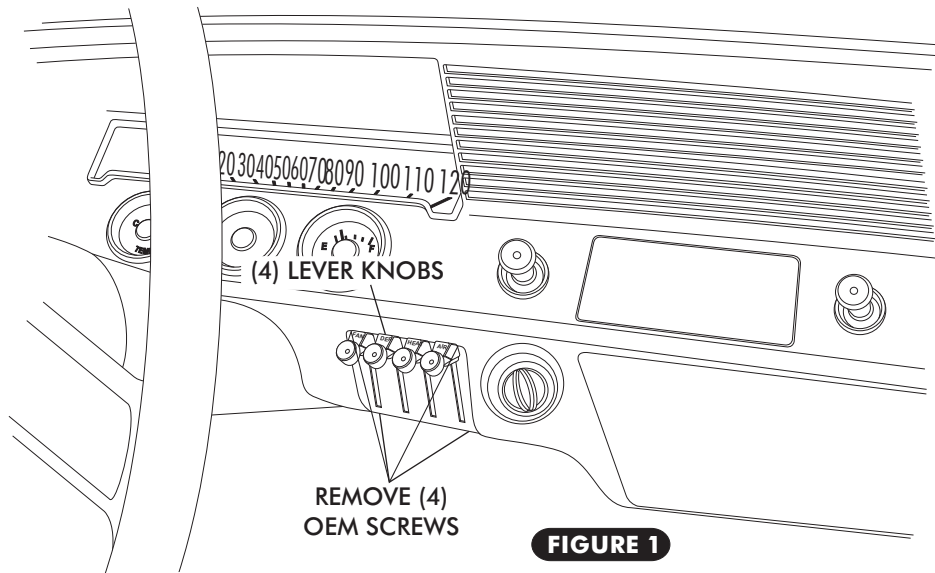

FIGURE 1

SLIDE POT ASSEMBLY MODIFICATIONS

- LOCATE THE THREE SLIDE POT ASSEMBLIES, AND USING A PAIR OF WIRE CUTTERS, CUT SLIDE POT ACTUATOR RODS AS SHOWN BELOW IN FIGURE 2.

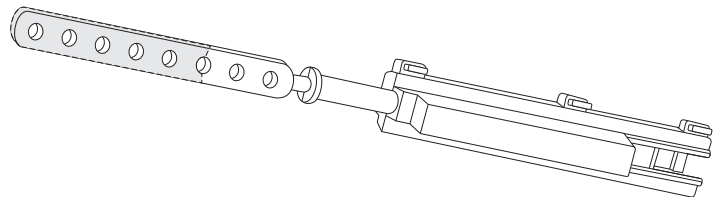
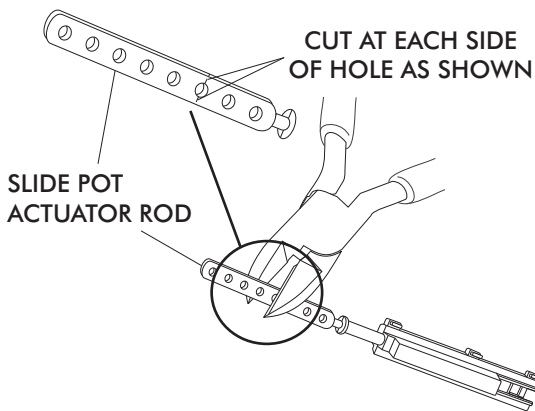

FIGURE 2

CUT ALL THREE SLIDE POT ASSEMBLIES AT 3RD HOLE (REMOVE SHADED PORTION)

SLIDE POT ASSEMBLY MOUNTING CLAMP INSTALLATION

- INSTALL SLIDE POT ASM MOUNTING CLAMPS. SEE FIGURE 3 BELOW.

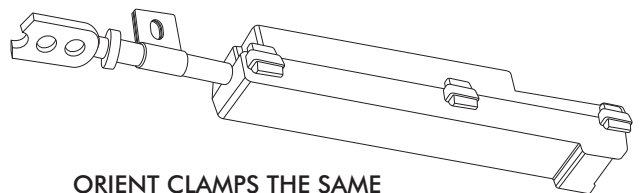
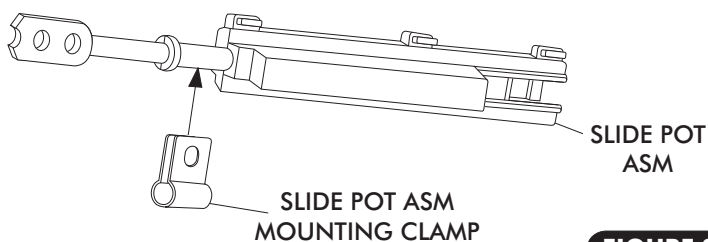

FIGURE 3

ORIENT CLAMPS THE SAME DIRECTION FOR ALL (3) SLIDE POT ASSEMBLIES

ORIENT SLIDE POT ASSEMBLIES AS SHOWN AND INSTALL MOUNTING CLAMPS AS SHOWN. (NOTE: ORIENT CLAMPS IN RELATION TO THE (3) HOUSING SNAPS ON SLIDE POT ASSEMBLY)



SLIDE POT ASSEMBLY INSTALLATION

DASH/FLR/DEF SLIDE POT ASSEMBLY

- INSTALL SLIDE POT ASM ON THE DASH/FLR/DEF LEVER. SEE FIGURE 4 BELOW.
- INSTALL SLIDE POT LEVER PUSH ROD ONTO OEM CABLE MOUNTING STUD ON LEVER. SEE FIGURE 4 BELOW.
- SECURE THE SLIDE POT ASM TO THE CONTROL PANEL USING THE OEM SCREW IN THE OEM CABLE CLAMP MOUNTING LOCATION. SEE FIGURE 4 BELOW.
- SINCE THE SLIDE POT ASSEMBLY CAN SLIDE BACK AND FORTH IN CLAMP BEFORE SCREW IS TIGHTENED, POSITION SLIDE POT ASSEMBLY SUCH THAT THE FLAT PART OF THE ROD IS AS CLOSE TO FLUSH AS POSSIBLE WITH THE END OF HOUSING AT THE LEVER'S INNER MOST POSITION. SEE FIGURE 4 BELOW.
- SECURE SLIDE POT LEVER PUSH ROD ONTO OEM CABLE MOUNTING STUD USING 3/16" PUSH-ON RING AS SHOWN IN FIGURE 4 BELOW.

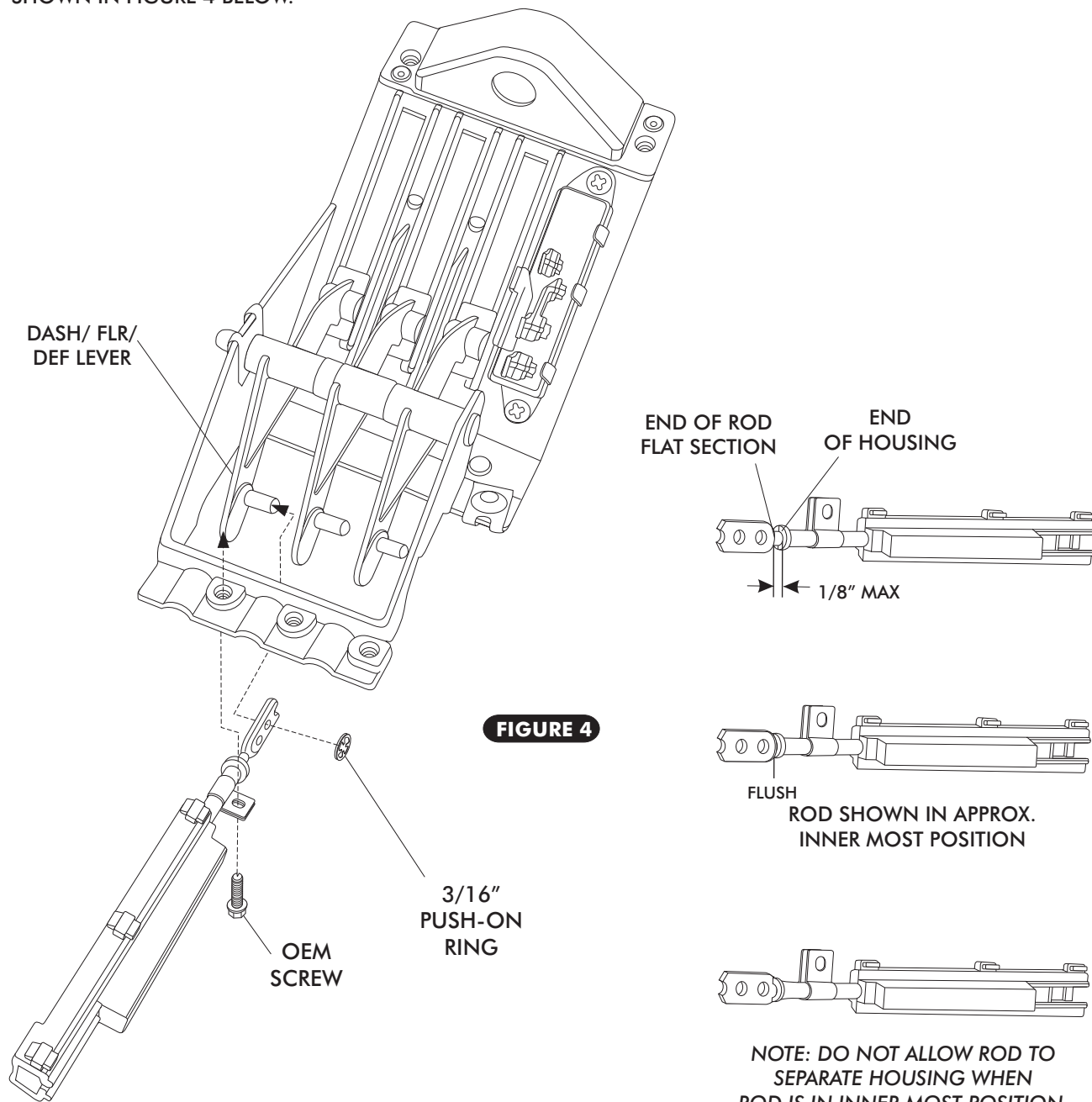

FIGURE 4

NOTE: DO NOT ALLOW ROD TO SEPARATE HOUSING WHEN ROD IS IN INNER MOST POSITION.



CONTROL HARNESS

- LOCATE THE CONTROL PANEL WIRE HARNESS AND PLUG THE CORRESPONDING WIRES INTO THE CORRECT SLIDE POT ASSEMBLY AS SHOWN IN FIGURE 5 BELOW.

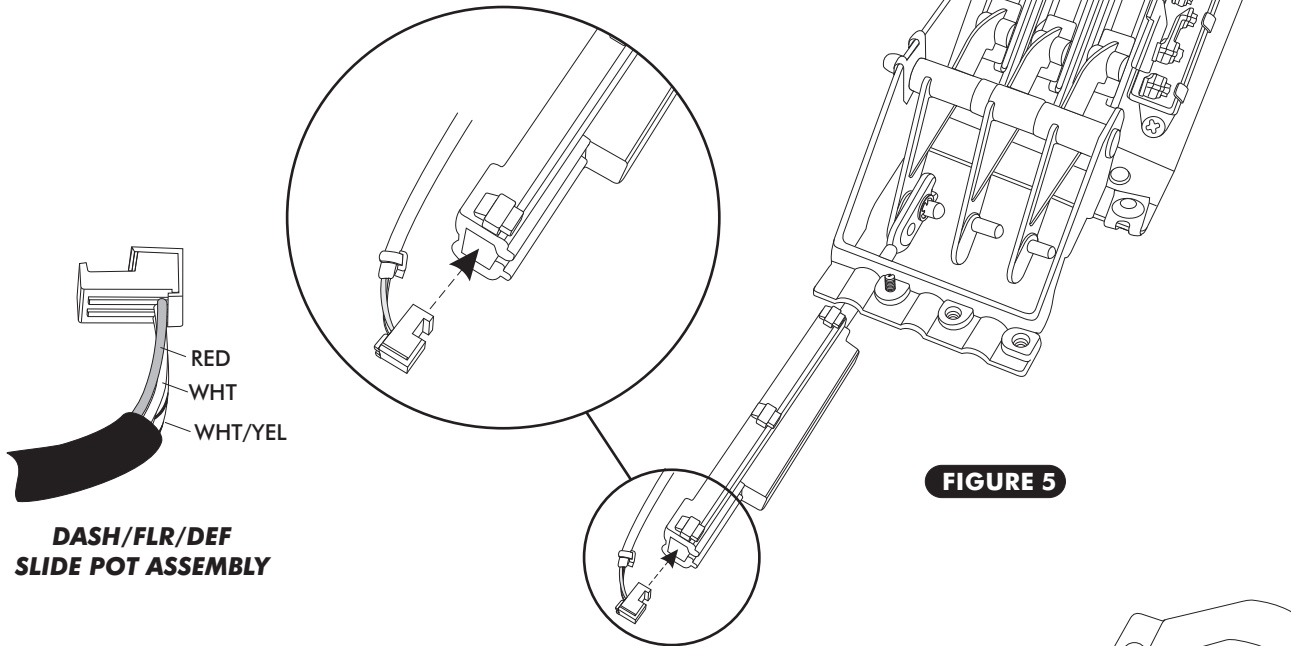

- ONCE WIRES ARE CORRECTLY PLUGGED INTO SLIDE POT ASSEMBLY, SECURE WIRES TO THE SLIDE POT ASSEMBLY USING TIE WRAPS (SUPPLIED). SEE FIGURE 5a BELOW. THE TIE WRAP MUST BE LOCATED BETWEEN THE END OF THE WIRE JACKET AND THE STEP IN THE SLIDE POT HOUSING FORCING A BEND IN EACH WIRE AS THEY PASS OVER THE STEP IN SLIDE POT HOUSING. HEAD OF TIE WRAP MUST FALL ON EDGE OF HOUSING AS SHOWN TO REMAIN TIGHT. ENSURE THAT THE TIE WRAPS ARE SNUG ENOUGH THAT THE WIRES CANNOT MOVE. SEE FIGURE 5a.

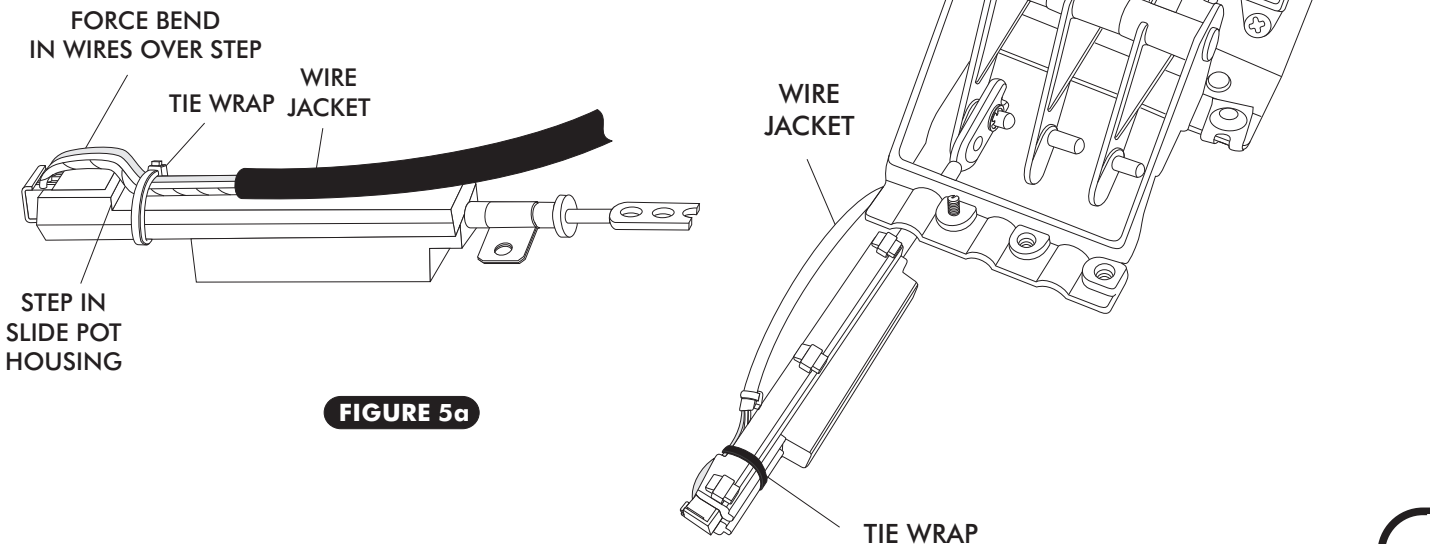



COLD/HOT SLIDE POT ASSEMBLY

- ❑ INSTALL SLIDE POT ASM ON THE COLD/HOT LEVER. SEE FIGURE 6 BELOW.
- ❑ INSTALL SLIDE POT LEVER PUSH ROD ONTO OEM CABLE MOUNTING STUD ON LEVER. SEE FIGURE 6 BELOW.
- ❑ SECURE THE SLIDE POT ASM TO THE CONTROL PANEL USING THE OEM SCREW IN THE OEM CABLE CLAMP MOUNTING LOCATION. SEE FIGURE 6 BELOW.
- ❑ SINCE THE SLIDE POT ASSEMBLY CAN SLIDE BACK AND FORTH IN CLAMP BEFORE SCREW IS TIGHTENED, POSITION SLIDE POT ASSEMBLY SUCH THAT THE FLAT PART OF THE ROD IS AS CLOSE TO FLUSH AS POSSIBLE WITH THE END OF HOUSING AT THE LEVER'S INNER MOST POSITION. SEE FIGURE 4, PAGE 5.
- ❑ SECURE SLIDE POT LEVER PUSH ROD ONTO OEM CABLE MOUNTING STUD USING 3/16" PUSH-ON RING AS SHOWN IN FIGURE 6 BELOW.

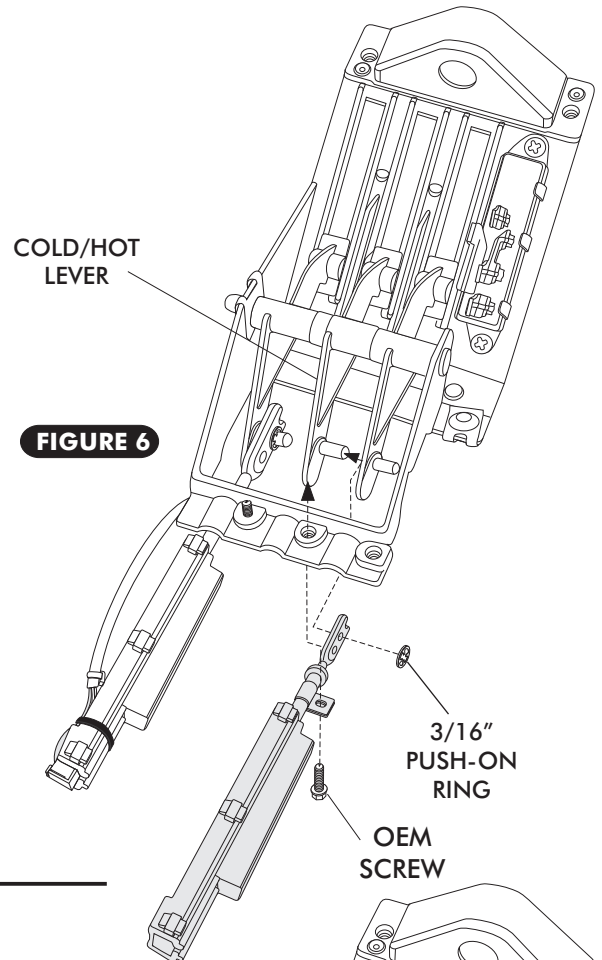

FIGURE 6

CONTROL HARNESS

- ❑ LOCATE THE CONTROL PANEL WIRE HARNESS, PLUG THE CORRESPONDING WIRES INTO THE CORRECT SLIDE POT ASSEMBLY AS SHOWN IN FIGURE 6a BELOW.

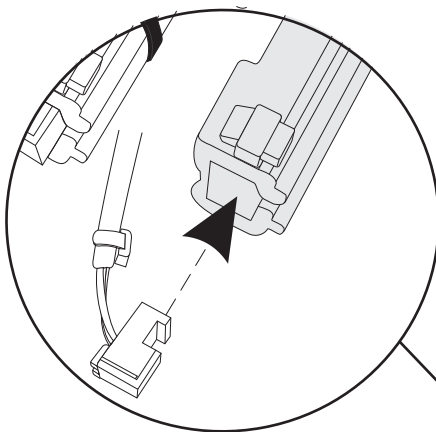
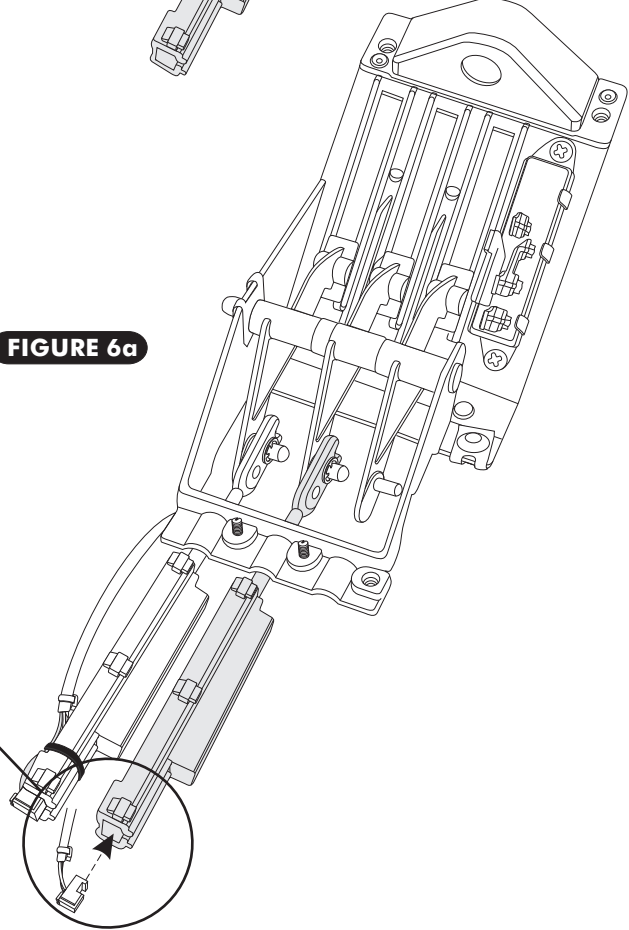
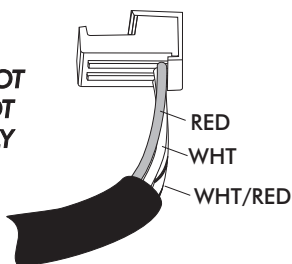

FIGURE 6a

**COLD/ HOT
SLIDE POT
ASSEMBLY**





CONTROL HARNESS CONT

- ONCE WIRES ARE CORRECTLY PLUGGED INTO SLIDE POT ASSEMBLY, SECURE WIRES TO THE SLIDE POT ASSEMBLY USING TIE WRAPS (SUPPLIED). SEE FIGURE 6b BELOW. THE TIE WRAP MUST BE LOCATED BETWEEN THE END OF THE WIRE JACKET AND THE STEP IN THE SLIDE POT HOUSING FORCING A BEND IN EACH WIRE AS THEY PASS OVER THE STEP IN SLIDE POT HOUSING. HEAD OF TIE WRAP MUST FALL ON EDGE OF HOUSING AS SHOWN TO REMAIN TIGHT. ENSURE THAT THE TIE WRAPS ARE SNUG ENOUGH THAT THE WIRES CANNOT MOVE. SEE FIGURE 6b.

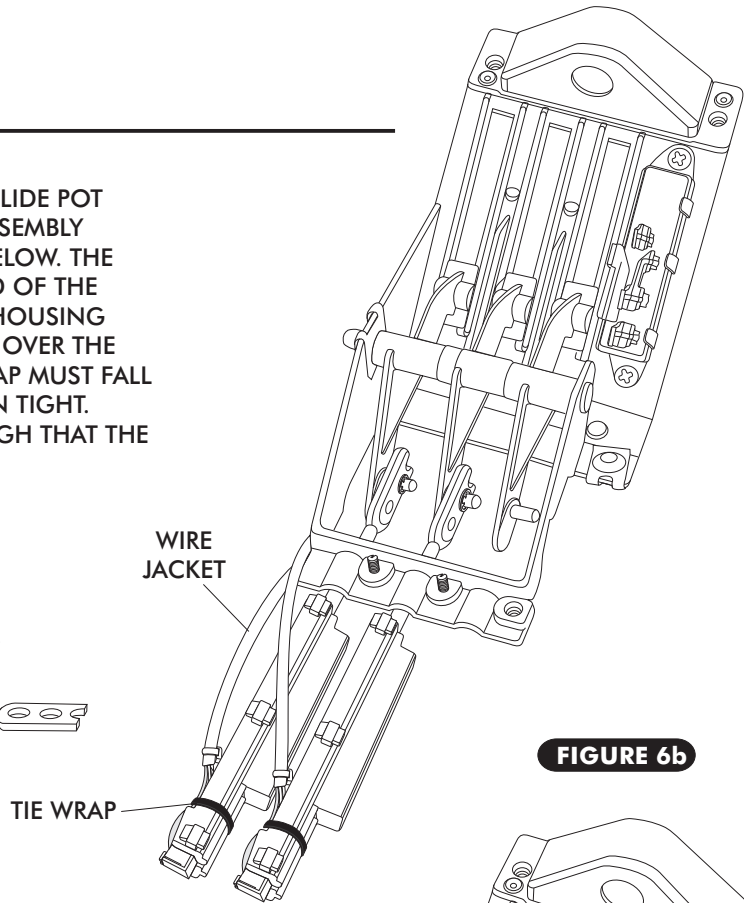
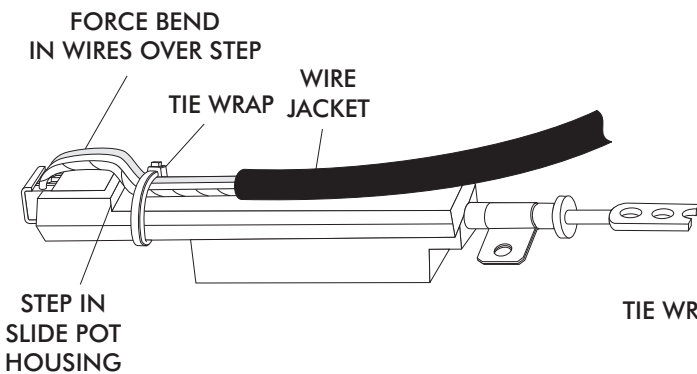

FIGURE 6b

OFF/HI SLIDE POT ASSEMBLY

- INSTALL SLIDE POT ASM ON THE OFF/ HI LEVER. SEE FIGURE 7 BELOW.
- INSTALL SLIDE POT LEVER PUSH ROD ONTO OEM CABLE MOUNTING STUD ON LEVER. SEE FIGURE 7 BELOW.
- SECURE THE SLIDE POT ASM TO THE CONTROL PANEL USING THE OEM SCREW IN THE OEM CABLE CLAMP MOUNTING LOCATION. SEE FIGURE 7 BELOW.
- SINCE THE SLIDE POT ASSEMBLY CAN SLIDE BACK AND FORTH IN CLAMP BEFORE SCREW IS TIGHTENED, POSITION SLIDE POT ASSEMBLY SUCH THAT THE FLAT PART OF THE ROD IS AS CLOSE TO FLUSH AS POSSIBLE WITH THE END OF HOUSING AT THE LEVER'S INNER MOST POSITION. SEE FIGURE 4, PAGE 5.
- SECURE SLIDE POT LEVER PUSH ROD ONTO OEM CABLE MOUNTING STUD USING 3/16" PUSH-ON RING AS SHOWN IN FIGURE 7 BELOW.

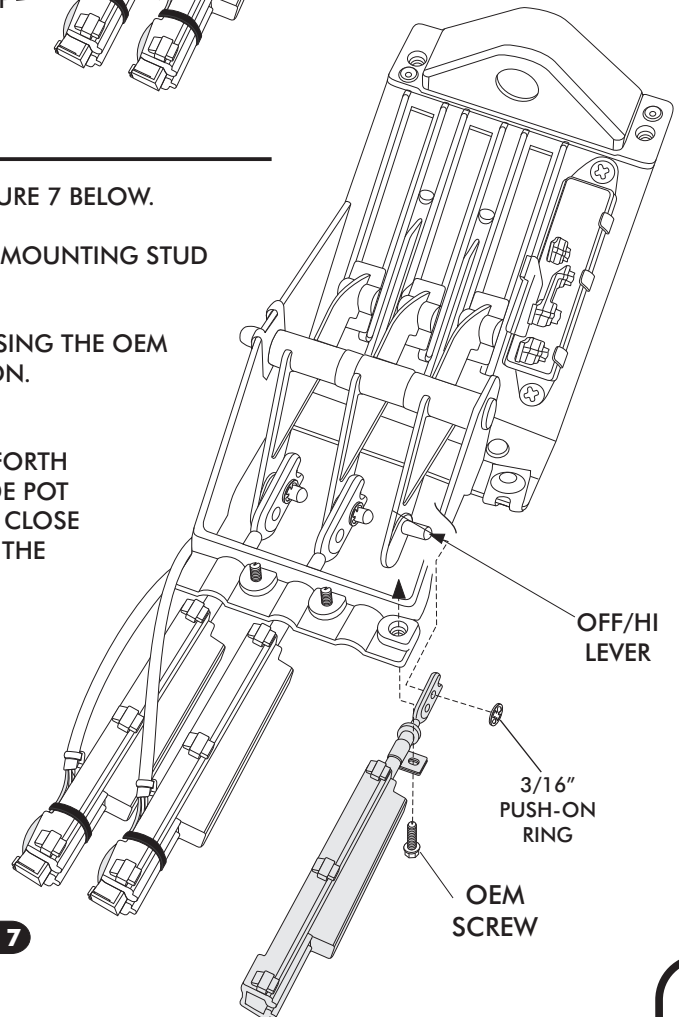

FIGURE 7



CONTROL HARNESS

- LOCATE THE CONTROL PANEL WIRE HARNESS AND PLUG THE CORRESPONDING WIRES INTO THE CORRECT SLIDE POT ASSEMBLY AS SHOWN IN FIGURE 7a BELOW.

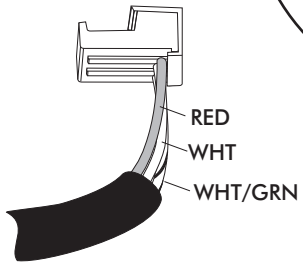
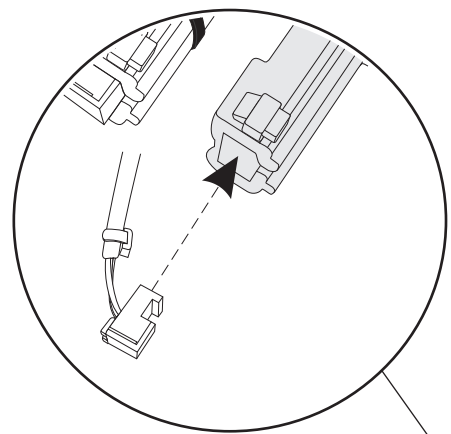

FIGURE 7a

OFF/ HI SLIDE POT ASSEMBLY

- ONCE WIRES ARE CORRECTLY PLUGGED INTO SLIDE POT ASSEMBLY, SECURE WIRES TO THE SLIDE POT ASSEMBLY USING TIE WRAPS (SUPPLIED). SEE FIGURE 7b BELOW. THE TIE WRAP MUST BE LOCATED BETWEEN THE END OF THE WIRE JACKET AND THE STEP IN THE SLIDE POT HOUSING FORCING A BEND IN EACH WIRE AS THEY PASS OVER THE STEP IN SLIDE POT HOUSING. HEAD OF TIE WRAP MUST FALL ON EDGE OF HOUSING AS SHOWN TO REMAIN TIGHT. ENSURE THAT THE TIE WRAPS ARE SNUG ENOUGH THAT THE WIRES CANNOT MOVE. SEE FIGURE 7b.

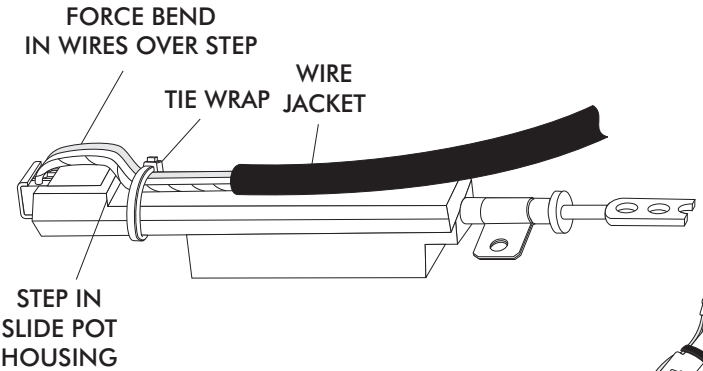
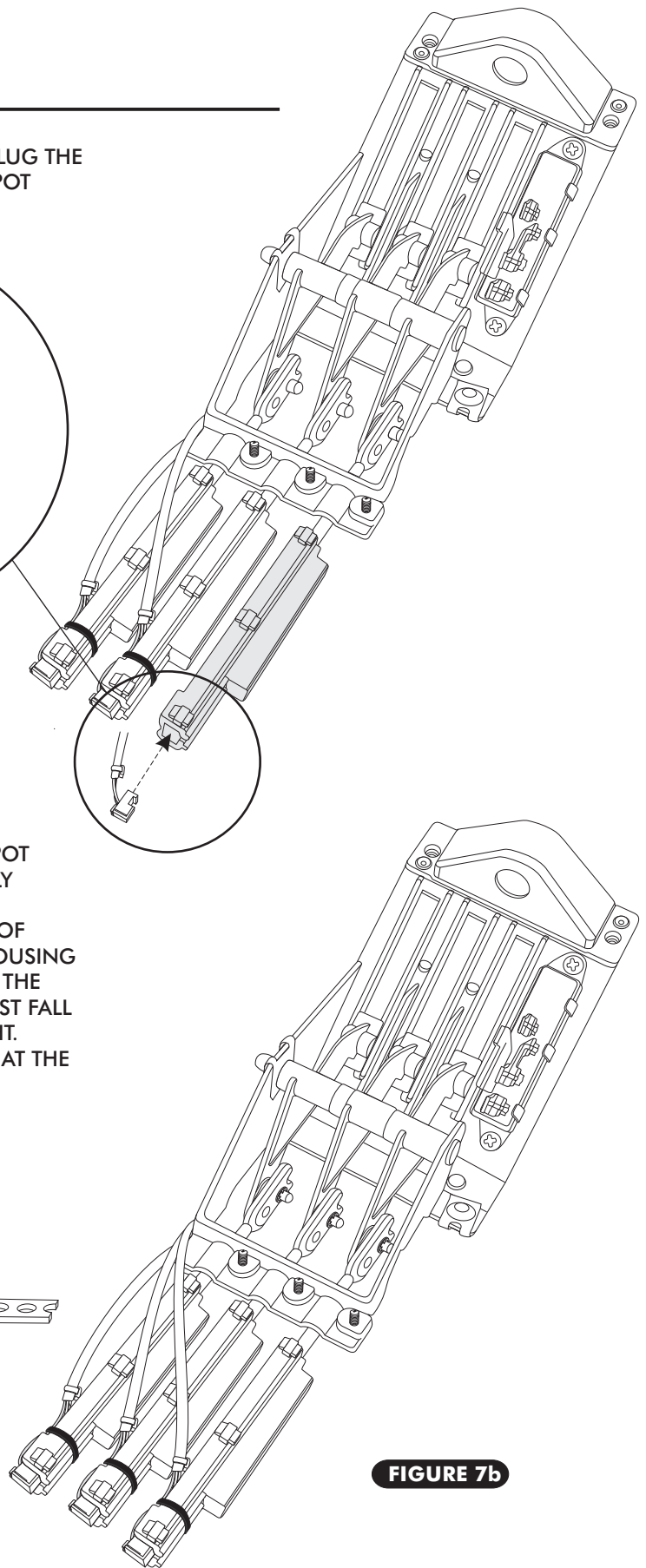

FIGURE 7b





CONTROL HARNESS CONT.

- USING THE SUPPLIED TIE-WRAPS, TIE THE WIRES TO THE CONTROL PANEL AS SHOWN IN FIGURE 8 BELOW. CONFIRM THAT WIRES ARE SECURED AND DO NOT INTERFERE WITH LEVER OPERATION OR SLIDE POT ASSEMBLY.

NOTE: TIE THE UNUSED WIRE TO THE CONTROL PANEL APPROXIMATELY AS SHOWN, ENSURE THAT THE WIRE DOES NOT INTERFERE WITH LEVERS OR SLIDE POT ASSEMBLIES.

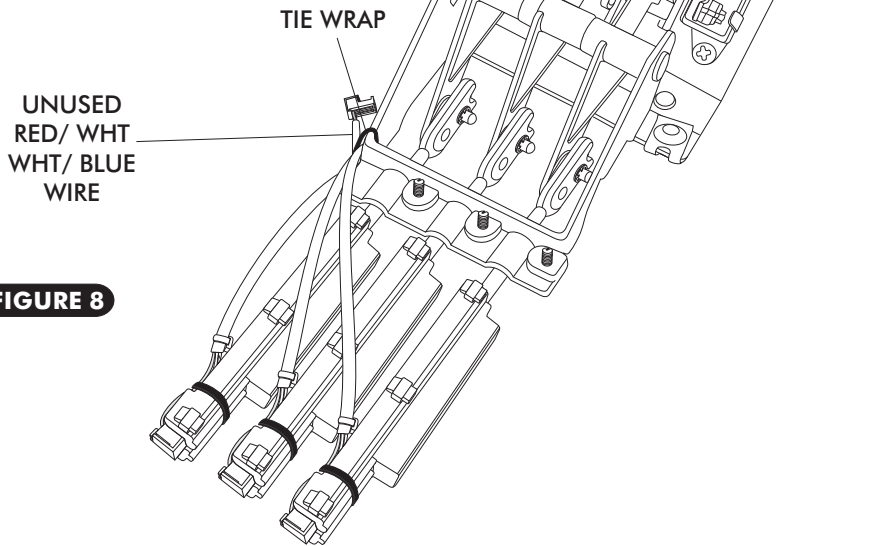

FIGURE 8

FINAL STEPS

- RE-INSTALL CONTROL PANEL IN DASH.
- ONCE CONTROL PANEL IS INSTALLED, INSTALL THE (4) MODE LEVER KNOBS AS SHOWN IN FIGURE 9 BELOW. NOTE: THE FIRST LEVER (HEAT) WILL NOT BE USED.

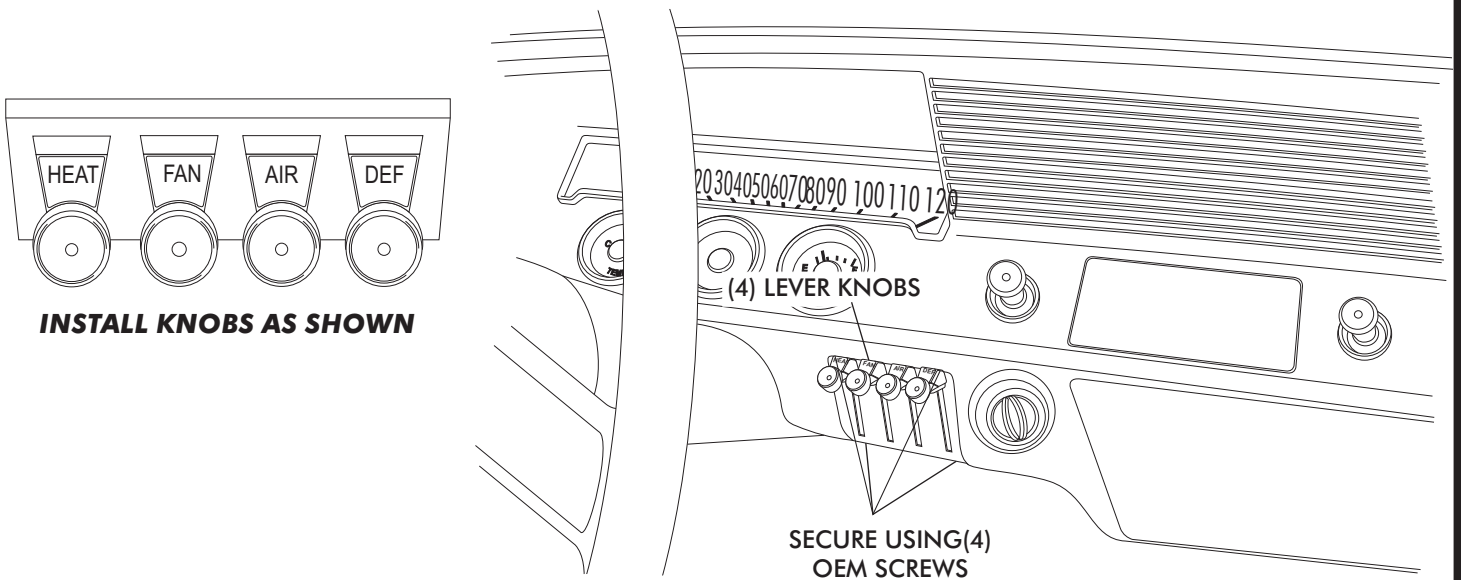

FIGURE 9



FINAL STEPS CONT.

- PLUG THE WIRING HARNESS INTO THE ECU MODULE ON SUB CASE. SEE FIGURE 10 BELOW.
- WIRE ACCORDING TO WIRING DIAGRAM ON PAGE 13.
- CONTROL PANEL CALIBRATION PROCEDURE AND OPERATION INSTRUCTIONS:
 - CALIBRATING THE CONTROL PANEL WILL SET THE RANGE OF TRAVEL FOR THE SLIDE POTS CONNECTED TO THE OEM CONTROL PANEL LEVERS. PERFORMING THIS PROCEDURE WILL SET THE LIMITS OF THE SLIDE POTS AT THEIR HIGHEST AND LOWEST POINTS
 - LOCATE THE GRAY WIRE WITH AN UNUSED CONNECTOR IN THE WIRING HARNESS NEAR THE TWO CABLE HARNESS RELAYS. THE WIRE IS LABELED PRGM ON THE WIRING DIAGRAM ON PAGE 13.
 - IT WILL BE NECESSARY TO GROUND THE GRAY WIRE FOR APPROXIMATELY FIVE SECONDS WHILE MOVING THE CONTROLS SO IT IS SOMETIMES HELPFUL TO ATTACH ONE END OF THE WHITE JUMPER WIRE TO THE VEHICLE'S GROUND (FOR EXAMPLE THE CHASSIS) AND HAVE THE OTHER END READY TO CONNECT TO THE GRAY PRGM WIRE WHEN THE PROCEDURE REQUIRES IT.
 - TO CALIBRATE THE CONTROL PANEL FOLLOW THE CALIBRATION PROCEDURES ON PAGE 12.

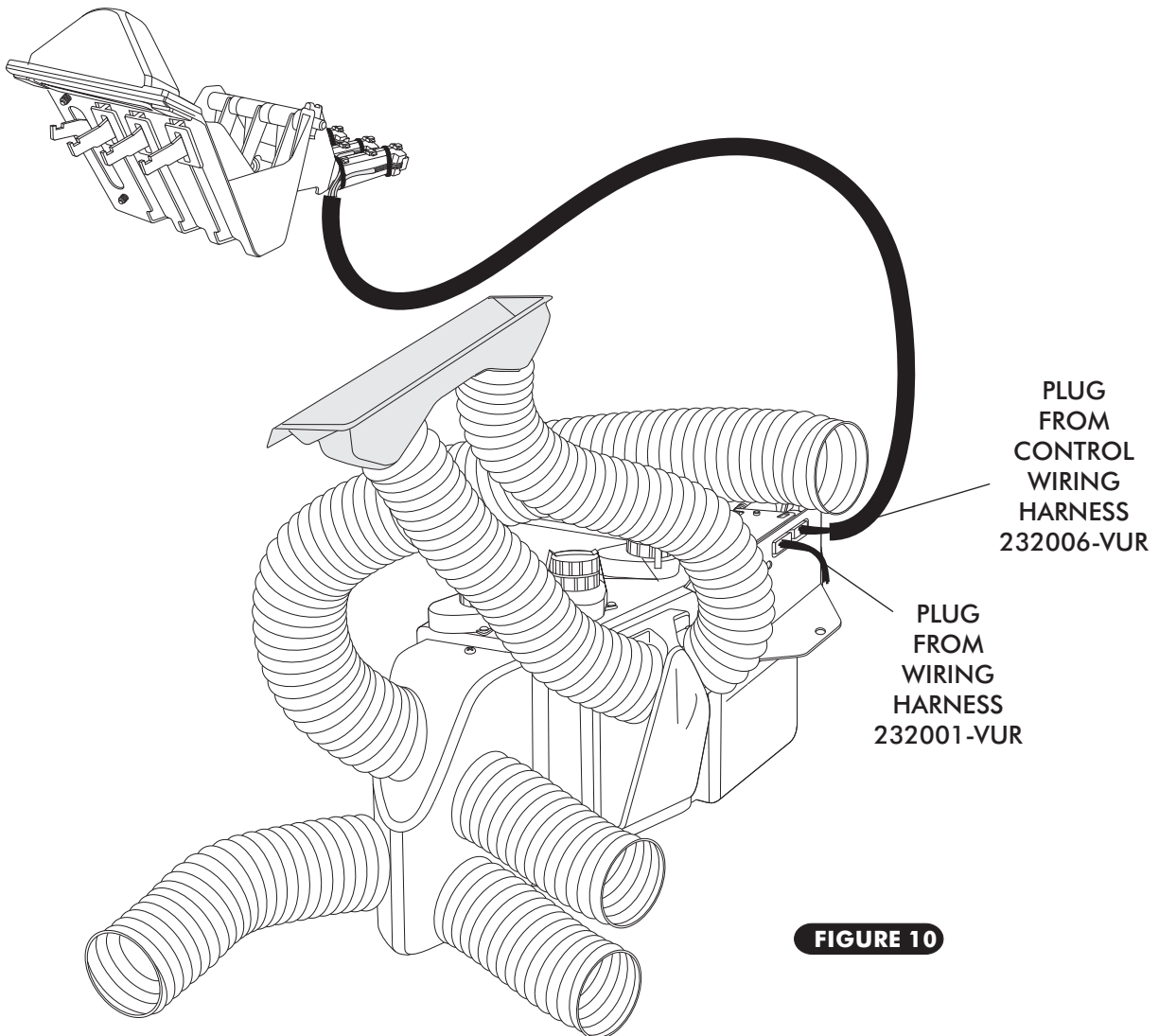
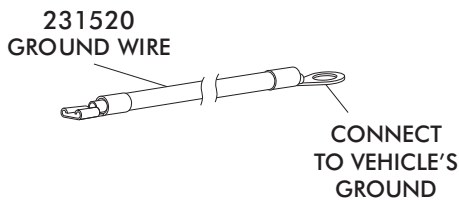

FIGURE 10



CONTROL PANEL CALIBRATION PROCEDURE

1. TURN THE IGNITION SWITCH ON (DO NOT START THE ENGINE)
2. CONNECT THE WHITE JUMPER WIRE TO VEHICLE'S GROUND (FOR EXAMPLE THE VEHICLE CHASSIS). ENSURE THAT THE GRAY WIRE IS NOT GROUNDING. DO NOT CONNECT JUMPER WIRE TO THE GRAY PRGM WIRE.



3. MOVE ALL OF THE CONTROL LEVERS TO THEIR MAXIMUM POSITIONS, AS SHOWN.

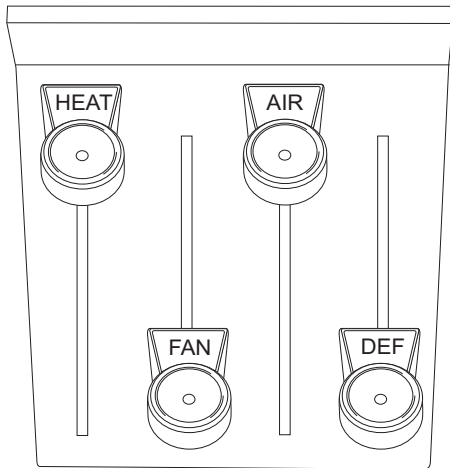

4. GROUND THE GRAY WIRE BY CONNECTING THE GRAY PRGM WIRE & WHITE JUMPER WIRE FOR APPROXIMATELY 5 SECONDS (THE BLOWER WILL CHANGE SPEEDS WHEN STEP FOUR IS COMPLETE)

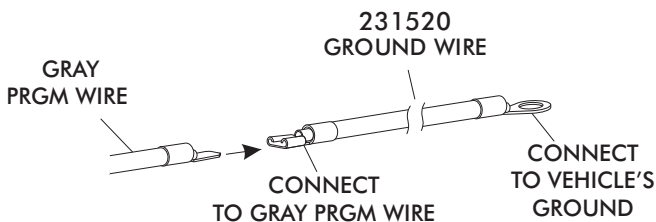

5. LEAVING THE GRAY WIRE GROUNDING, MOVE ALL OF THE CONTROL LEVERS TO THEIR MINIMUM POSITIONS AS SHOWN.

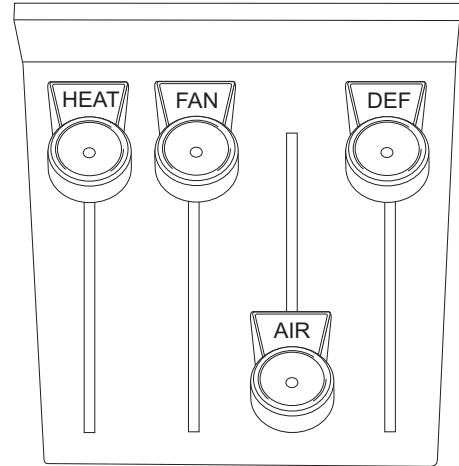

6. DISCONNECT THE GRAY WIRE FROM THE WHITE GROUND JUMPER WIRE (THE BLOWER WILL CHANGE SPEEDS WHEN STEP SIX IS COMPLETE)

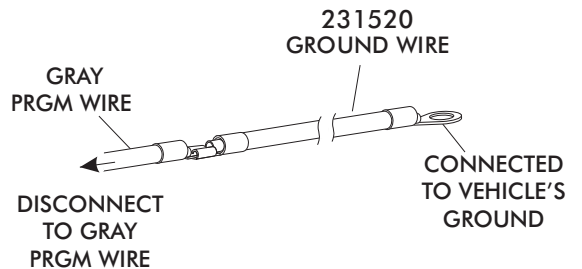

7. START THE ENGINE AND TEST ALL OF THE CONTROLS TO ENSURE THAT THE INTENDED RESULTS WERE ACCOMPLISHED.
8. DISCONNECT THE WHITE JUMPER WIRE FROM VEHICLE'S GROUND.

NOTE: THIS PROCEDURE MAY BE REPEATED IF NECESSARY.

*** WHEN FINISHED, TAPE OVER PROGRAM WIRE CONNECTOR WITH ELECTRICAL TAPE TO PREVENT ACCIDENTAL CONTACT WITH CHASSIS GROUND.**



OPERATION OF CONTROLS

NOTE: WHEN BATTERY POWER IS FIRST CONNECTED TO THE ECU, THE COMPUTER GOES THROUGH AN INITIALIZATION SEQUENCE. THIS INITIALIZATION MAY TAKE UP TO 30 SECONDS. DURING INITIALIZATION THE BLOWER WILL NOT OPERATE, BUT THE DOORS INSIDE THE UNIT WILL BE OPERATING. A LOW BATTERY OR DISCONNECTING THE BATTERY MAY ALSO TRIGGER A RE-INITIALIZATION. DURING START UP, A LOW BATTERY MAY DROP BELOW 7 VOLTS, TRIGGERING RE-INITIALIZATION.

NOTE: ORIGINAL BLOWER SWITCH WILL NOT BE USED.

BLOWER SPEED THERMOSTAT LEVER MODE LEVER

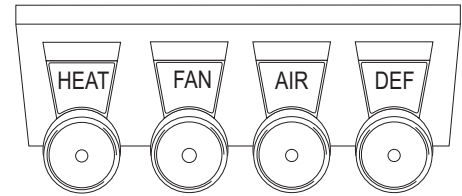

INSTALL KNOBS AS SHOWN

BLOWER SPEED
THIS LEVER CONTROLS THE BLOWER SPEED, FROM OFF TO HI

THERMOSTAT LEVER
THIS LEVER CONTROLS THE TEMPERATURE FROM HOT TO COLD

MODE LEVER
THIS LEVER CONTROLS THE MODE POSITIONS FROM DASH TO FLOOR TO DEFROST

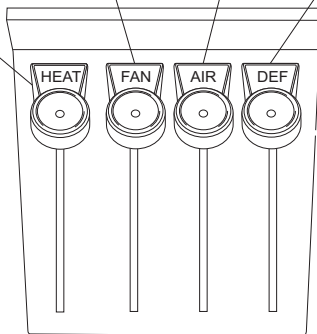

SYSTEM OFF

BLOWER SPEED
SLIDE THE FAN LEVER UP OR DOWN TO SELECT DESIRE FAN SPEED (SLIDE LEVER ALL THE WAY DOWN FOR MAXIMUM FAN SPEED)

THERMOSTAT LEVER
IN A/C MODE SLIDE THE AIR LEVER ALL THE WAY DOWN TO ENGAGE COMPRESSOR FOR MAXIMUM COOLING. (SLIDE LEVER UP OR DOWN TO ADJUST DESIRED TEMPERATURE)

MODE LEVER
SLIDE THE DEF LEVER ALL THE WAY UP FOR DASH MODE

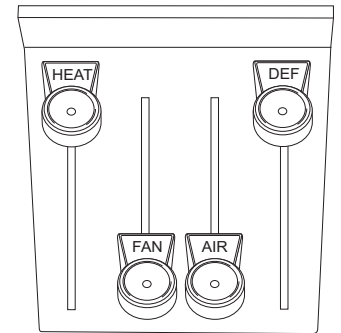

A/C MODE

BLOWER SPEED
SLIDE THE FAN LEVER UP OR DOWN TO SELECT DESIRE FAN SPEED (SLIDE LEVER ALL THE WAY DOWN FOR MAXIMUM FAN SPEED)

THERMOSTAT LEVER
IN HEAT MODE SLIDE THE AIR LEVER ALL THE WAY UP FOR MAXIMUM HEATING. (SLIDE LEVER UP OR DOWN TO ADJUST DESIRED TEMPERATURE)

MODE LEVER
SLIDE THE DEF LEVER TO THE CENTER FOR FLOOR MODE (SLIDE LEVER UP OR DOWN TO BLEND BETWEEN DESIRED MODE POSITIONS)

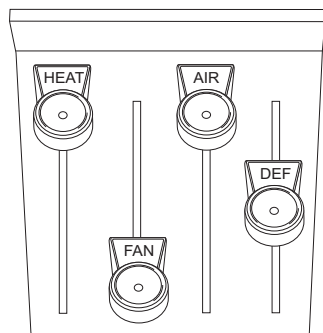

HEAT MODE

BLOWER SPEED
SLIDE THE FAN LEVER UP OR DOWN TO SELECT DESIRE FAN SPEED (SLIDE LEVER ALL THE WAY DOWN FOR MAXIMUM FAN SPEED)

THERMOSTAT LEVER
IN DEF MODE SLIDE THE AIR LEVER ALL THE WAY DOWN TO ENGAGE COMPRESSOR FOR MAXIMUM COOLING. (SLIDE LEVER UP OR DOWN TO ADJUST DESIRED TEMPERATURE)

MODE LEVER
SLIDE THE DEF LEVER ALL THE WAY DOWN FOR DEFROST MODE (SLIDE LEVER UP OR DOWN TO BLEND BETWEEN DESIRED MODE POSITIONS)

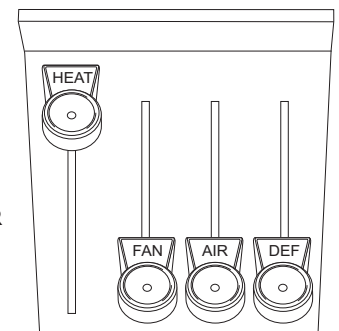

DEFROST MODE



CONTROL KIT PACKING LIST

**CONTROL KIT
471062**

No.	QTY.	PART No.	DESCRIPTION	
1.	3	112002-SUA	SLIDE POT ASM	_____
2.	1	232006-VUR	GEN IV UNIVERSAL CONTROL HARNESS (TYPE B)	_____
3.	3	65976-VUE	3/16" PUSH-ON RING	_____
4.	3	491010-VUR	SLIDE POT CLAMP	_____
5.	5	21301-VUP	4" TIE WRAP	_____
6.	1	231520	GROUND WIRE	_____

CHECKED BY: _____
 PACKED BY: _____
 DATE: _____

