

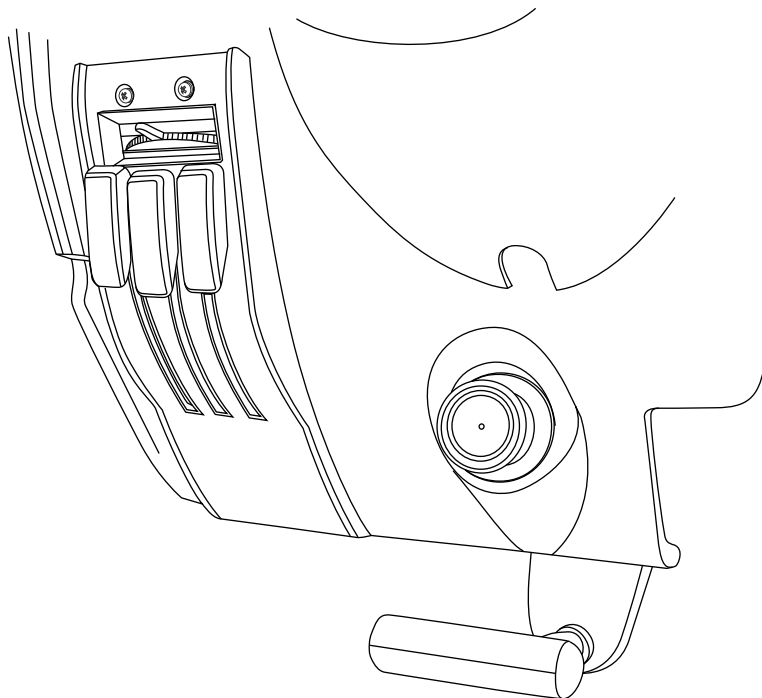

an ISO 9001: 2000 Registered Company

1967-68 MUSTANG

WITHOUT AC CONTROL PANEL
CONVERSION KIT
474267



18865 GOLL ST. - SAN ANTONIO, TX. - 78266 ph.210-654-7171 - fax 210-654-3113



Table of Contents

PAGES

1. COVER
2. TABLE OF CONTENTS
3. PACKING LIST/ PARTS DISCLAIMER
4. REMOVING OEM CONTROL PANEL
FIGURES 1 & 1a
5. CABLE CONVERTER ASSEMBLY MODIFICATIONS & CABLE CONVERTER
ASSEMBLY MOUNTING CLAMP INSTALLATION
FIGURES 2 & 3
6. OFF/ HI CABLE CONVERTER ASM INSTALLATION & CONTROL
HARNESS
FIGURES 4 & 5
7. CONTROL HARNESS CONT. & COLD/ HOT CONVERTER ASM INSTALLATION
FIGURES 6 & 7
8. CONTROL HARNESS & CONTROL HARNESS CONT.
FIGURES 8 & 9
9. DASH/ FLR/ DEF CABLE CONVERTER ASM INSTALLATION & CONTROL HARNESS
FIGURES 10 & 11
10. CONTROL HARNESS CONT. & CONTROL HARNESS FINAL STEP
FIGURES 12 & 13
11. FINAL STEP & FINAL STEPS CONT.
FIGURES 14 & 15
12. CONTROL PANEL CALIBRATION PROCEDURE
13. WIRING DIAGRAM
14. OPERATION OF CONTROLS
15. CONTROL PANEL KIT PACKING LIST



CONTROL PANEL KIT PACKING LIST

CONTROL KIT
474267

No.	QTY.	PART No.	DESCRIPTION
1.	3	112002-SUA	SLIDE POT ASM
2.	1	232006-VUR	GEN IV UNIVERSAL CONTROL HARNESS (TYPE B)
3.	3	65976-VUE	3/16" PUSH-ON RING
4.	3	491010-VUR	SLIDE POT CLAMP
5.	5	21301-VUP	4" TIE WRAP
6.	1	231520	GROUND WIRE
7.	2	18247-VUB	#10 x 1/2" SHEET METAL SCREW

**** BEFORE BEGINNING INSTALLATION OPEN ALL PACKAGES AND CHECK CONTENTS OF SHIPMENT. PLEASE REPORT ANY SHORTAGES DIRECTLY TO VINTAGE AIR WITHIN 15 DAYS. AFTER 15 DAYS, VINTAGE AIR WILL NOT BE RESPONSIBLE FOR MISSING OR DAMAGED ITEMS.**

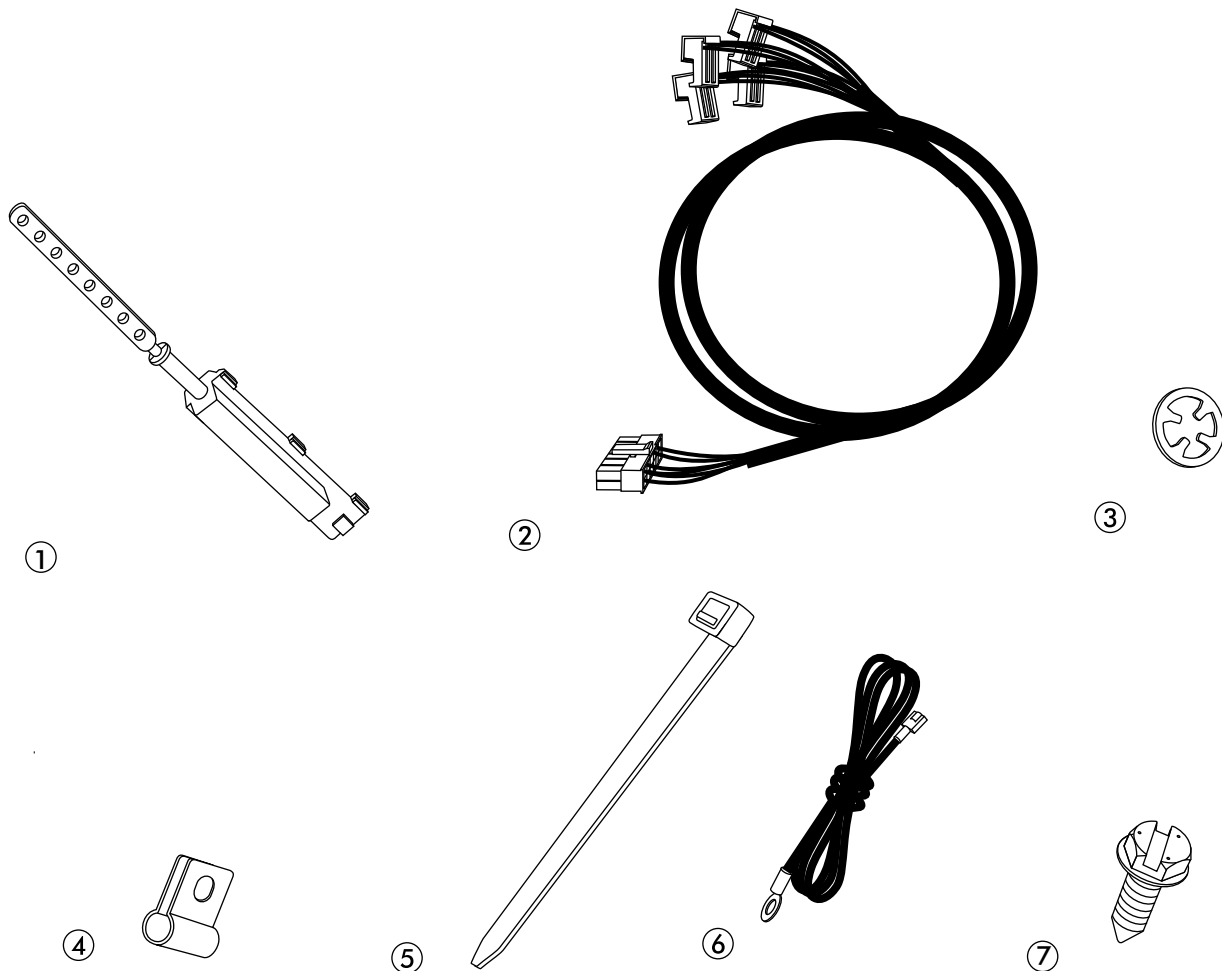



CONTROL PANEL CONVERSION INSTRUCTIONS FOR 1967-68 MUSTANG WITHOUT AC

REMOVING OEM CONTROL PANEL

- REMOVE (4) OEM MOUNTING SCREWS FROM TOP AND BOTTOM OF CONTROL PANEL (RETAIN SCREWS). SEE FIGURE 1 BELOW.
- DISCONNECT CABLES, WIRES FROM BACK OF CONTROL PANEL.
- REMOVE THE CONTROL PANEL.

68 MUSTANG SHOWN

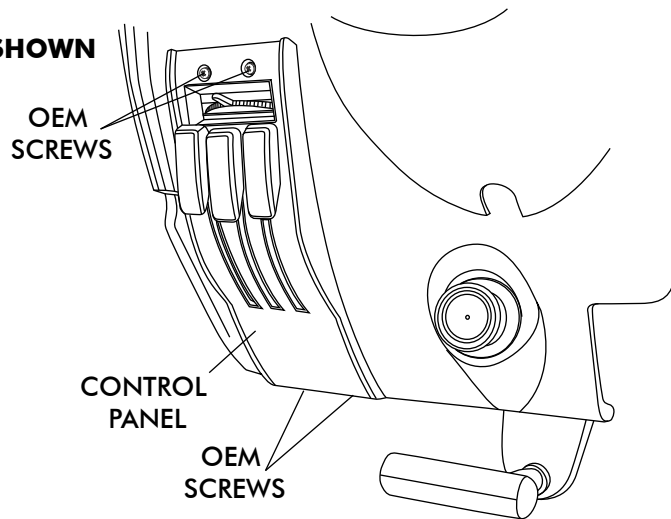

FIGURE 1

67 MUSTANG SHOWN

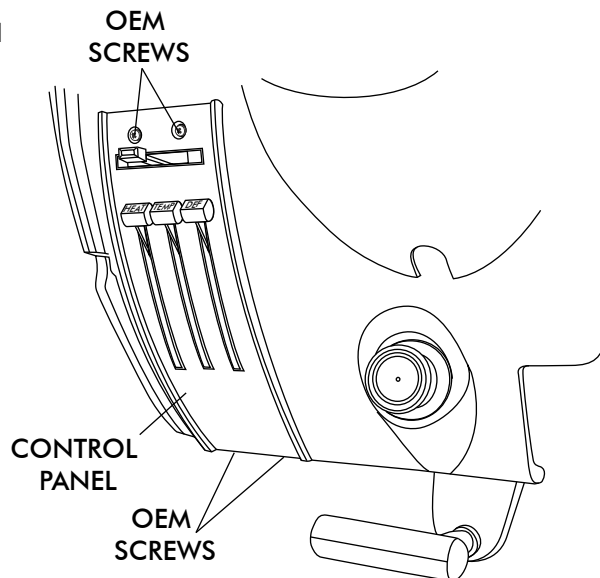
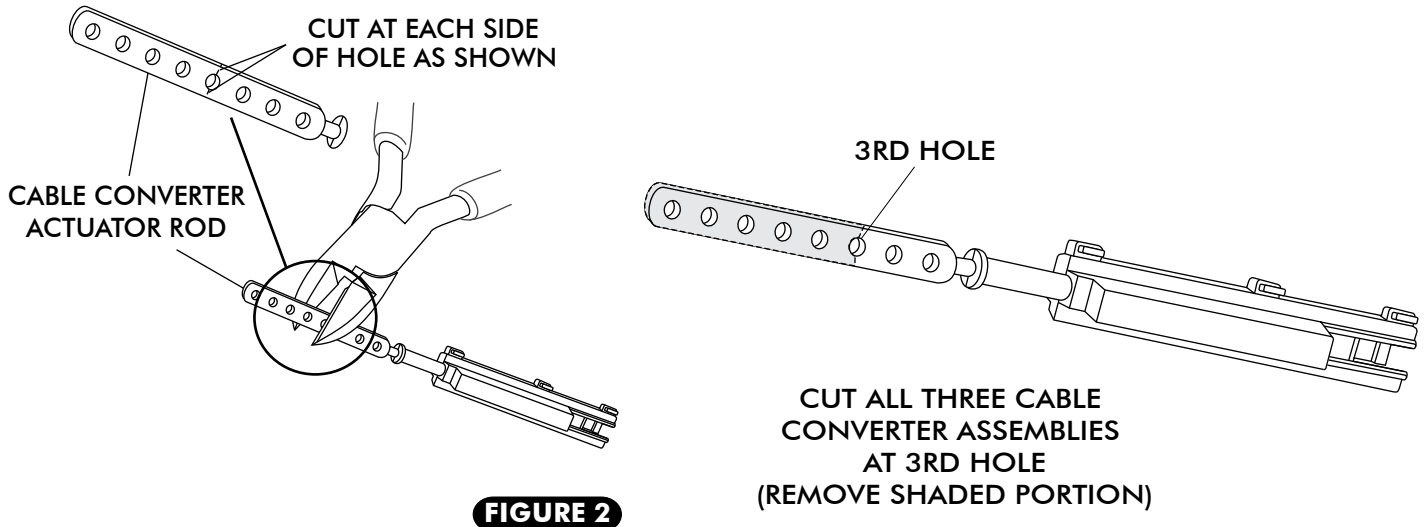

FIGURE 1a



CABLE CONVERTER ASSEMBLY MODIFICATIONS

- LOCATE THE (3) CABLE CONVERTER ASSEMBLIES, AND USING A PAIR OF WIRE CUTTERS, CUT CABLE CONVERTER ACTUATOR RODS AS SHOWN IN FIGURE 2 BELOW.



CABLE CONVERTER ASSEMBLY MOUNTING CLAMP INSTALLATION

- INSTALL CABLE CONVERTER ASM MOUNTING CLAMPS, SEE FIGURE 3 BELOW

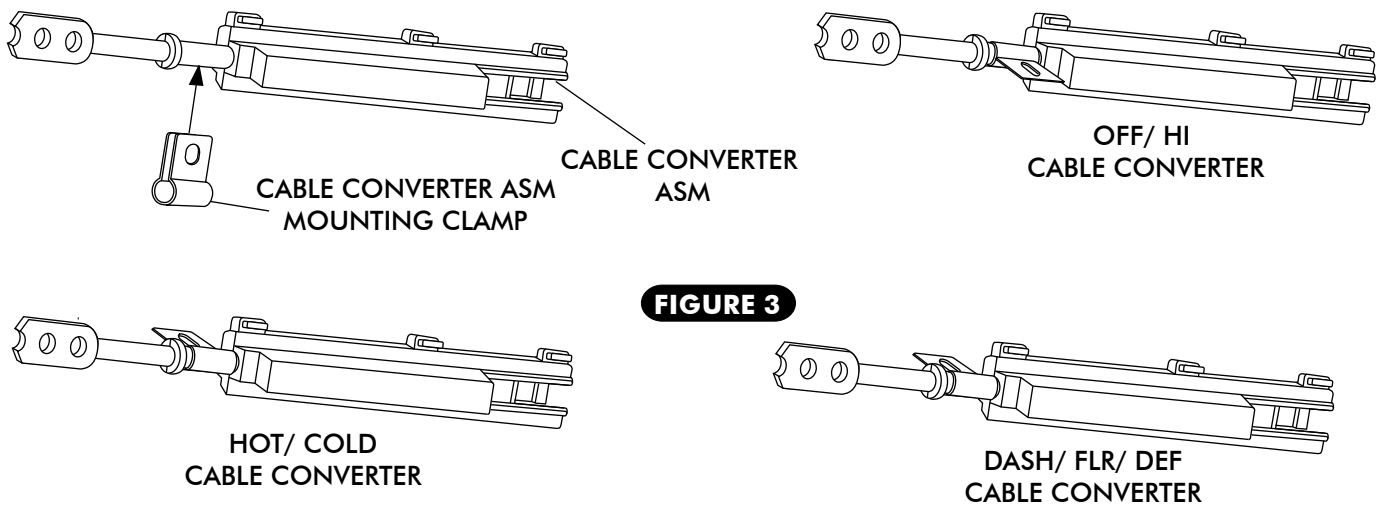

ORIENT SLIDE POT ASSEMBLIES AS SHOWN AND INSTALL MOUNTING CLAMPS AS SHOWN. (NOTE: ORIENT CLAMPS IN RELATION TO THE (3) HOUSING SNAPS ON SLIDE POT ASSEMBLY)



CABLE CONVERTER ASSEMBLY INSTALLATION

OFF/ HI CABLE CONVERTER ASSEMBLY

- INSTALL CABLE CONVERTER ASM ON THE OFF/ HI LEVER. SEE FIGURE 4 BELOW.
- INSTALL CABLE CONVERTER LEVER PUSH ROD ONTO OEM CABLE MOUNTING STUD ON LEVER. SEE FIGURE 4 BELOW.
- SECURE CABLE CONVERTER LEVER PUSH ROD ONTO OEM CABLE MOUNTING STUD USING $\frac{3}{16}$ " PUSH-ON RING AS SHOWN IN FIGURE 4 BELOW.

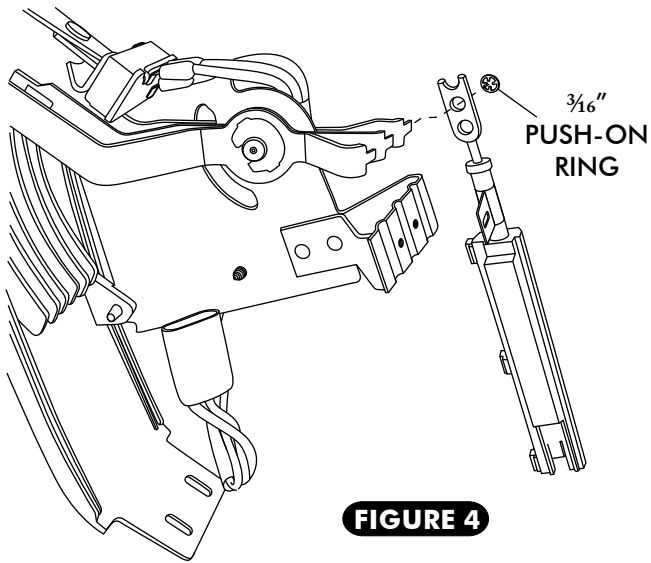
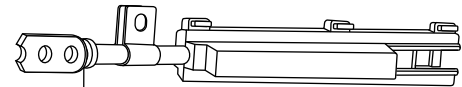
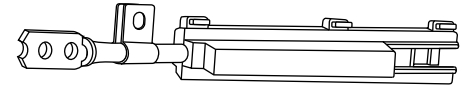

FIGURE 4



FLUSH

ROD SHOWN IN APPROX.
INNER MOST POSTION



NOTE: DO NOT ALLOW ROD TO SEPARATE
HOUSING WHEN ROD IS IN INNER
MOST POSITION.

CONTROL HARNESS

- LOCATE THE CONTROL PANEL WIRE HARNESS AND PLUG THE CORRESPONDING WIRES INTO THE CORRECT CABLE CONVERTER ASSEMBLY AS SHOWN IN FIGURE 5 BELOW.

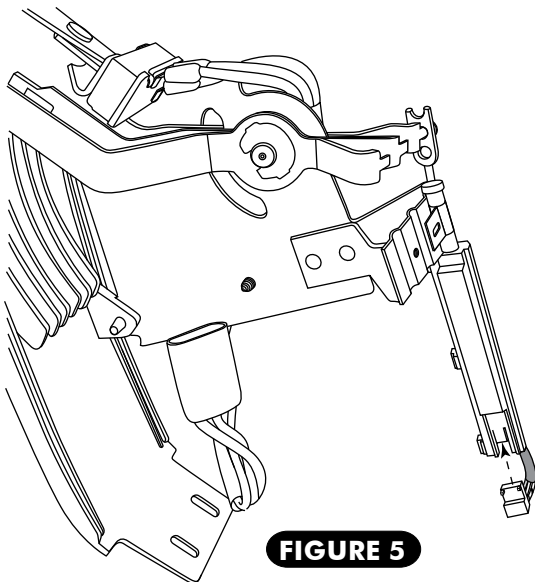
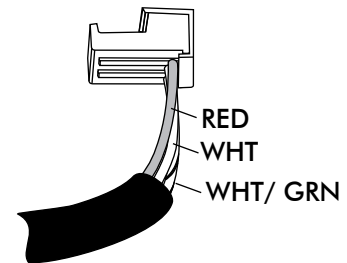

FIGURE 5



OFF/ HI
CABLE CONVERTER
ASSEMBLY



CONTROL HARNESS CONT.

- ONCE WIRES ARE CORRECTLY PLUGGED INTO CABLE CONVERTER ASSEMBLY, SECURE WIRES TO THE CABLE CONVERTER ASSEMBLY USING TIE WRAPS (SUPPLIED). SEE FIGURE 6 BELOW. THE TIE WRAP MUST BE LOCATED BETWEEN THE END OF THE WIRE JACKET AND THE STEP IN THE CABLE CONVERTER HOUSING FORCING A BEND IN EACH WIRE AS THEY PASS OVER THE STEP IN THE CABLE CONVERTER HOUSING. HEAD OF TIE WRAP MUST FALL ON EDGE OF HOUSING AS SHOWN TO REMAIN TIGHT. ENSURE THAT THE TIE WRAPS ARE SNUG ENOUGH THAT THE WIRES CANNOT MOVE. SEE FIGURE 6.

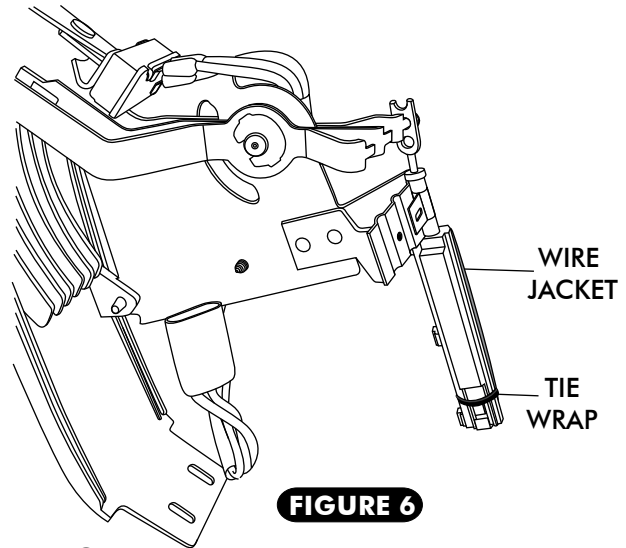
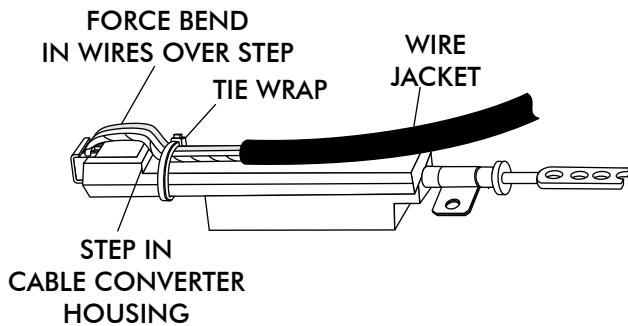
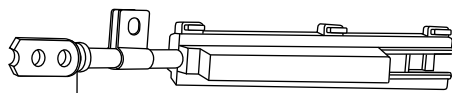

FIGURE 6

CABLE CONVERTER ASSEMBLY INSTALLATION

COLD/ HOT (TEMPERATURE BLEND DOOR) CABLE CONVERTER ASSEMBLY

- INSTALL CABLE CONVERTER ASM ON THE COLD/ HOT LEVER. SEE FIGURE 7 BELOW.
- INSTALL CABLE CONVERTER LEVER PUSH ROD ONTO OEM CABLE MOUNTING STUD ON LEVER. SEE FIGURE 7 BELOW.
- SECURE THE CABLE CONVERTER ASM TO THE CONTROL PANEL USING #10 x 1/2" SHEET METAL SCREW IN THE OEM CABLE CLAMP MOUNTING LOCATION, SEE FIGURE 7 BELOW.
- SINCE THE CABLE CONVERTER ASSEMBLY CAN SLIDE BACK AND FORTH IN CLAMP BEFORE SCREW IS TIGHTENED, POSITION CABLE CONVERTER ASSEMBLY SUCH THAT THE FLAT PART OF THE ROD IS AS CLOSE TO FLUSH AS POSSIBLE WITH THE END OF HOUSING AT THE LEVER'S INNER MOST POSITION. SEE FIGURE 7.
- SECURE CABLE CONVERTER LEVER PUSH ROD ONTO OEM CABLE MOUNTING STUD USING 3/16" PUSH-ON RING AS SHOWN IN FIGURE 7 BELOW.



FLUSH

ROD SHOWN IN APPROX. INNER MOST POSITION

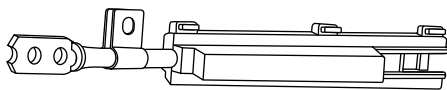

NOTE: DO NOT ALLOW ROD TO SEPARATE HOUSING WHEN ROD IS IN INNER MOST POSITION.

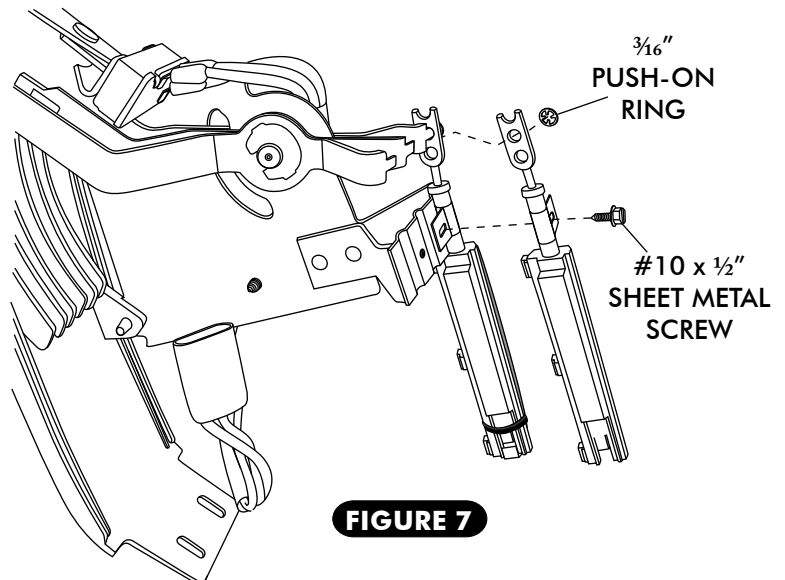

FIGURE 7



CONTROL HARNESS

- LOCATE THE CONTROL PANEL WIRE HARNESS AND PLUG THE CORRESPONDING WIRES INTO THE CORRECT CABLE CONVERTER ASSEMBLY AS SHOWN IN FIGURE 8 BELOW.

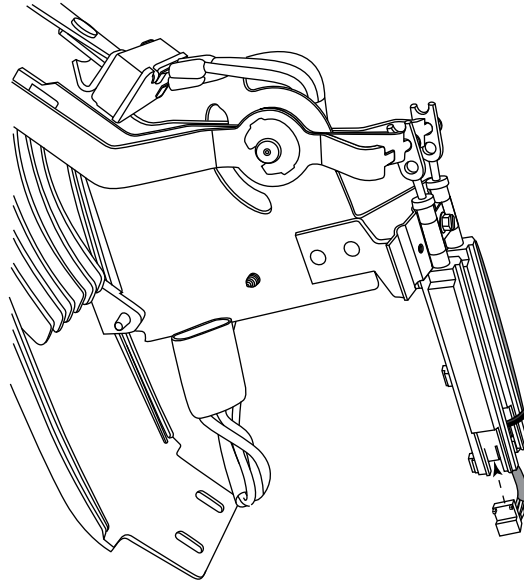
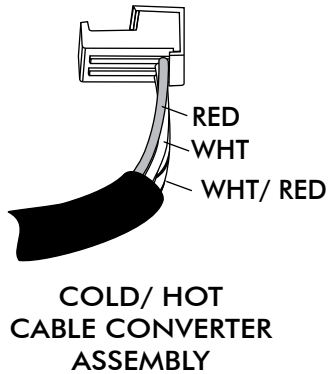

FIGURE 8

CONTROL HARNESS CONT.

- ONCE WIRES ARE CORRECTLY PLUGGED INTO CABLE CONVERTER ASSEMBLY, SECURE WIRES TO THE CABLE CONVERTER ASSEMBLY USING TIE WRAPS (SUPPLIED). SEE FIGURE 9 BELOW. THE TIE WRAP MUST BE LOCATED BETWEEN THE END OF THE WIRE JACKET AND THE STEP IN THE CABLE CONVERTER HOUSING FORCING A BEND IN EACH WIRE AS THEY PASS OVER THE STEP IN THE CABLE CONVERTER HOUSING. HEAD OF TIE WRAP MUST FALL ON EDGE OF HOUSING AS SHOWN TO REMAIN TIGHT. ENSURE THAT THE TIE WRAPS ARE SNUG ENOUGH THAT THE WIRES CANNOT MOVE. SEE FIGURE 9.

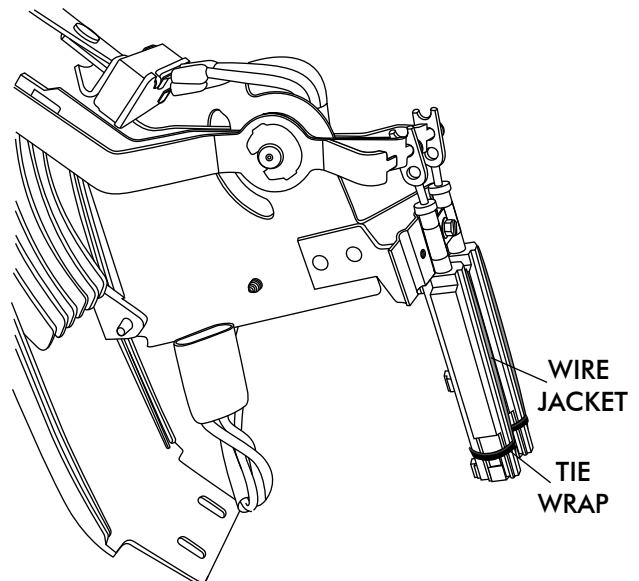
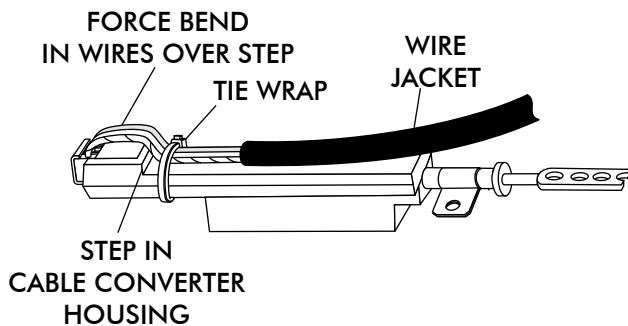

FIGURE 9



CABLE CONVERTER ASSEMBLY INSTALLATION

DASH/ FLR/ DEF CABLE CONVERTER ASSEMBLY

- INSTALL CABLE CONVERTER ASM ON THE DASH/ FLR/ DEF LEVER. SEE FIGURE 10 BELOW
- INSTALL CABLE CONVERTER LEVER PUSH ROD ONTO OEM CABLE MOUNTING STUD ON LEVER. SEE FIGURE 10 BELOW.
- SECURE THE CABLE CONVERTER ASM TO THE CONTROL PANEL USING #10 x 1/2" SHEET METAL SCREW IN THE OEM CABLE CLAMP MOUNTING LOCATION. SEE FIGURE 10 BELOW.
- SINCE THE CABLE CONVERTER ASSEMBLY CAN SLIDE BACK AND FORTH IN CLAMP BEFORE SCREW IS TIGHTENED, POSITION CABLE CONVERTER ASSEMBLY SUCH THAT THE FLAT PART OF THE ROD IS AS CLOSE TO FLUSH AS POSSIBLE WITH THE END OF HOUSING AT THE LEVER'S INNER MOST POSITION. SEE FIGURE 10.
- SECURE CABLE CONVERTER LEVER PUSH ROD ONTO OEM CABLE MOUNTING STUD USING 3/16" PUSH-ON RING AS SHOWN IN FIGURE 10 BELOW.

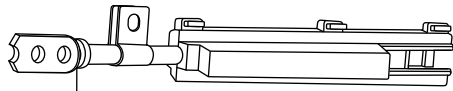

FLUSH

ROD SHOWN IN APPROX.
INNER MOST POSITION

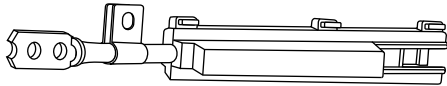

NOTE: DO NOT ALLOW ROD TO SEPARATE
HOUSING WHEN ROD IS IN INNER
MOST POSITION.

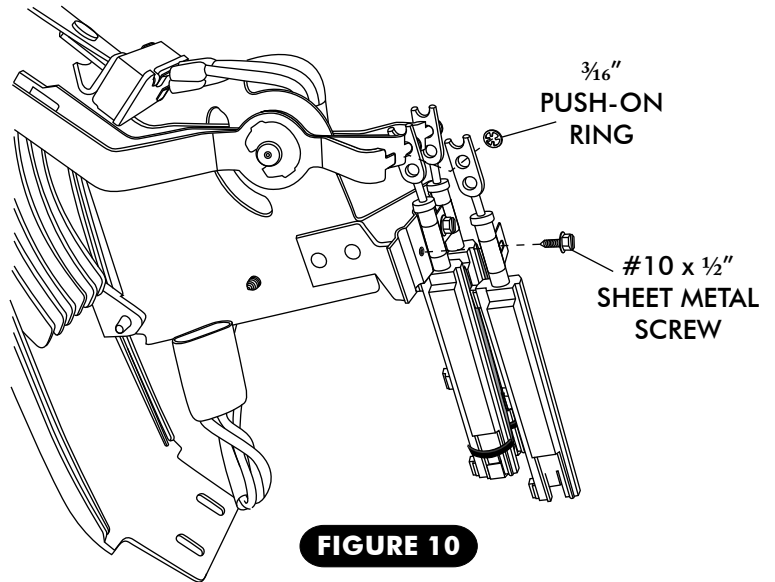
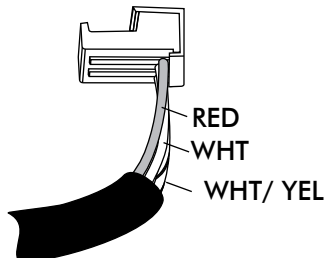

FIGURE 10

CONTROL HARNESS

- LOCATE THE CONTROL PANEL WIRE HARNESS AND PLUG THE CORRESPONDING WIRES INTO THE CORRECT CABLE CONVERTER ASSEMBLY AS SHOWN IN FIGURE 11 BELOW.



DASH/ FLR/ DEF
CABLE CONVERTER
ASSEMBLY

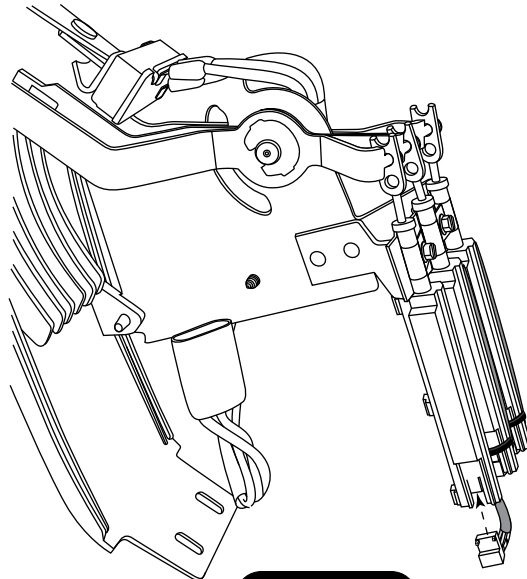

FIGURE 11



CONTROL HARNESS CONT.

- ONCE WIRES ARE CORRECTLY PLUGGED INTO CABLE CONVERTER ASSEMBLY, SECURE WIRES TO THE CABLE CONVERTER ASSEMBLY USING TIE WRAPS (SUPPLIED). SEE FIGURE 12 BELOW. THE TIE WRAP MUST BE LOCATED BETWEEN THE END OF THE WIRE JACKET AND THE STEP IN THE CABLE CONVERTER HOUSING FORCING A BEND IN EACH WIRE AS THEY PASS OVER THE STEP IN THE CABLE CONVERTER HOUSING. HEAD OF TIE WRAP MUST FALL ON EDGE OF HOUSING AS SHOWN TO REMAIN TIGHT. ENSURE THAT THE TIE WRAPS ARE SNUG ENOUGH THAT THE WIRES CANNOT MOVE. SEE FIGURE 12.

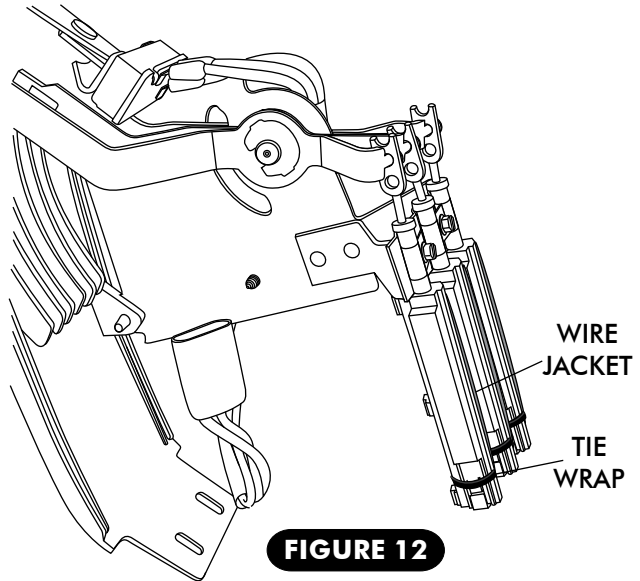
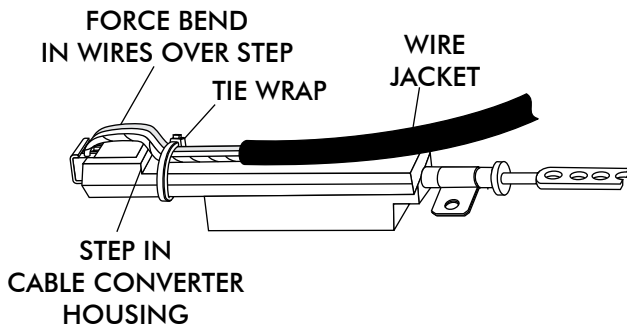

FIGURE 12

CONTROL HARNESS FINAL STEPS

- USING THE SUPPLIED TIE-WRAPPS, TIE THE WIRES TO THE CONTROL PANEL AS SHOWN IN FIGURE 13, BELOW.
- CONFIRM THAT WIRES ARE SECURED AND DO NOT INTERFERE WITH LEVER OPERATION OR CABLE CONVERTER ASSEMBLY.

NOTE: TIE THE UNUSED WIRE TO THE CONTROL PANEL APPROXIMATELY AS SHOWN, ENSURE THAT THE WIRE DOES NOT INTERFERE WITH LEVERS OR SLIDE POT ASSEMBLES.

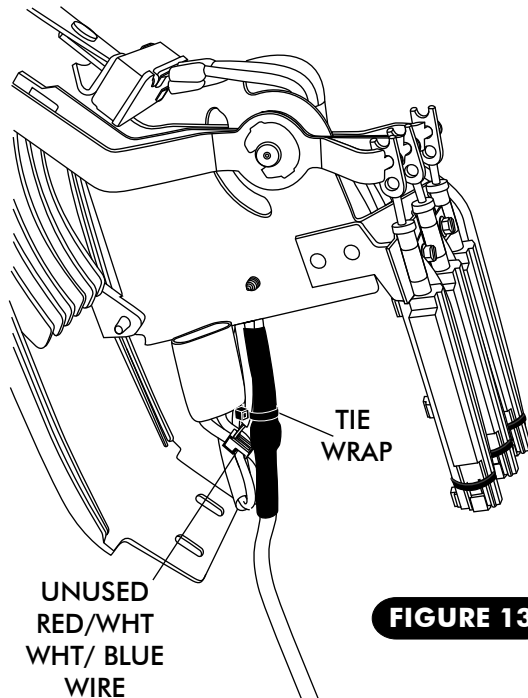

FIGURE 13



FINAL STEPS

- RE-INSTALL CONTROL PANEL IN DASH USING THE (4) OEM SCREWS.

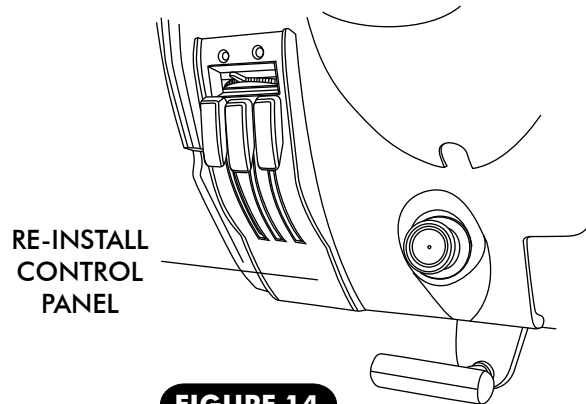

FIGURE 14

FINAL STEPS CONT.

- PLUG THE WIRING HARNESS INTO THE ECU MODULE ON SUB CASE. SEE FIGURE 15 BELOW.
- WIRE ACCORDING TO WIRING DIAGRAM ON PAGE 13.
CONTROL PANEL CALIBRATION PROCEDURE AND OPERATION INSTRUCTIONS:
 - CALIBRATING THE CONTROL PANEL WILL SET THE RANGE OF TRAVEL FOR THE CABLE CONVERTERS CONNECTED TO THE OEM CONTROL PANEL LEVERS. PERFORMING THIS PROCEDURE WILL SET THE LIMITS OF THE CABLE CONVERTERS AT THEIR HIGHEST AND LOWEST POINTS.
 - LOCATE THE GRAY WIRE WITH AN UNUSED CONNECTOR IN THE WIRING HARNESS NEAR THE TWO CABLE HARNESS RELAYS. THE WIRE IS LABELED PRGM ON THE WIRING DIAGRAM ON PAGE 13.
 - IT WILL BE NECESSARY TO GROUND THE GRAY WIRE FOR APPROXIMATELY FIVE SECONDS WHILE MOVING THE CONTROLS SO IT IS SOMETIMES HELPFUL TO ATTACH ONE END OF THE WHITE JUMPER WIRE TO THE VEHICLE'S GROUND (FOR EXAMPLE THE CHASSIS) AND HAVE THE OTHER END READY TO CONNECT TO THE GRAY PRGM WIRE WHEN THE PROCEDURE REQUIRES IT.
 - TO CALIBRATE THE CONTROL PANEL FOLLOW THE CALIBRATION PROCEDURES ON PAGE 12.

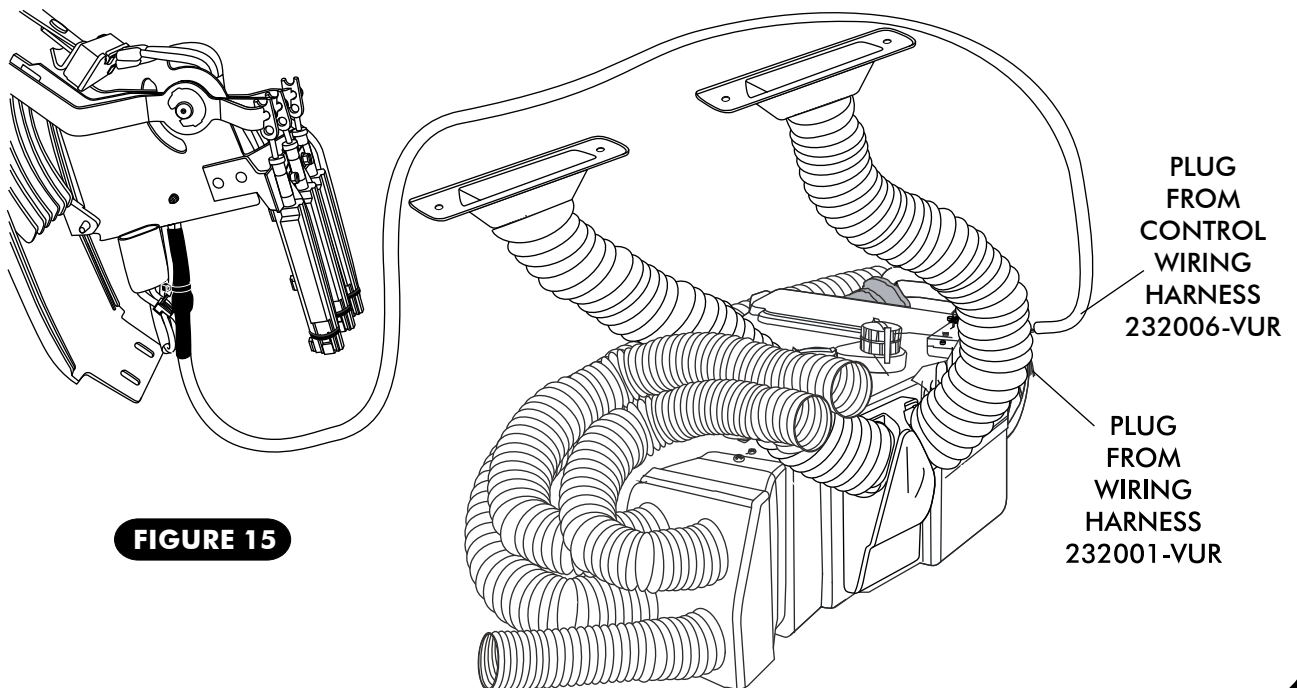
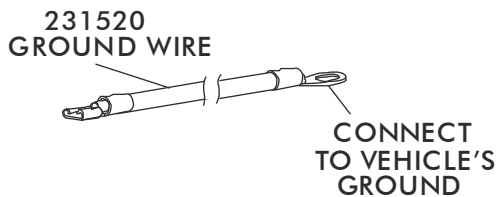

FIGURE 15



CONTROL PANEL CALIBRATION PROCEDURE

1. TURN THE IGNITION SWITCH ON (DO NOT START THE ENGINE)
2. CONNECT THE WHITE JUMPER WIRE TO VEHICLE'S GROUND (FOR EXAMPLE THE VEHICLE CHASSIS). ENSURE THAT THE GRAY WIRE IS NOT GROUNDING. DO NOT CONNECT JUMPER WIRE TO THE GRAY PRGM WIRE.



3. MOVE ALL OF THE CONTROL LEVERS TO THEIR MAXIMUM POSITIONS, AS SHOWN.

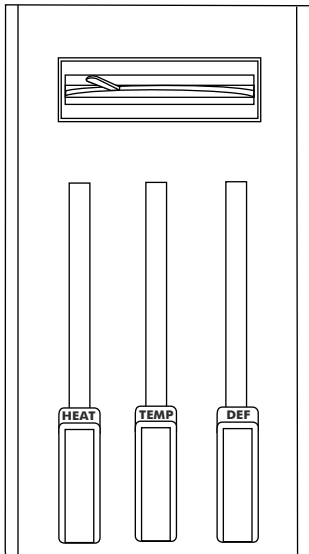

4. GROUND THE GRAY WIRE BY CONNECTING THE GRAY PRGM WIRE & WHITE JUMPER WIRE FOR APPROXIMATELY 5 SECONDS (THE BLOWER WILL CHANGE SPEEDS WHEN STEP FOUR IS COMPLETE)

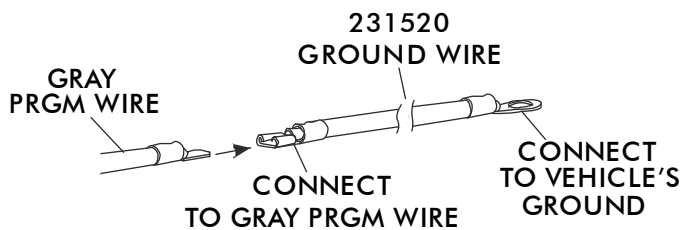

5. LEAVING THE GRAY WIRE GROUNDING, MOVE ALL OF THE CONTROL LEVERS TO THEIR MINIMUM POSITIONS AS SHOWN.

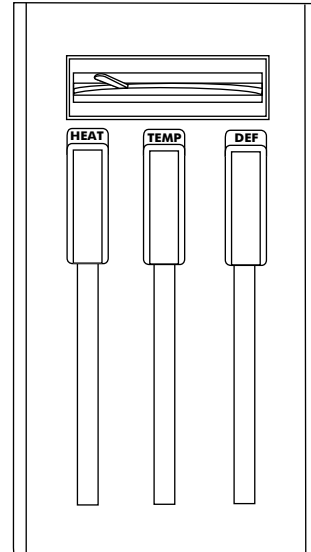

6. DISCONNECT THE GRAY WIRE FROM THE WHITE GROUND JUMPER WIRE (THE BLOWER WILL CHANGE SPEEDS WHEN STEP SIX IS COMPLETE)

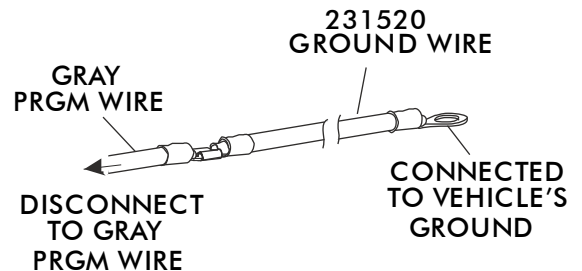

7. START THE ENGINE AND TEST ALL OF THE CONTROLS TO ENSURE THAT THE INTENDED RESULTS WERE ACCOMPLISHED.
8. DISCONNECT THE WHITE JUMPER WIRE FROM VEHICLE'S GROUND.

NOTE: THIS PROCEDURE MAY BE REPEATED IF NECESSARY.

*** WHEN FINISHED, TAPE OVER PROGRAM WIRE WIRE CONNECTOR WITH ELECTRICAL TAPE TO PREVENT ACCIDENTAL CONTACT WITH CHASSIS GROUND.**



WIRING DIAGRAM

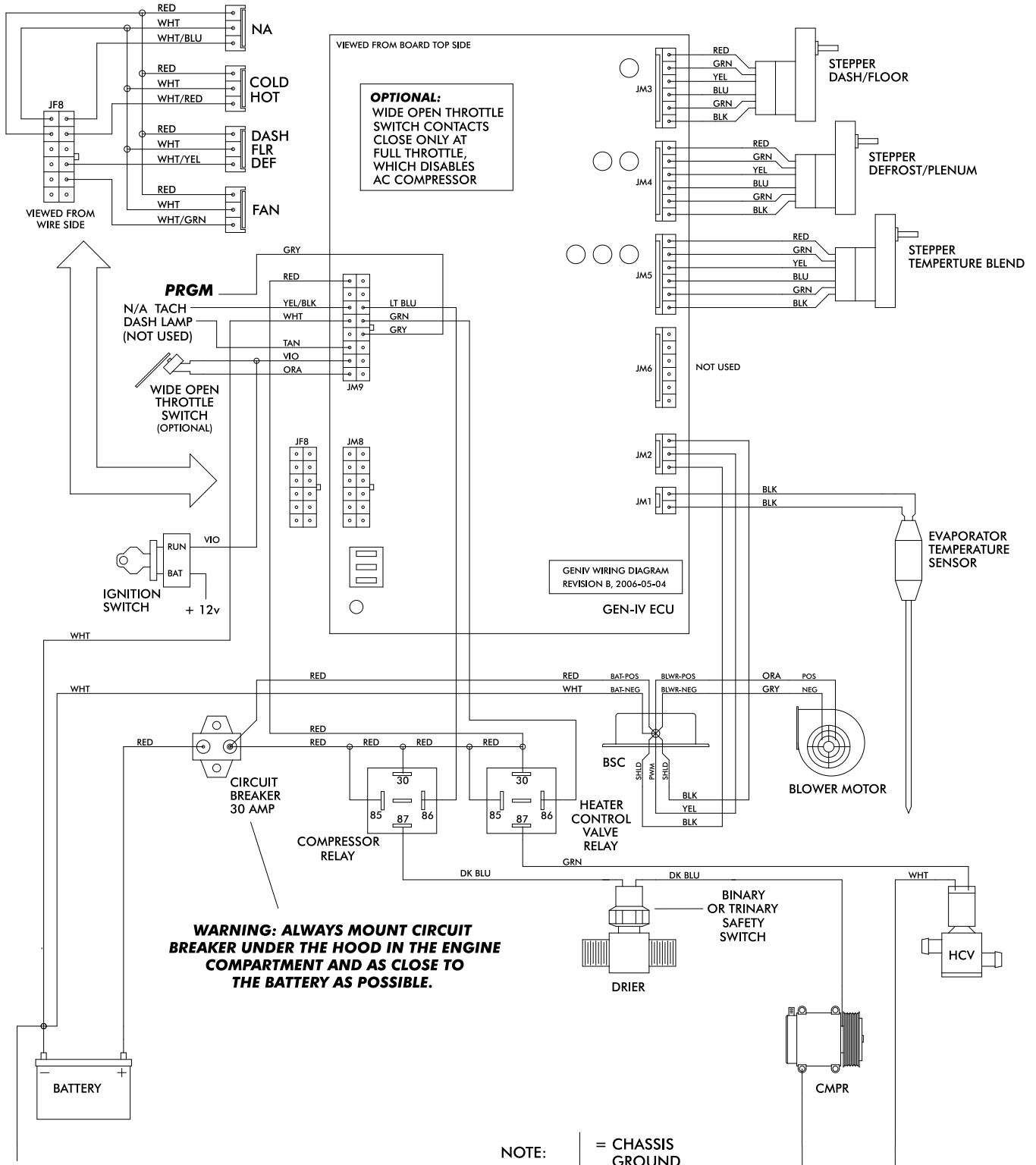



OPERATION OF CONTROLS

NOTE: CONTROLS MUST BE CALIBRATED PRIOR TO FIRST OPERATION-REFER TO CONTROL PANEL INSTRUCTIONS

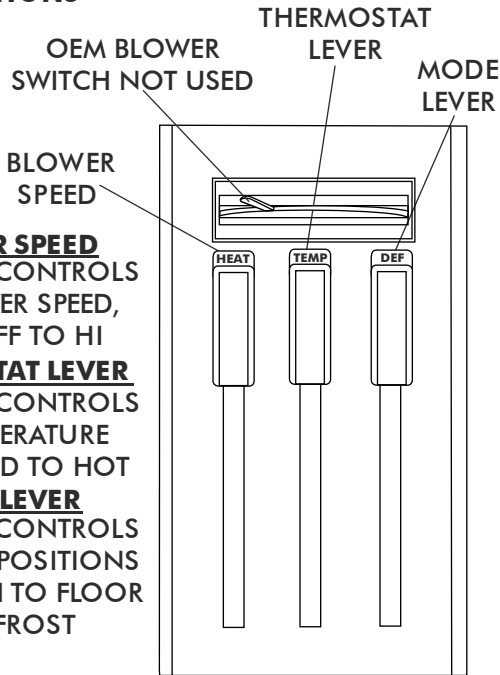

SYSTEM OFF

BLOWER SPEED
THIS LEVER CONTROLS THE BLOWER SPEED, FROM OFF TO HI

THERMOSTAT LEVER
THIS LEVER CONTROLS THE TEMPERATURE FROM COLD TO HOT

MODE LEVER
THIS LEVER CONTROLS THE MODE POSITIONS FROM DASH TO FLOOR TO DEFROST

BLOWER SPEED
SLIDE THE FAN LEVER UP OR DOWN TO SELECT DESIRED FAN SPEED
(SLIDE LEVER ALL THE WAY DOWN FOR MAXIMUM FAN SPEED)

THERMOSTAT LEVER
IN A/C MODE SLIDE THE TEMP LEVER ALL THE WAY UP TO ENGAGE COMPRESSOR FOR MAXIMUM COOLING.
(SLIDE LEVER UP OR DOWN TO ADJUST DESIRED TEMPERATURE)

MODE LEVER
SLIDE THE MODE LEVER ALL THE WAY UP FOR DASH MODE

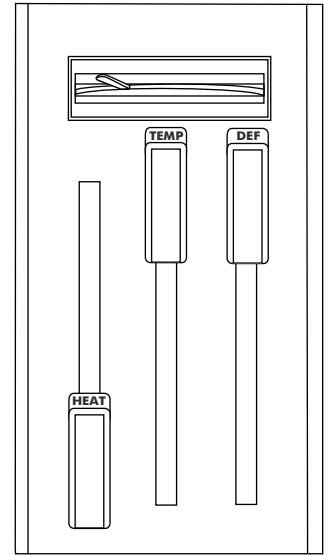

A/C MODE

BLOWER SPEED
SLIDE THE FAN LEVER UP OR DOWN TO SELECT DESIRED FAN SPEED
(SLIDE LEVER ALL THE WAY DOWN FOR MAXIMUM FAN SPEED)

THERMOSTAT LEVER
IN HEAT MODE SLIDE THE TEMP LEVER ALL THE WAY DOWN FOR MAXIMUM HEATING.
(SLIDE LEVER UP OR DOWN TO ADJUST DESIRED TEMPERATURE)

MODE LEVER
SLIDE THE MODE LEVER TO THE CENTER FOR FLOOR MODE
(SLIDE LEVER UP OR DOWN TO BLEND BETWEEN DESIRED MODE POSITIONS)

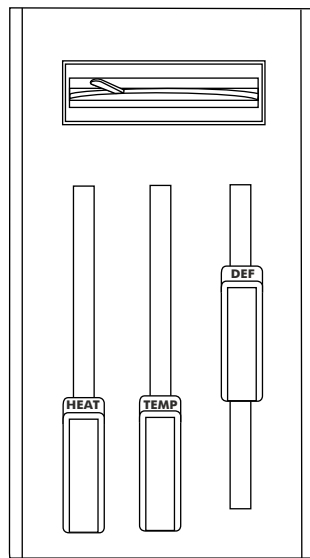

HEAT MODE

BLOWER SPEED
SLIDE THE FAN LEVER UP OR DOWN TO SELECT DESIRED FAN SPEED
(SLIDE LEVER ALL THE WAY DOWN FOR MAXIMUM FAN SPEED)

THERMOSTAT LEVER
IN DEF MODE SLIDE THE TEMP LEVER ALL THE WAY UP TO ENGAGE COMPRESSOR FOR MAXIMUM COOLING.
(SLIDE LEVER UP OR DOWN TO ADJUST DESIRED TEMPERATURE)

MODE LEVER
SLIDE THE MODE LEVER ALL THE WAY DOWN FOR DEFROST MODE
(SLIDE LEVER UP OR DOWN TO BLEND BETWEEN DESIRED MODE POSITIONS)

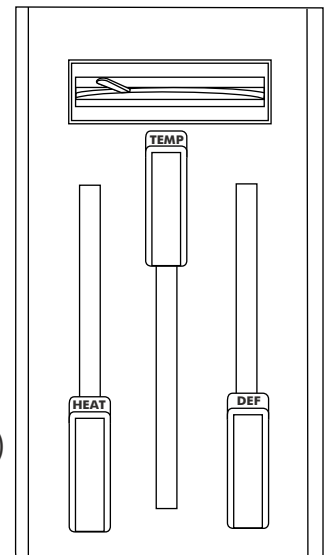

DEFROST MODE



CONTROL PANEL KIT PACKING LIST

CONTROL KIT
474267

No.	QTY.	PART No.	DESCRIPTION	
1.	3	112002-SUA	SLIDE POT ASM	_____
2.	1	232006-VUR	GEN IV UNIVERSAL CONTROL HARNESS (TYPE B)	_____
3.	3	65976-VUE	3/16" PUSH-ON RING	_____
4.	3	491010-VUR	SLIDE POT CLAMP	_____
5.	5	21301-VUP	4" TIE WRAP	_____
6.	1	231520	GROUND WIRE	_____
7.	2	18247-VUB	#10 x 1/2" SHEET METAL SCREW	_____

**** BEFORE BEGINNING INSTALLATION OPEN ALL PACKAGES AND CHECK CONTENTS OF SHIPMENT. PLEASE REPORT ANY SHORTAGES DIRECTLY TO VINTAGE AIR WITHIN 15 DAYS. AFTER 15 DAYS, VINTAGE AIR WILL NOT BE RESPONSIBLE FOR MISSING OR DAMAGED ITEMS.**

