

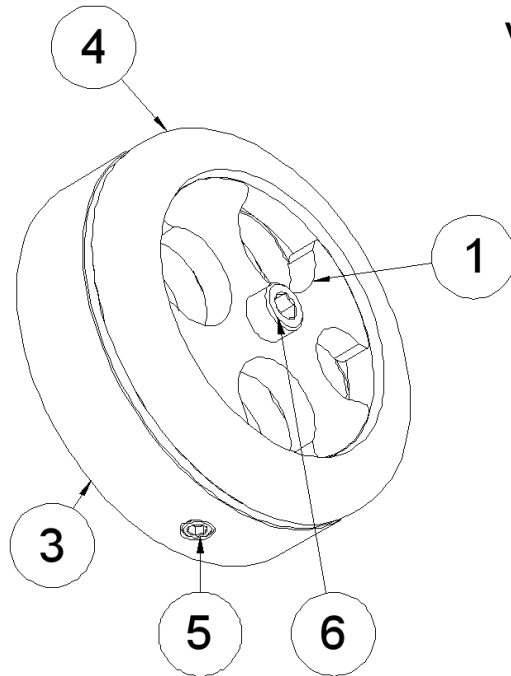

II MUCH AIRPORT A/C BULKHEAD INSTALLATION INSTRUCTIONS

Vintage Air Part # 388902



Parts List	
No.	Description
1	CINCH PLATE (X2)
2	O-RING (HIDDEN)
3	BEZEL NUT
4	BEZEL
5	SET SCREW, 1/4-20
6	CAP SCREW
7	NUT, 1/4-20
8	HEATER HOSE ADAPTER

Warning

1. The II MUCH Airport is designed to work with the Vintage Air E-Z Clip hose system. As such, all applicable precautions recommended by Vintage Air regarding E-Z Clip hose installation should be followed.
2. II MUCH hose adapters are designed only for engine coolant applications.

Tools

The following are the minimum tools required. Depending upon the vehicle and mounting location, more tools and materials may be needed.

1. 2.5" hole saw. We recommend Holcutter™ by Blair Equipment Company, Part Number 4674.
2. 1/8" and 3/16" Allen wrenches.
3. 7/16" socket.

Background

The II MUCH Airport A/C bulkhead was developed to reduce the amount of space and time required to route heater and A/C hoses through a firewall. Its compact design takes advantage of the smaller diameter of the E-Z Clip hoses that are required when using this product. E-Z Clip hoses are available from Vintage Air at www.vintageair.com.

II MUCH AIRPORT A/C BULKHEAD INSTALLATION INSTRUCTIONS

Installation

1. Install the evaporator under the dash per the manufacturer's instructions.
2. Determine a location for the bulkhead that will allow the hoses to be routed without exceeding the minimum bend radius of the E-Z Clip hoses.
3. Drill a 2.5" hole at the desired location.
4. Assemble the bezel facing into the engine compartment, and install the nut hand tight.
5. Tighten the set screw on the bezel nut.
6. Adapt from the heater control valve to EZ-Clip with a short length of heater hose and the included adapter. It's assumed the heater control valve will be mounted under the dash.
7. When ordering E-Z Clip hoses and fittings, a method will be needed to interface the E-Z Clip lines with the heater hose at the water pump. Additional fittings are available from both II MUCH and Vintage Air for this purpose.
8. Route the hoses through the installed bezel.
9. Install the cinch plates to the bezel. They will separate the hoses and be a somewhat tight fit.
10. Once the cinch plates are assembled, tighten the assembly together with the 1/4-20 cap screw and self-locking nut.