



Proline Louver Installation

Assembly Procedure:

1. Place ball into bezel with vanes facing forward as shown.
2. Place ring into back of bezel with internal radius facing ball.
3. Place wave spring behind ring with spring gap projecting into flat on back of anodized rear ring.
4. Retain all assembled components by snapping spiral ring into inner diameter groove at rear of bezel.
5. Thread barbed adapter onto bezel (hand tight).

Penta Ball Louver

Clear Anodized-499127

Black Anodized-499128

Spyder Ball Louver

Clear Anodized-499130

Black Anodized-499131

Trident Ball Louver

Clear Anodized-499133

Black Anodized-499134

Planar Ball Louver

Clear Anodized-499144

Black Anodized-499145

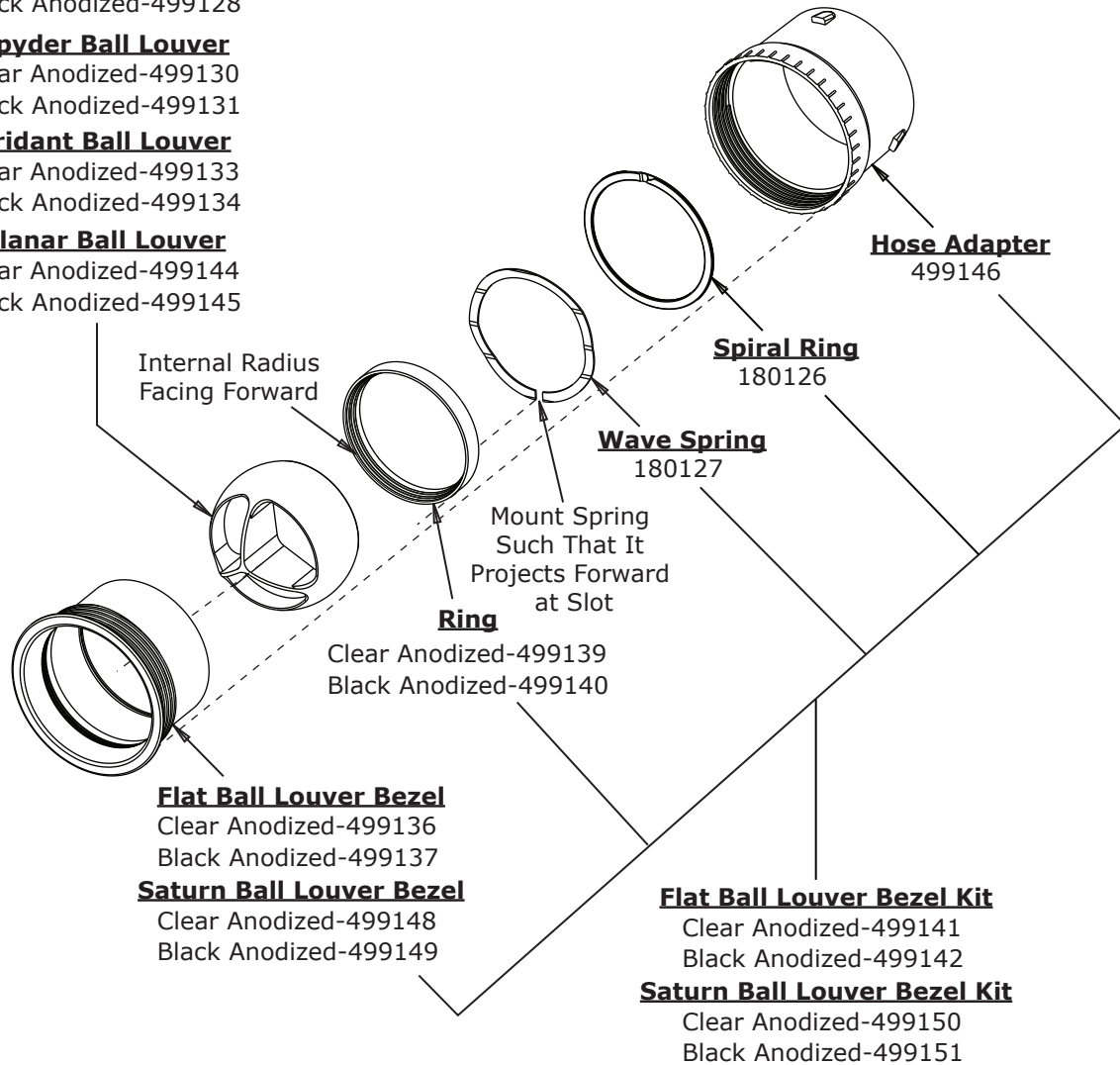

NOTE: Bezel kits include all components shown, (bezel and ring either black or clear anodized) minus ball.