



**All New - Not Rebuilt!
The Best Quality Compressors**

Sanden USA's quality management system is ISO/TS 16949:2002 certified



All compressors available with V-Belt or Serpentine pulley.

Sanden SD 508 Compressor

This compressor is recommended for all Vintage Air systems. It pumps 8.4 cubic inches per revolution with a maximum 6000 sustained RPM range. Available in standard finish or polished. Fits all Vintage Air brackets (see pages 61-64).



Sanden SD 7 (model 7176) Front Runner Compressor

This compact but high performance compressor is an integral part of our award winning Front Runner™ Accessory Drive system. Use only with our pulleys engineered specifically for this compressor.



Sanden Direct GM Replacement Compressor

Bolts into accessory drive mounts on most GM engines from 1996 to 2000. Chevy and GMC 4.3 six and 5.0, 5.7 V-8's. Also Cadillac Escalade 5.7 and Olds Bravada 4.3



Sanden Rear Exit Compressor

Excellent solution to low hood clearance issues. SD 508 Compressor with rear exit #8 and #10 male O-ring fittings. Compatible with standard female o-ring fittings on pages 70.

We recommend compressor safety Switches on page 66.

508 Compressor 134a

- 04808-VUA** Double V groove pulley-standard finish
- 04808-VUQ** Double V groove pulley-polished finish
- 04808-VMA** 7-Groove serpentine pulley-standard finish
- 04808-VMQ** 7-Groove serpentine pulley-polished finish
- 046700-KUR** 8-Groove serpentine 7 Cylinder 9.5 c.i.
- 04808-SWA** Single wide groove pulley-standard finish (3/4" Belt)
- 04808-SWQ** Single wide groove pulley-polished finish (3/4" Belt)

SD 7 Compressor 134a

- 04670-MTA** 6-Groove serpentine pulley - standard finish
- 04670-MTQ** 6-Groove serpentine pulley - polished finish
- 046702** V-Belt pulley - standard finish
- 046703** V-Belt pulley - polished finish



Refrigerant line o-ring adapters for SD 7 compressors

- 045008-VUR** #8 O-ring adapter
- 045010-VUR** #10 O-ring adapter
- 045010-VUR** #8 O-ring for adapter
- 045010-VUR** #10 O-ring for adapter
- 184136** Polished 12 point 8mm-1.25 bolt (no washer required)

Sanden Direct Replacement GM Compressor 134a

- 046440-MTR** 6-Groove serpentine pulley - standard finish
- 046441-MTQ** 6-Groove serpentine pulley - polished finish

508 Rear Exit Compressor 134a

- 047000-SUR** Double V groove pulley rear exit with #8 & #10 Fittings-standard finish
- 047001-SUQ** Double V groove pulley rear exit with #8 & #10 Fittings-polished finish
- 047002-MUR** 7-Groove serpentine pulley rear exit with #8 & #10 Fittings-standard finish
- 047003-MUQ** 7-Groove serpentine pulley rear exit with #8 & #10 Fittings-polished finish

Machined Aluminum Covers

Provides smooth detailed look and keeps clutch assembly clean and dirt free.

- 04400-VUQ** Aluminum V-belt clutch cover, machined - V groove and Multi-groove 508
- 04401-VUQ** Aluminum V-belt clutch cover, polished - V groove and Multi-groove 508
- 04408-MCP** Polished Front Runner compressor clutch cover
- 04407-MCA** Brushed Front Runner compressor clutch cover

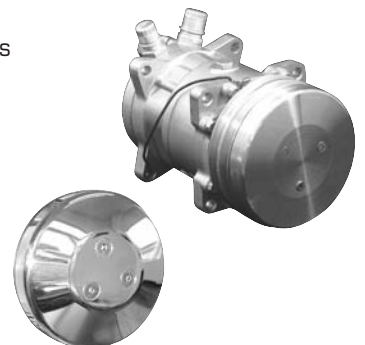

BUSINESS MANAGEMENT TEAM

Denise Packard is the Vintage Air office manager. Denise comes to us with extensive experience in banking and management. She is one of many great folks on the Vintage Air team who are helping us remain the leader in performance air conditioning.