

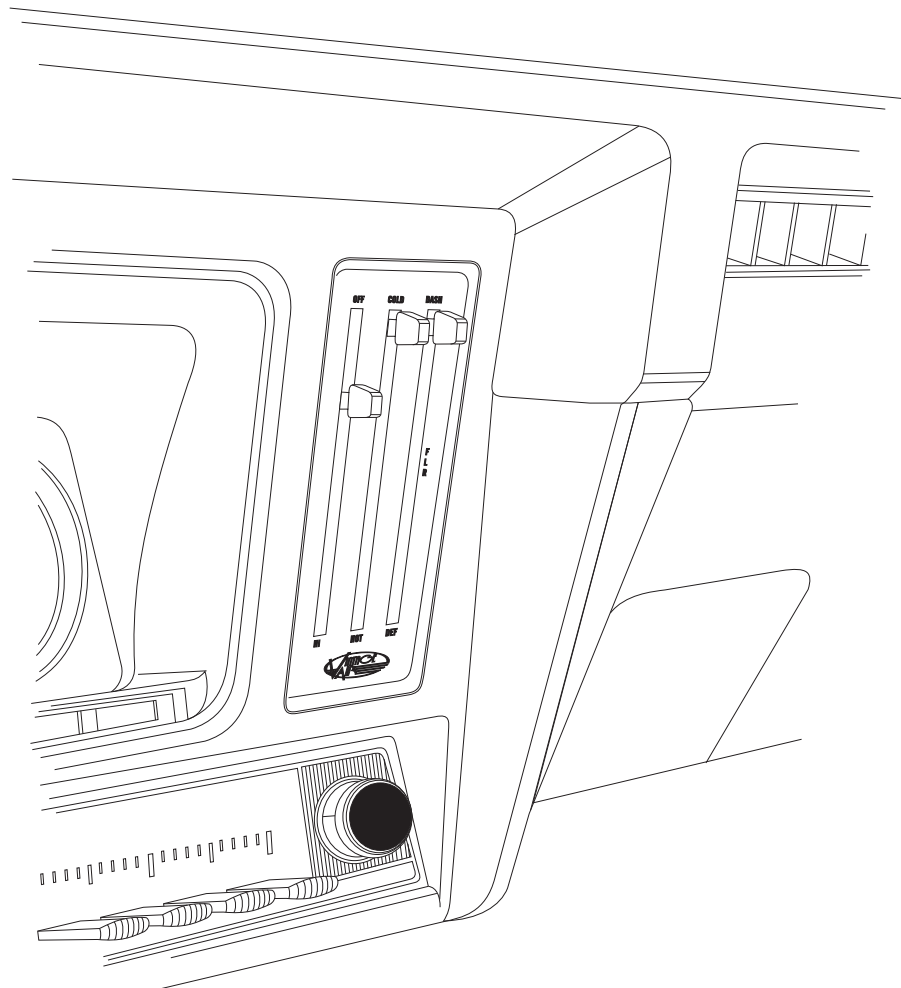

# 1969 CAMARO

w/o AC CONTROL PANEL  
CONVERSION KIT  
474169



18865 GOLL ST. - SAN ANTONIO, TX. - 78266 ph.210-654-7171 - fax 210-654-3113



## Table of Contents

### PAGES

1. COVER
2. TABLE OF CONTENTS
3. PACKING LIST/ PARTS DISCLAIMER
4. REMOVING OEM CONTROL PANEL  
SLIDE POT MODIFICATIONS  
FIGURES 1 & 2
5. SLIDE POT ASM MOUNTING CLAMP INSTALLATION  
PLACARD INSTALLATION  
FIGURES 3 & 4
6. SLIDE POT ASM INSTALLATION (DASH/FLR/DEF SLIDE POT ASM)  
FIGURE 5
7. CONTROL HARNESS  
FIGURES 5a & 5b
8. OFF/HI SLIDE POT ASM INSTALLATION  
CONTROL HARNESS  
FIGURES 6 & 6a
9. CONTROL HARNESS CONT.  
COLD/HOT SLIDE POT ASM INSTALLATION  
FIGURES 6b & 7
10. CONTROL HARNESS  
FIGURES 7a & 7b
11. CONTROL HARNESS CONT.  
FINAL STEPS  
FIGURES 8 & 9
12. CONTROL PANEL CALIBRATION PROCEDURE
13. WIRING DIAGRAM
14. OPERATION OF CONTROLS
15. CONTROL PANEL KIT PACKING LIST



# 1969 CAMARO w/o AC CNTRL PNL

## CONTROL KIT PACKING LIST

**CONTROL KIT  
474169**

No.	QTY.	PART No.	DESCRIPTION
1.	1	484069-PCR	1969 CAMARO w/o AC PLACARD w/ BLACK BACKING SHEET
2.	3	112002-SUA	SLIDE POT ASM
3.	1	232006-VUR	GEN IV UNIVERSAL CONTROL HARNESS (TYPE B)
4.	3	65976-VUE	3/16" PUSH-ON RING
5.	3	491010-VUR	SLIDE POT CLAMP
6.	5	21301-VUP	4" TIE WRAP
7.	1	23140-VUW	GROUND WIRE

**\*\* BEFORE BEGINNING INSTALLATION OPEN ALL PACKAGES AND CHECK CONTENTS OF SHIPMENT. PLEASE REPORT ANY SHORTAGES DIRECTLY TO VINTAGE AIR WITHIN 15 DAYS. AFTER 15 DAYS, VINTAGE AIR WILL NOT BE RESPONSIBLE FOR MISSING OR DAMAGED ITEMS.**

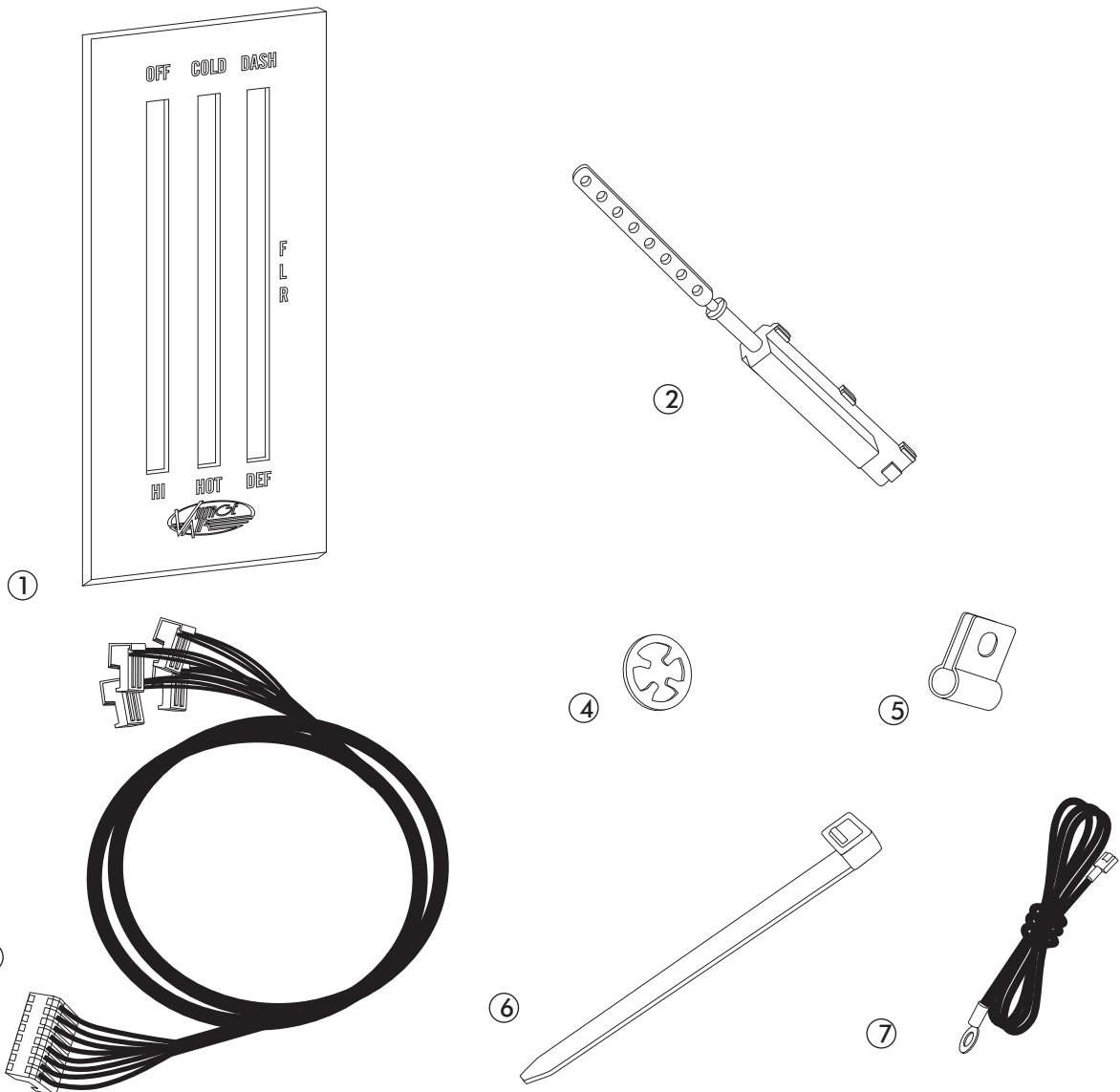



## CONTROL PANEL CONVERSION INSTRUCTIONS FOR 1969 CAMARO w/o AC

### REMOVING OEM CONTROL PANEL

- REMOVE THE (3) OEM MOUNTING SCREWS FROM INSTRUMENT PANEL OF DASH SEE FIGURE 1 BELOW.
- DISCONNECT CABLES, WIRES FROM BACK OF CONTROL PANEL. *NOTE: MAKE SURE THE GLOVE BOX AND GLOVE BOX DOOR HAVE BEEN REMOVED.*
- REMOVE THE CONTROL PANEL FROM BEHIND THE DASH THROUGH THE GLOVE BOX OPENING IN DASH.

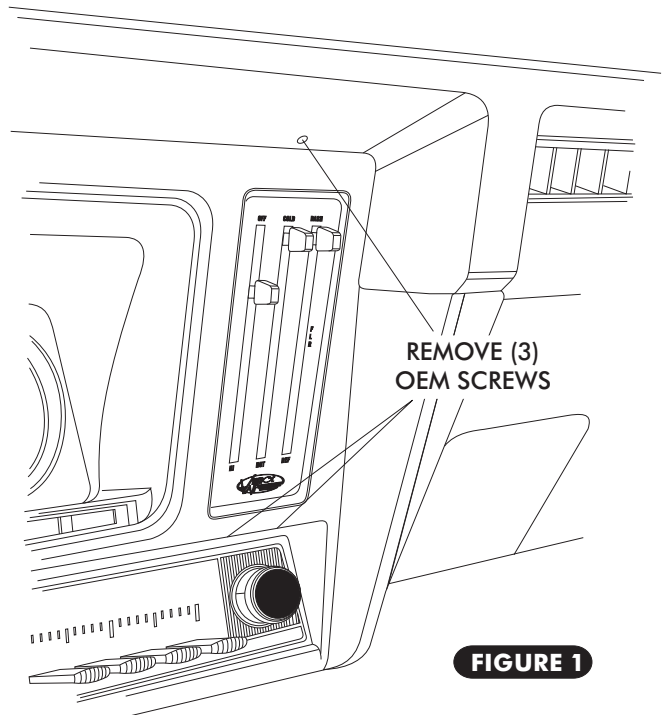

**FIGURE 1**

### SLIDE POT ASSEMBLY MODIFICATIONS

- LOCATE THE THREE SLIDE POT ASSEMBLIES, AND USING A PAIR OF WIRE CUTTERS, CUT SLIDE POT ACTUATOR RODS AS SHOWN BELOW IN FIGURE 2.

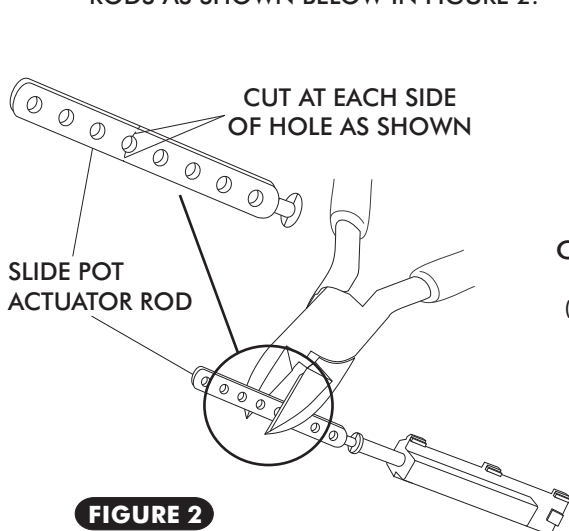

**FIGURE 2**

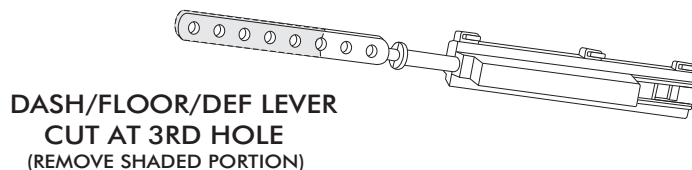
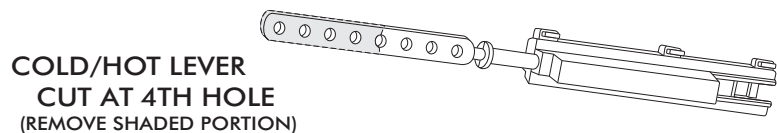
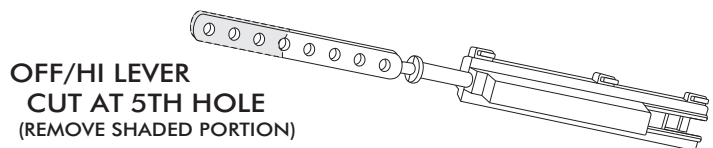



### SLIDE POT ASSEMBLY MOUNTING CLAMP INSTALLATION

- INSTALL SLIDE POT ASM MOUNTING CLAMPS, SEE FIGURE 3 BELOW.

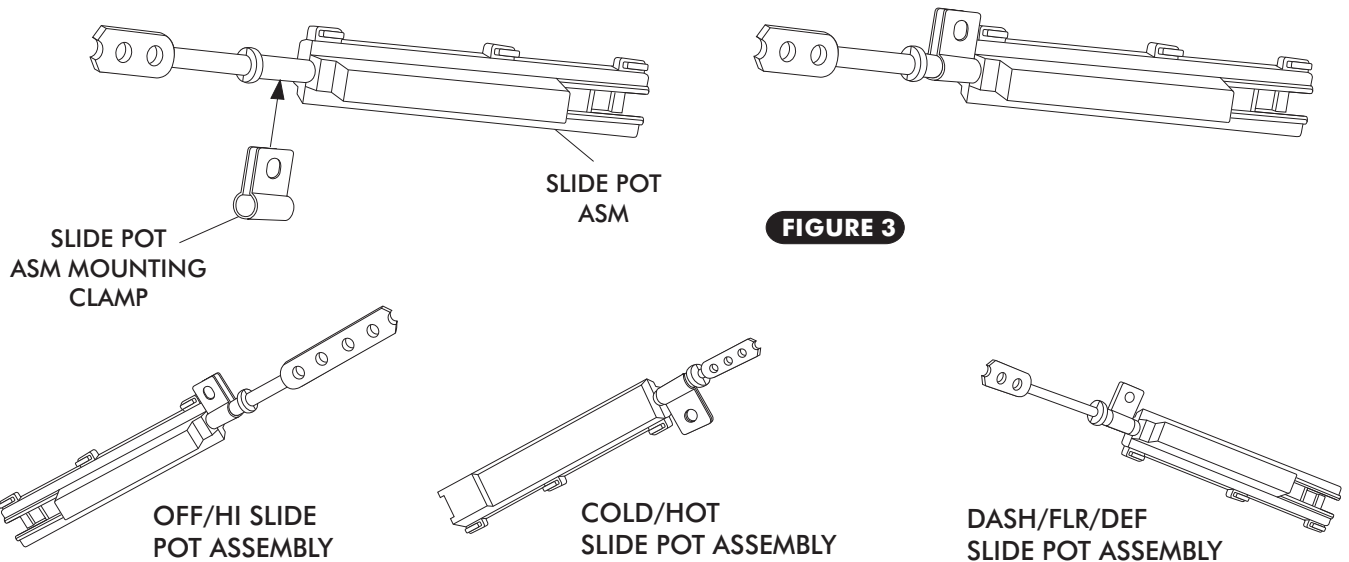

**ORIENT SLIDE POT ASSEMBLIES AS SHOWN AND INSTALL MOUNTING CLAMPS AS SHOWN.  
(NOTE: ORIENT CLAMPS IN RELATION TO THE (3) HOUSING SNAPS ON SLIDE POT ASSEMBLY)**

### PLACARD INSTALLATION

- REMOVE LEVER KNOBS
- REMOVE PLACARD RETAINING CLIPS SEE FIGURE 4 BELOW.
- REMOVE BACKING SHEET FROM CONTROL PANEL.
- INSTALL NEW BLACK BACKING SHEET ON CONTROL PANEL. SEE FIGURE 4 BELOW.
- INSTALL NEW PLACARD AND SECURE USING OEM RETAINING CLIPS. SEE FIGURE 4 BELOW.
- RE-INSTALL KNOBS.

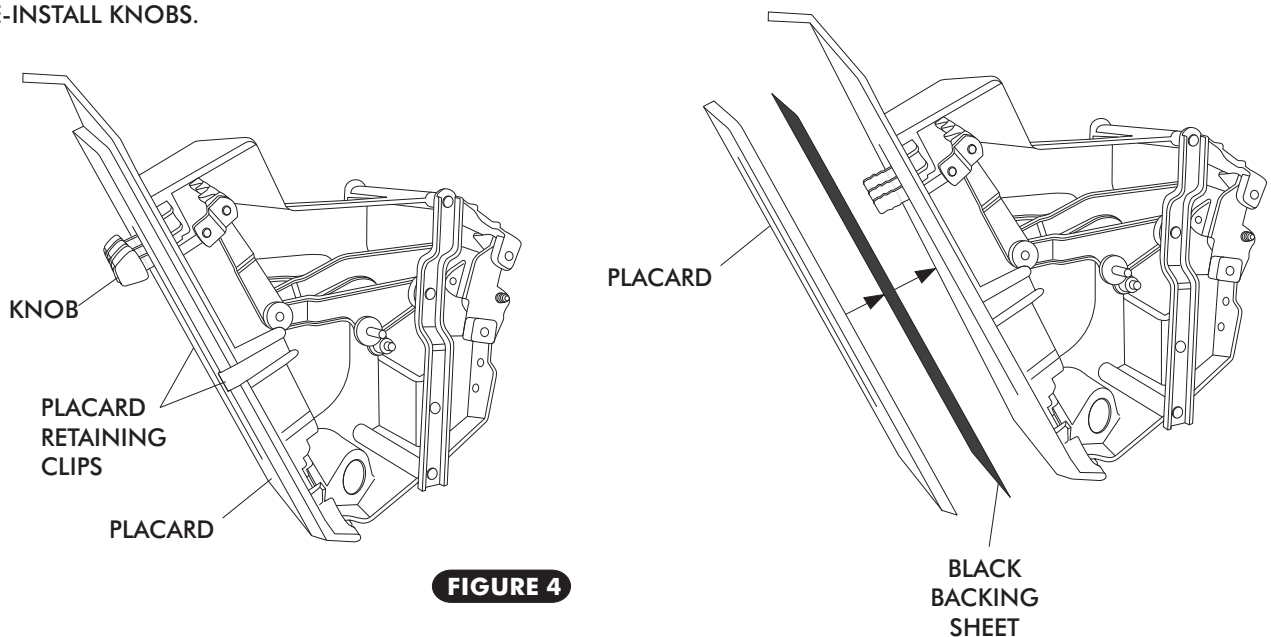



## SLIDE POT ASSEMBLY INSTALLATION

### DASH/FLR/DEF SLIDE POT ASSEMBLY

- INSTALL SLIDE POT ASM ON THE DASH/FLR/DEF LEVER. SEE FIGURE 5 BELOW.
- INSTALL SLIDE POT LEVER PUSH ROD ONTO OEM CABLE MOUNTING STUD ON LEVER. SEE FIGURE 5 BELOW.
- SECURE THE SLIDE POT ASM TO THE CONTROL PANEL USING THE OEM SCREW IN THE OEM CABLE CLAMP MOUNTING LOCATION. SEE FIGURE 5 BELOW.
- SINCE THE SLIDE POT ASSEMBLY CAN SLIDE BACK AND FORTH IN CLAMP BEFORE SCREW IS TIGHTENED, POSITION SLIDE POT ASSEMBLY SUCH THAT THE FLAT PART OF THE ROD IS AS CLOSE TO FLUSH AS POSSIBLE WITH THE END OF HOUSING AT THE LEVER'S INNER MOST POSITION. SEE FIGURE 5 BELOW.
- SECURE SLIDE POT LEVER PUSH ROD ONTO OEM CABLE MOUNTING STUD USING 3/16" PUSH-ON RING AS SHOWN IN FIGURE 5 BELOW.

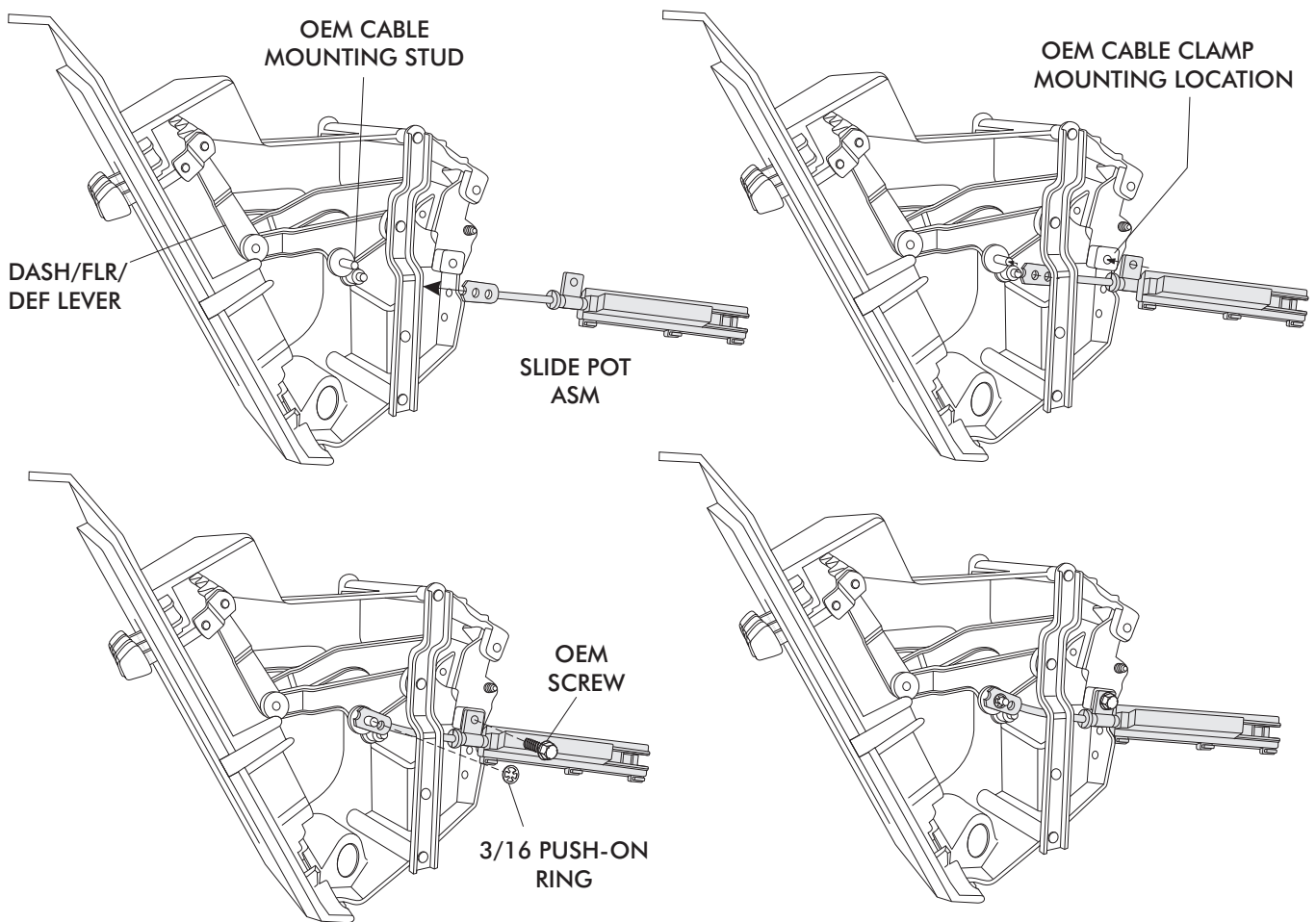

**FIGURE 5**

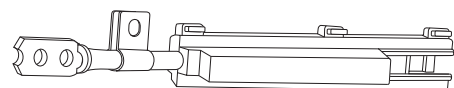
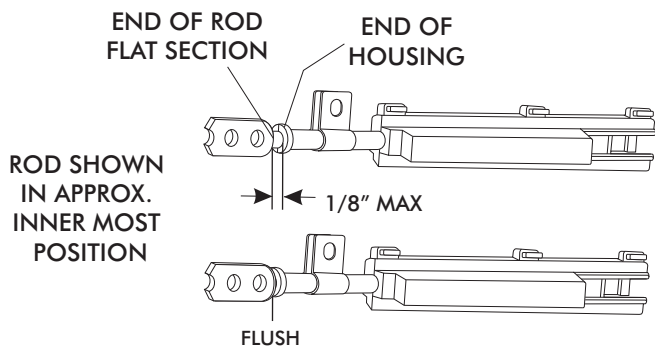

**NOTE: DO NOT ALLOW ROD TO SEPARATE HOUSING WHEN ROD IS IN INNER MOST POSITION.**



**CONTROL HARNESS**

- LOCATE THE CONTROL PANEL WIRE HARNESS AND PLUG THE CORRESPONDING WIRES INTO THE CORRECT SLIDE POT ASSEMBLY AS SHOWN IN FIGURE 5a BELOW.

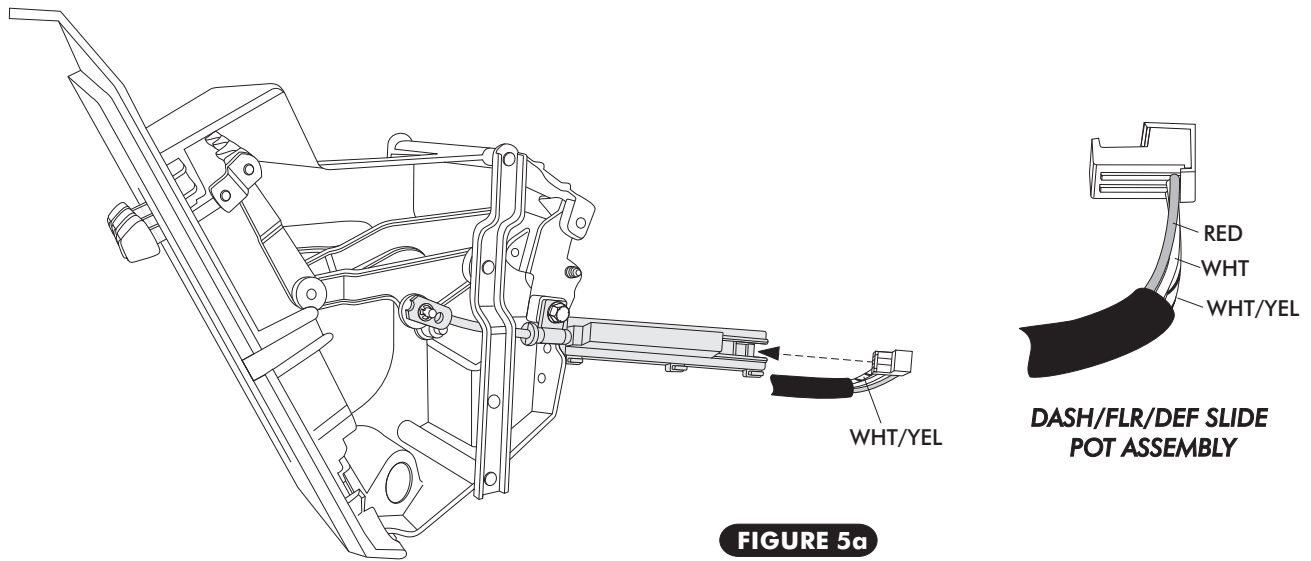

- ONCE WIRES ARE CORRECTLY PLUGGED INTO SLIDE POT ASSEMBLY, SECURE WIRES TO THE SLIDE POT ASSEMBLY USING TIE WRAPS (SUPPLIED). SEE FIGURE 5b BELOW. THE TIE WRAP MUST BE LOCATED BETWEEN THE END OF THE WIRE JACKET AND THE STEP IN THE SLIDE POT HOUSING FORCING A BEND IN EACH WIRE AS THEY PASS OVER THE STEP IN SLIDE POT HOUSING. HEAD OF TIE WRAP MUST FALL ON EDGE OF HOUSING AS SHOWN TO REMAIN TIGHT. ENSURE THAT THE TIE WRAPS ARE SNUG ENOUGH THAT THE WIRES CANNOT MOVE. SEE FIGURE 5b.

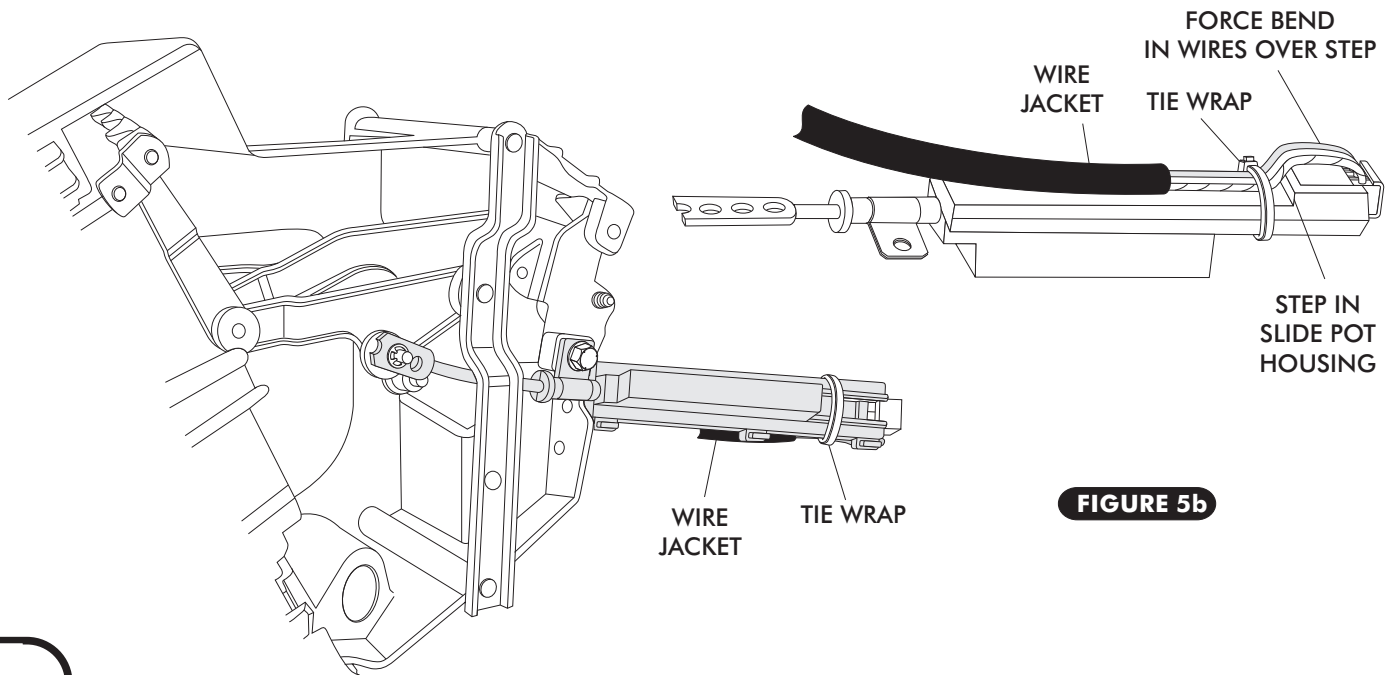



**OFF/HI SLIDE POT ASSEMBLY**

- INSTALL SLIDE POT ASM ON THE OFF/HI LEVER. SEE FIGURE 6 BELOW.
- INSTALL SLIDE POT LEVER PUSH ROD ONTO OEM CABLE MOUNTING STUD ON LEVER. SEE FIGURE 6 BELOW.
- SECURE THE SLIDE POT ASM TO THE CONTROL PANEL USING THE OEM SCREW IN THE OEM CABLE CLAMP MOUNTING LOCATION. SEE FIGURE 6 BELOW.
- SINCE THE SLIDE POT ASSEMBLY CAN SLIDE BACK AND FORTH IN CLAMP BEFORE SCREW IS TIGHTENED, POSITION SLIDE POT ASSEMBLY SUCH THAT THE FLAT PART OF THE ROD IS AS CLOSE TO FLUSH AS POSSIBLE WITH THE END OF HOUSING AT THE LEVER'S INNER MOST POSITION. SEE FIGURE 5, PAGE 6.
- SECURE SLIDE POT LEVER PUSH ROD ONTO OEM CABLE MOUNTING STUD USING 3/16" PUSH-ON RING AS SHOWN IN FIGURE 6 BELOW.

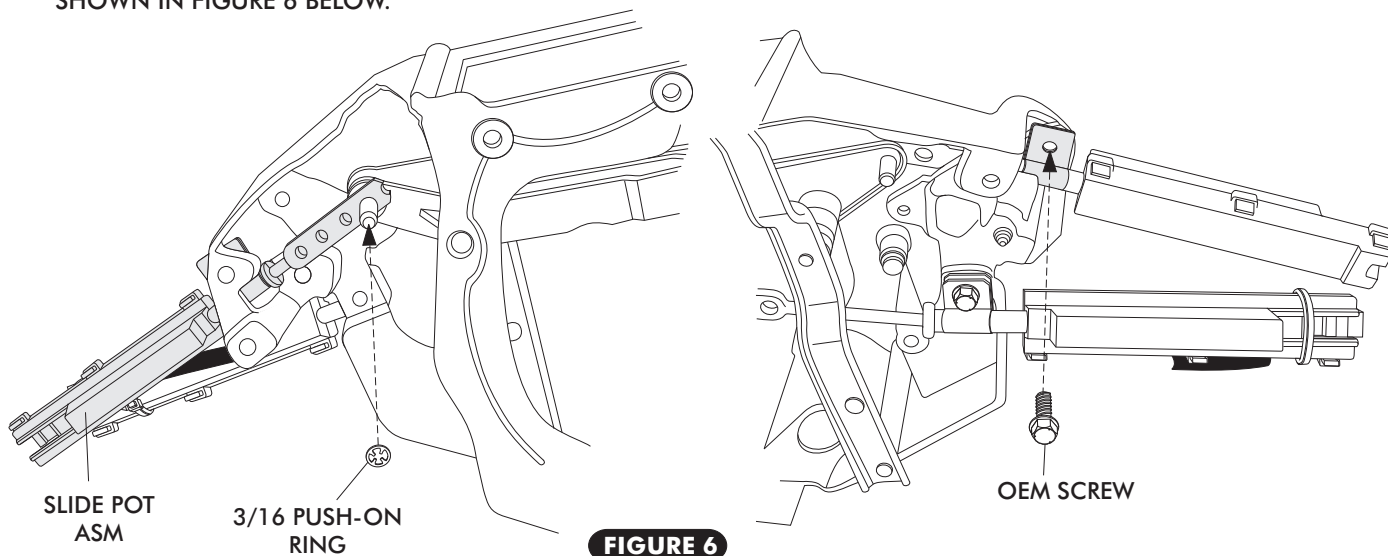

**FIGURE 6**

**CONTROL HARNESS**

- LOCATE THE CONTROL PANEL WIRE HARNESS AND PLUG THE CORRESPONDING WIRES INTO THE CORRECT SLIDE POT ASSEMBLY AS SHOWN IN FIGURE 6a BELOW.

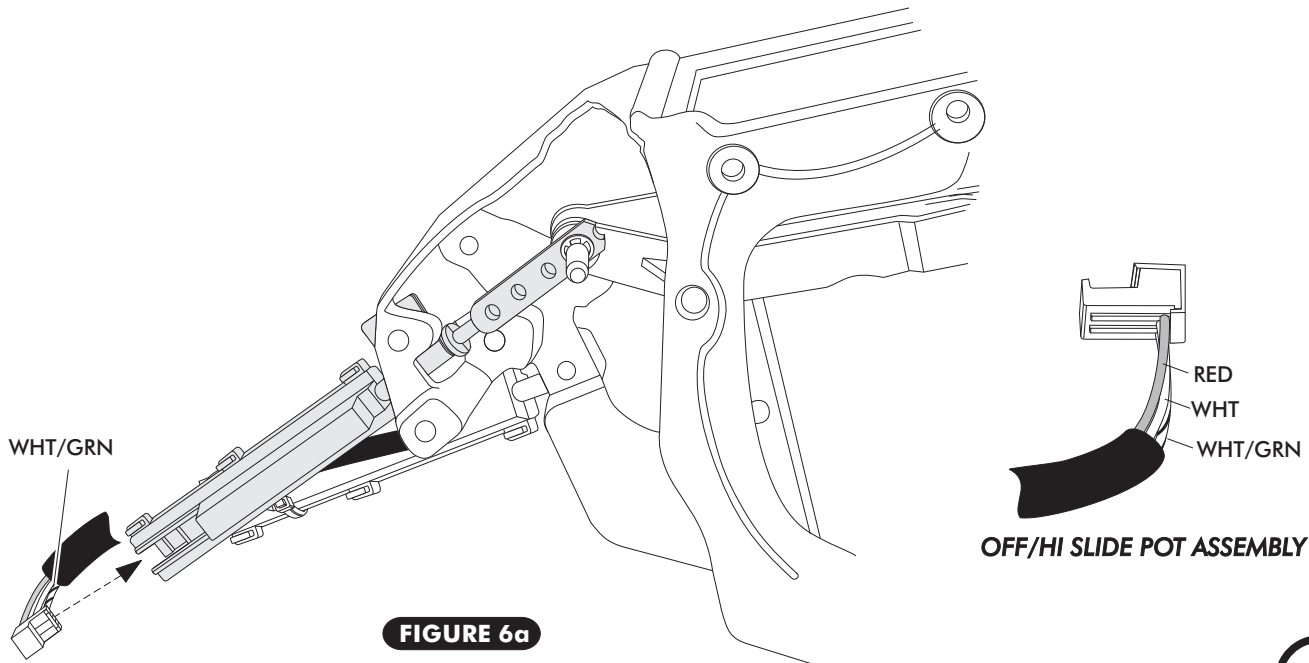
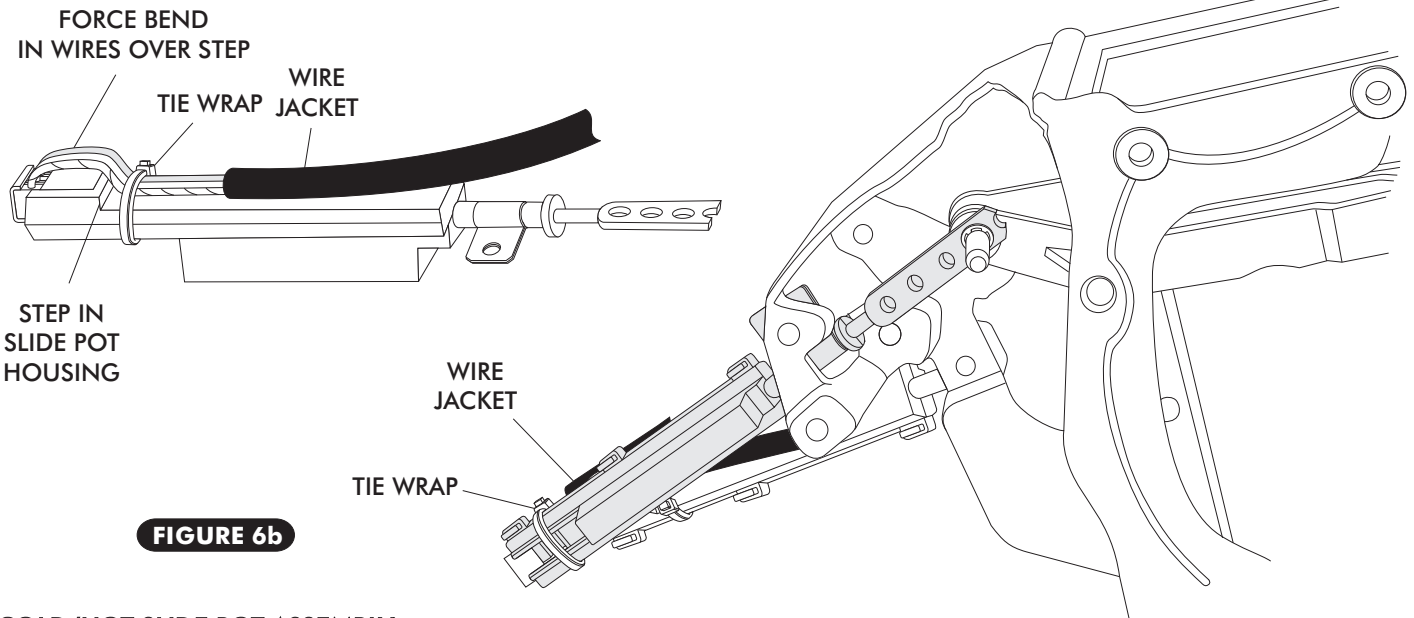

**FIGURE 6a**



# 1969 CAMARO w/o AC CNTRL PNL

- ONCE WIRES ARE CORRECTLY PLUGGED INTO SLIDE POT ASSEMBLY, SECURE WIRES TO THE SLIDE POT ASSEMBLY USING TIE WRAPS (SUPPLIED). SEE FIGURE 6b BELOW. THE TIE WRAP MUST BE LOCATED BETWEEN THE END OF THE WIRE JACKET AND THE STEP IN THE SLIDE POT HOUSING FORCING A BEND IN EACH WIRE AS THEY PASS OVER THE STEP IN SLIDE POT HOUSING. HEAD OF TIE WRAP MUST FALL ON EDGE OF HOUSING AS SHOWN TO REMAIN TIGHT. ENSURE THAT THE TIE WRAPS ARE SNUG ENOUGH THAT THE WIRES CANNOT MOVE. SEE FIGURE 6b.



**FIGURE 6b**

## COLD/HOT SLIDE POT ASSEMBLY

- INSTALL SLIDE POT ASM ON THE COLD/HOT LEVER. SEE FIGURE 7 BELOW.
- INSTALL SLIDE POT LEVER PUSH ROD ONTO OEM CABLE MOUNTING STUD ON LEVER. SEE FIGURE 5 BELOW.
- SECURE THE SLIDE POT ASM TO THE CONTROL PANEL USING THE OEM SCREW IN THE OEM CABLE CLAMP MOUNTING LOCATION. SEE FIGURE 7 BELOW.
- SINCE THE SLIDE POT ASSEMBLY CAN SLIDE BACK AND FORTH IN CLAMP BEFORE SCREW IS TIGHTENED, POSITION SLIDE POT ASSEMBLY SUCH THAT THE FLAT PART OF THE ROD IS AS CLOSE TO FLUSH AS POSSIBLE WITH THE END OF HOUSING AT THE LEVER'S INNER MOST POSITION. SEE FIGURE 5, PAGE 6.
- SECURE SLIDE POT LEVER PUSH ROD ONTO OEM CABLE MOUNTING STUD USING 3/16" PUSH-ON RING AS SHOWN IN FIGURE 7 BELOW.

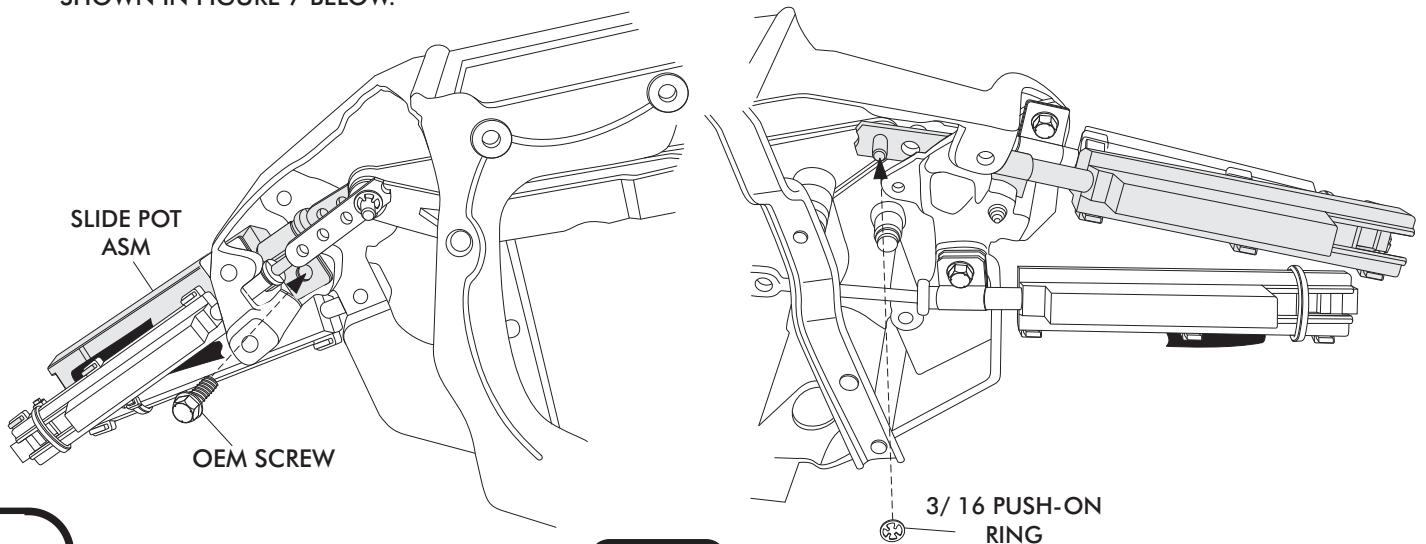

**FIGURE 7**

**CONTROL HARNESS**

- LOCATE THE CONTROL PANEL WIRE HARNESS AND PLUG THE CORRESPONDING WIRES INTO THE CORRECT SLIDE POT ASSEMBLY AS SHOWN IN FIGURE 7a BELOW.

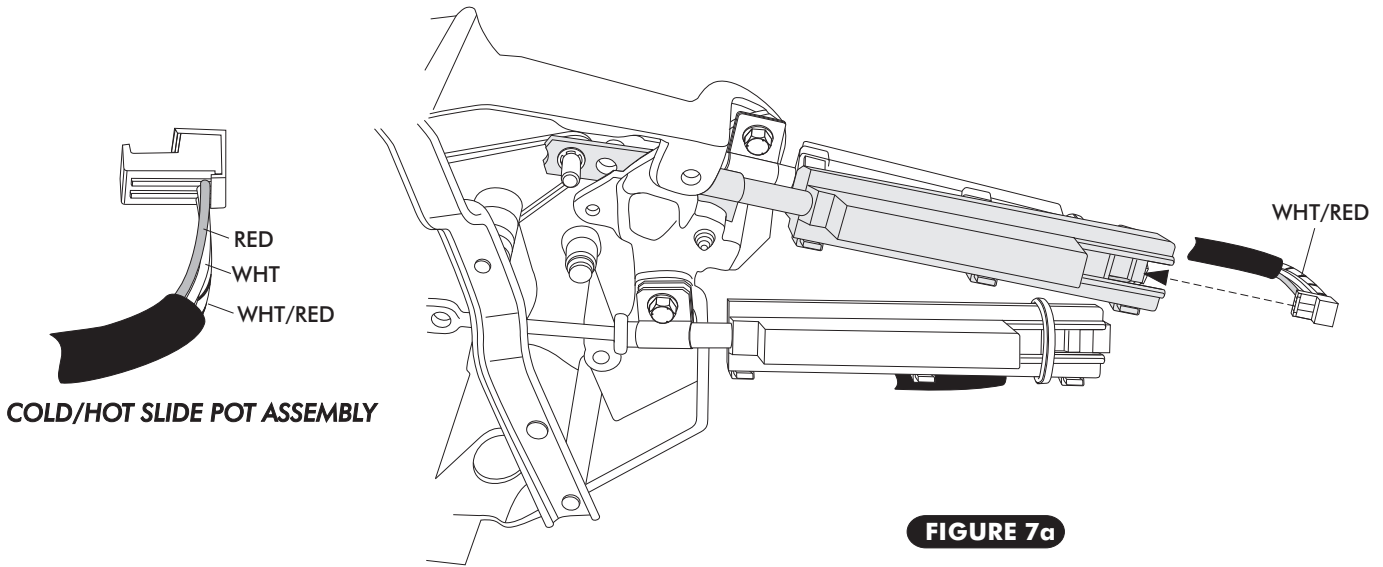

**FIGURE 7a**

- ONCE WIRES ARE CORRECTLY PLUGGED INTO SLIDE POT ASSEMBLY, SECURE WIRES TO THE SLIDE POT ASSEMBLY USING TIE WRAPS (SUPPLIED). SEE FIGURE 7b BELOW. THE TIE WRAP MUST BE LOCATED BETWEEN THE END OF THE WIRE JACKET AND THE STEP IN THE SLIDE POT HOUSING FORCING A BEND IN EACH WIRE AS THEY PASS OVER THE STEP IN SLIDE POT HOUSING. HEAD OF TIE WRAP MUST FALL ON EDGE OF HOUSING AS SHOWN TO REMAIN TIGHT. ENSURE THAT THE TIE WRAPS ARE SNUG ENOUGH THAT THE WIRES CANNOT MOVE. SEE FIGURE 7b.

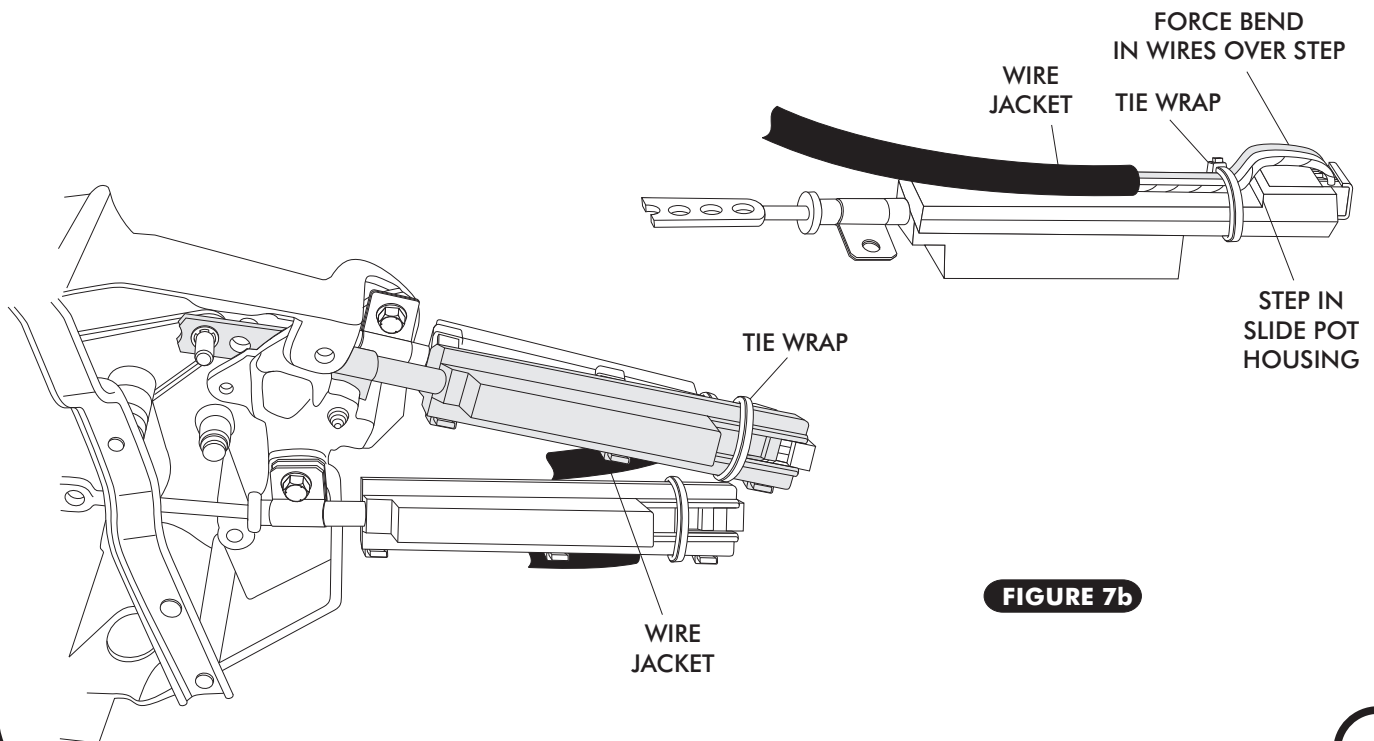

**FIGURE 7b**



## 1969 CAMARO w/o AC CNTRL PNL

### CONTROL HARNESS CONT.

- ❑ USING THE SUPPLIED TIE-WRAPS, TIE THE WIRES TO THE CONTROL PANEL AS SHOWN IN FIGURE 8 BELOW. CONFIRM THAT WIRES ARE SECURED AND DO NOT INTERFERE WITH LEVER OPERATION OR SLIDE POT ASSEMBLIES.

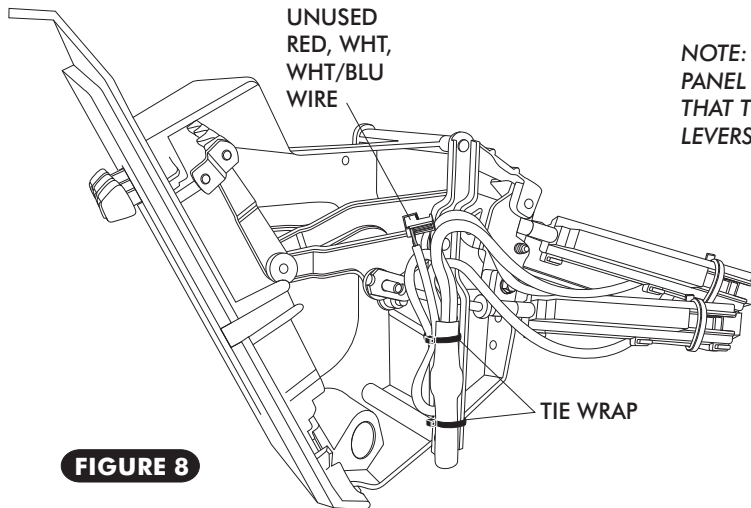

NOTE: TIE THE UNUSED WIRE TO THE CONTROL PANEL APPROXIMATELY AS SHOWN, ENSURE THAT THE WIRE DOES NOT INTERFERE WITH LEVERS OR SLIDE POT ASSEMBLIES.

**FIGURE 8**

### FINAL STEPS

- ❑ RE-INSTALL CONTROL PANEL IN DASH.
- ❑ PLUG THE WIRING HARNESS INTO THE ECU MODULE ON SUB CASE. SEE FIGURE 9.
- ❑ WIRE ACCORDING TO WIRING DIAGRAM ON PAGE 14.
- ❑ CONTROL PANEL CALIBRATION PROCEDURE AND OPERATION INSTRUCTIONS:

CALIBRATING THE CONTROL PANEL WILL SET THE RANGE OF TRAVEL FOR THE SLIDE POTS CONNECTED TO THE OEM CONTROL PANEL LEVERS. PERFORMING THIS PROCEDURE WILL SET THE LIMITS OF THE SLIDE POTS AT THEIR HIGHEST AND LOWEST POINTS

LOCATE THE GRAY WIRE WITH AN UNUSED CONNECTOR IN THE WIRING HARNESS NEAR THE TWO CABLE HARNESS RELAYS. THIS WIRE IS LABELED PRGM ON THE WIRING DIAGRAM ON PAGE 14.

IT WILL BE NECESSARY TO GROUND THE GRAY WIRE FOR APPROXIMATELY FIVE SECONDS WHILE MOVING THE CONTROLS SO IT IS SOMETIMES HELPFUL TO ATTACH ONE END OF THE WHITE JUMPER WIRE TO THE VEHICLE'S GROUND (FOR EXAMPLE THE CHASSIS) AND HAVE THE OTHER END READY TO CONNECT TO THE GRAY PRGM WIRE WHEN THE PROCEDURE REQUIRES IT.

TO CALIBRATE THE CONTROL PANEL FOLLOW THE CALIBRATION PROCEDURES ON PAGE 10.

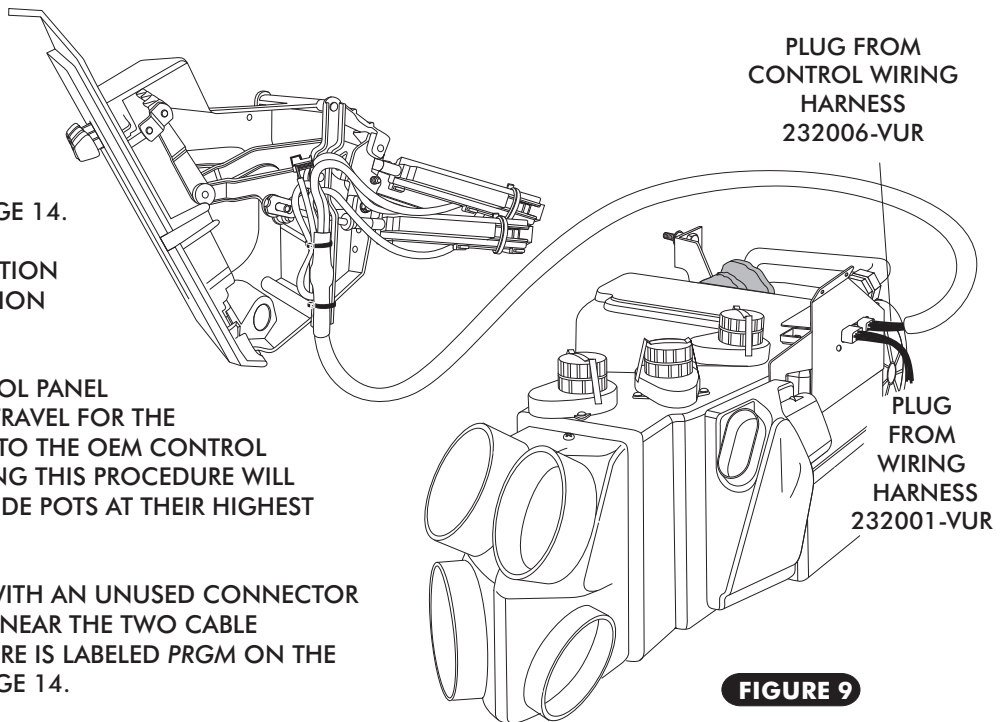

**FIGURE 9**



# 1969 CAMARO w/o AC CNTRL PNL

## CONTROL PANEL CALIBRATION PROCEDURE

1. TURN THE IGNITION SWITCH ON (DO NOT START THE ENGINE)
2. CONNECT THE WHITE JUMPER WIRE TO VEHICLE'S GROUND (FOR EXAMPLE THE VEHICLE CHASSIS). ENSURE THAT THE GRAY WIRE IS NOT GROUNDED. DO NOT CONNECT JUMPER WIRE TO THE GRAY PRGM WIRE.

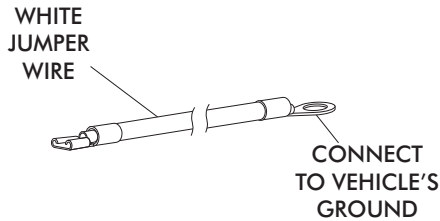

3. MOVE ALL OF THE CONTROL LEVERS TO THEIR MAXIMUM POSITIONS, AS SHOWN.



4. GROUND THE GRAY WIRE BY CONNECTING THE GRAY PRGM WIRE & WHITE JUMPER WIRE FOR APPROXIMATELY 5 SECONDS (THE BLOWER WILL CHANGE SPEEDS WHEN STEP FOUR IS COMPLETE)

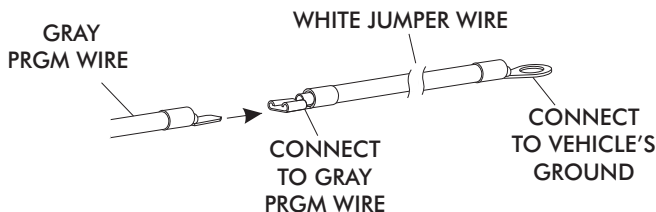

5. LEAVING THE GRAY WIRE GROUNDED, MOVE ALL OF THE CONTROL LEVERS TO THEIR MINIMUM POSITIONS AS SHOWN.



6. DISCONNECT THE GRAY WIRE FROM THE WHITE GROUND JUMPER WIRE (THE BLOWER WILL CHANGE SPEEDS WHEN STEP SIX IS COMPLETE)

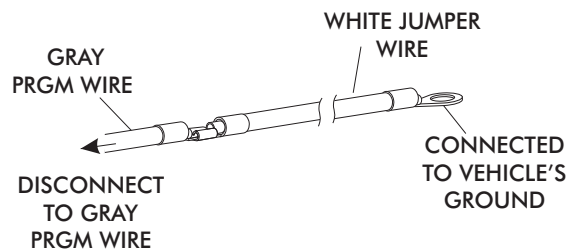

7. START THE ENGINE AND TEST ALL OF THE CONTROLS TO ENSURE THAT THE INTENDED RESULTS WERE ACCOMPLISHED.

8. DISCONNECT THE WHITE JUMPER WIRE FROM VEHICLE'S GROUND.

NOTE: THIS PROCEDURE MAY BE REPEATED IF NECESSARY.

**\* WHEN FINISHED, TAPE OVER PROGRAM WIRE CONNECTOR WITH ELECTRICAL TAPE TO PREVENT ACCIDENTAL CONTACT WITH CHASSIS GROUND.**





# OPERATION OF CONTROLS

**NOTE:**

WHEN BATTERY POWER IS FIRST CONNECTED TO THE ECU, THE COMPUTER GOES THROUGH AN INITIALIZATION SEQUENCE. THIS INITIALIZATION MAY TAKE UP TO 30 SECONDS. DURING INITIALIZATION THE BLOWER WILL NOT OPERATE, BUT THE DOORS INSIDE THE UNIT WILL BE OPERATING. A LOW BATTERY OR DISCONNECTING THE BATTERY MAY ALSO TRIGGER A RE-INITIALIZATION. DURING START UP, A LOW BATTERY MAY DROP BELOW 7 VOLTS, TRIGGERING RE-INITIALIZATION.

THE COLD LEVER TOGGLES BETWEEN COLD AND HOT MODES. FOR A/C MODE SLIDE THE COLD LEVER ALL THE WAY UP TO ENGAGE THE COMPRESSOR. SLIDE THE COLD KNOB LEVER DOWN TO SELECT DESIRED TEMPERATURE. FOR HEAT MODE SLIDE THE COLD LEVER ALL THE WAY DOWN TO DISENGAGE THE COMPRESSOR. SLIDE THE COLD LEVER UP TO TO SELECT DESIRED TEMPERATURE.

ALL SWITCHES ARE VARIABLE BETWEEN POSITIONS, SYSTEM WILL PERFORM A BLEND BETWEEN THE FUNCTIONS.

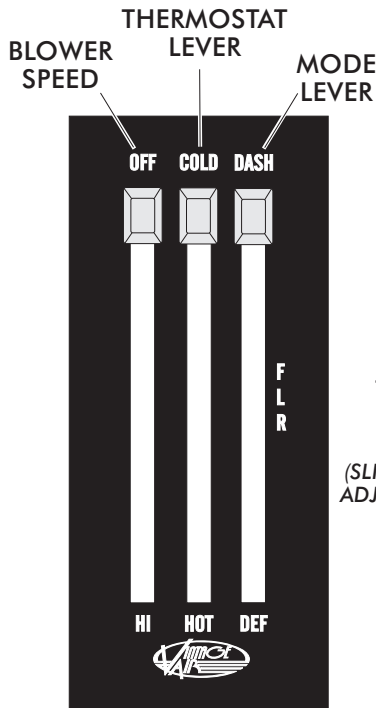

**SYSTEM OFF**

**BLOWER SPEED**  
THIS LEVER CONTROLS THE BLOWER SPEED, FROM OFF TO HI

**THERMOSTAT LEVER**  
IN A/C MODE SLIDE THE THERMOSTAT LEVER ALL THE WAY UP TO THE COLD POSITION, FOR MAXIMUM COOLING (SLIDE LEVER UP OR DOWN TO ADJUST DESIRED TEMPERATURE)

**MODE LEVER**  
SLIDE THE LEVER TO THE "DASH" POSITION



**A/C MODE**

**BLOWER SPEED**  
SLIDE LEVER DOWN TO DESIRED BLOWER SPEED, FROM OFF TO HI

**THERMOSTAT LEVER**  
IN A/C MODE SLIDE THE THERMOSTAT LEVER ALL THE WAY UP TO THE COLD POSITION, TO ENGAGE COMPRESSOR. FOR MAXIMUM COOLING (SLIDE LEVER UP OR DOWN TO ADJUST DESIRED TEMPERATURE)

**MODE LEVER**  
SLIDE THE LEVER TO THE "DASH" POSITION

**HEAT MODE**

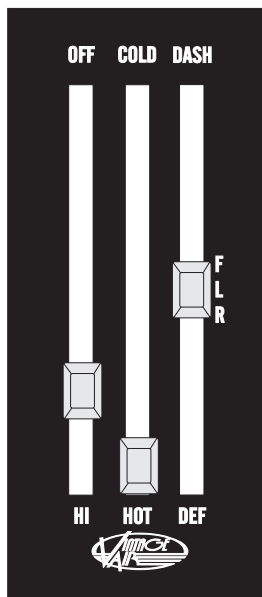

**BLOWER SPEED**  
SLIDE LEVER DOWN TO DESIRED BLOWER SPEED, FROM OFF TO HI

**THERMOSTAT LEVER**  
IN HEAT MODE SLIDE THE THERMOSTAT LEVER ALL THE WAY DOWN TO THE HOT POSITION, FOR MAXIMUM HEATING (SLIDE LEVER UP OR DOWN TO ADJUST DESIRED TEMPERATURE)

**MODE LEVER**  
SLIDE THE LEVER TO THE "FLR" POSITION

**DEFROST/DEFOG MODE**

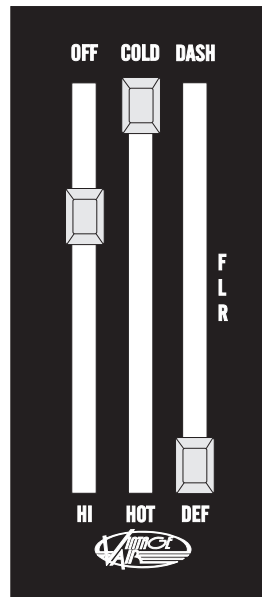

**BLOWER SPEED**  
SLIDE LEVER DOWN TO DESIRED BLOWER SPEED, FROM OFF TO HI

**THERMOSTAT LEVER**  
IN DEFROST MODE SLIDE THE THERMOSTAT LEVER ALL THE WAY UP TO THE COLD POSITION, TO ENGAGE COMPRESSOR. FOR MAXIMUM COOLING (SLIDE LEVER UP OR DOWN TO ADJUST DESIRED TEMPERATURE)

**MODE LEVER**  
SLIDE THE LEVER TO THE "DEF" POSITION



# 1969 CAMARO w/o AC CNTRL PNL

## CONTROL KIT 474169

### CONTROL KIT PACKING LIST

No.	QTY.	PART No.	DESCRIPTION	
1.	1	484069-PCR	1969 CAMARO w/o AC PLACARD w/ BLACK BACKING SHEET	_____
2.	3	112002-SUA	SLIDE POT ASM	_____
3.	1	232006-VUR	GEN IV UNIVERSAL CONTROL HARNESS (TYPE B)	_____
4.	3	65976-VUE	3/16" PUSH-ON RING	_____
5.	3	491010-VUR	SLIDE POT CLAMP	_____
6.	5	21301-VUP	4" TIE WRAP	_____
7.	1	23140-VUW	GROUND WIRE	_____

CHECKED BY: \_\_\_\_\_  
 PACKED BY: \_\_\_\_\_  
 DATE: \_\_\_\_\_

