



FORD FLATHEAD LATE WIDE BRACKET

NOTE: THIS BRACKET KIT FITS A SINGLE WIDE-GROOVE BELT SYSTEM. THE ALTERNATOR PULLEY OFFSET IS CRITICAL FOR BELT ALIGNMENT. THIS KIT DOES NOT INCLUDE AN ALTERNATOR PULLEY. FOR INSTALLATIONS WHERE ALTERNATOR PULLEY REPLACEMENT IS REQUIRED FOR PROPER ALIGNMENT WITH THE COMPRESSOR, A GM WIDE-GROOVE ALTERNATOR PULLEY IS AVAILABLE IN (2) FINISHES FROM VINTAGE AIR (CHROME: PART # 739001, STANDARD: PART # 739002).

INSTALLATION

- INSTALL THE COMPRESSOR AND ALTERNATOR BRACKET AS SHOWN BELOW.

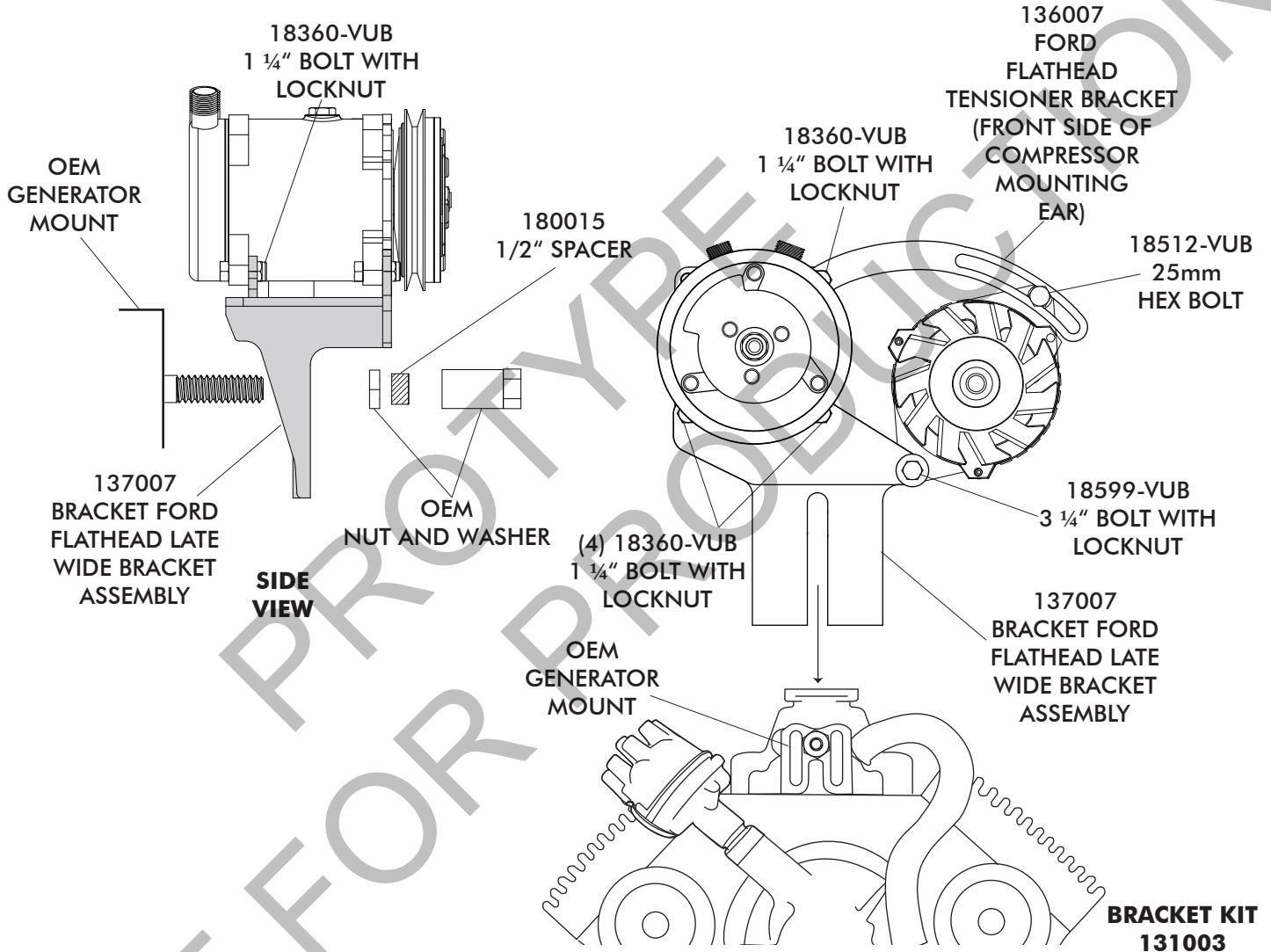

No.	QTY.	PART No.	DESCRIPTION
1.	1	137007	BRACKET, FORD FLATHEAD LATE WIDE ASSEMBLY
2.	1	136007	BRACKET, FORD FLATHEAD TENSIONER
3.	1	191019	HARDWARE KIT

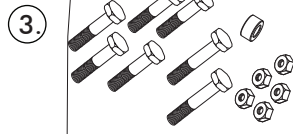
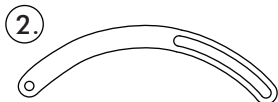
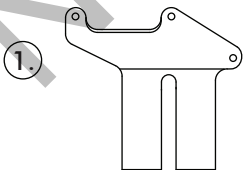

CHECKED BY: _____
 PACKED BY: _____
 DATE: _____