

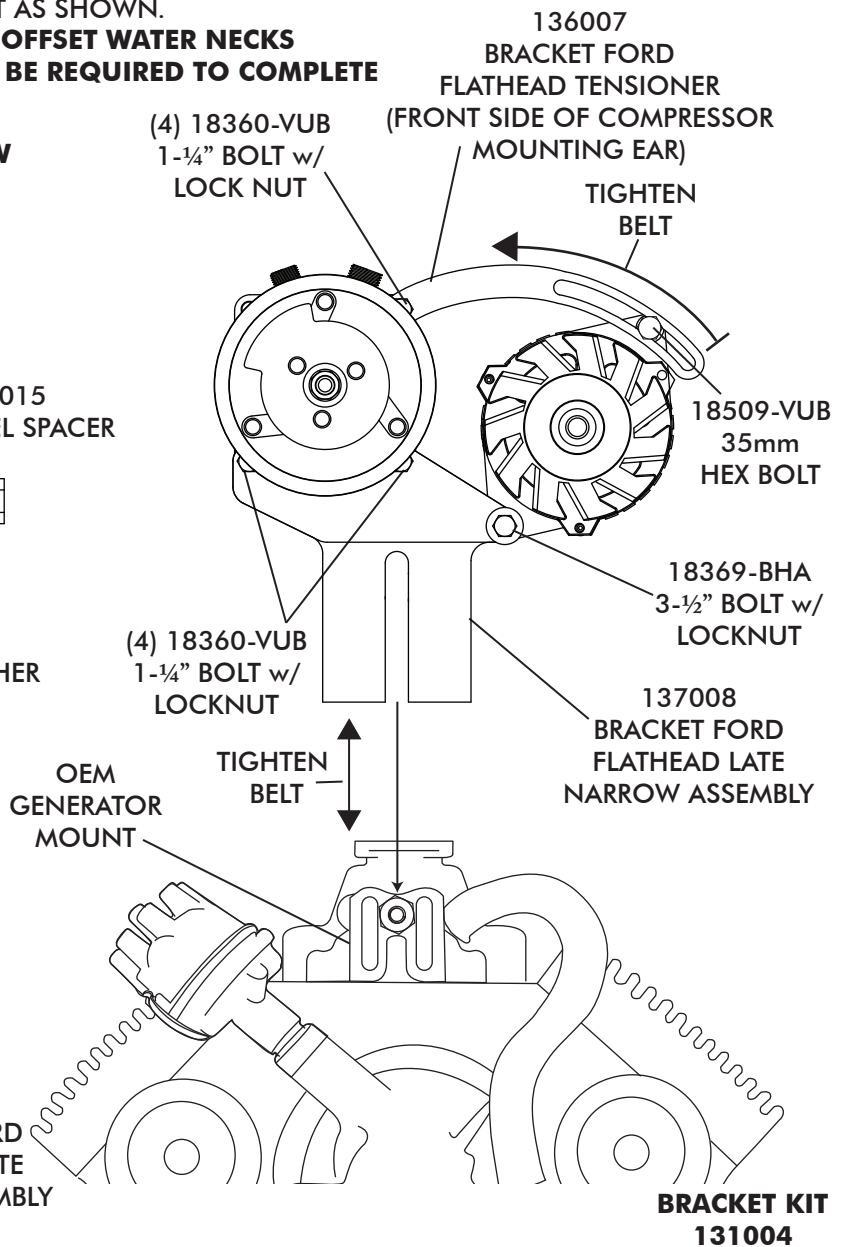

FORD FLATHEAD LATE NARROW BRACKET

INSTALLATION

- INSTALL THE COMPRESSOR AND ALTERNATOR BRACKET AS SHOWN BELOW.
- ADJUST THE BRACKET TO TIGHTEN THE COMPRESSOR BELT **FIRST**.
- ADJUST THE ALTERNATOR TO TIGHTEN BELT AS SHOWN.
- NOTE: THE PURCHASE OF (2) FLATHEAD OFFSET WATER NECKS (VINTAGE AIR PART # 70654-VUQ) WILL BE REQUIRED TO COMPLETE THE INSTALLATION.**

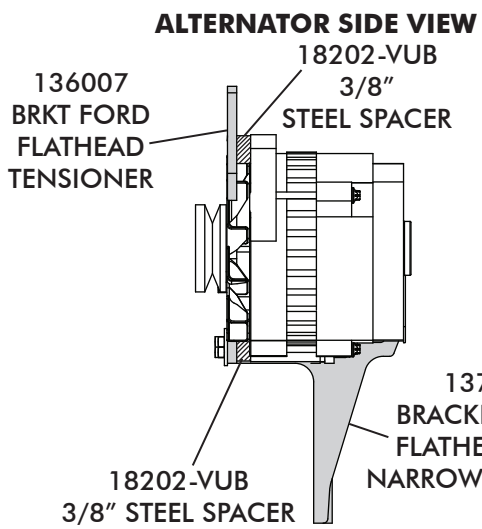
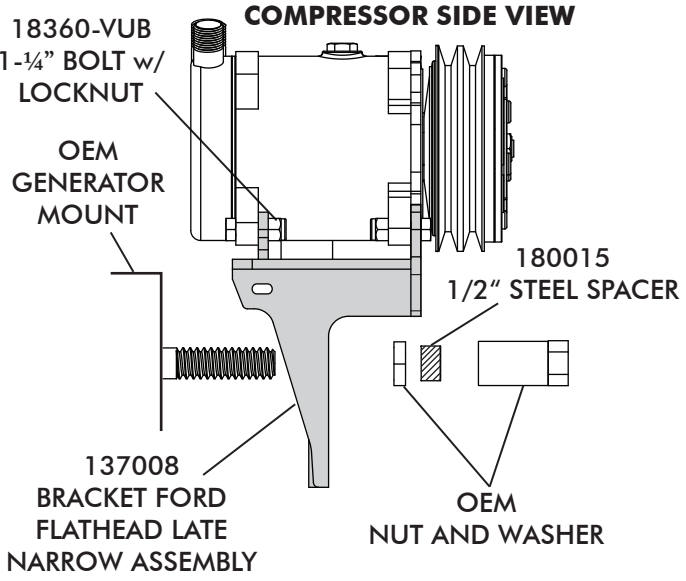

No.	QTY.	PART No.	DESCRIPTION
1.	1	137008	BRACKET FORD FLATHEAD LATE NARROW ASSEMBLY
2.	1	136007	BRACKET FORD FLATHEAD TENSIONER
3.	1	191020	HARDWARE KIT FORD FLATHEAD LATE NARROW

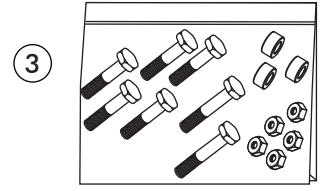
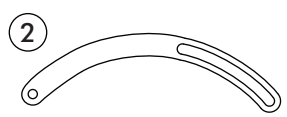
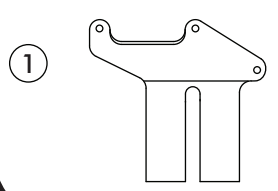

CHECKED BY: _____
 PACKED BY: _____
 DATE: _____