

- INSTALL COMPRESSOR BRACKET AND COMPRESSOR AS SHOWN BELOW. SOME FORD HEADS HAVE 3/8 HOLES AND SOME HAVE 7/16. BOTH 3/8 AND 7/16 BOLTS ARE FURNISHED IN THIS KIT. IF YOUR HEAD USES 7/16 BOLTS IT WILL BE NECESSARY TO ENLARGE THE 3 MOUNTING HOLES IN THE BRACKET TO 7/16. WITH COMPRESSOR BOLTED TO THE MOUNT, SLIDE THE COMPRESSOR UNTIL ONE OF THE GROOVES ON THE CLUTCH ALIGNS WITH YOUR PULLEYS. THEN TIGHTEN THE 2 BOLTS LOCKING IT IN PLACE. IT WILL BE NECESSARY TO DRILL ONE 3/8 HOLE AS SHOWN IN FIGURE 1 BELOW.

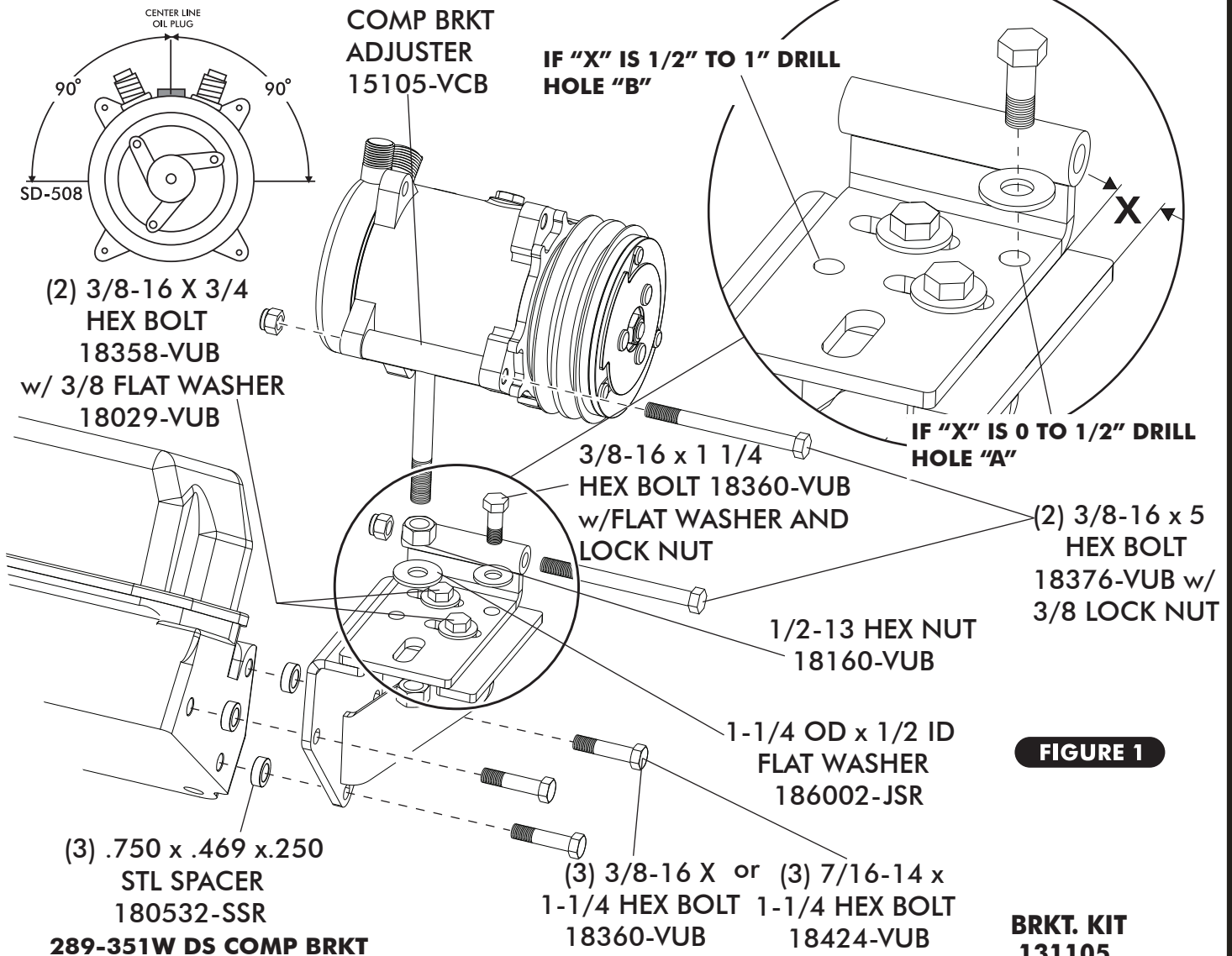
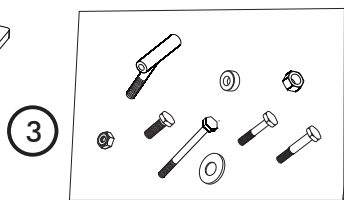
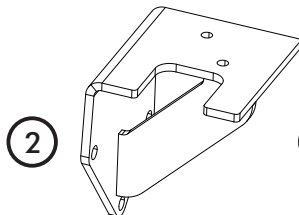
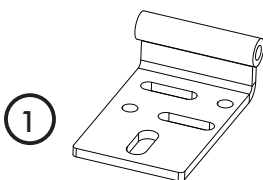

FIGURE 1

No.	QTY.	PART No.	DESCRIPTION
1.	1	137005	289-351W DS COMP MOUNT ASM.
2.	1	137004	289-351W DS COMP BRKT ASM
3.	1	191010	289-351W DS HARDWARE KIT



CHECKED BY: _____
PACKED BY: _____
DATE: _____