



331-354 Chrysler Hemi

Compressor/Alternator Bracket Kit

(151007)

Fits:
331 Hemi (1955)
354 Hemi (1956)

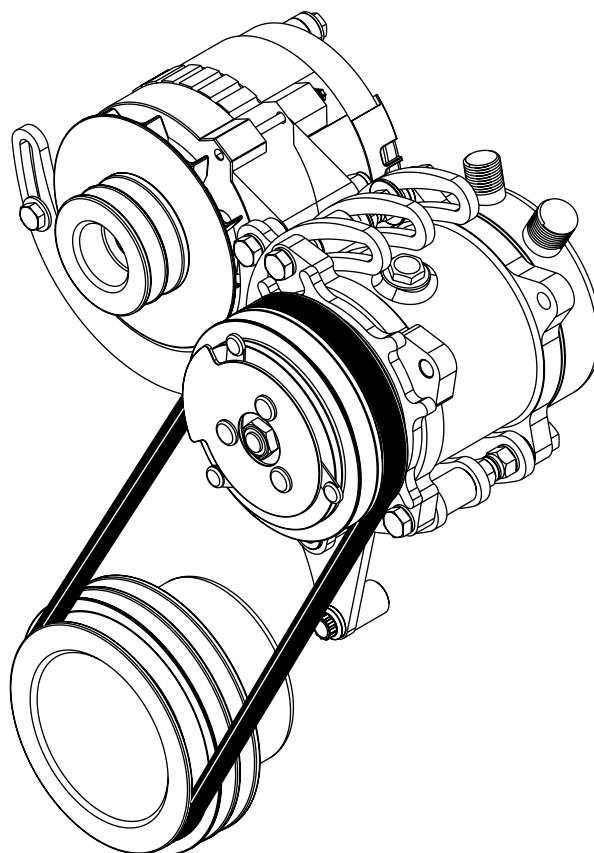

18865 Goll St. San Antonio, TX 78266
Phone: 210-654-7171
Fax: 210-654-3113
www.vintageair.com



www.vintageair.com

Table of Contents

Cover..... 1

Table of Contents..... 2

Packing List/Parts Disclaimer..... 3

Engine Compartment Disassembly, Mounting Bracket Assembly Installation..... 4

Compressor Installation..... 5

Alternator Installation..... 6

Alternator Rear Mounting Bracket Installation..... 7

Crankshaft Pulley Installation, Belt Routing, Compressor Warnings..... 8

Packing List..... 9

NOTE: To install this kit, the following additional parts are required:

Compressor — 04807-VUA

Alternator — 042916



www.vintageair.com

Packing List: 354 Chrysler Hemi Compressor/Alternator Bracket Kit (151007)

No.	Qty.	Part No.	Description
1.	1	151008	Bracket Assembly, Compressor/Alternator
2.	1	151009	Bracket, Alternator, Rear
3.	1	733109	Pulley, Crankshaft, Coated
4.	1	191031	Hardware Kit, Compressor/Alternator

**** Before beginning installation, open all packages and check contents of shipment. Please report any shortages directly to Vintage Air within 15 days. After 15 days, Vintage Air will not be responsible for missing or damaged items.**

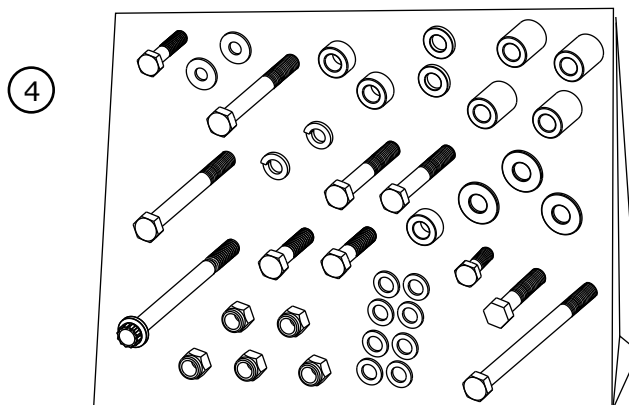
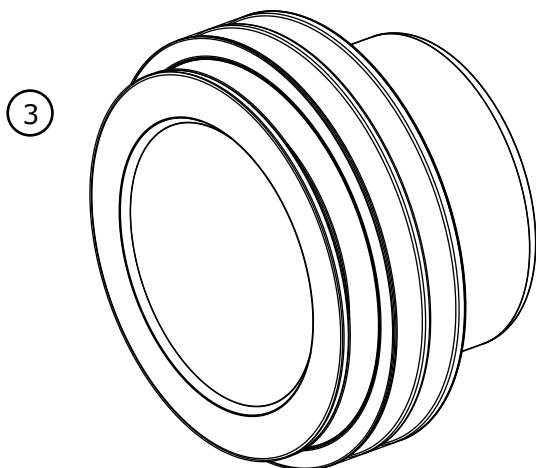
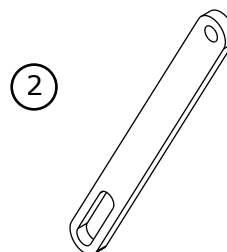
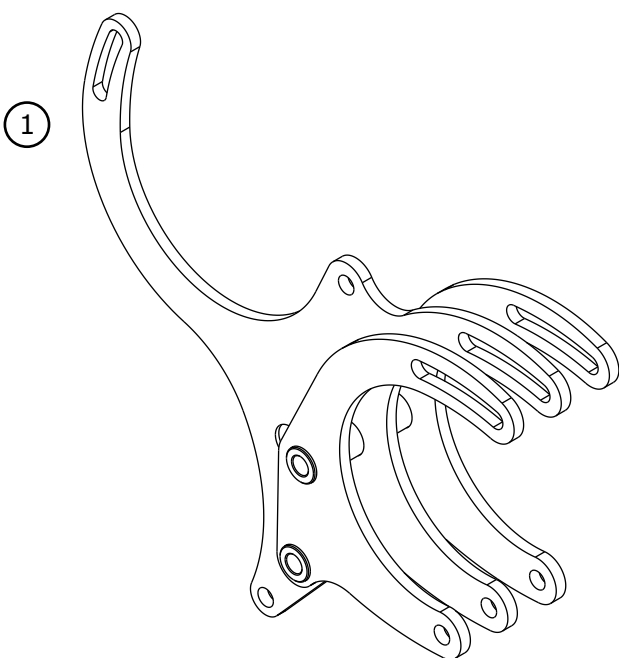

**NOTE: Images may not depict actual parts and quantities.
Refer to packing list for actual parts and quantities.**



www.vintageair.com

NOTE: Before tightening bolts, assemble all brackets loosely to engine. This will ensure proper alignment of all brackets.

Engine Compartment Disassembly

NOTE: Before starting the installation, check the function of the vehicle (horn, lights, etc.) for proper operation, and study the instructions, illustrations, & diagrams.

Perform the Following:

1. Remove all belts.
2. Remove generator and mounting bracket.
3. Remove engine cooling fan (retain hardware).
4. Remove crankshaft pulley and install new crankshaft pulley (Vintage Air Part #733109) with OEM hardware.
5. Remove upper and lower driver side cylinder head water pump mounting bolts.
6. Remove lower most driver side engine block water pump mounting bolt.

Mounting Bracket Assembly Installation

1. Install compressor/alternator mounting bracket assembly onto engine using appropriate hardware as shown below.

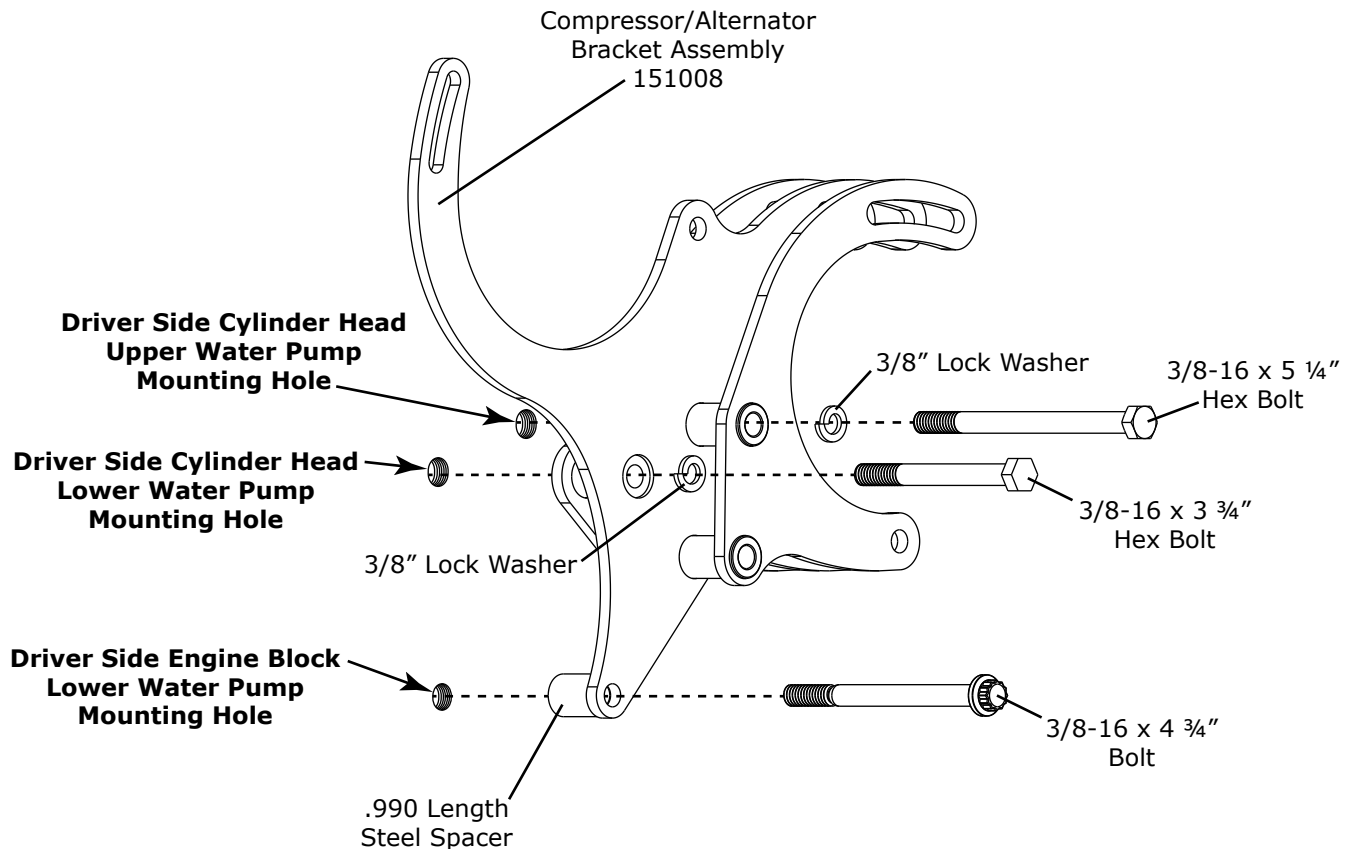

NOTE: Before tightening bolts, assemble all brackets loosely to engine. This will ensure proper alignment of all brackets.

www.vintageair.com

Compressor Installation

1. Install compressor onto compressor/alternator mounting bracket assembly using appropriate hardware as shown below.

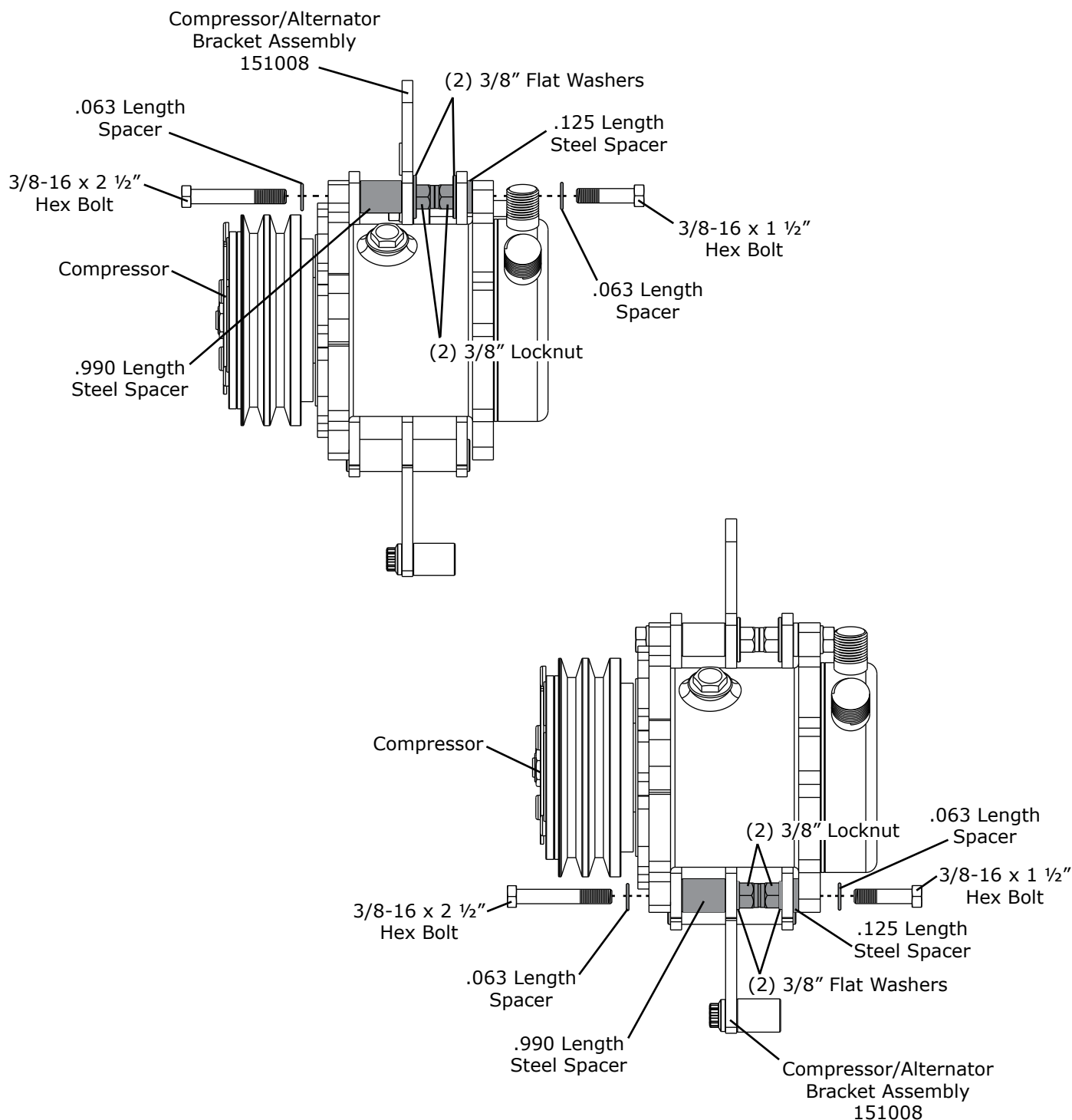

NOTE: Before tightening bolts, assemble all brackets loosely to engine. This will ensure proper alignment of all brackets.

www.vintageair.com

Alternator Installation

1. Using appropriate hardware, install alternator onto compressor/alternator mounting bracket assembly as shown below.

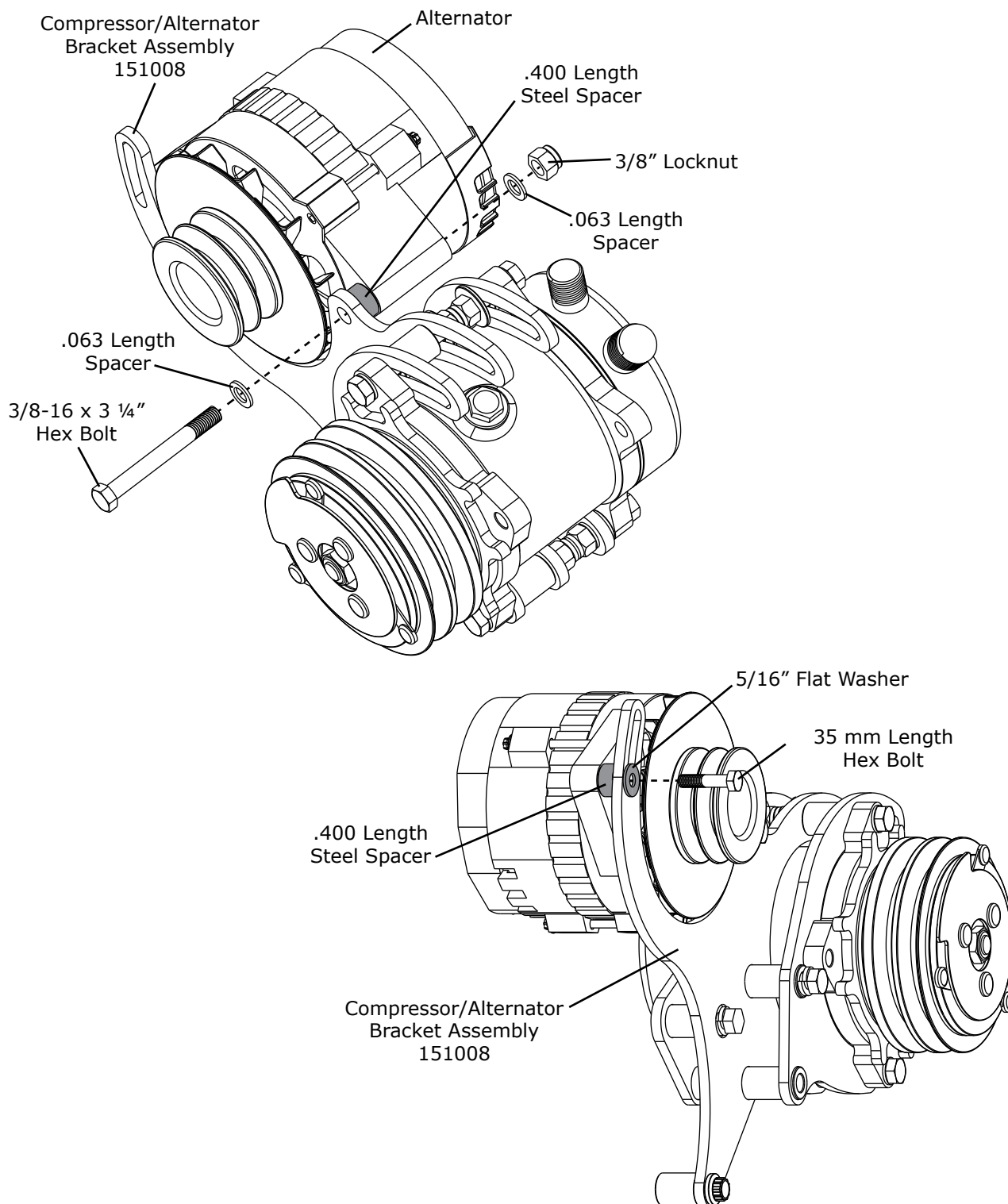

NOTE: Before tightening bolts, assemble all brackets loosely to engine. This will ensure proper alignment of all brackets.

Alternator Rear Mounting Bracket Installation

1. Using appropriate hardware, install alternator rear mounting bracket onto alternator as shown below.

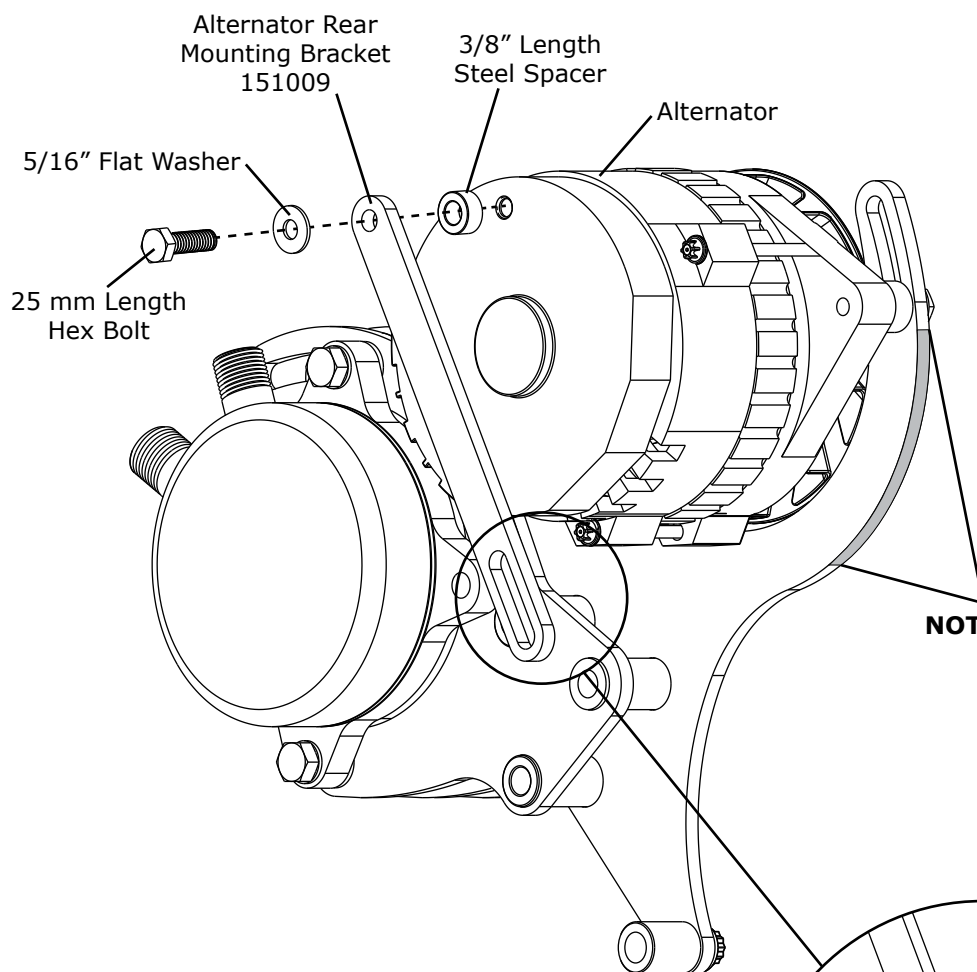

NOTE: Due to various intake manifold configurations and water neck designs, some grinding in this area may be required in order to attain sufficient clearance.

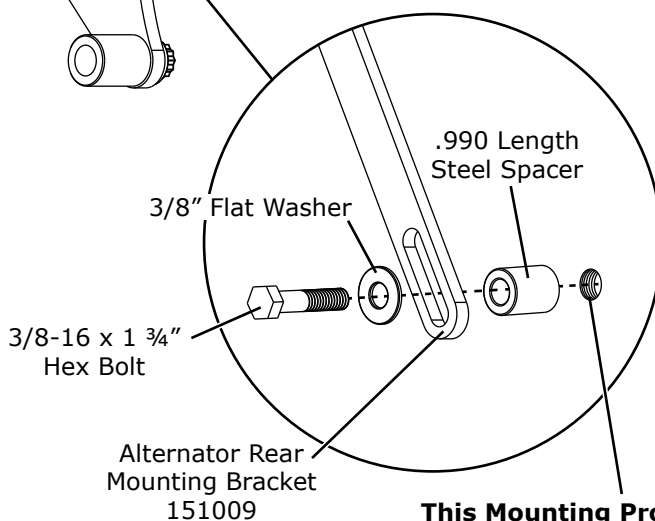

This Mounting Provision Is on the Back Side of the Water Pump at the Thermostat

Crankshaft Pulley Installation/ Belt Routing

1. Install the crankshaft pulley using OEM hardware.
2. Install (2) alternator belts using factory generator belt routing.
3. Route compressor belt as shown below. Vintage Air recommends using only Dayco, Gates or Goodyear brand reinforced V-belts with this compressor/alternator bracket kit. Any use of lesser-quality belts may cause improper performance. Compressor belt length of 48.5" is recommended. **NOTE: This can vary with the diameter of your water pump and crankshaft pulleys.**

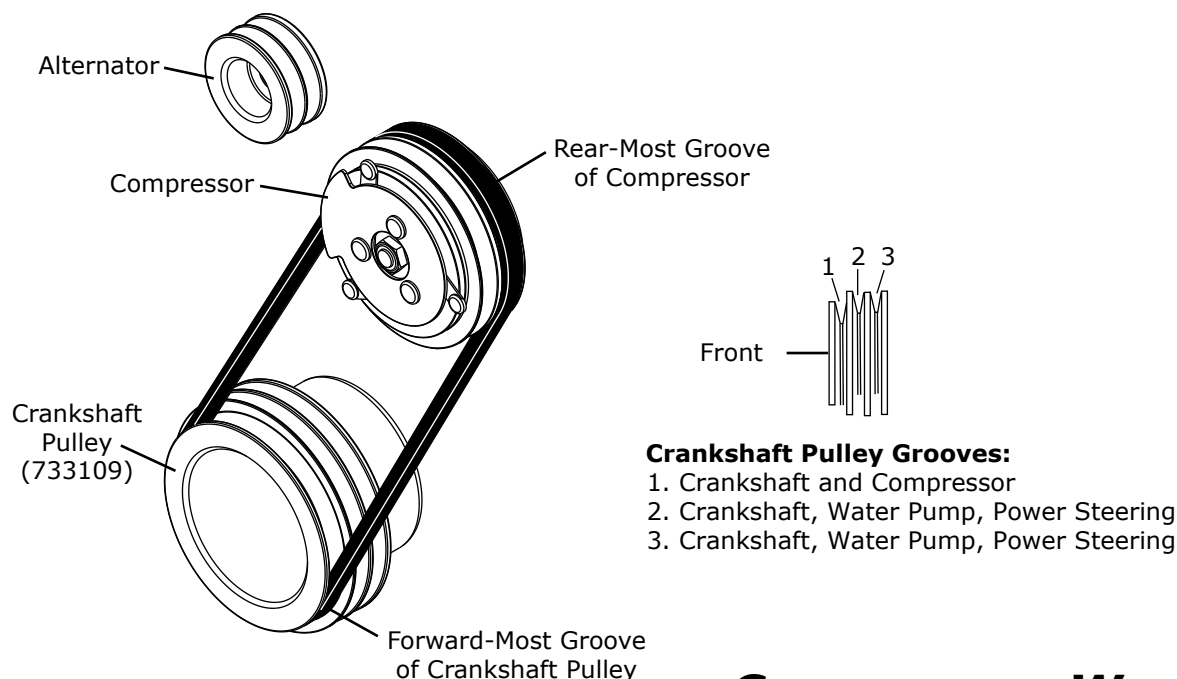

Compressor Warnings

NOTE: Failure to follow these procedures will void all warranties.

1. With compressor kit installed, and belt tightened, check angle of oil plug on compressor. As shown below, oil plug must not exceed 90° beyond vertical centerline.
2. Do not connect compressor clutch wire until system is being charged with refrigerant. Running compressor without refrigerant charge will result in compressor failure.

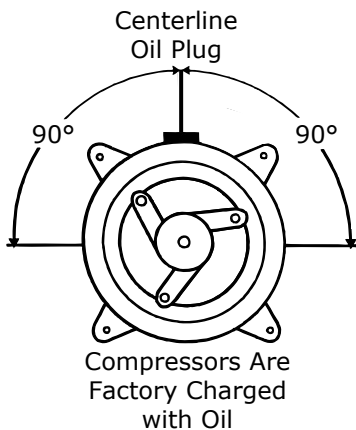

IMPORTANT NOTICE:

Do not connect compressor clutch wire until system is being charged with refrigerant. Running compressor without refrigerant will destroy compressor and void warranty.



www.vintageair.com

Packing List: 354 Chrysler Hemi Compressor/Alternator Bracket Kit (151007)

No.	Qty.	Part No.	Description	
1.	1	151008	Bracket Assembly, Compressor/Alternator	_____
2.	1	151009	Bracket, Alternator, Rear	_____
3.	1	733109	Pulley, Crankshaft, Coated	_____
4.	1	191031	Hardware Kit, Compressor/Alternator	_____

Checked By: _____

Packed By: _____

Date: _____

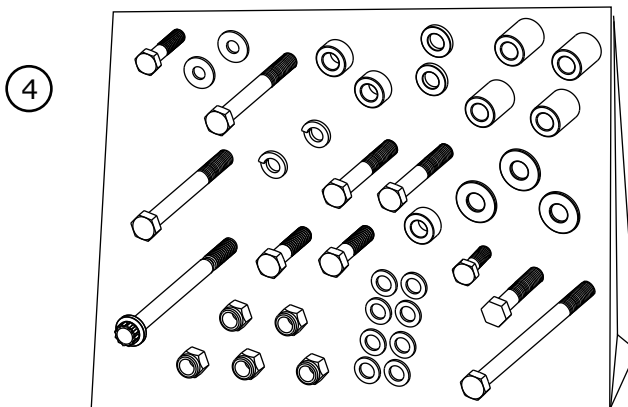
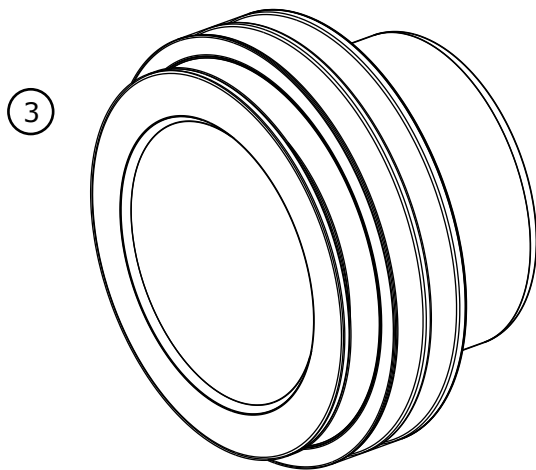
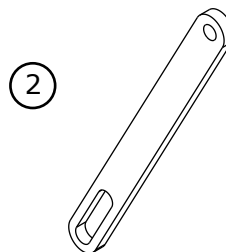
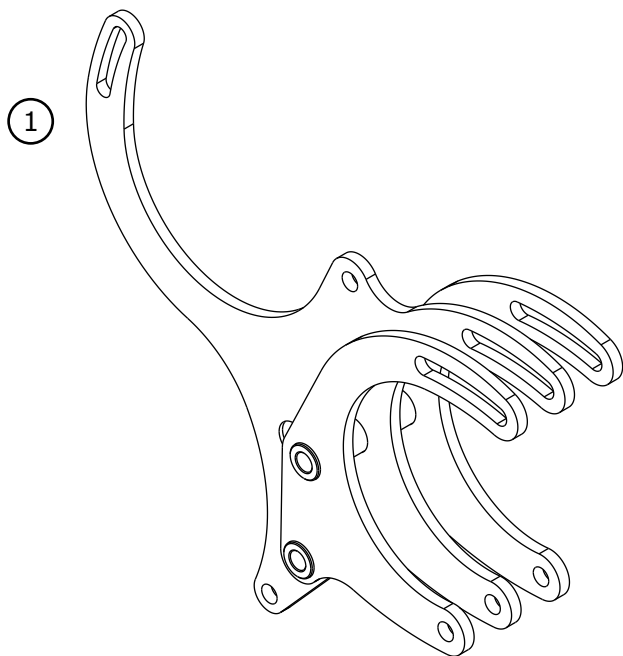

**NOTE: Images may not depict actual parts and quantities.
Refer to packing list for actual parts and quantities.**