

# Vintage Air Part # 15136-VCB

LOWER A.C.  
COMPRESSOR  
MOUNT

108R

Big Block Chevy - Passenger Side  
Short Water Pump

NOTE: REMOVE FUEL  
PUMP!

**ALAN  
GROVE**  
COMPONENTS, INC.

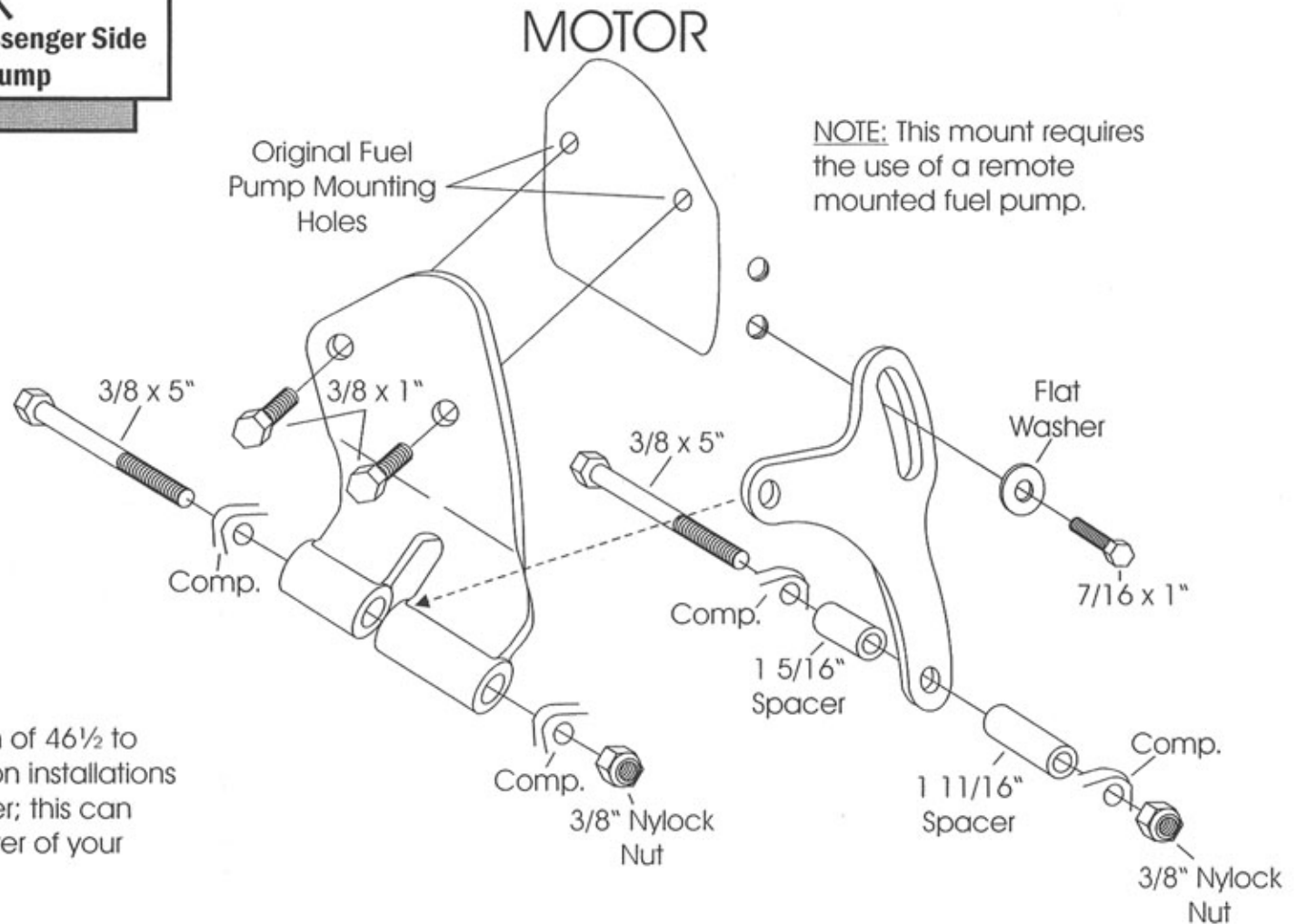

We use a belt length of 46½ to 47" with this mount on installations in our shop. However; this can vary with the diameter of your pulleys.

**As with any part of this nature, make sure it fits your application before painting or plating. Parts that have been painted, plated or modified may not be returned.**