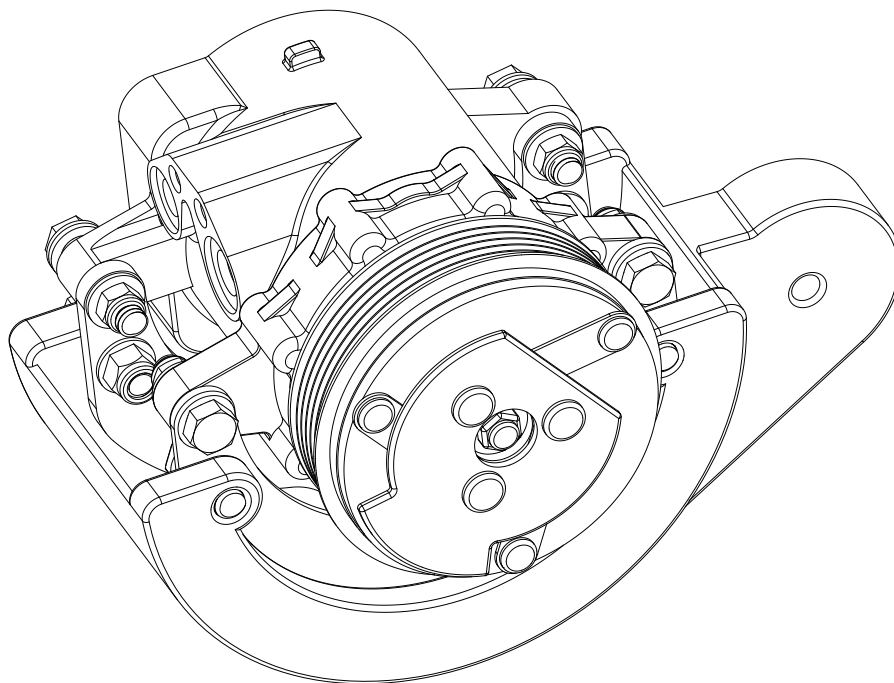




# Serpentine R4 to 7B10 Adapter

Bracket Kit  
(151585)

**Fits: 1988-92 GM F- and B-Body**  
**Fits: 1988-89 GM Chevrolet Pickup**



18865 Goll St. San Antonio, TX 78266  
Phone: 800-862-6658  
Sales: [sales@vintageair.com](mailto:sales@vintageair.com)  
Tech Support: [tech@vintageair.com](mailto:tech@vintageair.com)  
[www.vintageair.com](http://www.vintageair.com)



www.vintageair.com

# Table of Contents

Cover.....	1
Table of Contents/Preliminary Information.....	2
Packing List/Parts Disclaimer.....	3
F- and B-Body Engine Disassembly.....	4
F- and B-Body Adapter Bracket Installation.....	5
F- and B-Body Compressor Installation.....	6
F- and B-Body Reference Profiles.....	7
F- and B-Body Factory Serpentine Belt Routing.....	8
1988-89 GM Chevrolet Pickup Engine Disassembly.....	9
1988-89 GM Chevrolet Pickup Bracket and Compressor Installation.....	10
1988-89 GM Chevrolet Pickup Factory Serpentine Belt Routing.....	11
Packing List.....	12

## Additional Info: Please Read Before Beginning

- This compressor adapter kit is not intended to be used with the OEM A/C system, and is only recommended to work with Vintage Air systems.
- Before disconnecting any A/C compressor lines, be sure the system is properly evacuated.
- The compressor grounds through the bracket and into the engine, therefore, it is important to have a good ground connection. A separate ground wire may also be run to ensure ground continuity.
- Vintage Air recommends using only Dayco, Gates or Goodyear brand reinforced belts with this compressor bracket kit. A Gates K060960 belt was used for the stock pulley application for 1988-92 F- and B-Body installation and a Gates K061005 for the 1988-89 GM Chevrolet pickup installation. Belt lengths may vary depending on the accessories present and the diameter of the water pump, crankshaft, alternator and power steering pulleys. Measure your setup to verify the belt lengths.

### For 1988-92 F- and B-Body vehicles:

- These instructions are based on 1988-92 GM F-Body vehicles using GM bracket #10055800. There may be minor differences present on different vehicles.
- The OEM bracket shown in these instructions is a simplified representation and is not meant to reflect the actual OEM bracket.

### For 1988-89 GM Chevrolet Pickups:

- These instructions are based on 1988-89 GM pickups using GM bracket #10054896. There may be minor differences present on different vehicles.
- This bracket requires a 7B10 serpentine belt compressor (Vintage Air part number 046768-MTR (standard finish), 046769-MTQ (polished finish), or 046770 (chrome finish)).



A detailed tech video outlining the installation process is available on Vintage Air's YouTube channel at <http://bit.ly/3Hw3Wo9>. Viewing the tech video along with the written instructions will provide the installer the most detailed installation procedure.

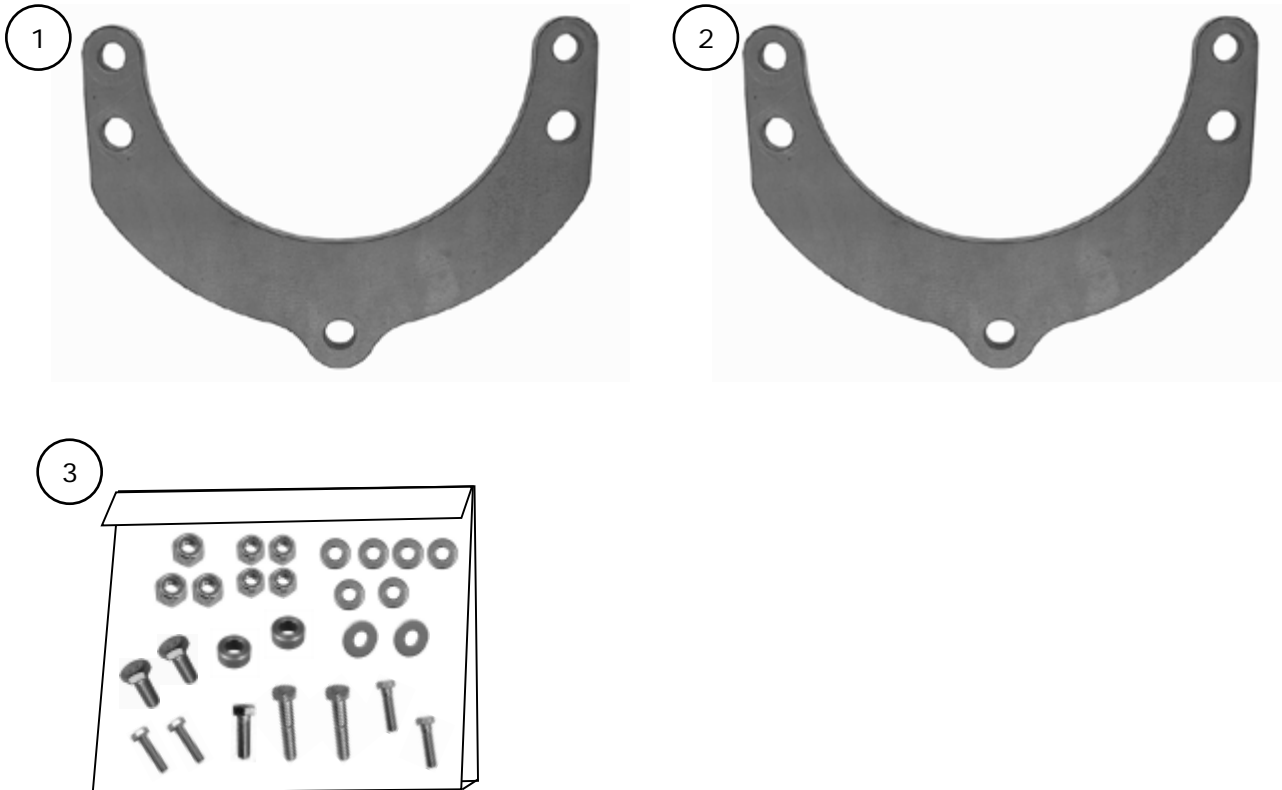


www.vintageair.com

## Packing List: Bracket Kit (151585)

No.	Qty.	Part No.	Description
1.	1	151586	Bracket, Front Adapter, 11 GA
2.	1	151587	Bracket, Rear Adapter, .250" Thick
3.	1	191135	Hardware Kit

**\*\* Before beginning installation, open all packages and check contents of shipment.  
Please report any shortages directly to Vintage Air within 15 days. After 15 days,  
Vintage Air will not be responsible for missing or damaged items.**



**NOTE: Images may not depict actual parts and quantities.  
Refer to packing list for actual parts and quantities.**

## F- and B-Body Engine Disassembly

1. Disconnect the battery.
2. Evacuate the A/C system.
3. Remove the tension from the serpentine belt using a 1/2" drive ratchet or breaker bar, then rotate the tensioner arm counter-clockwise (See Photo 1, below).
4. Remove the bolt holding the A/C lines to the rear of the OEM compressor (See Photo 2, below).  
**NOTE: Reference evaporator instruction (905189) for more information on A/C line removal.**
5. Disconnect the electrical connections (See Photos 3 and 4, below).
6. Remove (3) bolts from the rear of the OEM compressor, then remove the compressor (See Photo 5, below).

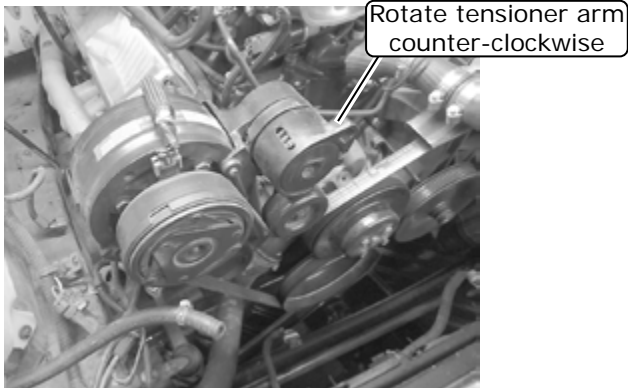


Photo 1

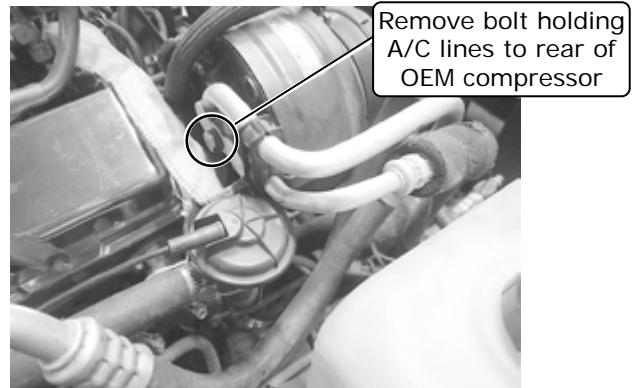


Photo 2

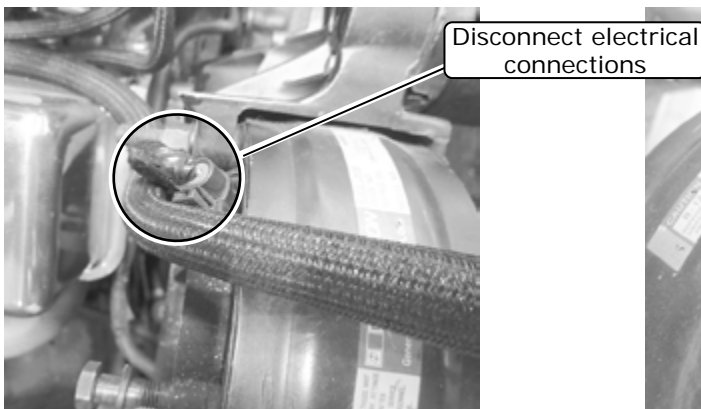


Photo 3

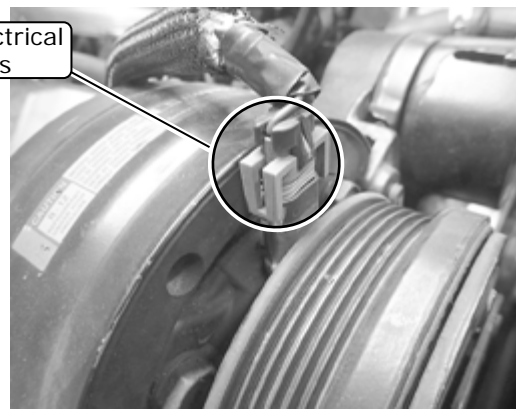


Photo 4

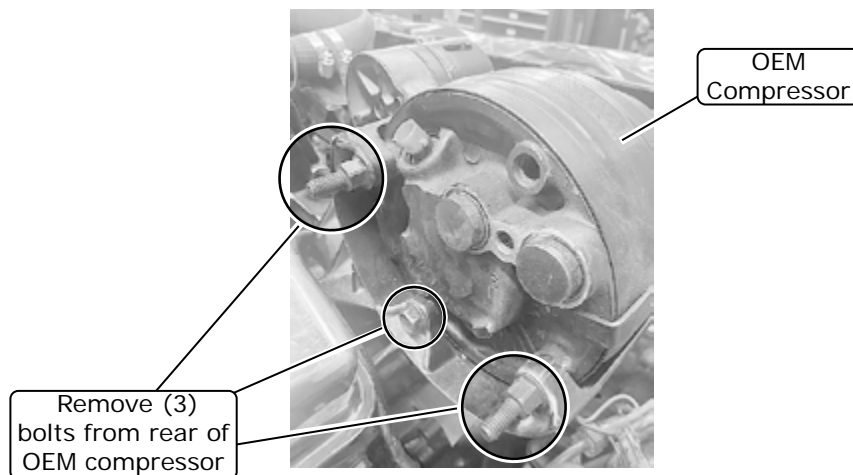
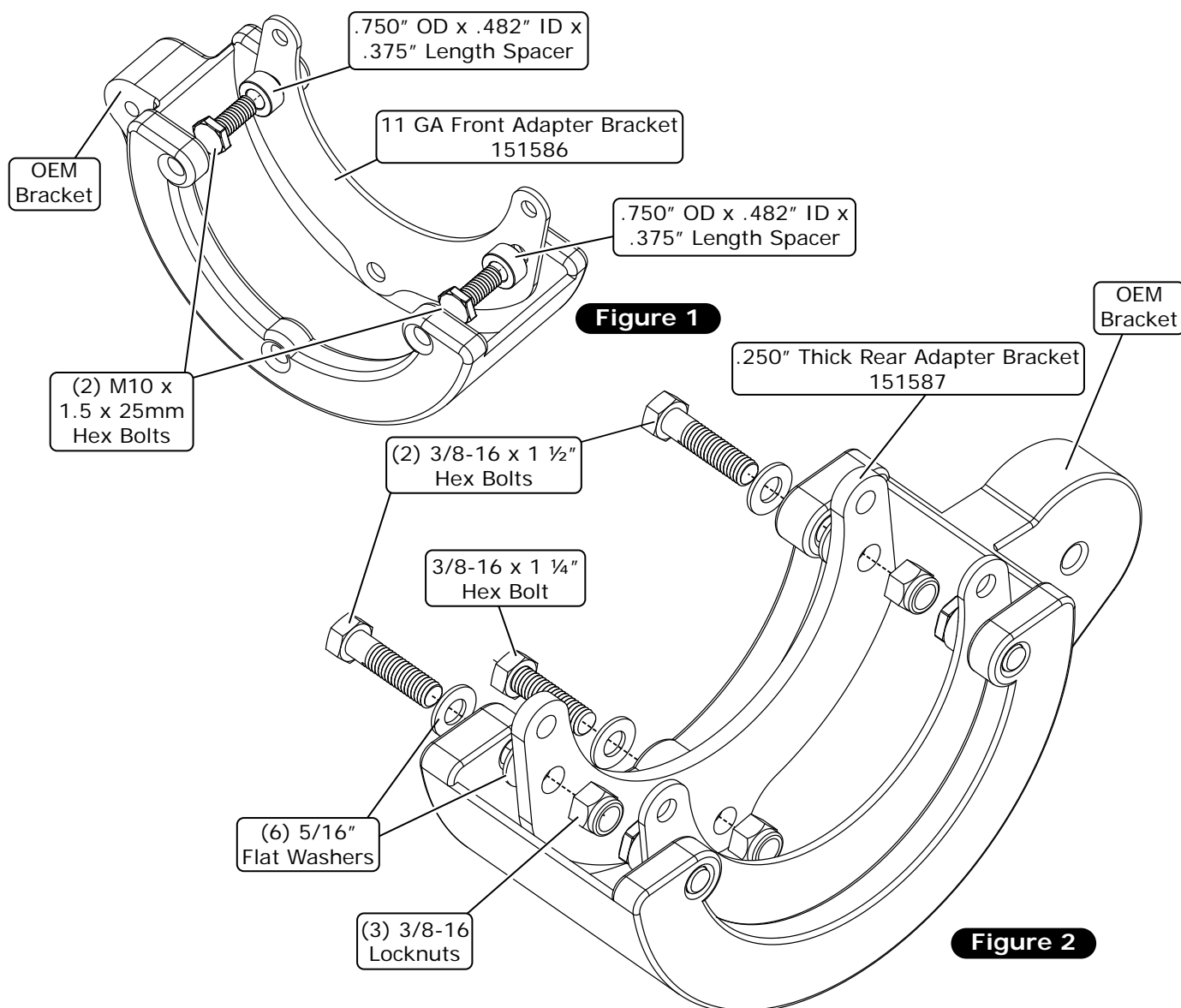


Photo 5

## F- and B-Body Adapter Bracket Installation

1. Install the 11 GA front adapter bracket onto the inside front of the OEM bracket. Secure it using (2) M10 x 1.5 x 25mm hex bolts and (2) .750" OD x .482" ID x .375" length spacers threaded into the OEM bracket as shown in Figure 1, below.
2. Install the .250" thick rear adapter bracket onto the inside rear of the OEM bracket. Beginning at the bottom center hole, install a 3/8-16 x 1 1/4" hex bolt and (2) 5/16" flat washers, with (1) washer installed between the rear adapter bracket and the OEM bracket. Secure it with a 3/8-16 locknut as shown in Figure 2, below.
3. Secure the upper holes on the rear adapter bracket with (2) 3/8-16 x 1 1/2" hex bolts, (4) 5/16" flat washers and (2) 3/8-16 locknuts, once again, with washers between the rear adapter bracket and the OEM bracket as shown in Figure 2, below.



## F- and B-Body Compressor Installation

1. Place the compressor into the cradle, with the front ears of the compressor against the rear of the 11 GA front adapter bracket. Secure the front ears using (2) 5/16-18 x 1 1/4" hex bolts, (2) 1/4" USS flat washers and (2) 5/16-18 locknuts as shown in Figure 1, below. **NOTE: The 1/4" USS flat washer installs behind the front compressor ears.**
2. Secure the rear compressor ears with (2) 5/16-18 x 1 3/4" hex bolts, and (2) 5/16-18 locknuts as shown in Figure 2, below. **NOTE: Bushings on the rear compressor ears collapse to remove slack from the bracket setup.**
3. Reinstall the serpentine belt using the OEM tensioner.

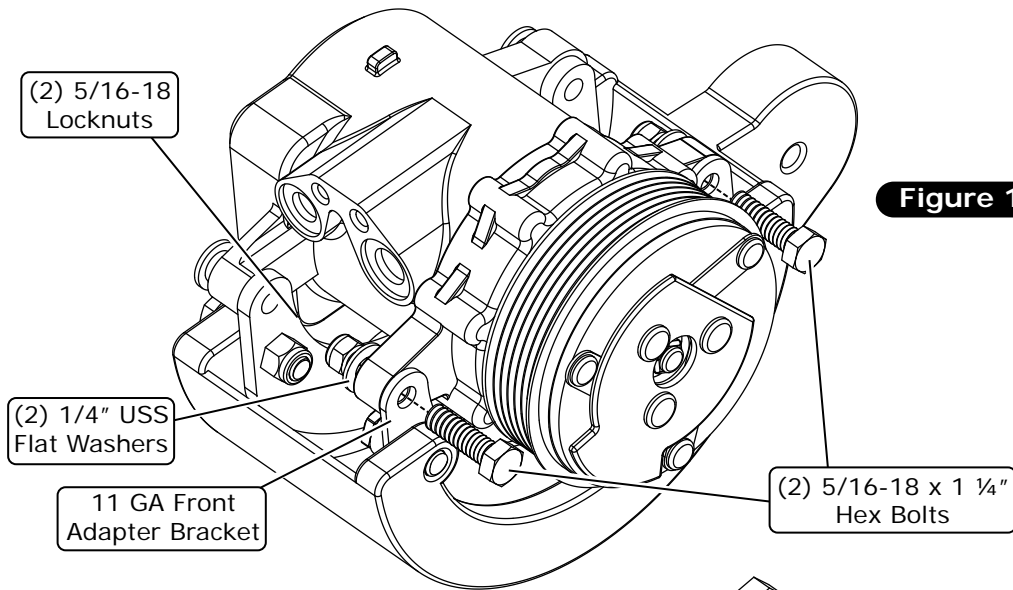


Figure 1

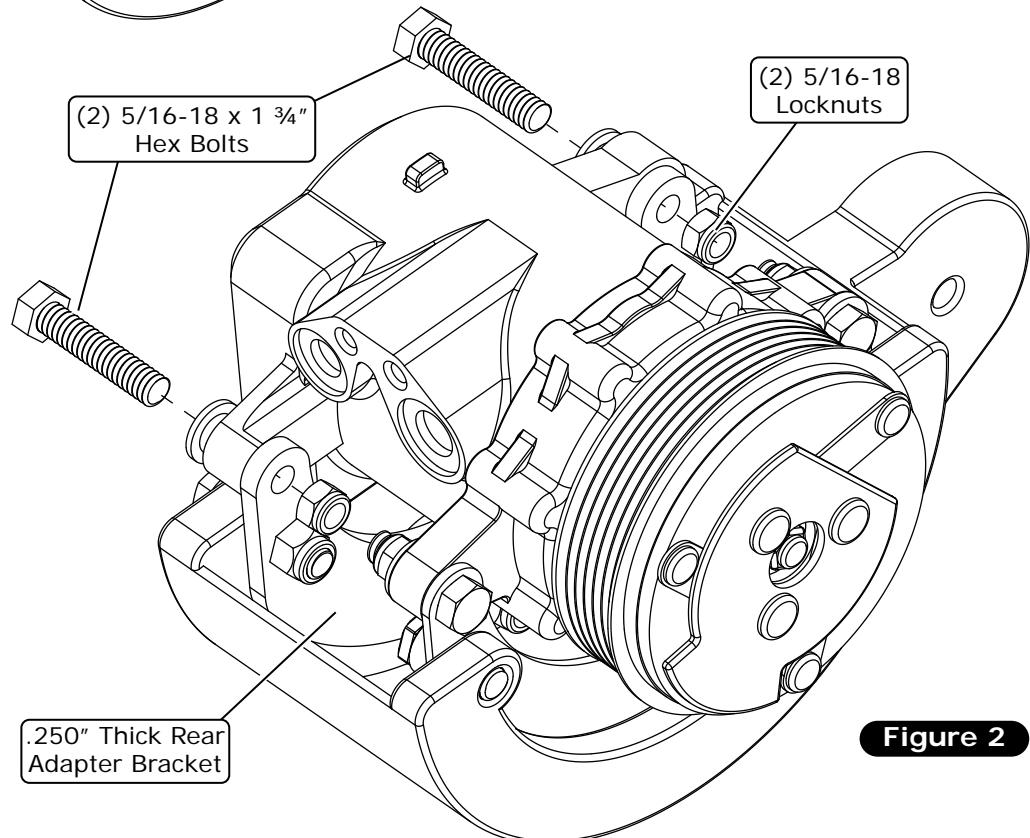
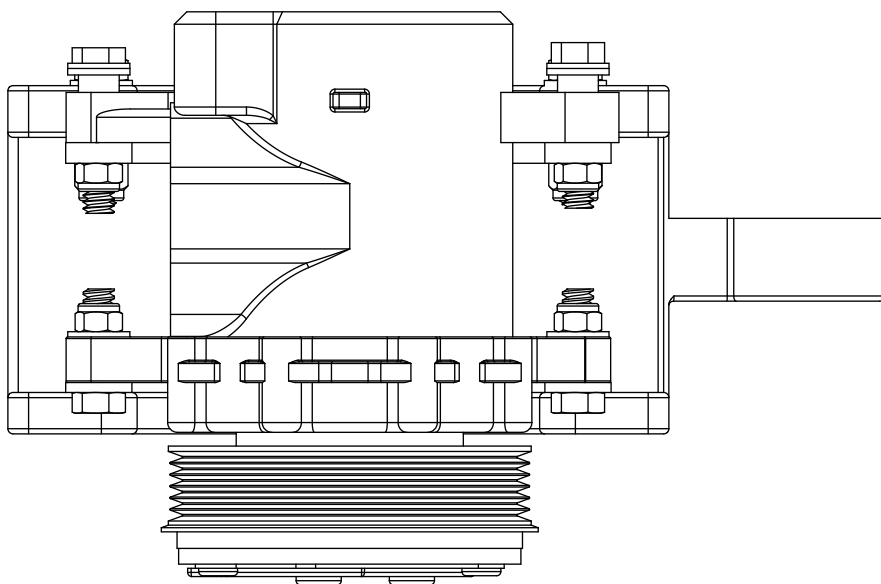
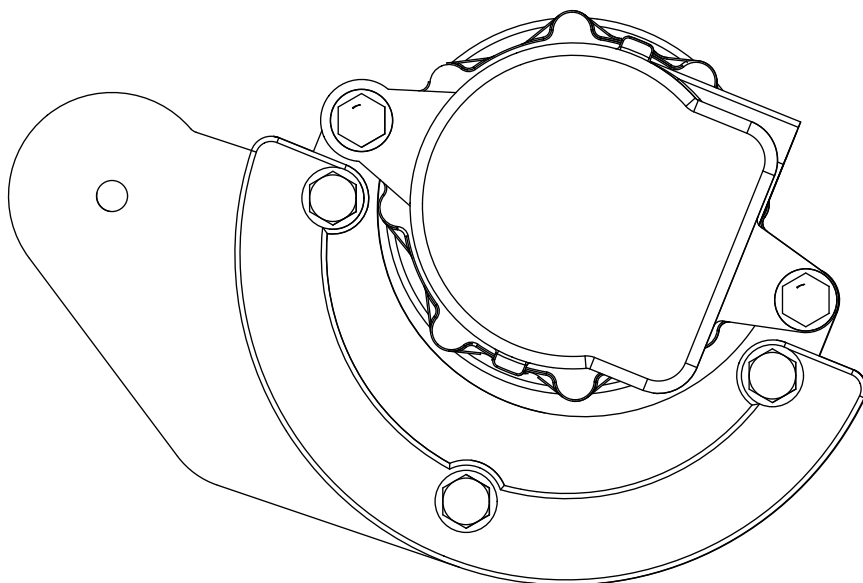


Figure 2

## ***F- and B-Body Reference Profiles***



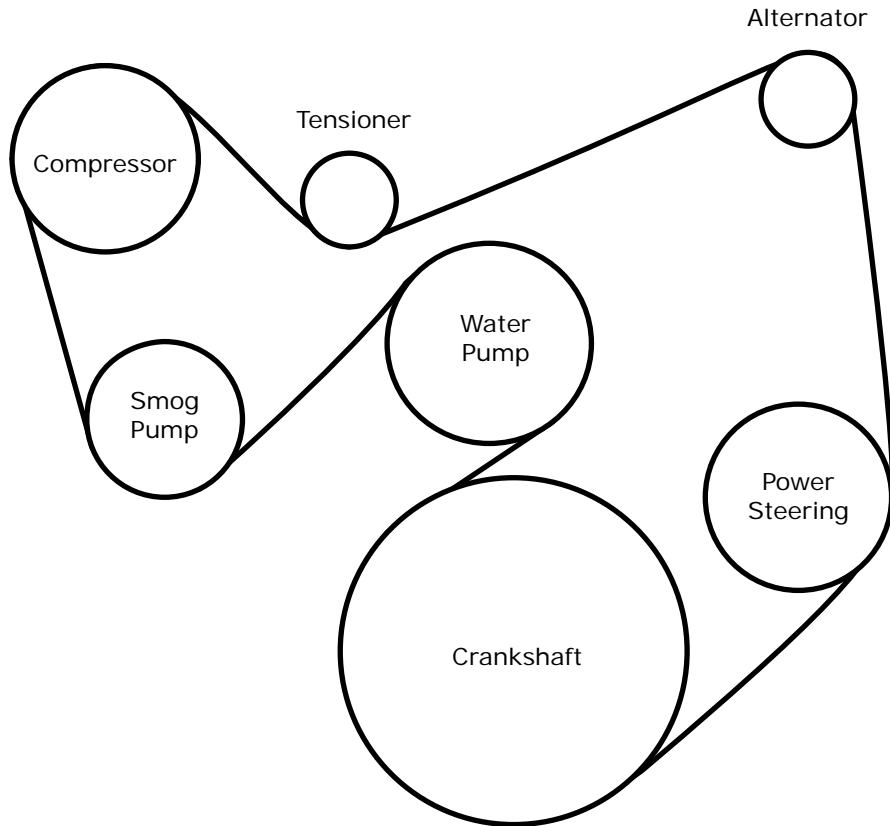
**Top View**



**Rear View**

## *F- and B-Body Factory Serpentine Belt Routing Diagram*

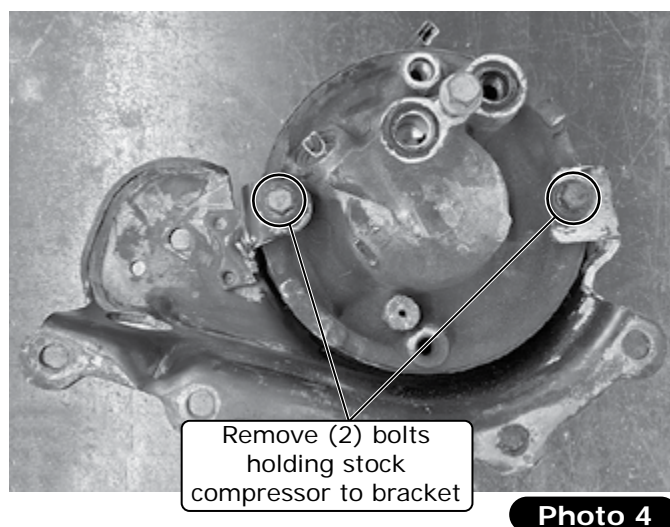
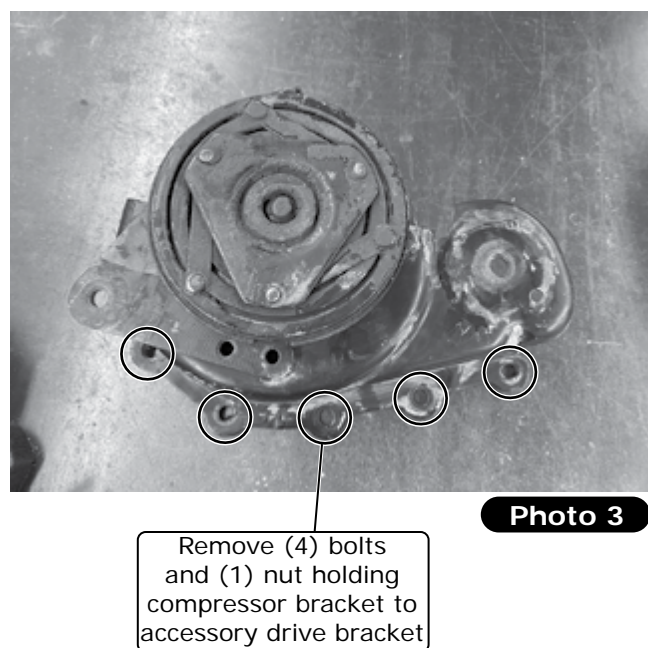
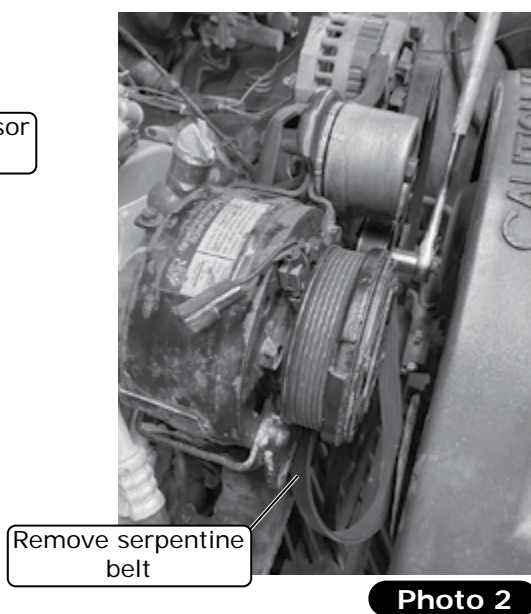
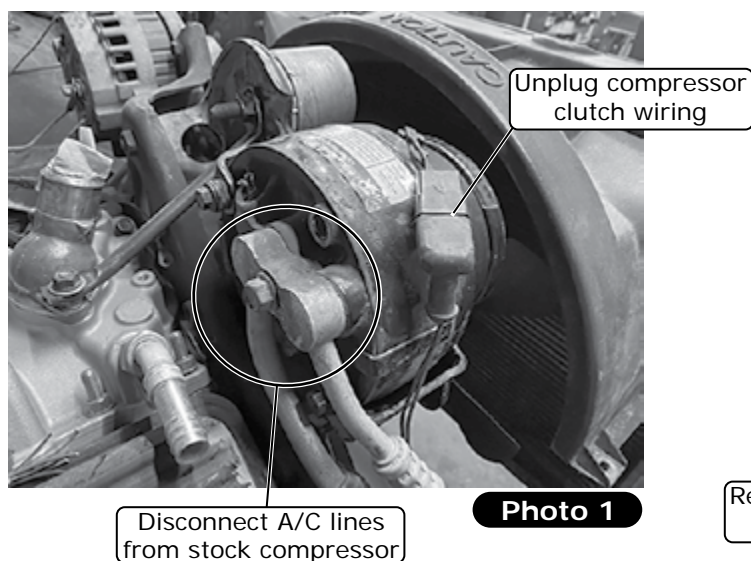
NOTE: Other belt routings may exist for A.I.R. (Air Injection Reactor) bypass, etc.





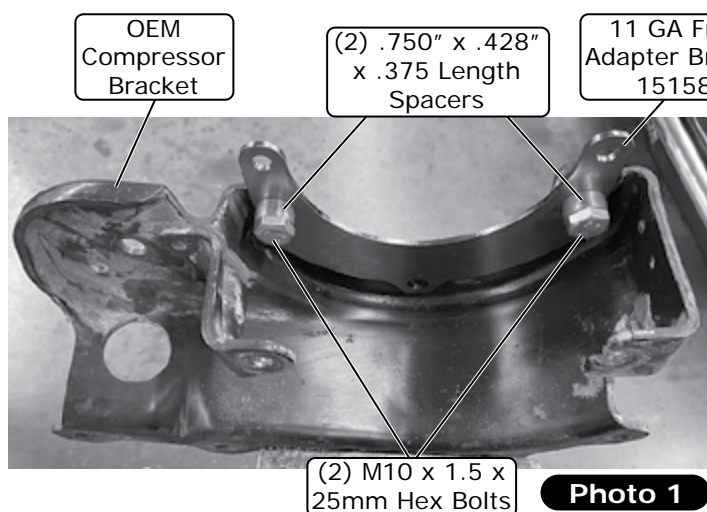
## 1988-89 GM Chevrolet Pickup Engine Disassembly

1. Disconnect the battery.
2. Evacuate the A/C system.
3. Disconnect the A/C lines from the stock compressor, then unplug the wiring for the compressor clutch (See Photo 1, below).
4. Remove the serpentine belt by pulling the tensioner belt to loosen it (See Photo 2, below).
5. Remove the (4) bolts and (1) nut holding the main compressor bracket onto the accessory drive bracket (See Photo 3, below).
6. On a workbench, remove the (2) bolts holding the stock compressor to the bracket (See Photo 4, below).

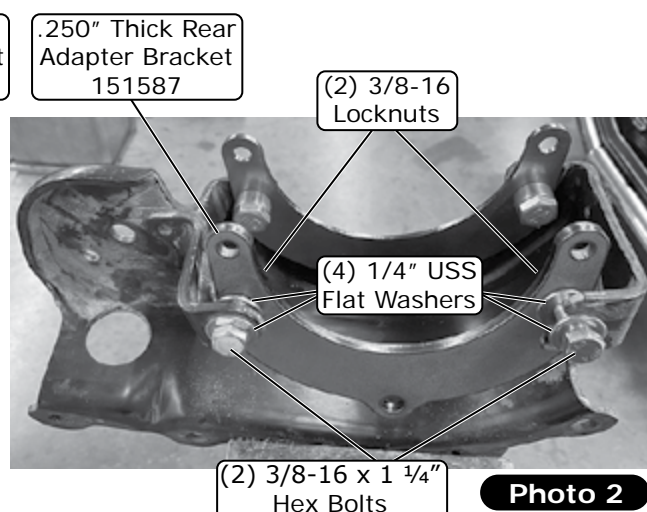


## 1988-89 GM Chevrolet Pickup Bracket and Compressor Installation

1. Attach the 11 GA front adapter bracket onto the compressor bracket using (2) .750" x .428" x .375" length spacers and (2) M10 x 1.5 x 25mm hex bolts (See Photo 1, below).
2. Attach the .250" thick rear adapter bracket onto the compressor bracket using (2) 3/8-16 x 1 1/2" hex bolts, (4) 5/16" flat washers and (2) 3/8-16 locknuts (See Photo 2, below).
3. Secure the front of the compressor to the 11 GA front adapter bracket using (2) 5/16-18 x 1 1/4" hex bolts, (2) 1/4" USS flat washers, and (2) 5/16-18 locknuts (See Photo 3, below). Then, secure the back of the compressor to the .250" thick rear adapter bracket using (2) 5/16-18 x 1 3/4" hex bolts and (2) 5/16-18 locknuts (See Photo 3, below).
4. Install the new compressor bracket assembly onto the accessory drive using the (4) OEM bolts and (1) OEM nut (See Photo 4, below).
5. Install the new serpentine belt using the OEM tensioner.
6. Route the belts as shown on Page 11.

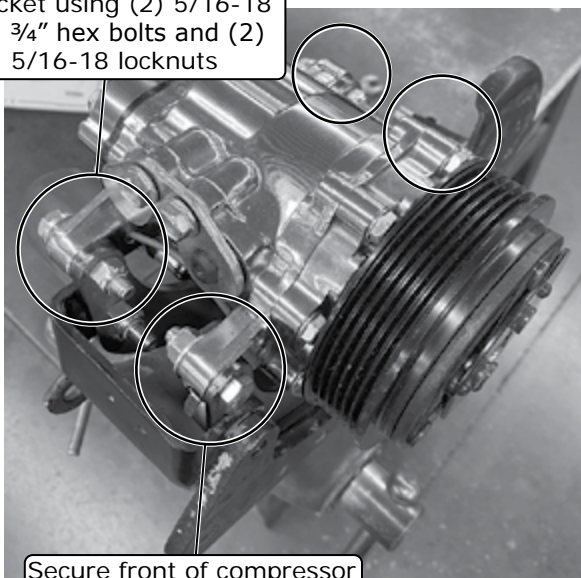


**Photo 1**

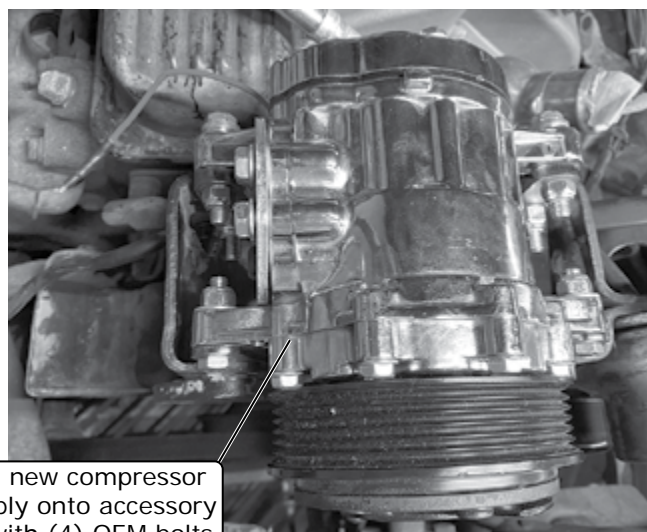


**Photo 2**

Secure back of compressor to .250" thick rear adapter bracket using (2) 5/16-18 x 1 3/4" hex bolts and (2) 5/16-18 locknuts



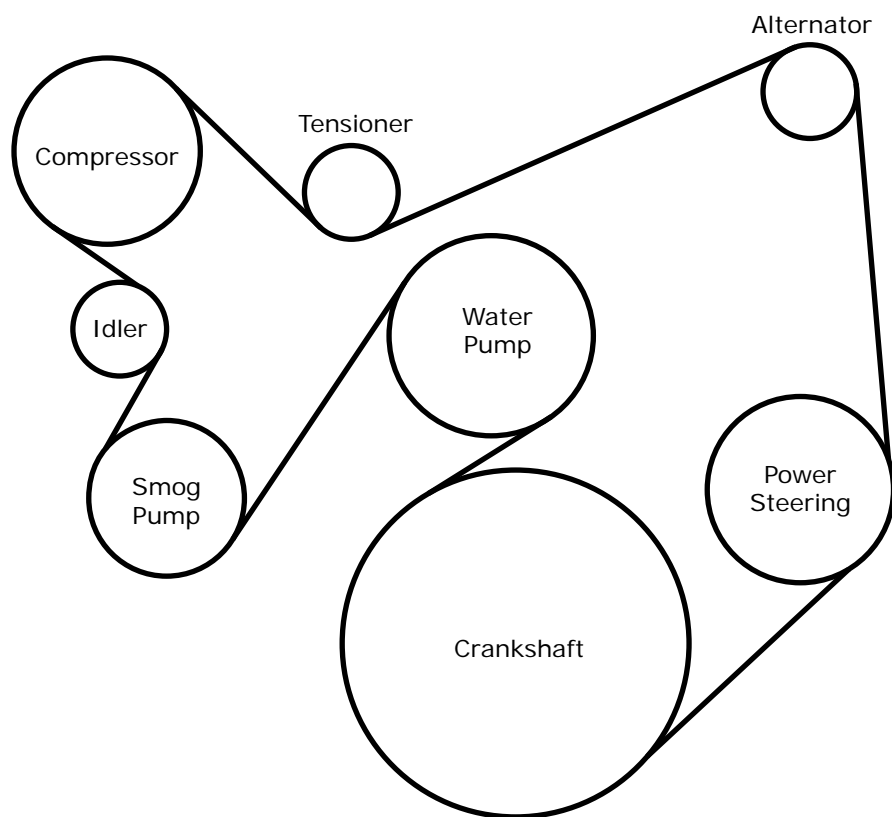
**Photo 3**



**Photo 4**

## 1988-89 GM Chevrolet Pickup Factory Serpentine Belt Routing Diagram

NOTE: Other belt routings may exist for A.I.R. (Air Injection Reactor) bypass, etc.





www.vintageair.com

## Packing List: Bracket Kit (151585)

No.	Qty.	Part No.	Description
1.	1	151586	Bracket, Front Adapter, 11 GA
2.	1	151587	Bracket, Rear Adapter, .250" Thick
3.	1	191135	Hardware Kit

Checked By: \_\_\_\_\_  
Packed By: \_\_\_\_\_  
Date: \_\_\_\_\_

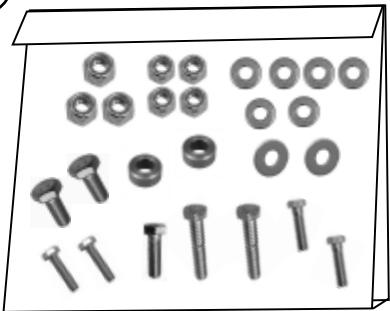
1



2



3



NOTE: Images may not depict actual parts and quantities.  
Refer to packing list for actual parts and quantities.