

VENTAGE
BAR

**INSTALLATION INSTRUCTIONS FOR
TOYOTA LAND CRUISER
COMPRESSOR BRACKET
ASSEMBLY
15465-VTB**

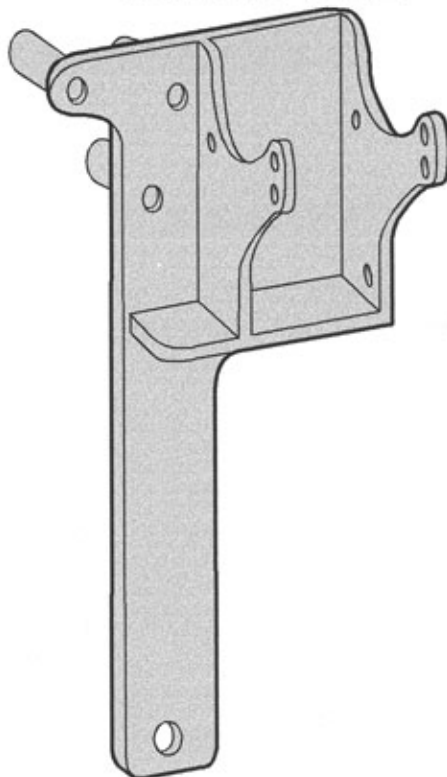

▶ CHECK THE CONTENTS OF THIS PACKAGE AGAINST THE PARTS LIST ON BACK PAGE. ◀

RADIATOR SUPPORT BRACE - PASSENGER SIDE

- THE COMPRESSOR MOUNT ASSEMBLY WILL HIT THE PASSENGER SIDE RADIATOR SUPPORT BRACE.
- LOOSEN THE SUPPORT BRACE AT THE RADIATOR JUST ENOUGH TO ALLOW MOVEMENT.
- REMOVE THE BOLT FROM THE LOWER END OF THE BRACE (AT THE BATTERY BOX SUPPORT).
- MOVE THE BRACE OUTWARD (TO THE PASSENGER SIDE), ROTATE THE ROD AND BUSHINGS FOR BEST FIT.
- DRILL A 1 1/32" INCH HOLE IN THE BATTERY BOX SUPPORT AND SECURE WITH THE SUPPLIED 5/16"NC x 1" BOLT AND LOCKNUT. THE HOLE WILL BE APPROXIMATELY ONE INCH IN FROM THE PASSENGER EDGE OF THE BATTERY BOX SUPPORT AND ONE INCH DOWN. SEE FIGURE 1.
- TRUCKS WITH SMALL ALTERNATORS MAY ONLY NEED TO BEND THE SUPPORT ARM FOR CLEARANCE.

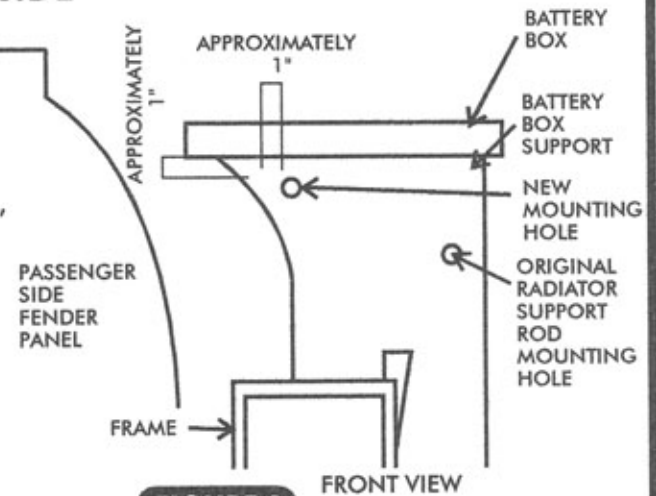

FIGURE 1

COMPRESSOR INSTALLATION

- REMOVE THE TOP BOLT FROM THE PASSENGER MOTOR MOUNT - CLEAN AND TAP (12mm X 1.25 PITCH).
- CLEAN AND TAP THE THREE MOUNTING BOSS HOLES IN THE CYLINDER HEAD. (10mm X 1.25 PITCH).
- ASSEMBLE THE COMPRESSOR BRACKET AND THE COMPRESSOR, SEE FIGURES 2, 3 & 3A. IT IS NECESSARY TO HAVE THE FRONT MOST MOUNTING BOLT IN PLACE BEFORE MOUNTING THE A/C COMPRESSOR ON THE BRACKET.

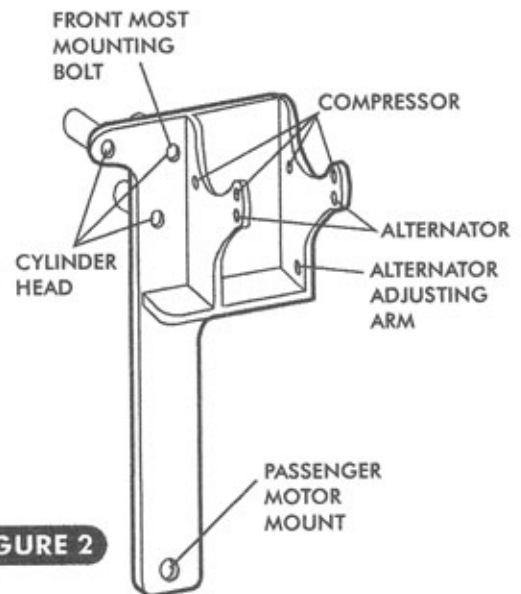
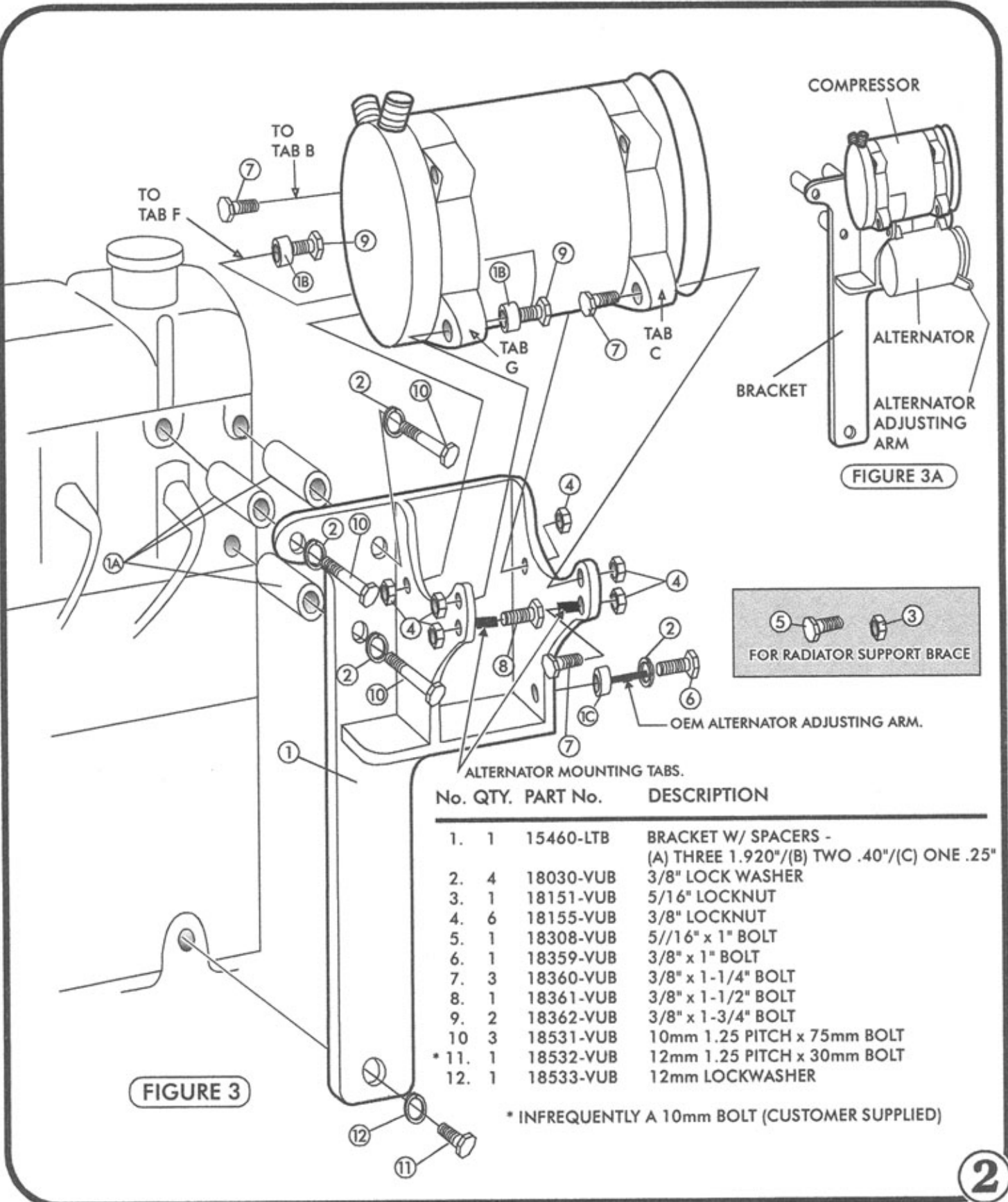

FIGURE 2

BELTS AND PULLEYS

- THE COMPRESSOR AND OEM ALTERNATOR WILL USE THE SAME PULLEY AS THE AS THE ALTERNATOR ORIGINALLY DID. POWER STEERING AND EMISSION CONTROL BELTS ARE NOT AFFECTED.
- NORMALLY A 22590 [SIZE 22(WIDE) BY 59 INCHES(LONG)] BELT IS CORRECT (22600 BELT AFTER AUG. 1976). EARLY MODELS HAD 1/2" WIDE BELT.
- CHECK BELT ALIGNMENT. IT MAY BE NECESSARY TO ELONGATE OR SHIM THE MOUNTING HOLES. VERIFY FAN CLEARANCE. EARLY MODELS (1968 ERA) WILL REQUIRE A TWO (2) GROOVE CLUTCH, A 1/2" BELT, AND IT WILL BE NECESSARY TO SPACE THE COMPRESSOR FOWARD. THE FAN AND FAN COVER MAY NEED TO BE TRIMMED.



ALTERNATOR MOUNTING TABS.

No.	QTY.	PART No.	DESCRIPTION
1.	1	15460-LTB	BRACKET W/ SPACERS - (A) THREE 1.920"/(B) TWO .40"/(C) ONE .25"
2.	4	18030-VUB	3/8" LOCK WASHER
3.	1	18151-VUB	5/16" LOCKNUT
4.	6	18155-VUB	3/8" LOCKNUT
5.	1	18308-VUB	5//16" x 1" BOLT
6.	1	18359-VUB	3/8" x 1" BOLT
7.	3	18360-VUB	3/8" x 1-1/4" BOLT
8.	1	18361-VUB	3/8" x 1-1/2" BOLT
9.	2	18362-VUB	3/8" x 1-3/4" BOLT
10	3	18531-VUB	10mm 1.25 PITCH x 75mm BOLT
* 11.	1	18532-VUB	12mm 1.25 PITCH x 30mm BOLT
12.	1	18533-VUB	12mm LOCKWASHER

* INFREQUENTLY A 10mm BOLT (CUSTOMER SUPPLIED)