



1958-62 Corvette

**Compressor Bracket
Passenger Side
15472-VCB**

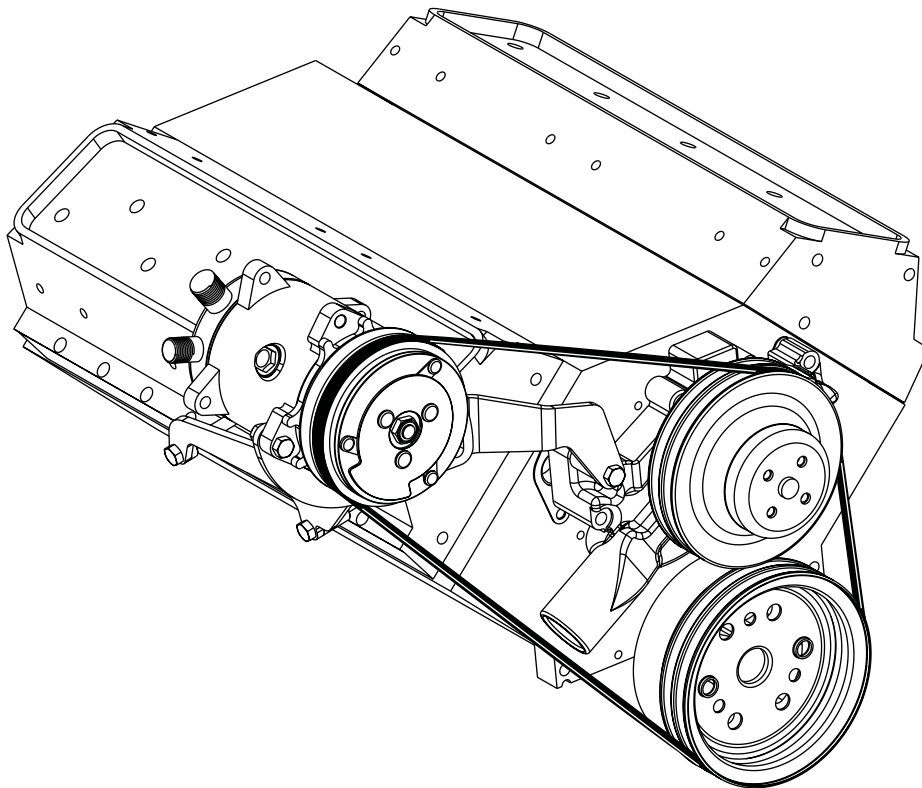



Table of Contents

- 1. Cover**
- 2. Table of Contents**
- 3. Packing List/Parts Disclaimer**
- 4. Dimensional References & OEM Bolt Removal**
Figure 1
- 5. Rear Mounting Bracket Installation**
- 6. Front Mounting Bracket Installation**
Figure 2
- 7. Compressor Mounting Bracket Installation**
Figures 3 & 4
- 8. Compressor Mounting Bracket Installation (Cont.) & Belt Routing**
Figures 5 & 6
- 9. Compressor Warnings**
Figure 7
- 10. Packing List**



Packing List: 1958-62 Corvette Compressor Bracket Passenger Side (15472-VCB)

No.	Qty.	Part No.	Description
1.	1	146014	1958-62 Corvette Passenger Side Front Mounting Bracket
2.	1	146009	1958-62 Corvette Compressor Mounting Bracket
3.	1	146019	1958-62 Corvette Pass. Side Compressor Rear Mounting Bracket Assembly
4.	1	191023	Hardware Kit

**** Before beginning installation, open all packages and check contents of shipment. Please report any shortages directly to Vintage Air within 15 days. After 15 days, Vintage Air will not be responsible for missing or damaged items.**

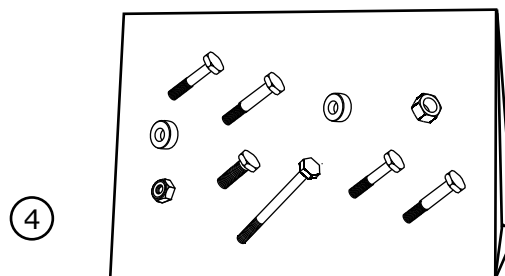
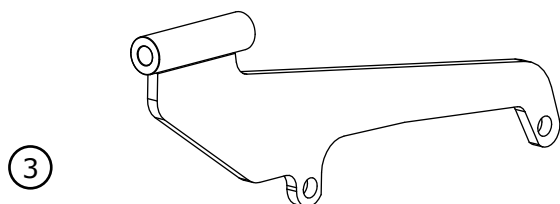
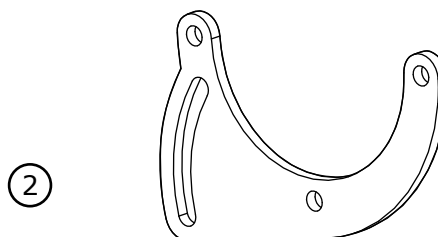
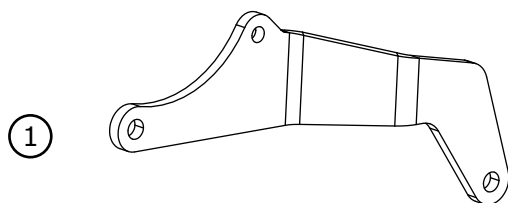

Dimensional References

NOTE: Before installing bracket assembly onto engine, refer to dimensional references provided. Brackets must be installed to the specified measurements, or the compressor bracket kit will not fit correctly.

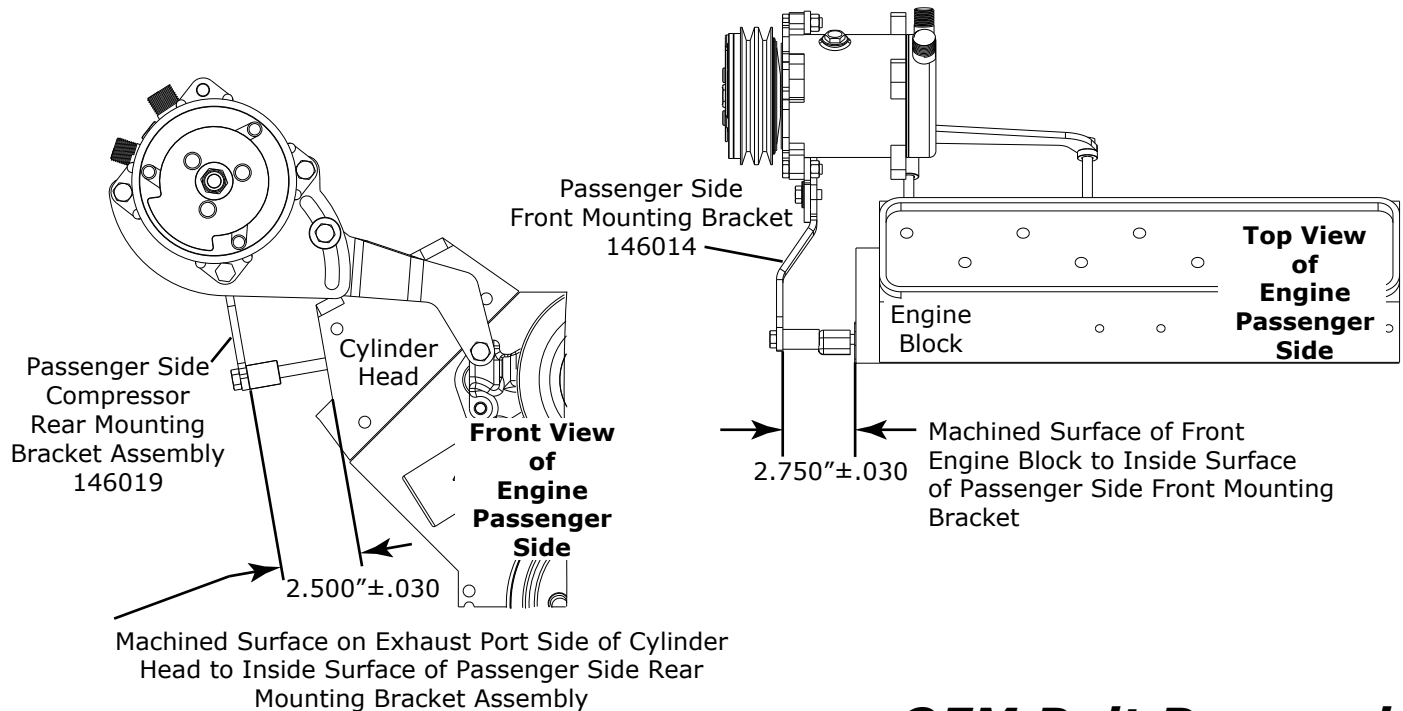

OEM Bolt Removal

1. Remove the passenger side top water pump mounting bolt (discard) as shown in Figure 1, below.
2. Remove the 1st and 3rd passenger side manifold bolts (discard) as shown in Figure 1, below.

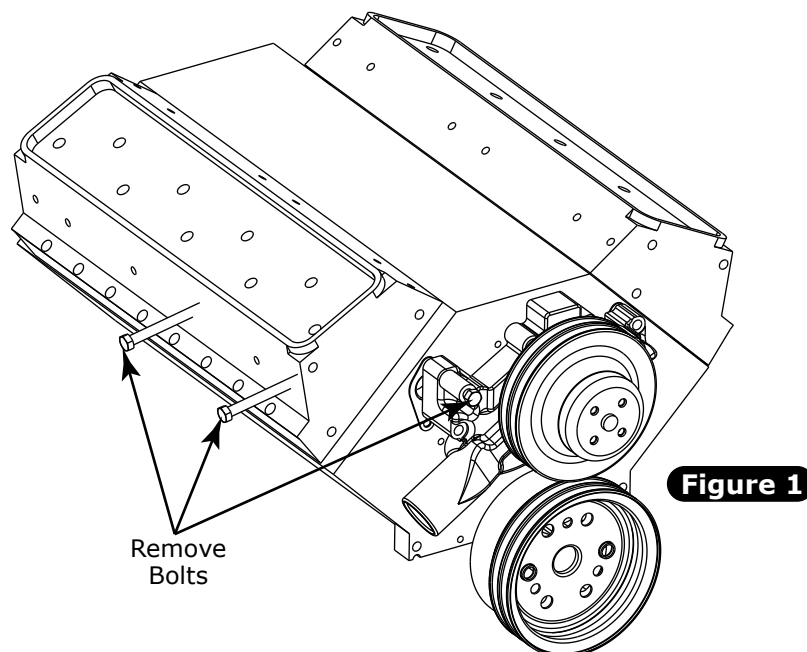

Figure 1



NOTE: Before tightening bolts, assemble all brackets loosely to engine. This will ensure proper alignment of all brackets.

Rear Mounting Bracket Installation

1. Install passenger side compressor rear mounting bracket assembly onto cylinder head using (2) 3/8-16 x 3 1/4" hex bolts, 1" steel spacer, and 1/4" steel spacer as shown in Figure 2, below.

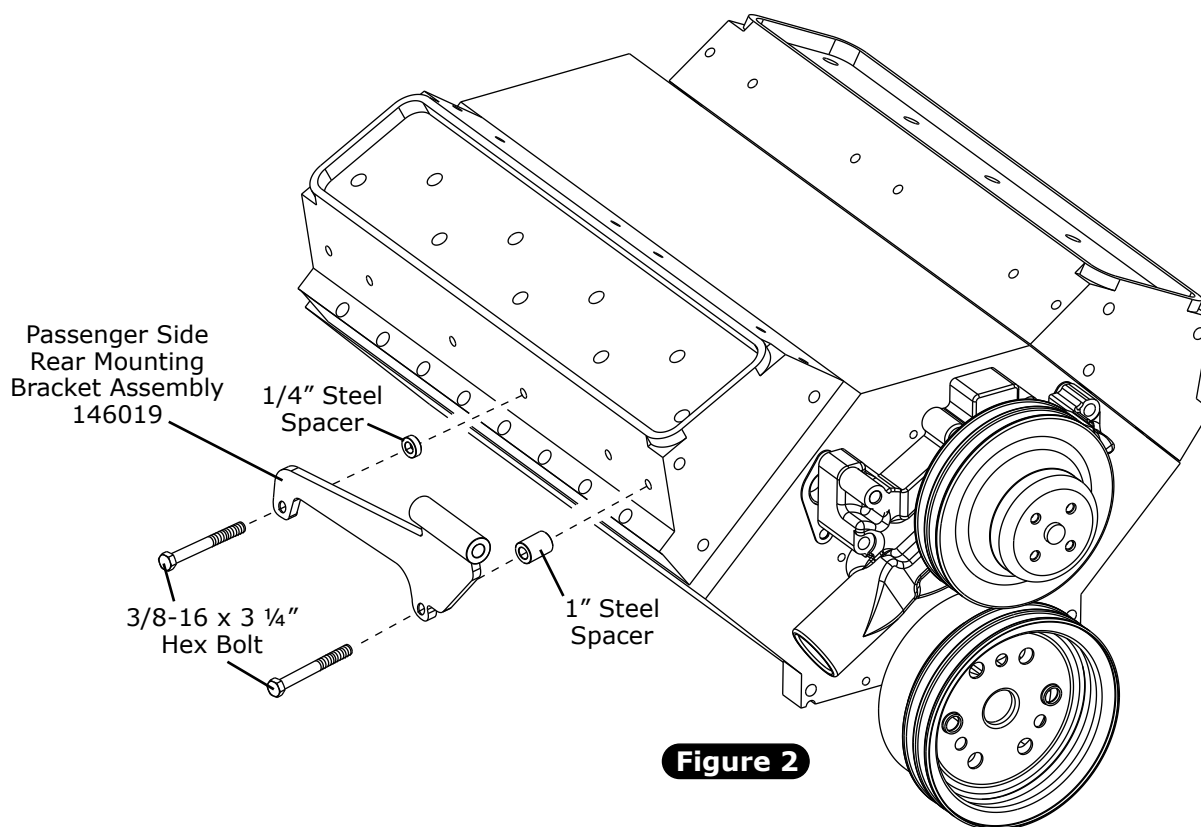
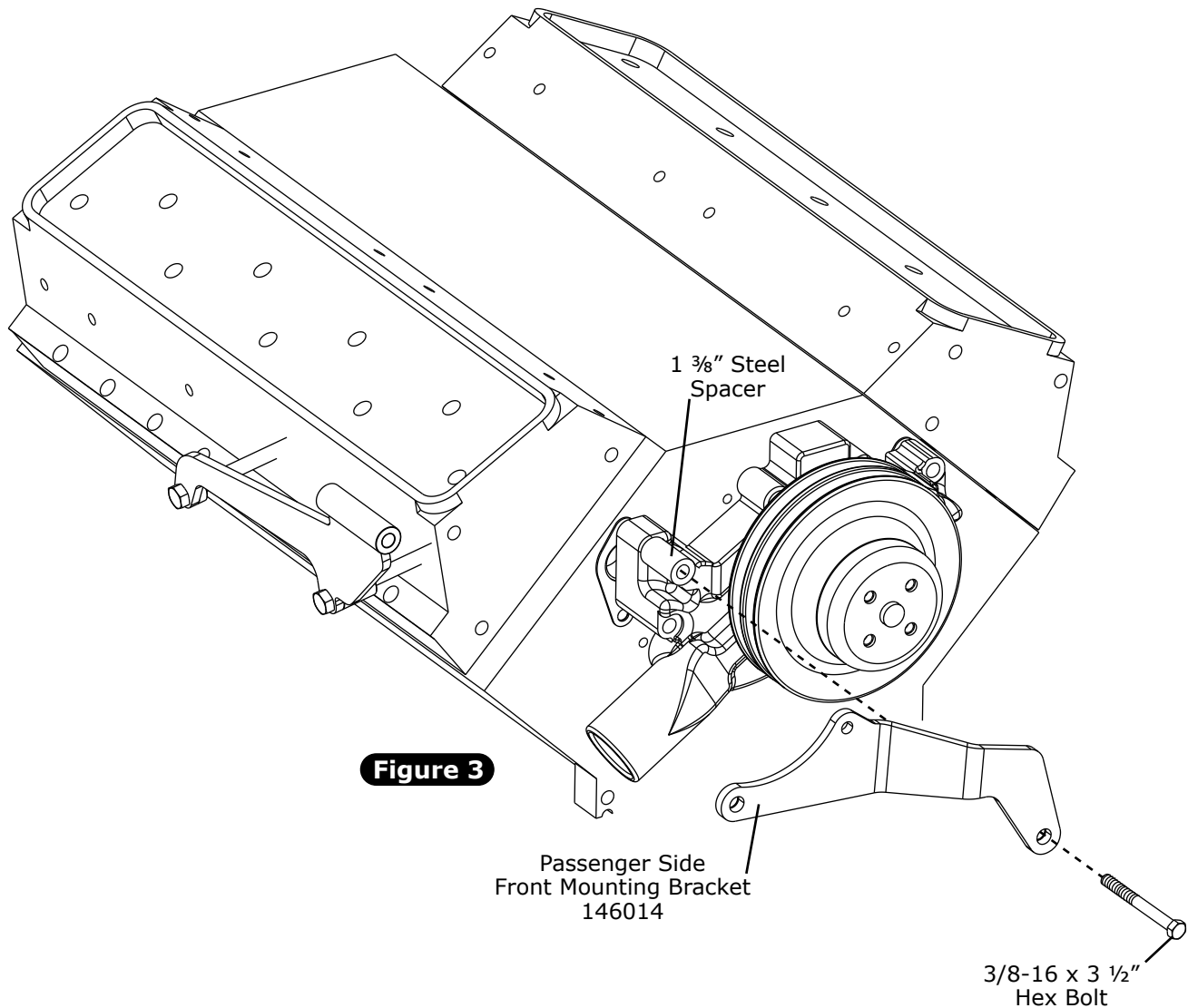

Figure 2



Front Mounting Bracket Installation

1. Install front mounting bracket onto water pump ear as shown in Figure 3, below.



Compressor Mounting Bracket Installation

1. Install compressor mounting bracket onto compressor using (2) 3/8-16 x 1 1/4" hex bolts and (2) 3/8" locknuts as shown in Figure 4, below.
2. Install compressor assembly onto passenger side front mounting bracket and passenger side compressor rear mounting bracket assembly using a 3/8-16 x 5" hex bolt and a 3/8" locknut as shown in Figure 5, below.

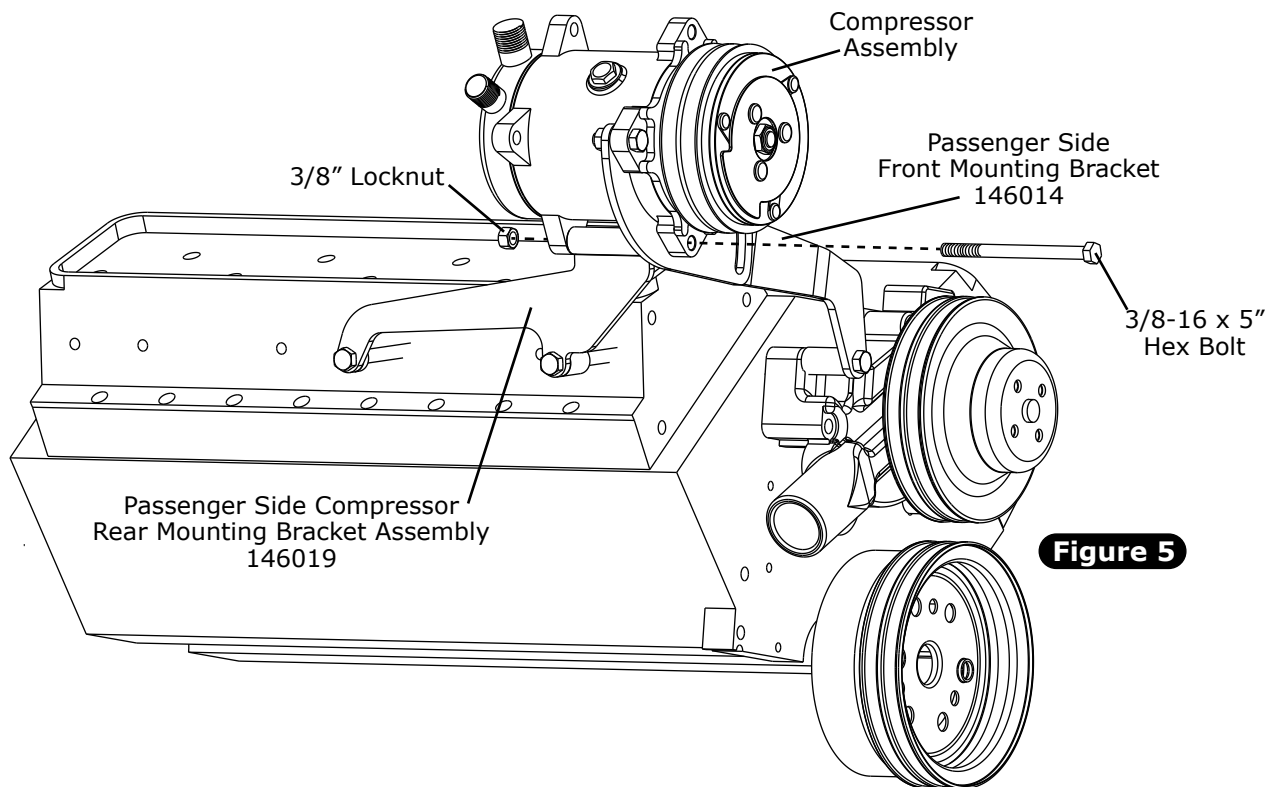
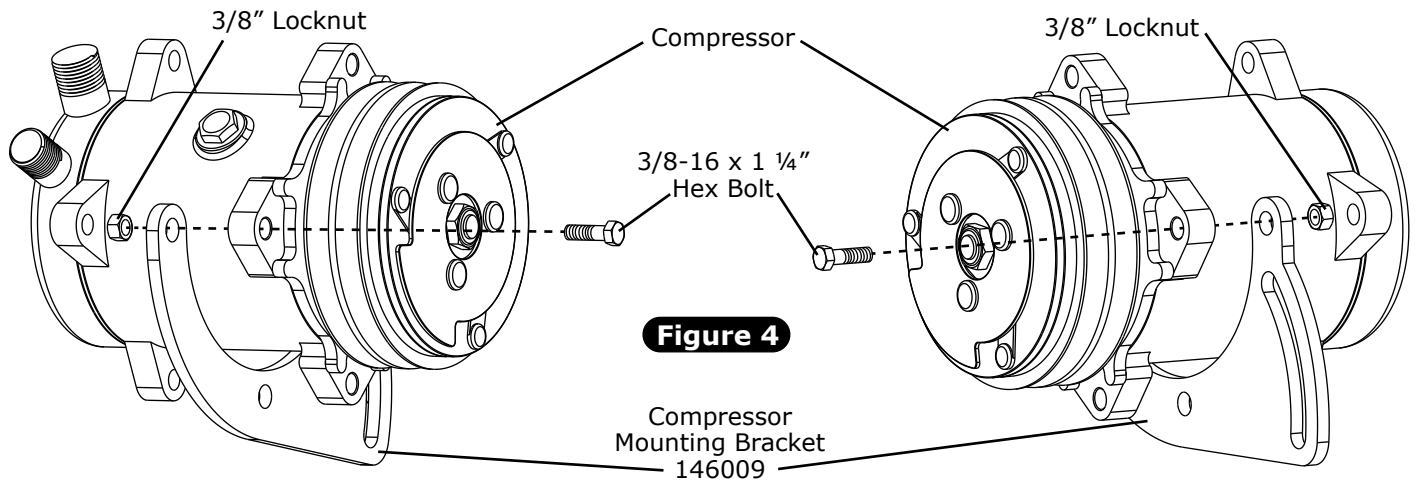

Compressor Mounting Bracket Installation (Cont.)

1. Install 3/8" x 3/4" hex bolt and 3/8" flat washer through slot on compressor mounting bracket into threaded hole on passenger side front mounting bracket as shown in Figure 6, below.

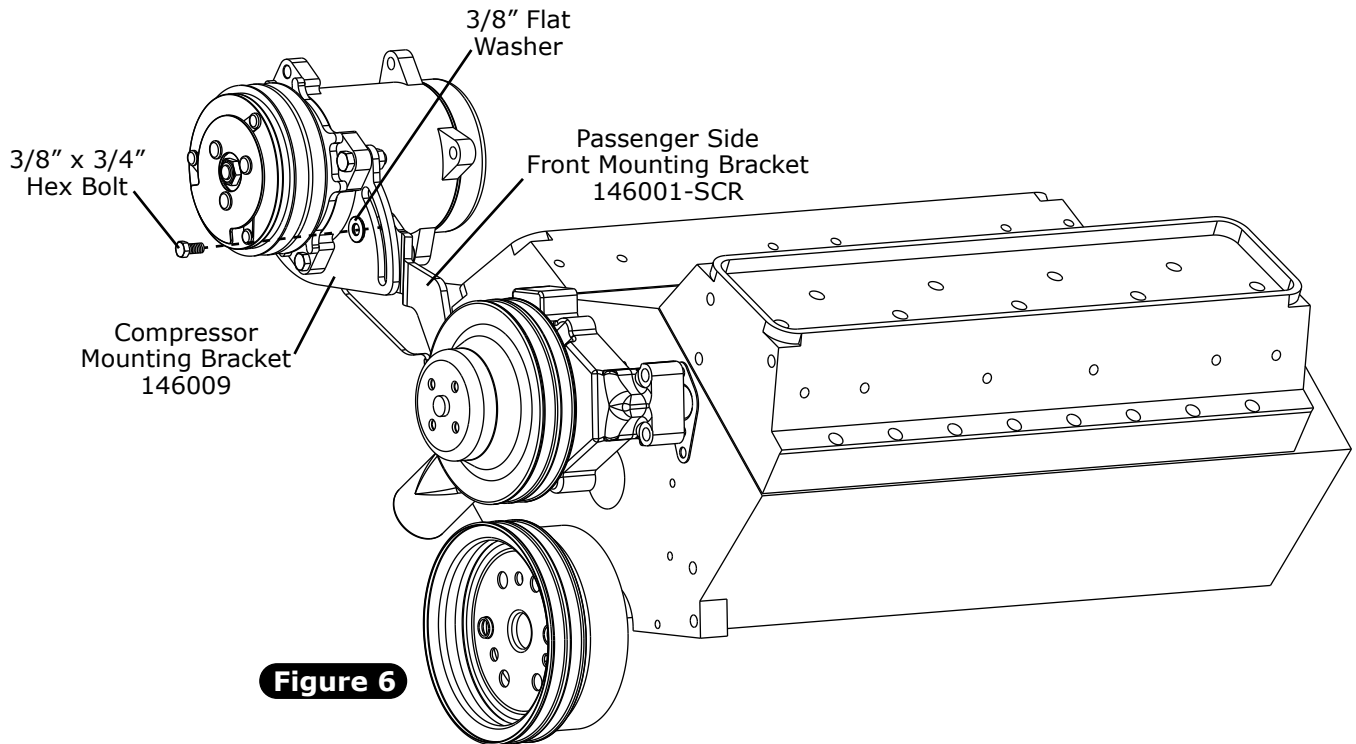

Figure 6

Belt Routing

1. Route belts as shown in Figure 7, below. Vintage Air recommends using only Dayco, Gates or Goodyear brand reinforced V-belts with this compressor. Any use of lesser-quality belts may cause compressor to perform improperly. A belt length of 57" is recommended. **NOTE: This can vary with diameter of your water pump and crankshaft pulleys.**

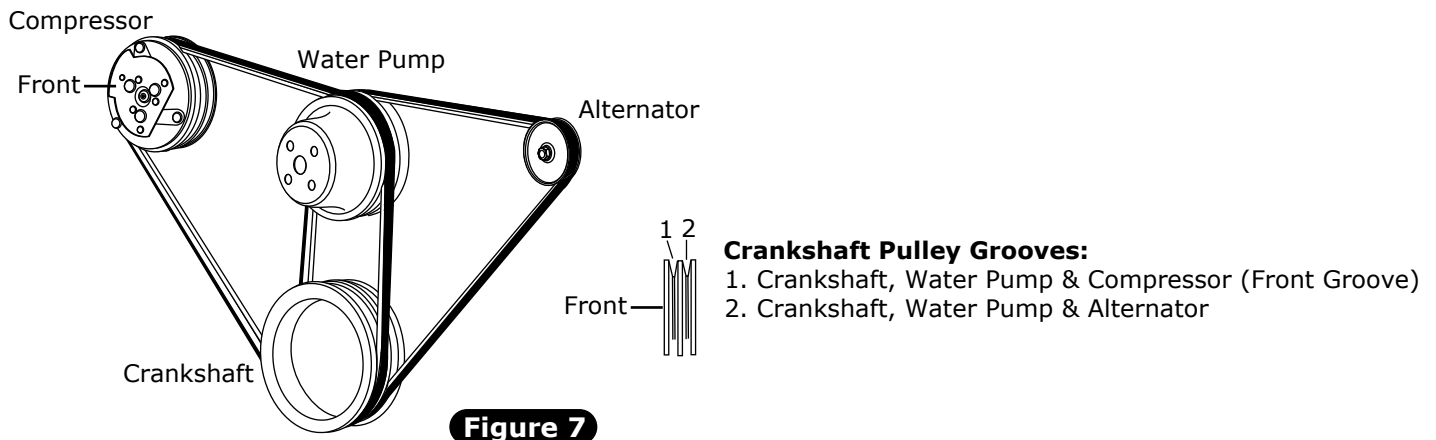

Figure 7

Compressor Warnings

NOTE: Failure to follow these procedures will void all warranties.

1. With compressor kit installed and belt tightened, check angle of oil plug on compressor. Oil plug must not exceed 90° beyond vertical centerline as shown in Figure 8, below.
2. Do not connect compressor clutch wire until system is being charged with refrigerant. Running compressor without refrigerant charge will result in compressor failure.

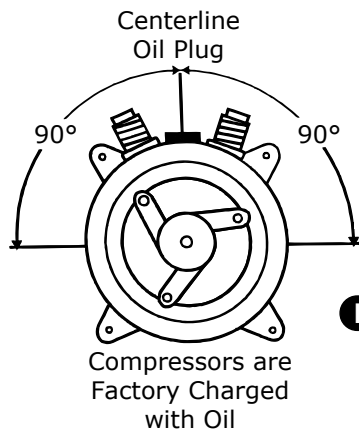

Figure 8

IMPORTANT NOTICE:

**Do not connect compressor clutch wire until system is being charged with refrigerant.
Running compressor without refrigerant will destroy compressor and void warranty.**



Packing List: 1958-62 Corvette Compressor Bracket Passenger Side (15472-VCB)

No.	Qty.	Part No.	Description	
1.	1	146014	1958-62 Corvette Passenger Side Front Mounting Bracket	_____
2.	1	146009	1958-62 Corvette Compressor Mounting Bracket	_____
3.	1	146019	1958-62 Corvette Pass. Side Compressor Rear Mounting Bracket Assembly	_____
4.	1	191023	Hardware Kit	_____

Checked By: _____
Packed By: _____
Date: _____

①

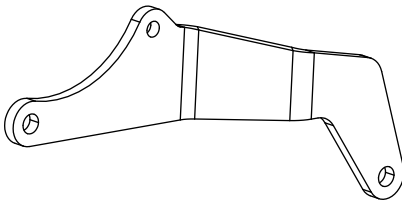

②

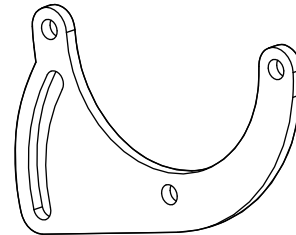

③

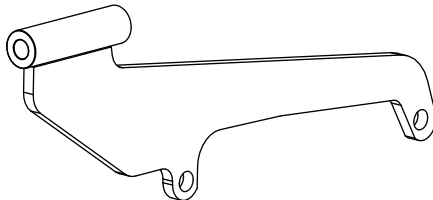

④

