

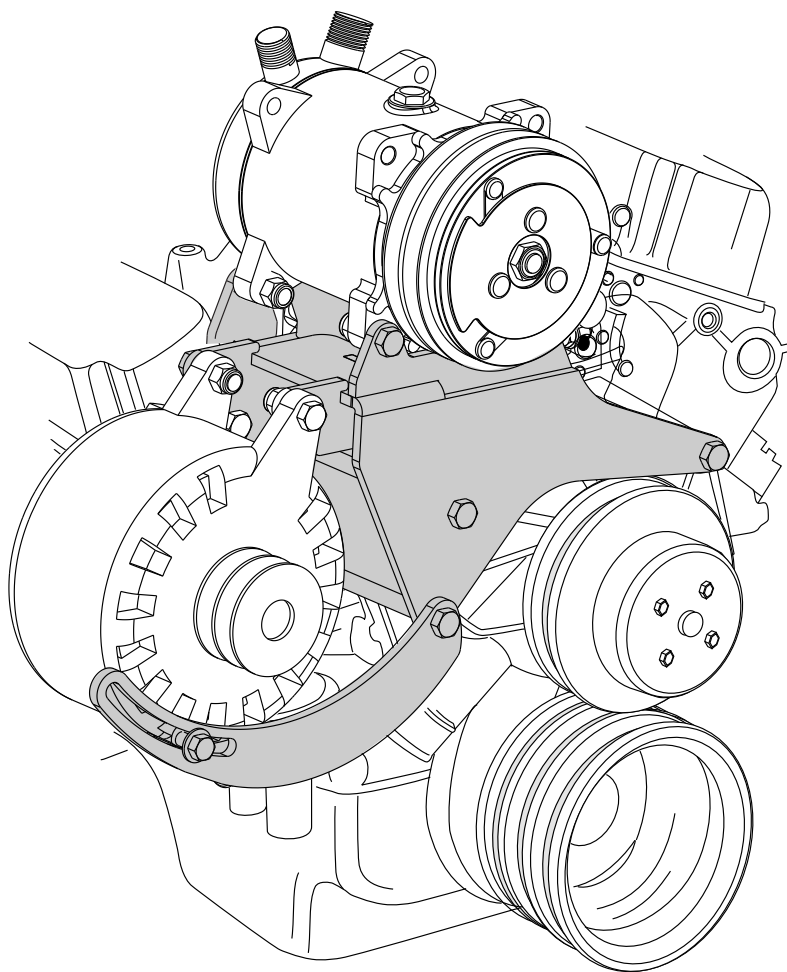

1970-78 Mopar 318/340/360

Compressor/Alternator Bracket Kit
with Power Steering, without Air Pump
(162774-SDA)



18865 Goll St. San Antonio, TX 78266
Phone: 800-862-6658
Sales: sales@vintageair.com
Tech Support: tech@vintageair.com
www.vintageair.com



www.vintageair.com

Table of Contents

Cover.....	1
Table of Contents.....	2
Packing List/Parts Disclaimer.....	3
Engine Disassembly.....	4
Heater Fitting Replacement.....	5
Compressor Bracket Installation.....	6
Compressor/Alternator Installation.....	7
Belt Routing, Compressor Warning.....	8
Packing List.....	9



www.vintageair.com

Packing List: Compressor/Alternator Bracket Kit (162774-SDA)

No.	Qty.	Part No.	Description
1.	1	166018	Bracket, Compressor/Alternator
2.	1	166474-SDR	Bracket, Alternator Adjuster
3.	1	191474-HMA	Hardware Kit

**** Before beginning installation, open all packages and check contents of shipment. Please report any shortages directly to Vintage Air within 15 days. After 15 days, Vintage Air will not be responsible for missing or damaged items.**

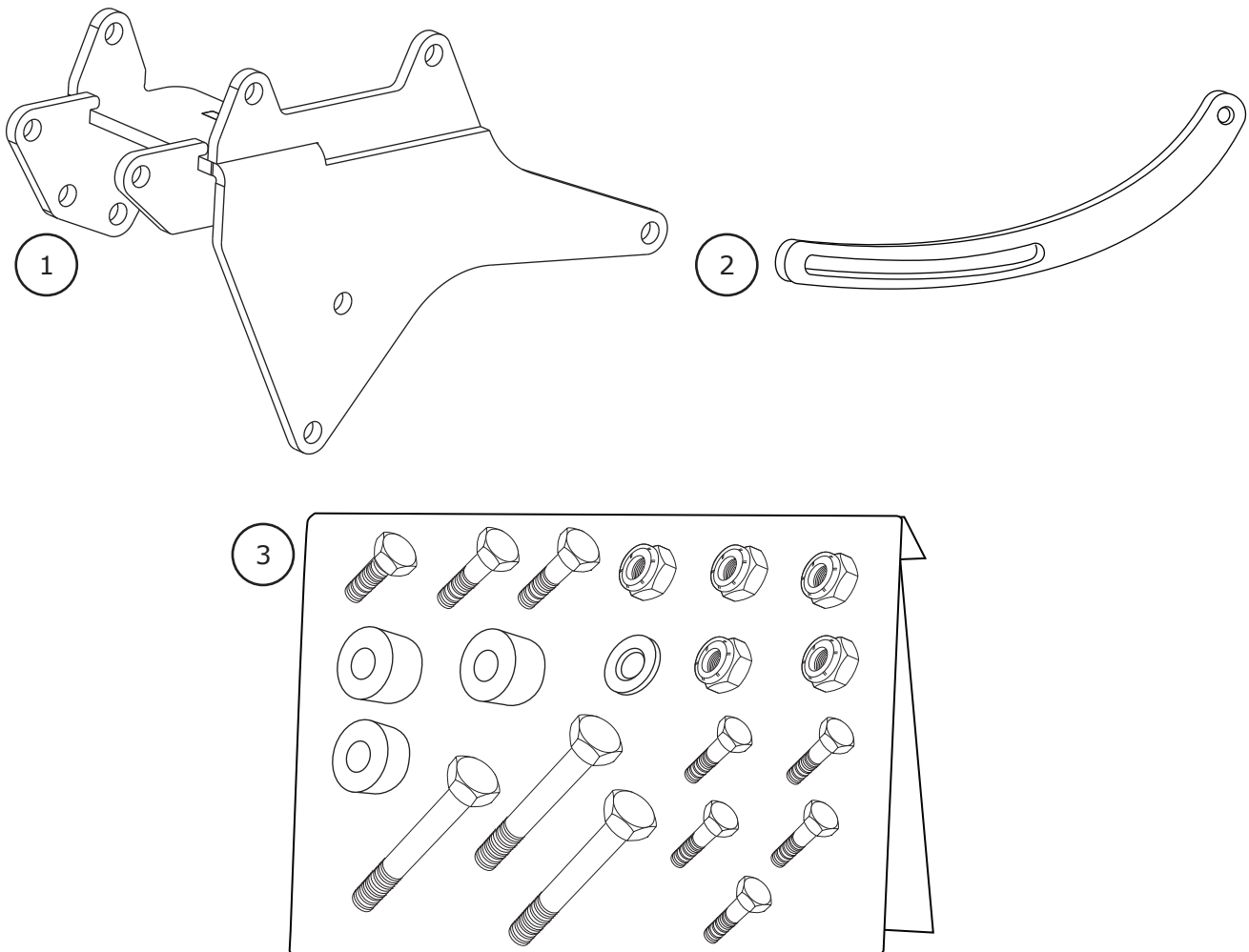

**NOTE: Images may not depict actual parts and quantities.
Refer to packing list for actual parts and quantities.**

Engine Disassembly

1. Disconnect battery
2. Drain coolant.
3. Remove belts.
4. Remove stock compressor and alternator.
5. Remove (3) water pump bolts as shown in Figure 1, below.

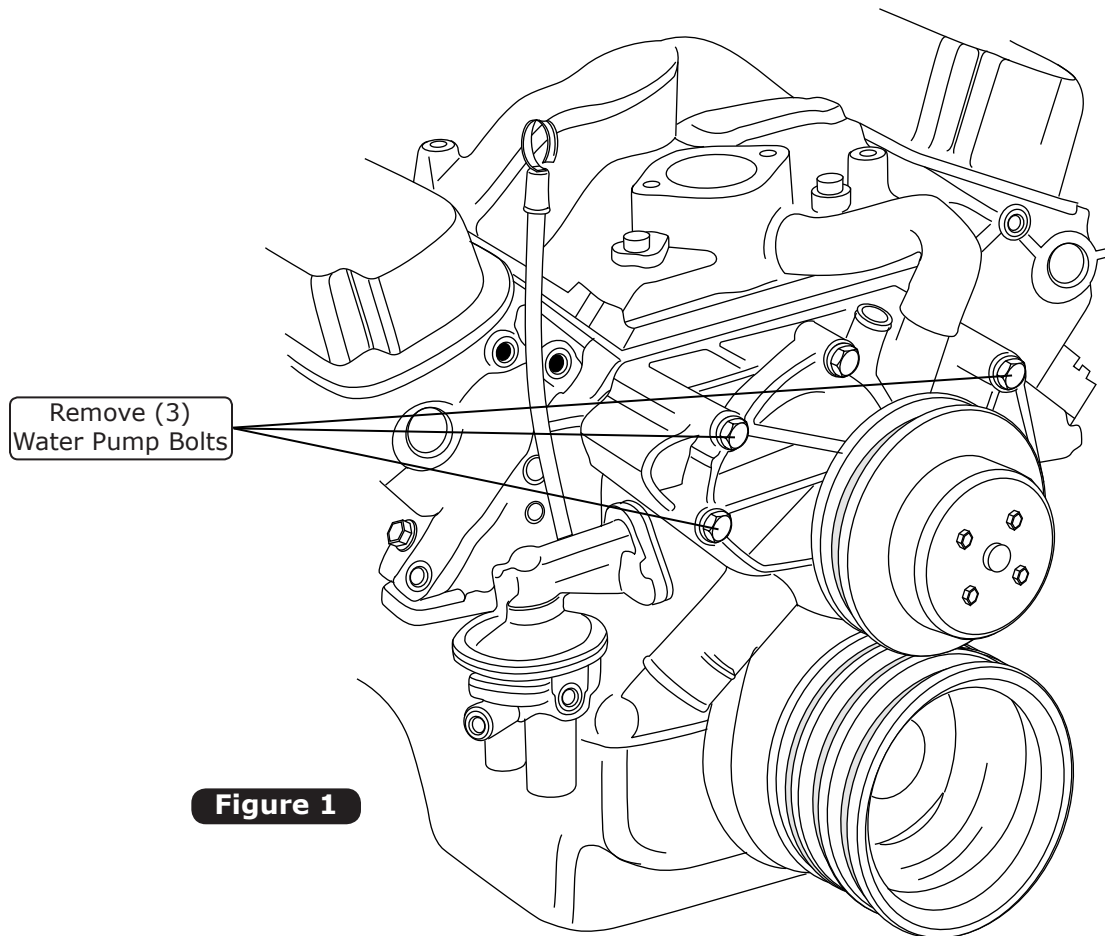

Figure 1

NOTE: Before tightening bolts, assemble all brackets loosely to engine. This will ensure proper alignment of all brackets.

www.vintageair.com

Heater Fitting Replacement

1. On both 4-barrel and 2-barrel OEM intake manifolds, it will be necessary to remove the factory heater hose fitting, and replace it with a larger 5/8" barb fitting. **NOTE: Some 4-barrel intakes have two heater hose fitting locations. In this case, use the rear-most hole closest to the center of the engine, and install a plug into the remaining hole.**
2. On 2-barrel intake manifolds, we recommend a 45° 3/8" NPT to 5/8" barb fitting, either Vintage Air part number 501015, or a similar fitting from your local parts store. Clock the fitting as shown in Photo 2, below, to allow adequate clearance. **NOTE: Be sure to use thread sealant when installing the fitting.**

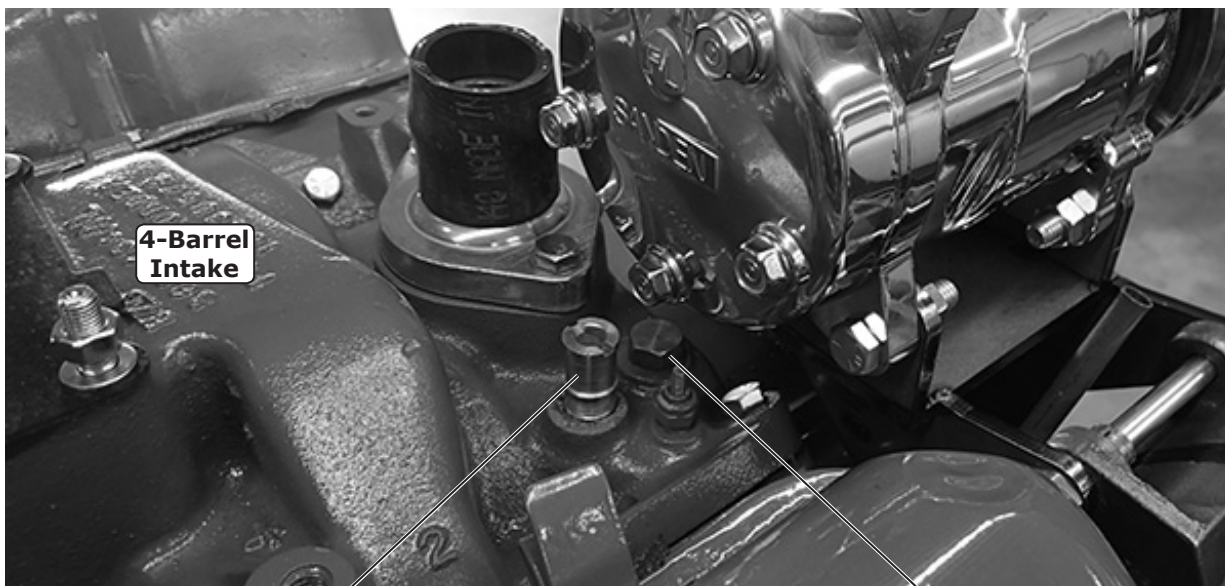

Photo 1

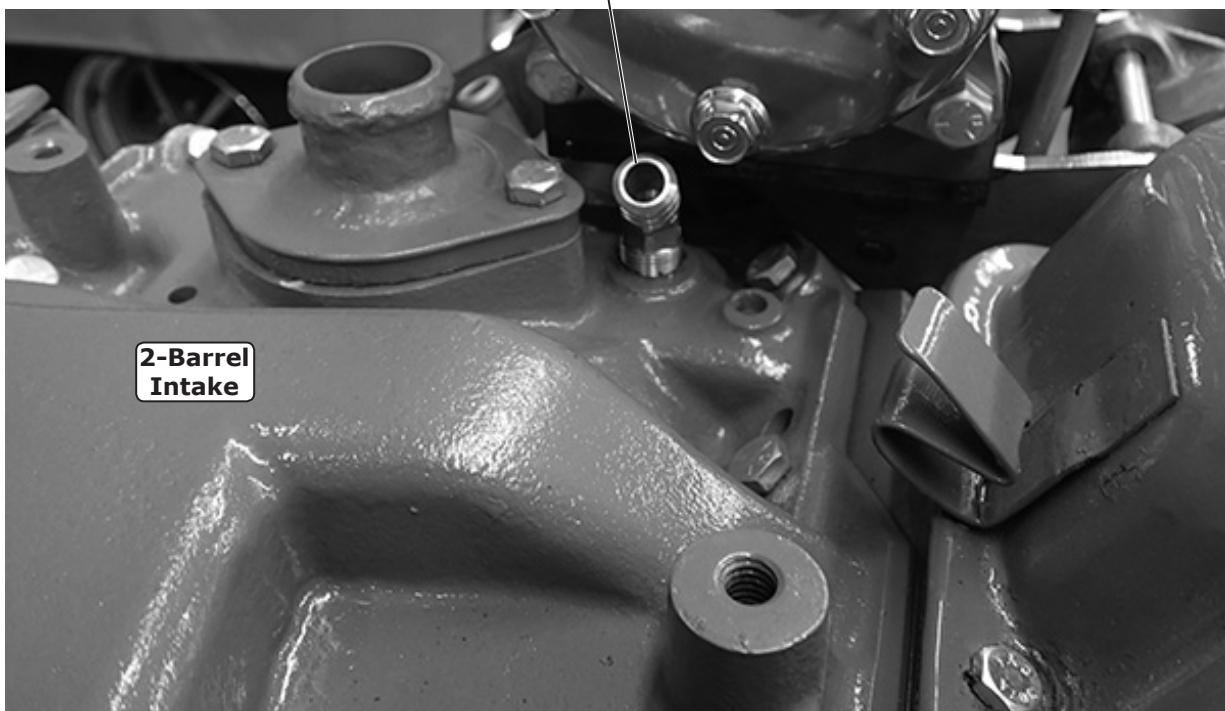
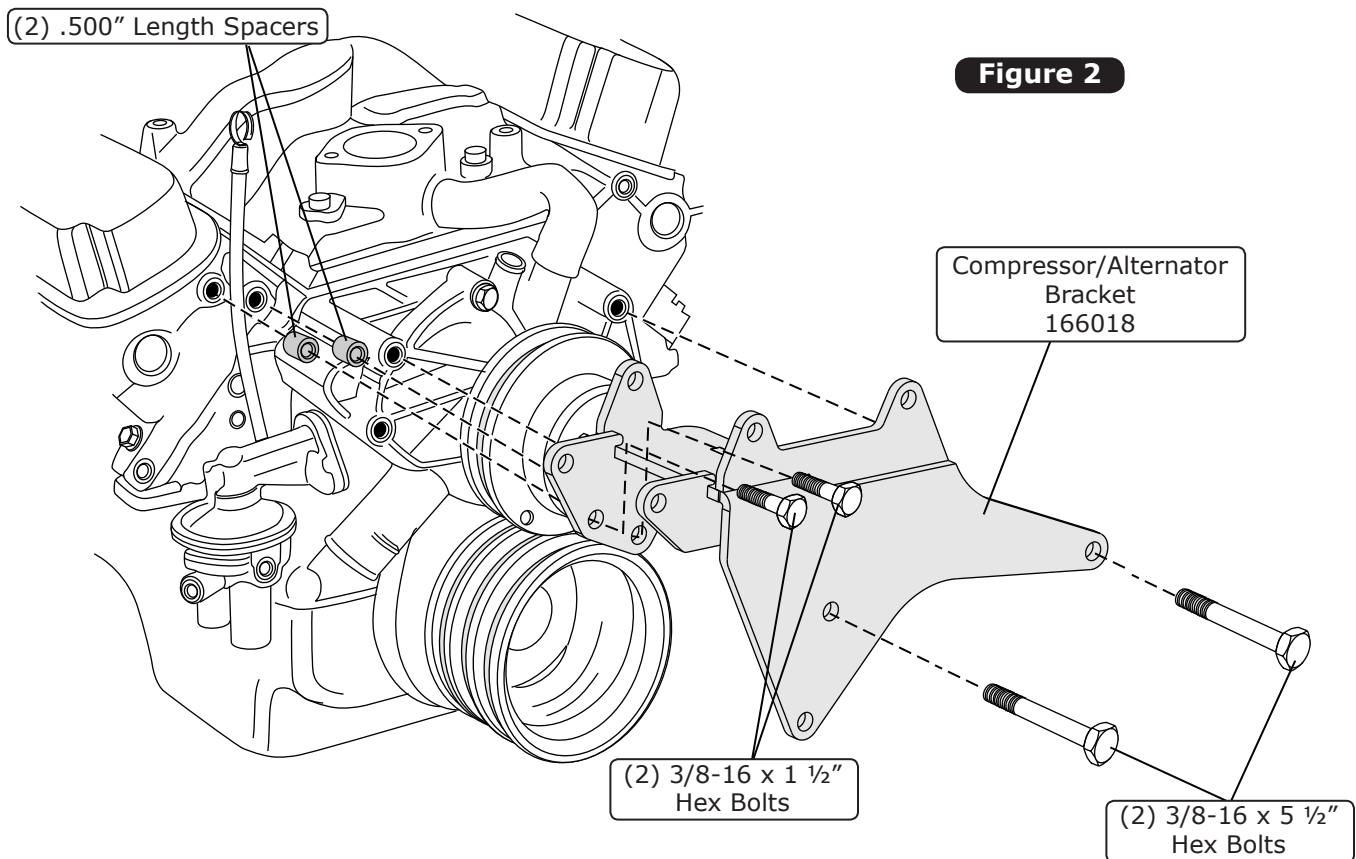

Photo 2

Compressor Bracket Installation

1. Install the compressor/alternator bracket using (2) .500" length spacers, (2) 3/8-16 x 1 1/2" hex bolts and (2) 3/8-16 x 5 1/2" hex bolts (See Figure 2, below).



Compressor/Alternator Installation

1. Install the compressor onto the compressor/alternator bracket using (3) 3/8-16 x 1 1/4" hex bolts and (3) 3/8-16 locknuts (See Figure 3, below).
2. Install the alternator onto the compressor/alternator bracket using (2) 3/8-16 x 1 1/4" hex bolts and (2) 3/8-16 locknuts (See Figure 3, below).
3. Install the alternator adjuster bracket onto the compressor/alternator bracket using a 3/8-16 x 5 1/2" hex bolt (See Figure 3, below).
4. Insert a .250" length spacer between the alternator and the alternator adjuster bracket. Secure the bracket to the alternator using a 5/16-18 x 1" hex bolt and a 5/16" flat washer (See Figure 3, below). **NOTE: Do not fully tighten the bracket hardware at this time. The bracket hardware will be fully tightened when the belts are installed.**

If pulleys are needed, the following are available from Vintage Air:

735006 — Single-groove water pump pulley

735007 — 2-groove crankshaft pulley

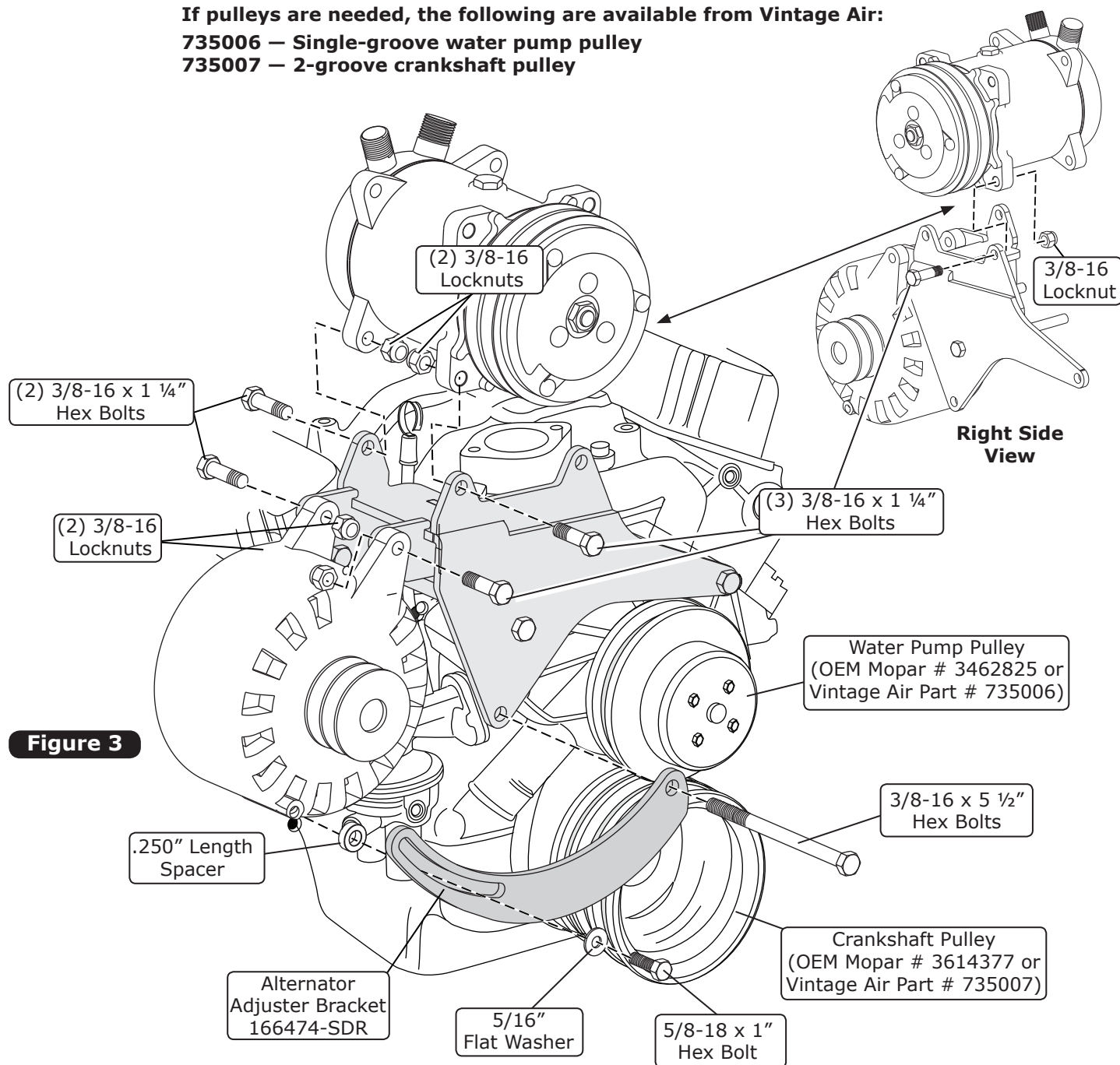
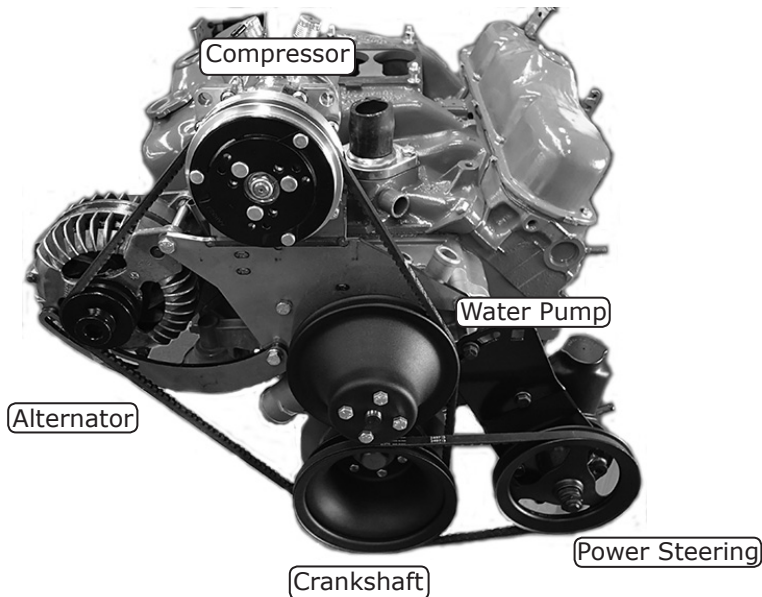

Figure 3

Belt Routing

1. Route belts as shown below, and tighten the alternator and alternator adjuster bracket. Vintage Air recommends using only Dayco, Gates or Goodyear brand reinforced V-belts with this compressor bracket kit. Compressor belt length of 55" inches is recommended. Power steering belt length of 37" is recommended.



Compressor Warnings

NOTE: Failure to follow these procedures will void all warranties.

1. With compressor kit installed, and belt tightened, check angle of oil plug on compressor. As shown below, oil plug must not exceed 90° beyond vertical centerline.
2. Do not connect compressor clutch wire until system is being charged with refrigerant. Running compressor without refrigerant charge may result in compressor failure.

IMPORTANT NOTICE:

- Do not connect compressor clutch wire until system is being charged with refrigerant. Since an A/C system relies on refrigerant to circulate lubricant, running the compressor without refrigerant may destroy the compressor and void the warranty.
- Proper compressor orientation is important. Sanden compressors may be rotated from vertical (oil fill plug at top) up to 90° in either direction (See illustration).

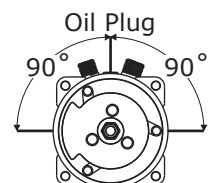



www.vintageair.com

Packing List: Compressor/Alternator Bracket Kit (162774-SDA)

No.	Qty.	Part No.	Description
1.	1	166018	Bracket, Compressor/Alternator
2.	1	166474-SDR	Bracket, Alternator Adjuster
3.	1	191474-HMA	Hardware Kit

Checked By: _____
Packed By: _____
Date: _____

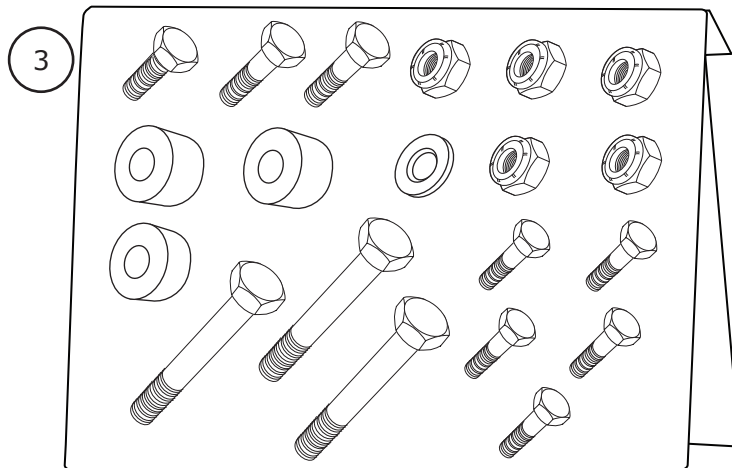
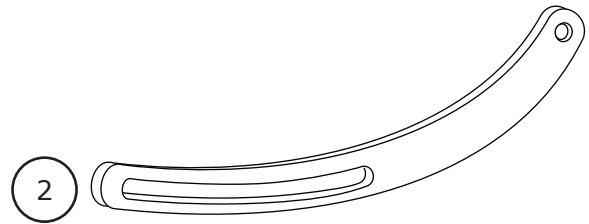
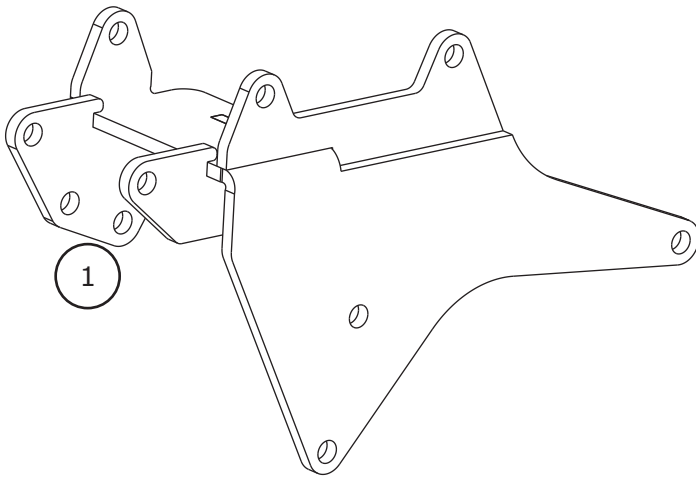

**NOTE: Images may not depict actual parts and quantities.
Refer to packing list for actual parts and quantities.**