

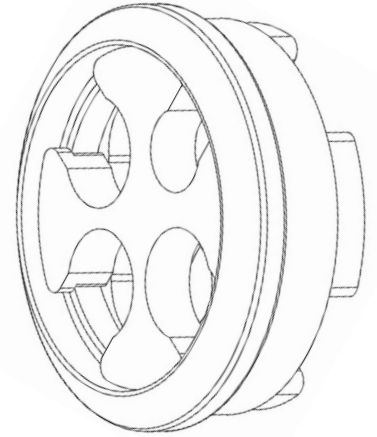

[www.iimuch.com](http://www.iimuch.com)

888-216-6033



## **INSTALLATION INSTRUCTION**

### **IIMUCH®, AIRPORT® A/C BULKHEAD P/N 200011**

#### **Warning**

1. The II MUCH Airport is designed to work with the Vintage Air® EZ-Clip hose system, as such all applicable precautions recommend by Vintage Air with respect to the EZ-Clip hose install should be followed.
2. II MUCH hose adapters are designed only for engine coolant applications.
3. Hose adapter ⑨ must be installed on engine side of firewall as a leak could cause injury or death.

#### **Tools**

The following lists the minimum tools required. Depending on your vehicle and mounting location, more tools and materials may be needed.

2.5-inch hole saw. We recommend "Holcutters" by Blair Equipment Company, PN 4674

7/16-inch socket

#### **Background**

The II MUCH Airport A/C bulkhead was developed to reduce the amount of space and time required to route heater and AC hoses through a firewall. Its compact design takes advantage of the smaller diameter of the EZ-Clip hoses required when using this product which are available from

[www.vintageair.com](http://www.vintageair.com)

#### **Installation (See illustrated parts breakdown on page 2)**

1. Install Evaporator under dash per manufacturer's instructions
2. Determine location for the bulkhead that will allow the hoses to be routed without exceeding the minimum bend radius of the EZ-Clip hoses.
3. Drill a 2.5" hole at the desired location and remove any burrs or sharp edges.
4. Assemble the Bezel ② facing into the engine compartment.
5. Install the spacer ⑤ passenger side of the firewall
6. Route Hoses through bezel ②. The inner hose support ④ can be removed to facilitate assembly.  
NOTE: Hoses must still run through the inner hose support ④ for final assembly
7. Snap hoses into the front cinch plate ① and insert hose and cinch plate into the bezel ②
8. Snap hoses into rear cinch plate ⑥ as close to Airport as possible and slide over the threaded stud ⑦ and install the lock nut ⑧.

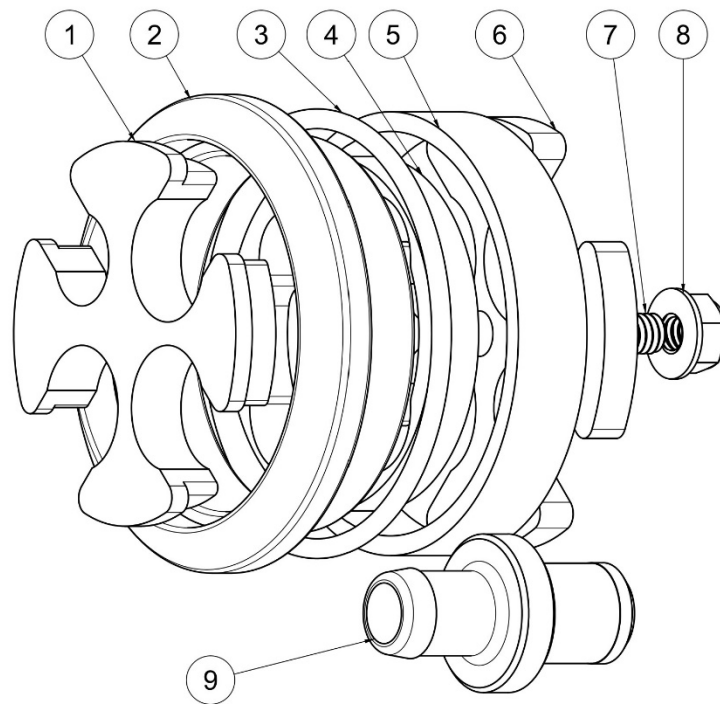

PARTS LIST				
ITEM	QTY	PART NUMBER	DESCRIPTION	MATERIAL
1	1	CINCH PLATE, FRONT	BLACK ANNODIZED	ALUMINUM 6061
2	1	BEZEL		ALUMINUM 6061
3	1	O-RING		RUBBER
4	1	HOSE SUPPORT		PC/ABS PLASTIC
5	1	SPACER		PC/ABS PLASTIC
6	1	REAR PLATE, 6061 AL	BLACK ANNODIZED	STEEL
7	1	STUD	1/4-20 INCH	STAINLESS STEEL
8	1	NUT	SELF LOCKING	STAINLESS STEEL
9	1	EZ CLIP TO WATER PUMP 5/8		ALUMINUM 6061

### Warranty

This product is warranted against defects in material and workmanship for one year from the date of purchase. If, within one year, you find this product to be defective, return the product to us and we will, at our discretion, either repair or replace it at no cost to you. This warranty is your sole remedy in the event that the product fails in any way. We hereby also disclaim all liability for incidental or consequential damages arising from the use of this product. Misuse, abuse, or any failure to follow the instructions provided with the product, will result in the voiding of this warranty