

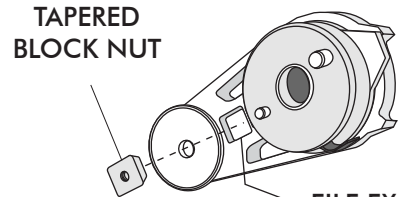

## TENSIONER COVER INSTALLATION

- REMOVE DRIVE BELT
- REMOVE TENSIONER ASSEMBLY FROM FRONT RUNNER DRIVE SYSTEM, THEN REMOVE TENSIONER ROLLER FROM TENSIONER ASSEMBLY
- INSTALL TAPERED BLOCK NUT INTO THE BACK SIDE OF TENSIONER. (LIGHTLY TAP INTO PLACE.  
**NOTE: IT MAY BE NECESSARY TO USE A FILE AND REMOVE EXCESS METAL FLASHING AROUND SQUARE OPENING FOR THE TAPERED BLOCK NUT TO FIT PROPERLY.**
- RE-INSTALL TENSIONER ROLLER TO TENSIONER, AND THEN RE-INSTALL TENSIONER ASSEMBLY TO THE FRONT RUNNER DRIVE ASSEMBLY.
- RE-INSTALL DRIVE BELT
- INSTALL TENSIONER COVER WITH 10-32 X 3/4 SOCKET SCREW.  
**NOTE: APPLY REMOVABLE LOC-TITE TO SCREW PRIOR TO INSTALLATION.**

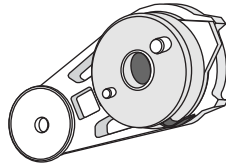
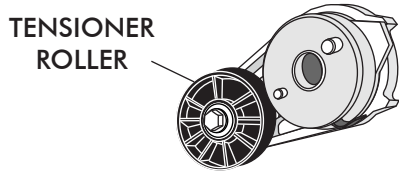

FILE EXCESS FLASHING IF NECESSARY

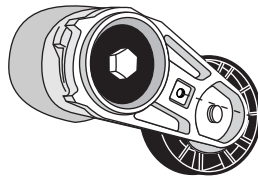
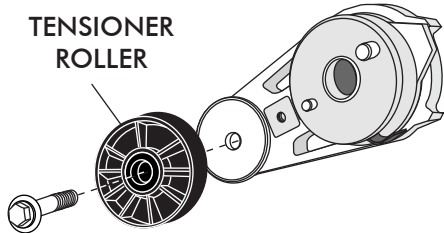

10-32 X 3/4 SOCKET SCREW

TENSIONER COVER

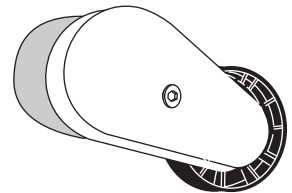
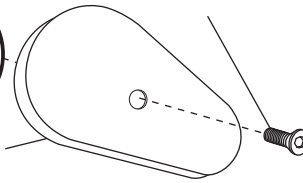

## TENSIONER COVER PACKING LIST

TENSIONER COVER  
CHROME  
398002

| No. | QTY. | PART No.  | DESCRIPTION                         |
|-----|------|-----------|-------------------------------------|
| 1.  | 1    | 398001    | TENSIONER COVER w/ PRESS NUT CHROME |
| 2.  | 1    | 18174-VUB | 10-32 x 3/4 SOCKET SCREW            |

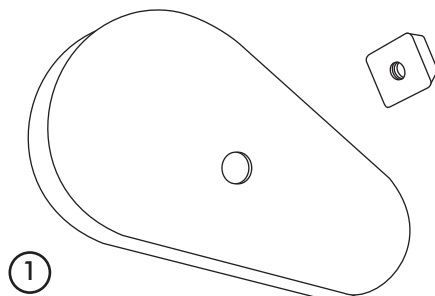

②

CHECKED BY: \_\_\_\_\_  
 PACKED BY: \_\_\_\_\_  
 DATE: \_\_\_\_\_