

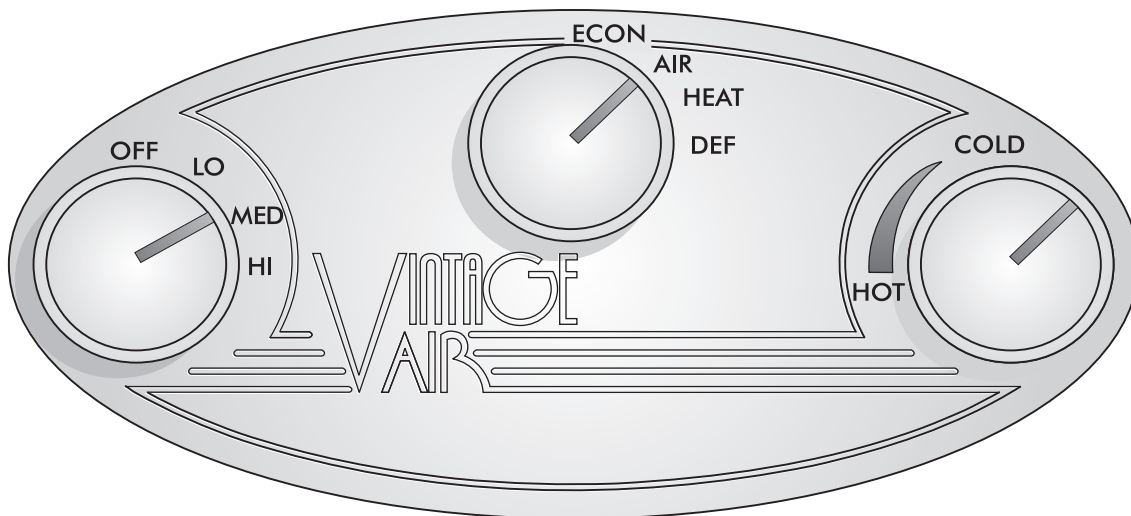

Streamline Control Panel

(49500-VSQ)



18865 Goll St. San Antonio, TX 78266
Phone: 800-862-6658
Sales: sales@vintageair.com
Tech Support: tech@vintageair.com
www.vintageair.com



www.vintageair.com

Table of Contents

Cover.....	1
Table of Contents.....	2
Packing List/Parts Disclaimer.....	3
Streamline Control Panel Template.....	4
Control Panel Installation.....	5
Streamline Control Panel Wiring Diagram, Streamline Operation of Controls.....	6
Wiring/Vacuum Diagram - Heat & Cool.....	7
Wiring/Vacuum Diagram - Heat & Cool with Defrost.....	8
Important Notice, Air Conditioning Adjustments, Adjusting A/C Thermostat.....	9
Packing List.....	10



www.vintageair.com

Packing List: Streamline Control Panel (49500-VSQ)

No.	Qty.	Part No.	Description
1.	1	11092-VUT	Thermostat, 48" Adjustable Rotary
2.	2	11458-VUS	Switch, 3-Speed Rotary
3.	3	18145-VUB	Locknut, 10-24
4.	6	18157-VUB	Shaft Nut, 7/16"
5.	3	18260-VUB	Nut with Star Washer, 10-24
6.	3	18414-VUB	Screw, 10-24 x 3/4", Set
7.	3	20557-VUP	Light Bulb
8.	1	49095-VUI	Panel, Streamline, Polished
9.	3	492014	Knob Assembly, Polished
10.	3	64123-VUB	Bracket, Streamline Control Panel
11.	3	33138-VUI	Grommet, 1/4"
12.	1	23120-VUW	Terminal, #10, Ring
13.	1	23122-VUW	Terminal, 1/4", Spade
14.	1	648178	Bracket, Streamline Oval Panel Rear Cover
15.	2	23123-VUW	Buddy Clip
16.	2	23139-VUW	Jumper Wire, 6"

**** Before beginning installation, open all packages and check contents of shipment.
Please report any shortages directly to Vintage Air within 15 days. After 15 days,
Vintage Air will not be responsible for missing or damaged items.**

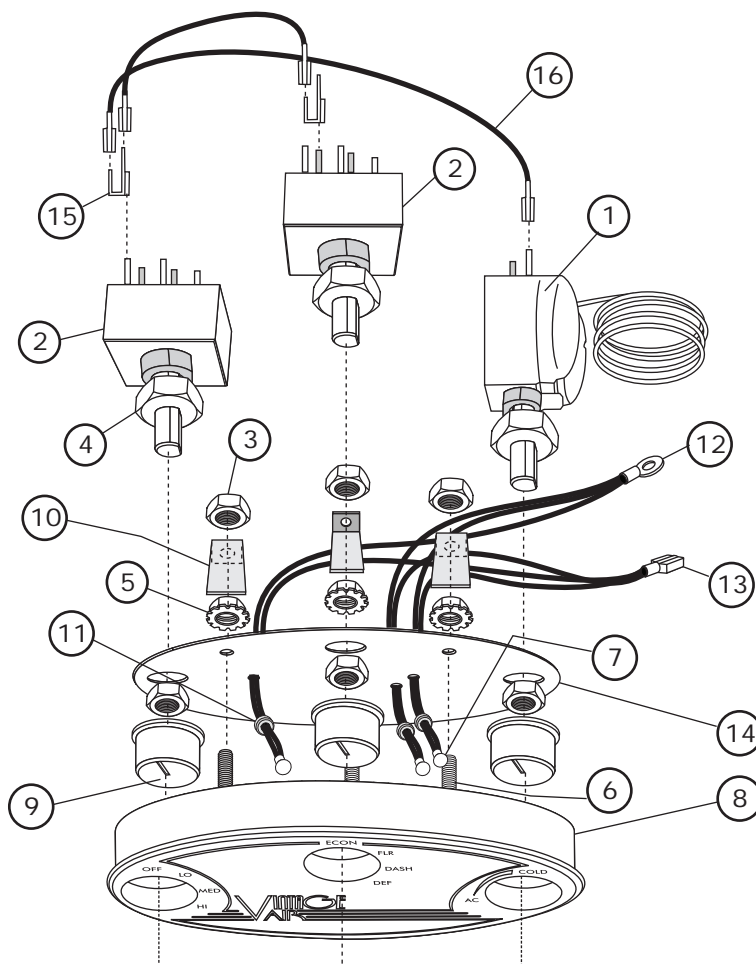

**NOTE: Images may not depict actual parts and quantities.
Refer to packing list for actual parts and quantities.**



www.vintageair.com

Streamline Control Panel Template

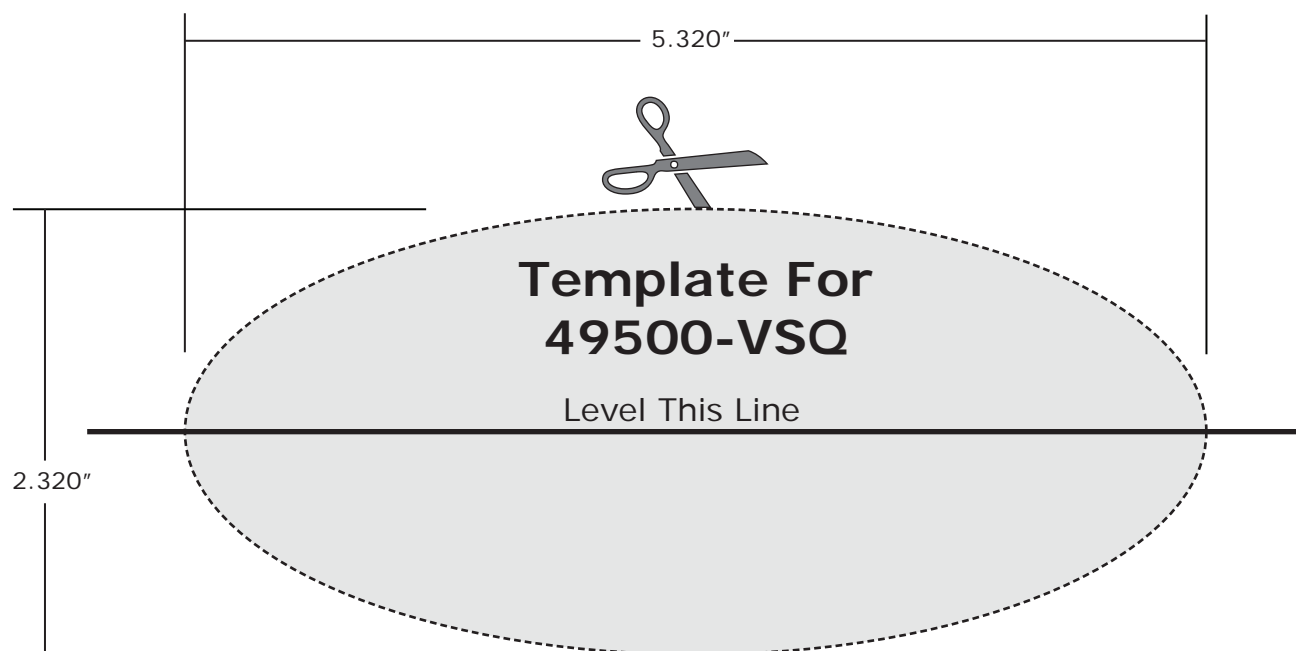

NOTE: Ensure that template measures to dimensions noted above prior to cutting dash.

NOTE: Due to printing variances, measure the line below before using this template. If template is scaled properly, the line should measure 6 inches.





www.vintageair.com

Control Panel Installation

1. Select a suitable location for the control panel. Consider heater control valve location, wiring harness length and capillary tube to evaporator distance.
2. After selecting a location for the panel, mask the area 3 ½" (tall) x 5 ½" (wide).
3. Cut out the grey section of template on Page 4 along the dotted line.
4. Mark the dash with a marker or scribe. **NOTE: Be sure to level the template on the dash.**
5. Cut out the opening for the panel.
6. Remove the backing plate from the face.
7. Install the face in the dash and reinstall the backing plate, making sure the wires for the lights exit the holes in the backing plate.
8. Install the nuts with star washers, then the bracket and nylon locknut. **NOTE: Do not over-tighten the nylon locknut.**
9. Tie one wire from each light bulb together and run them to a ground.
10. Tie the other wires together and connect to the wire in your vehicle's harness that powers your instrument panel lights (+12 volts).
11. Wire according to the wiring diagram on Page 7 for Gen II Compac & Gen II Super Units or see Page 8 for the Gen II Mini.
12. Insert the capillary tube through the sticker on top of the evaporator the entire thickness of the coil.

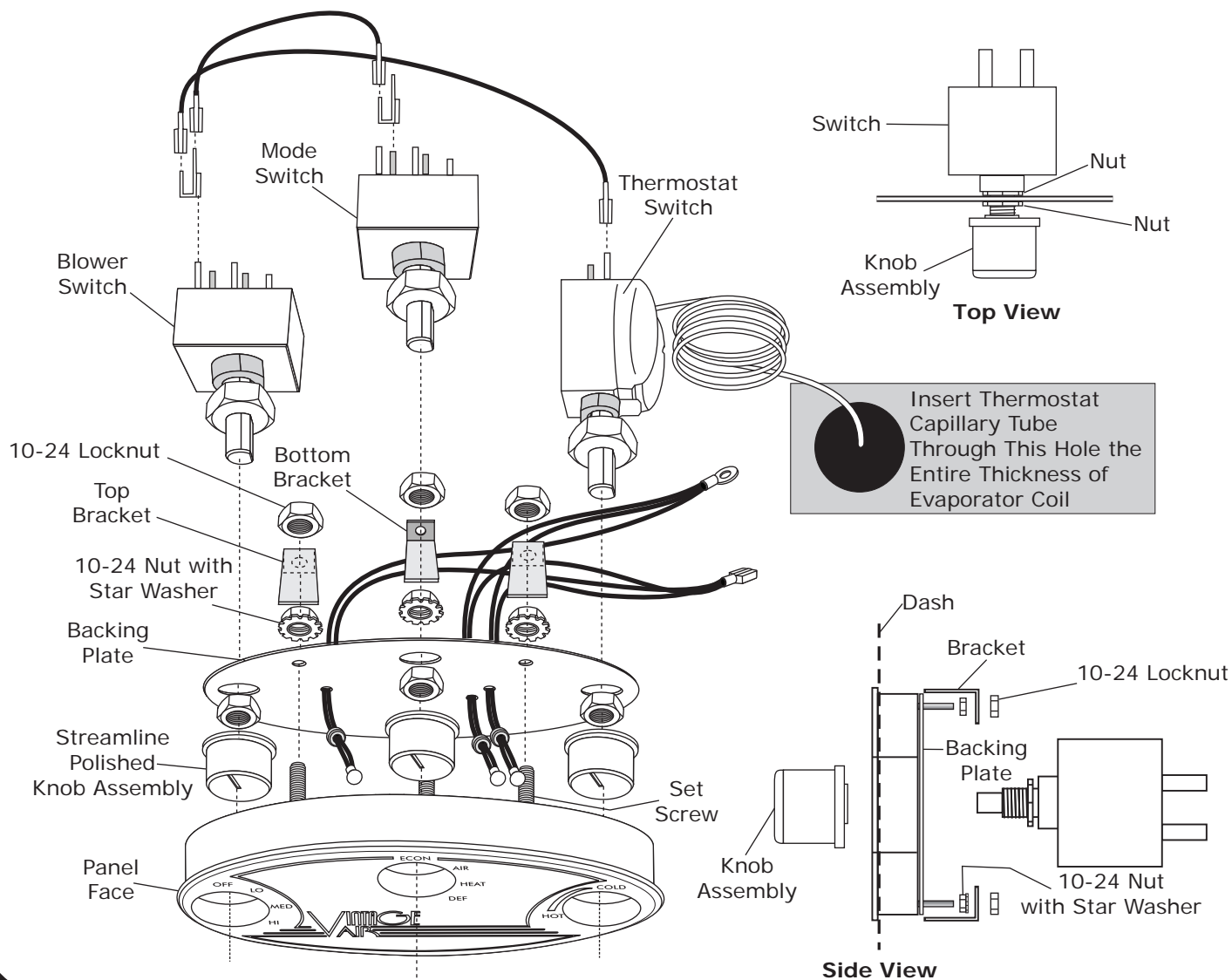



www.vintageair.com

Streamline Control Panel Wiring Diagram

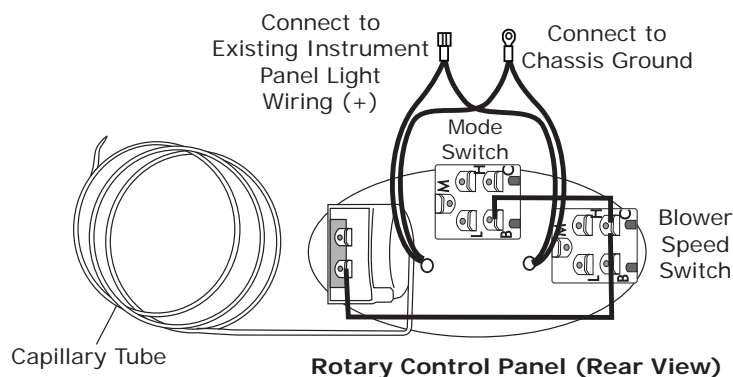

Streamline Operation of Controls

NOTE: Fan speed can be adjusted in any mode position.

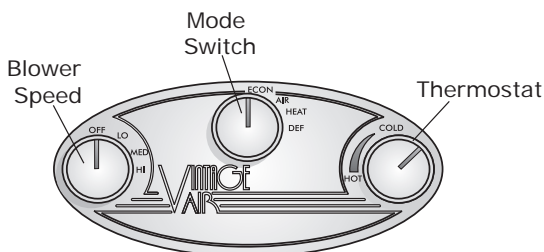

System Off

Turning the fan speed switch to OFF will shut down the system in any mode.

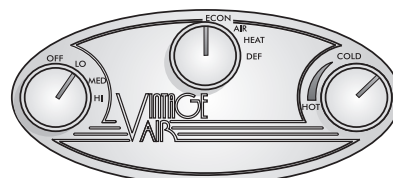

ECON Mode

Select fan speed.
Set mode switch to ECON for recirculation without A/C, heater, defrost.

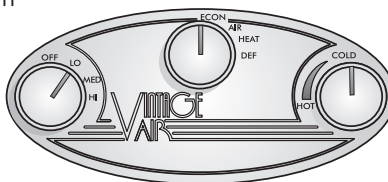

A/C Mode

Select fan speed.
Set mode switch to AIR.
Rotate thermostat knob to COLD. See thermostat instructions on Page 9.

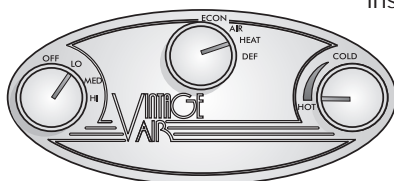

Heat Mode

Select fan speed.
Set mode switch to HEAT.
Hot air will exit the bottom of the unit.

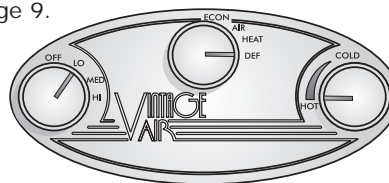

Defrost Mode

Select fan speed.
Set mode switch to DEF.
Dehumidified defrost will be directed to the windshield.
For thermostat adjustments, See Page 9.



Wiring/Vacuum Diagram Heat & Cool





www.vintageair.com

Wiring/Vacuum Diagram Heat & Cool W/Defrost

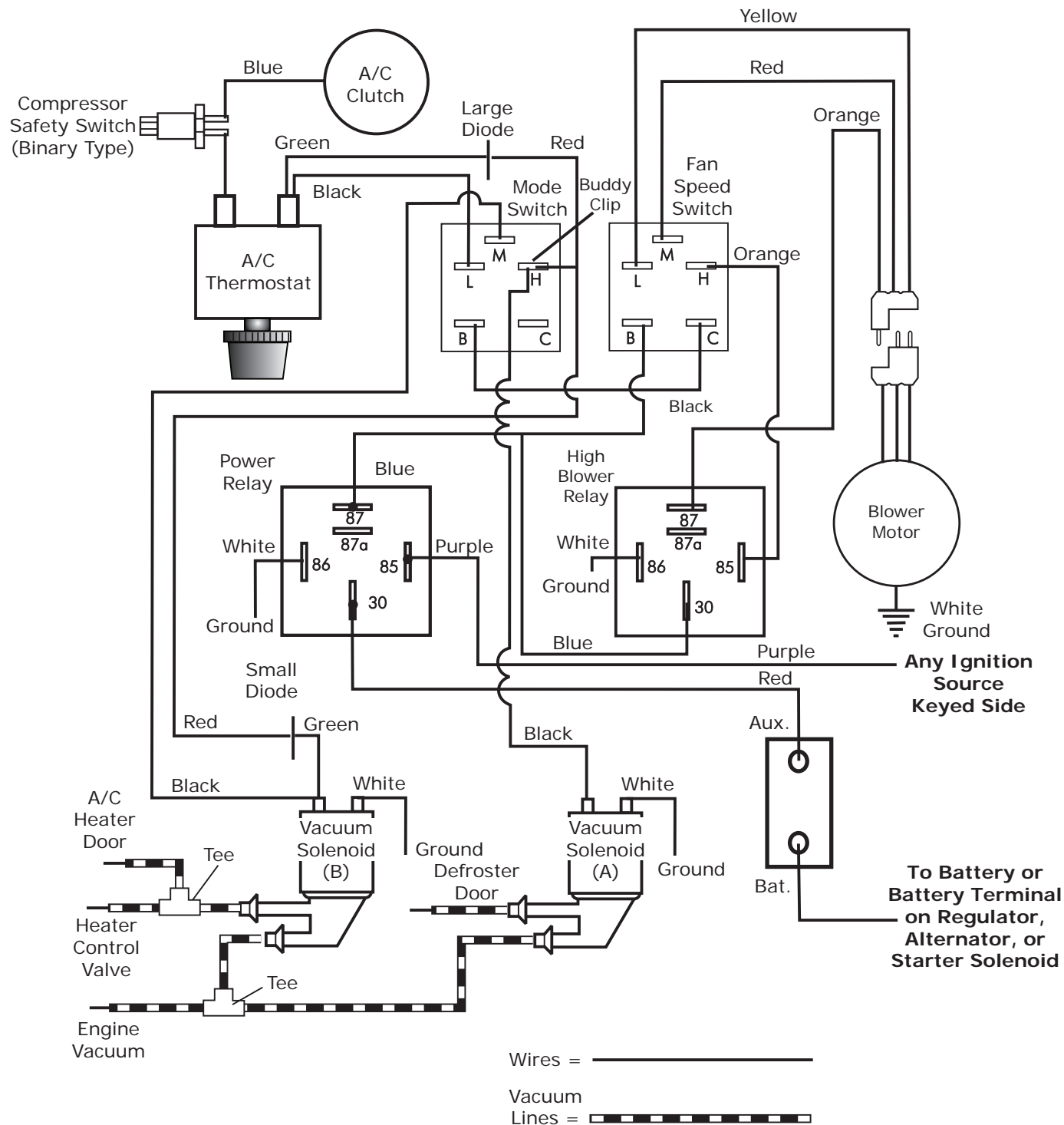



www.vintageair.com

Important Notice- Please Read!

This Sticker is Located on the Top Side of the Evaporator Case

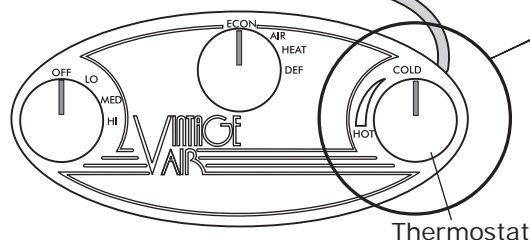
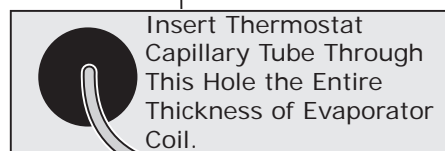

Capillary Tube to Evaporator Coil

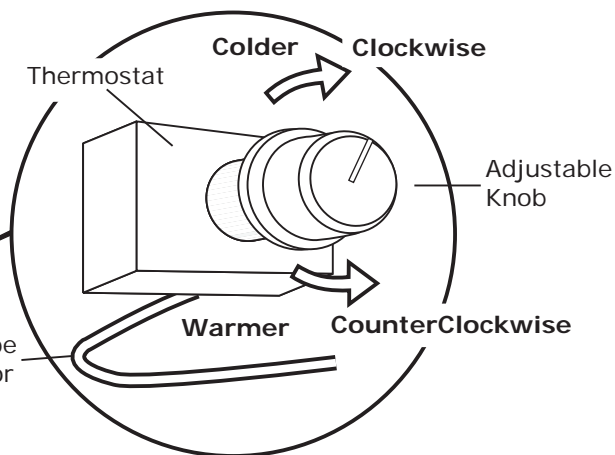

Air Conditioning Adjustments

1. The air conditioner thermostat controls coil temperature. It is shipped adjusted fully cold (clockwise) and, in the majority of cases, the A/C will operate correctly as shipped.
2. Turning the knob on the thermostat to the right (clockwise) makes the system operate colder. If the thermostat is set too cold, the evaporator will ice up. If this happens the evaporator coil is restricted with ice and cold air flow will be reduced.
3. Turning the knob on the left (counterclockwise) makes the system operate warmer. The compressor clutch will cycle off frequently and the A/C system will not get as cool as it could.

Adjusting A/C Thermostat

1. **Symptom:** The A/C works well at first, but then quits cooling. The air flow from the vents is low and the compressor cycles infrequently.
Solution: The thermostat is set too cold and the evaporator is icing up and restricting air flow. Allow the ice to melt and set the thermostat warmer (counter clockwise) 10% of a turn each adjustment until the symptoms diminish.
2. **Symptom:** A/C never gets cold and the compressor clutch cycles frequently.
Solution: The thermostat is set too warm. Set the thermostat colder (clockwise) 10% of a turn each adjustment until the compressor clutch cycles infrequently. Avoid setting the thermostat too cold.
3. **Symptom:** The A/C never gets cold, sometimes even blows hot, and the A/C compressor clutch infrequently cycles off.
Solution: The heater may be on at all times. Carefully feel around the heater hoses at the firewall. They should be cold when the A/C is on. If the hoses are hot:
 - A) The heater control valve may be installed backwards. Check the flow direction arrow on the valve against the illustration your installation instructions.
 - B) The heater control valve is installed in wrong heater hose.



www.vintageair.com

Packing List: Streamline Control Panel (49500-VSQ)

No.	Qty.	Part No.	Description
1.	1	11092-VUT	Thermostat, 48" Adjustable Rotary
2.	2	11458-VUS	Switch, 3-Speed Rotary
3.	3	18145-VUB	Locknut, 10-24
4.	6	18157-VUB	Shaft Nut, 7/16"
5.	3	18260-VUB	Nut with Star Washer, 10-24
6.	3	18414-VUB	Screw, 10-24 x 3/4", Set
7.	3	20557-VUP	Light Bulb
8.	1	49095-VUI	Panel, Streamline, Polished
9.	3	492014	Knob Assembly, Polished
10.	3	64123-VUB	Bracket, Streamline Control Panel
11.	3	33138-VUI	Grommet, 1/4"
12.	1	23120-VUW	Terminal, #10, Ring
13.	1	23122-VUW	Terminal, 1/4", Spade
14.	1	648178	Bracket, Streamline Oval Panel Rear Cover
15.	2	23123-VUW	Buddy Clip
16.	2	23139-VUW	Jumper Wire, 6"

Checked By: _____
Packed By: _____
Date: _____

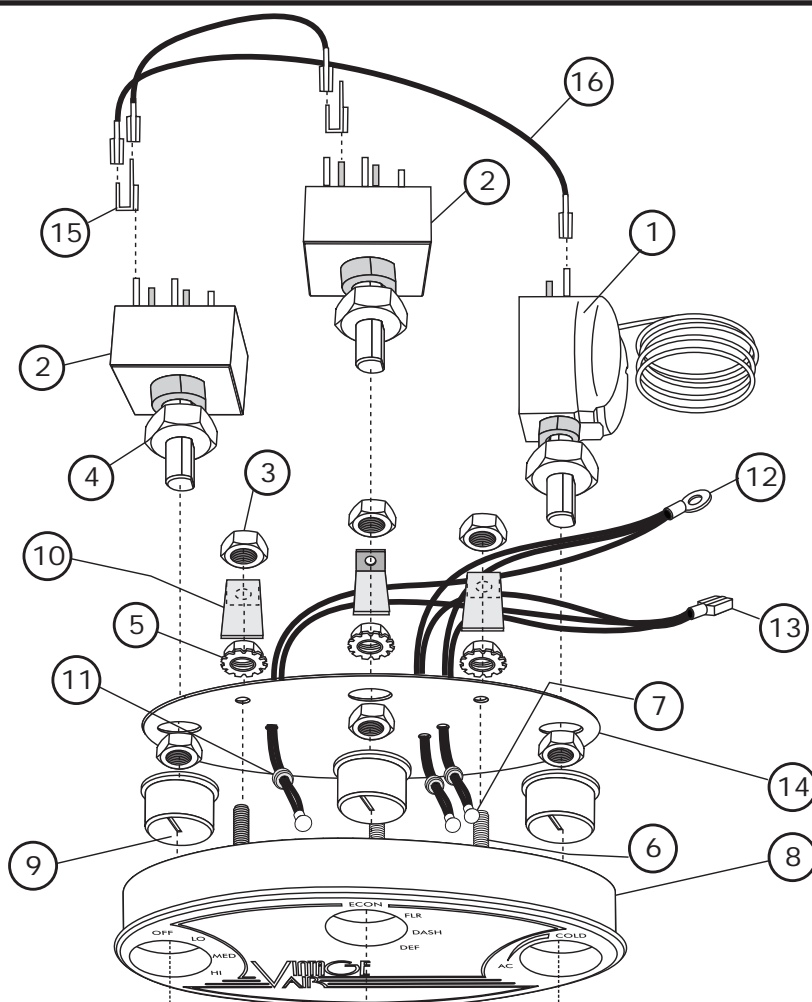

**NOTE: Images may not depict actual parts and quantities.
Refer to packing list for actual parts and quantities.**