

**ADVANTAGE  
AIR**

10305 I.H. 35 N. - SAN ANTONIO, TX. - 78233 - ph.210-654-7171 - fax 210-654-3113

INSTALLATION INSTRUCTIONS FOR

**ComPac**  
**HEATER** w/ DEFROST  
(50615-VUH)

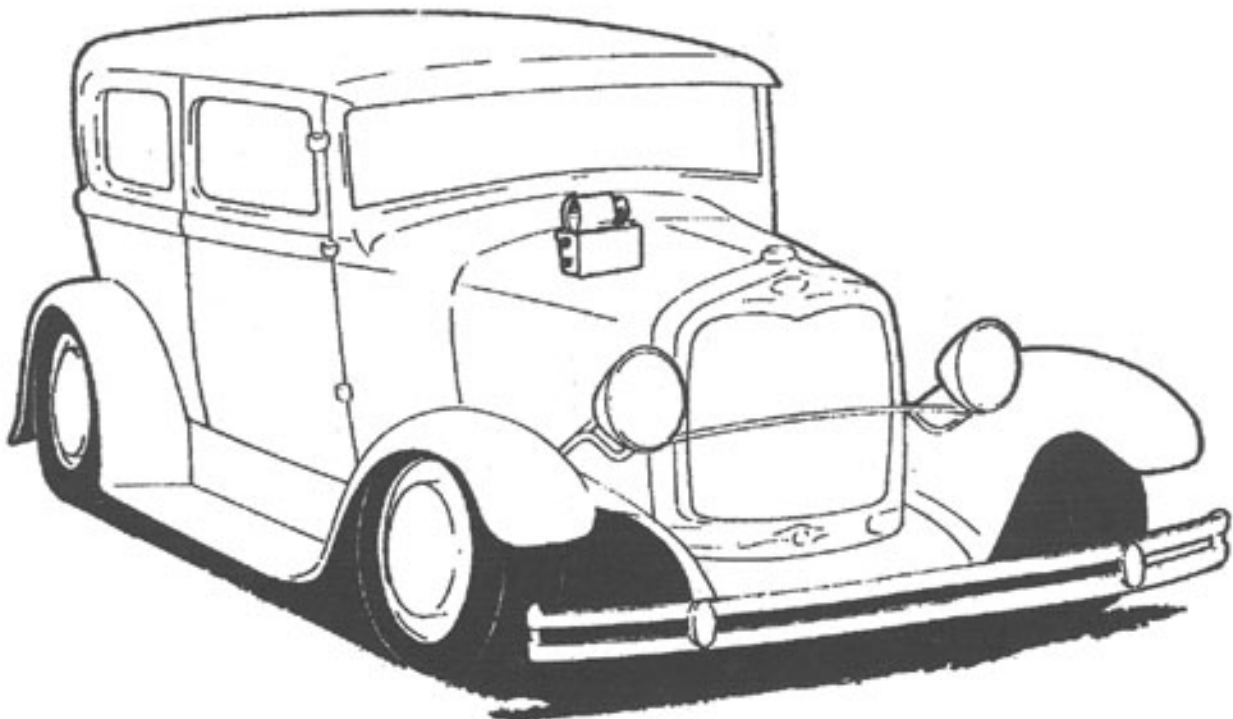

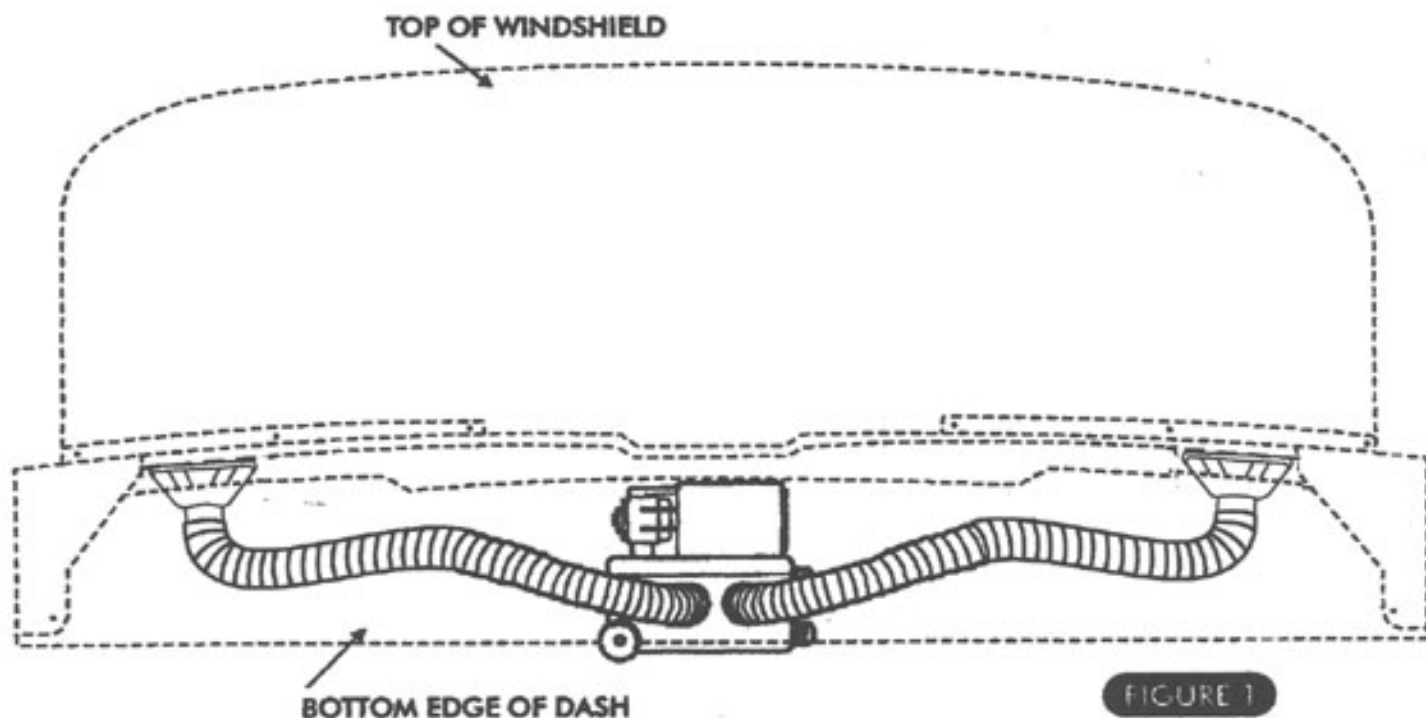

### INSTALLATION INSTRUCTIONS HEATER w/ DEFROST

THE VINTAGE AIR HEATER UNIT IS DESIGNED TO MOUNT INSIDE OF THE FIREWALL IN THE PASSENGER COMPARTMENT. THE INSTALLATION OF THIS UNIT VARIES ACCORDING TO BODY MANUFACTURER OR MODIFICATIONS TO ORIGINAL FIREWALL. AFTER SELECTING LOCATION (BE SURE UNIT DOES NOT INTERFERE WITH COWL VENT, WIPERS, ETC.) USE TEMPLATE TO LOCATE AND DRILL TWO (2) 9/32" DIAMETER MOUNTING HOLES (SEE PAGE 3).

**SEE PAGE 4 FOR HEATER HOSE ROUTING INSTRUCTIONS.**



# ComPac HEATER w/ DEFROST KIT

9.20" (9-13/64")

7/32"

7/32"



TOP

2.50"  
(2-1/2")

5"

DRILL TWO (2)  
9/32" DIAMETER HOLES



## HEATER HOSE INSTALLATION

- AFTER THE HEATER IS IN PLACE, RUN 5/8" HEATER HOSE FROM THE BOTTOM HEATER FITTING THRU FIREWALL OR BEHIND KICK PANEL THRU FLOOR TO THE INTAKE MANIFOLD HEATER CONNECTION. INSTALL THE VACUUM HEATER CONTROL VALVE IN THIS LINE. SEE FIGURE 2.
- INSTALL 5/8" HEATER HOSE ON TOP FITTING OF HEATER THRU FIREWALL OR BEHIND KICK PANEL THRU FLOOR BOARD AND OUT TO WATER PUMP CONNECTION.
- FILL RADIATOR WITH COOLANT. CHECK ALL HEATER CONNECTIONS FOR LEAKS.
- START ENGINE AND RUN UNTIL NORMAL OPERATING TEMPERATURE IS REACHED. PLACE SWITCH IN HEAT POSITION (SEE FIGURE 5) AND SELECT FAN SPEED DESIRED. THE SYSTEM WILL HEAT THE VEHICLE.
- WHEN VALVE IS CLOSED INLET SIDE OF VALVE SHOULD BE HOT AND OUTLET SIDE SHOULD BE COOL. WHEN THE VALVE IS OPEN BOTH INLET AND OUTLET SIDE SHOULD BE HOT.

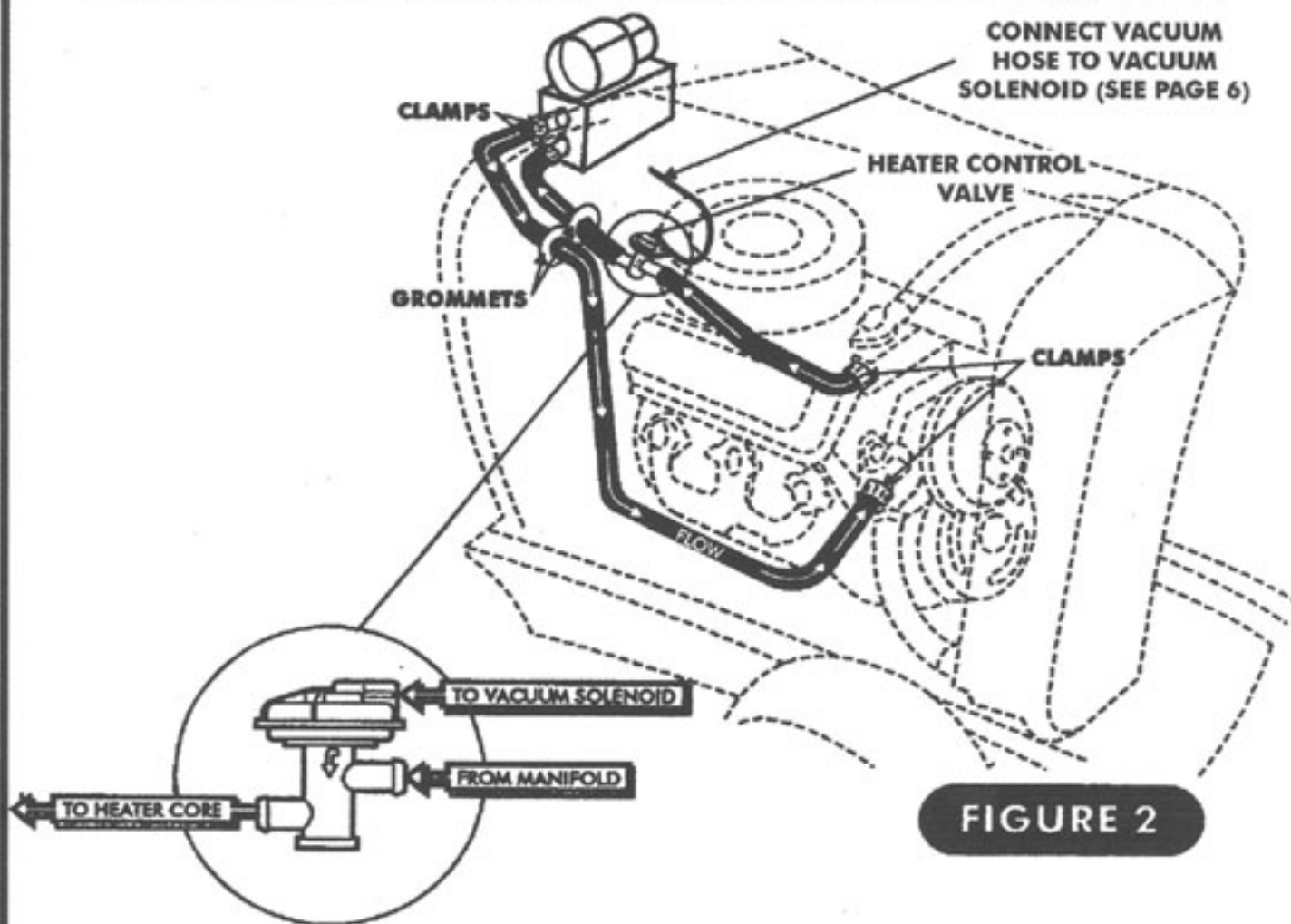

**FIGURE 2**

## DEFROST DUCTS INSTALLATION

- FIGURE 3 SHOWS GENERAL LOCATIONS OF DEFROSTER DUCT HOLES. THE LOCATION OF THESE DUCTS WILL VARY.

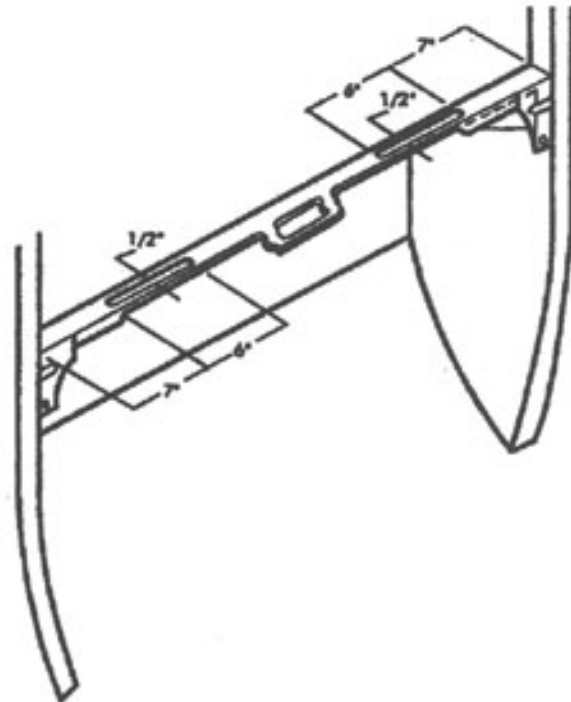

**FIGURE 3**

- INSTALL THE DEFROST DUCTS AS FIGURE 4 SHOWS.

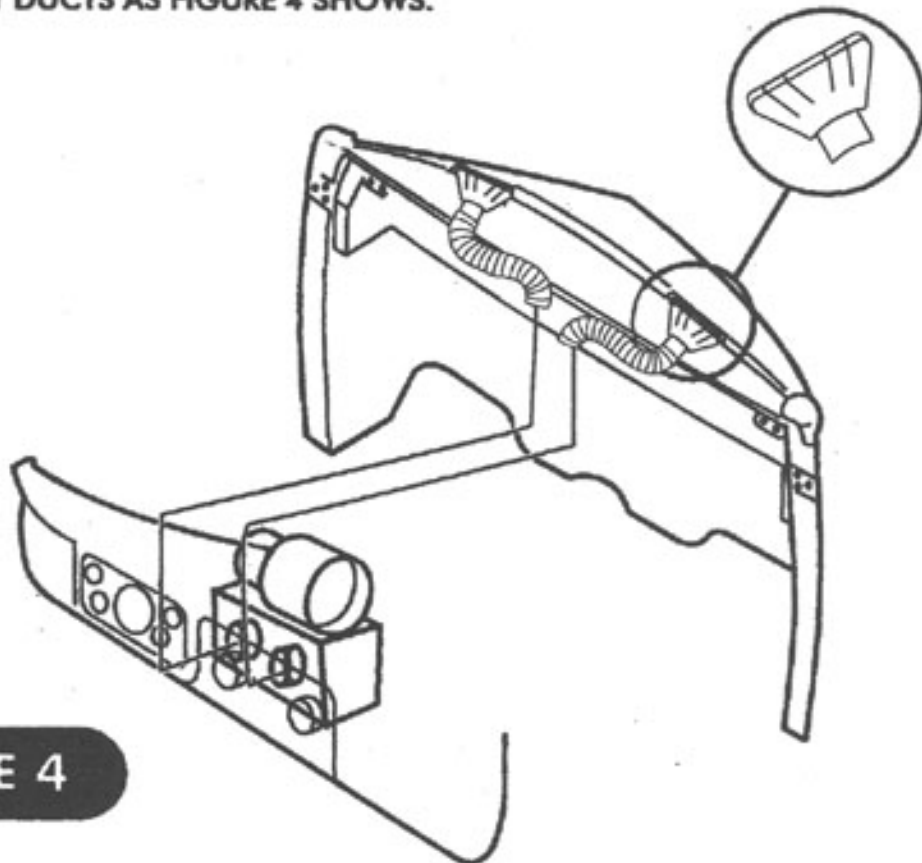

**FIGURE 4**

## WIRING/ VACUUM DIAGRAM HEATER w/ DEFROST

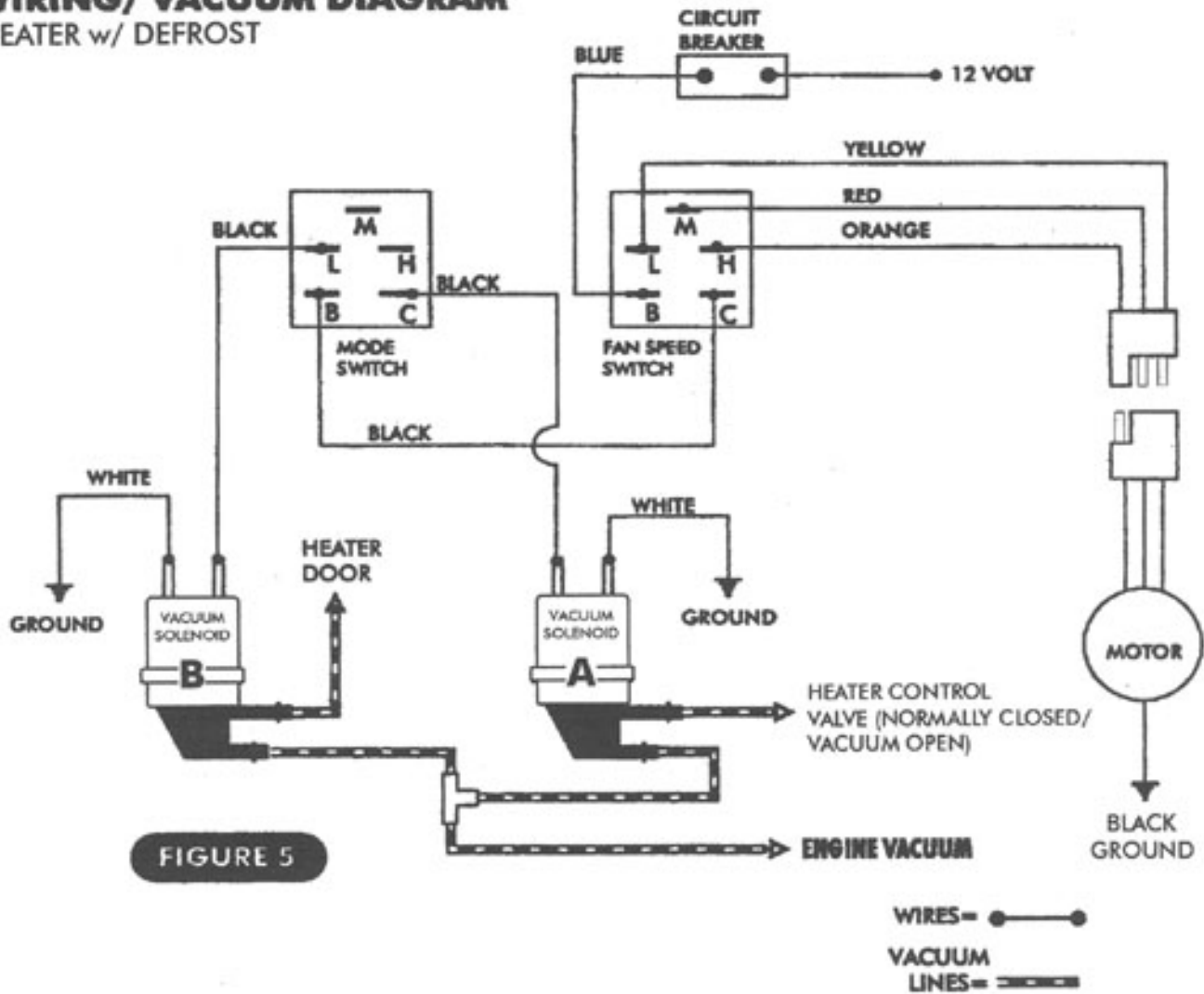

## CONTROL POD

### CHECK OPERATION.

THE SWITCH ON THE LEFT IS THE BLOWER SWITCH - CONTROLS 3-SPEED FAN MOTOR.

MODE SWITCH ON RIGHT. FULL COUNTER CLOCKWISE IS THE OFF POSITION. THE FIRST POSITION IS HEAT. HEATER DOOR OPENS AND HEATER VALVE WILL HAVE VACUUM. HOT AIR EXITS AT FLOOR. THE SECOND POSITION IS DEFROST. AIR WILL BE DIRECTED TO DEFROST VENTS.

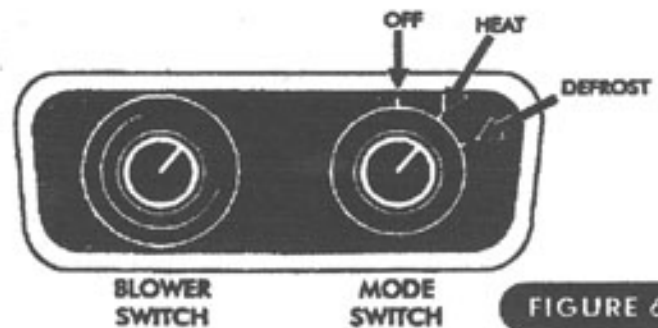

**50615-VUH PACKING LIST**

No.	QTY.	PART No.	DESCRIPTION
1.	1	50506-VUE	SLIMLINE HEATER w/ DEFROST SUB CASE
2.	1	49701-VUH	HEATER/DEFROST WIRING KIT
3.	1	63360-VUE	HEATER I K KIT
4.	1	63380-VUE	COMPAC DEFROSTER DUCTS
5.	5	06200-VUE	2" DUCT HOSE

CHECKED BY: \_\_\_\_\_  
 PACKED BY: \_\_\_\_\_  
 DATE: \_\_\_\_\_

